



- ES** MANUAL DE USUARIO
- EN** OWNER'S MANUAL
- FR** MANUEL DE L'UTILISATEUR
- PT** MANUAL DO UTILIZADOR
- IT** MANUALE DI UTENTE



SMART APP

Por favor lea atentamente este manual antes de usar este producto.

Please, read carefully this manual before using the product.

Avant d'utiliser l'équipement, lisez attentivement les instructions.

Por favor leia atentamente este manual antes de usar o equipamento.

Per favore leggere attentamente questo manuale prima di utilizzare questo prodotto.

Gracias | Thank you | Merci | Obrigado | Grazie

giatsu

ESPAÑOL

MANUAL DE USUARIO

SMART APP

Guía de usuario Smart APP

- Asegúrese de que su teléfono (o tablet) esté conectado al wifi cuando lo ponga en funcionamiento.
- Una vez vinculado puede controlar el aire acondicionado a través de la APLICACIÓN bajo la conexión de red móvil o wifi.



1. Escanee el código QR para instalar la APLICACIÓN

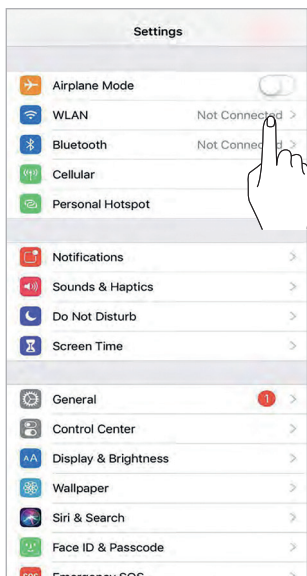

2. Encienda el wifi y conéctese a internet.

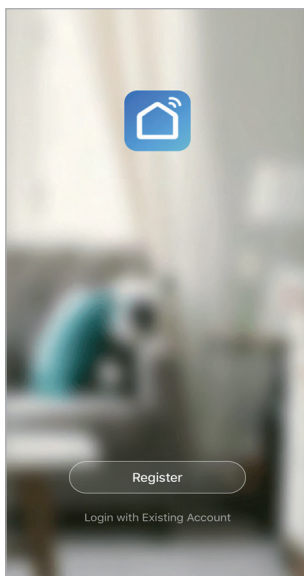

3. Abra la aplicación. Los nuevos usuarios operan de acuerdo con las indicaciones del registro. Los usuarios registrados teclean cuenta y contraseña para iniciar sesión.

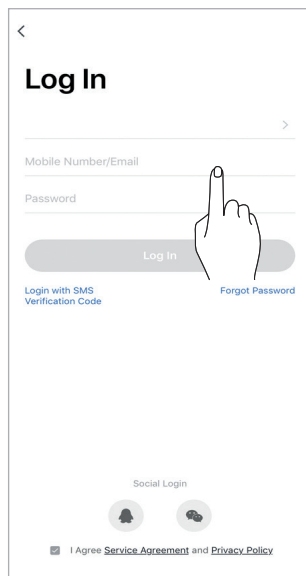

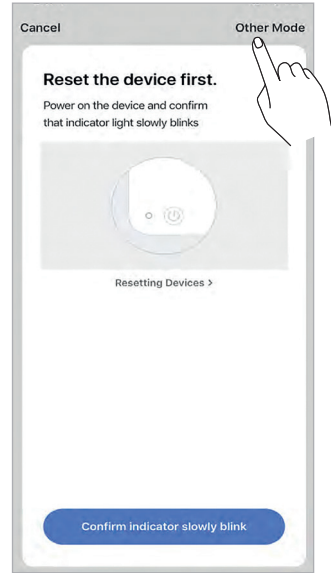
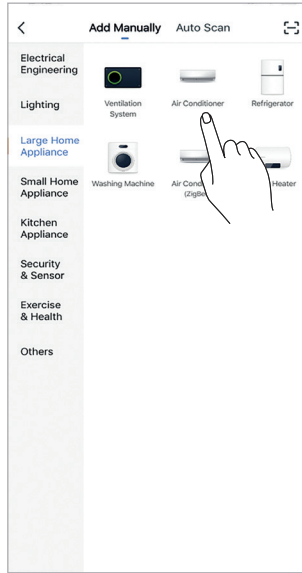
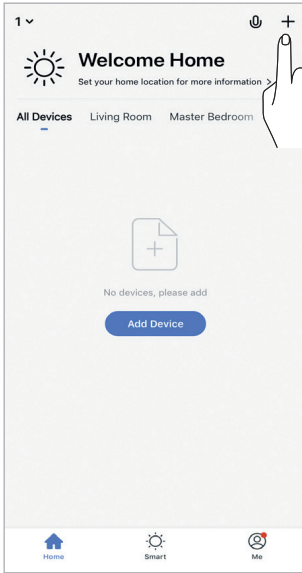

4. Después de iniciar sesión, haga clic en "+". Busque "Air Conditioner" en la lista de productos y agréguelo.

5. Haga clic en "Other Mode".

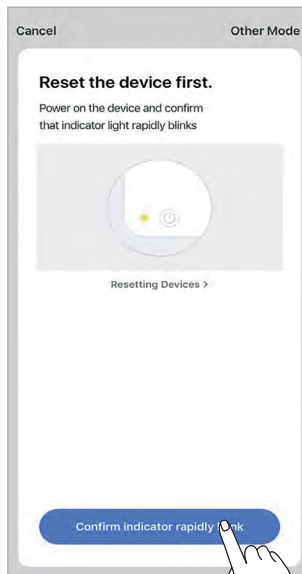
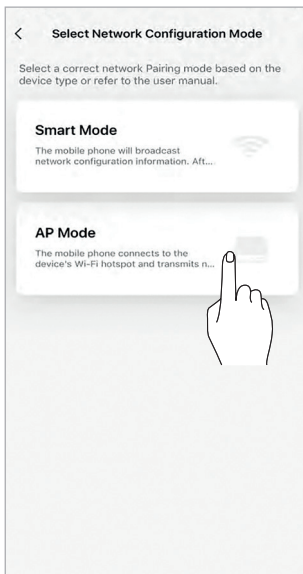

6. Clique "AP Mode" presione y mantenga el botón "Wi-Fi" del mando a distancia unos 3~5s. Después de que en el panel frontal aparezca "A2". Haga clic en "Confirm Indicator slowly blinks".

7. Clique "Confirm" después de ingresar la contraseña.

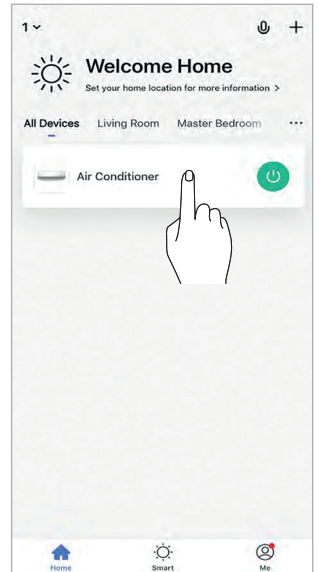
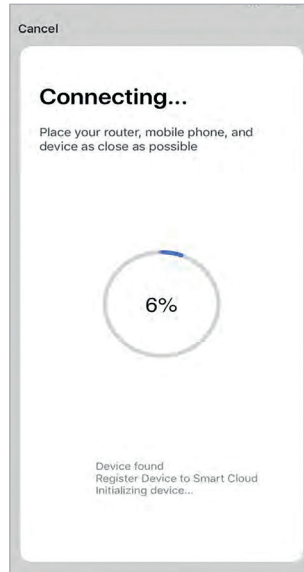
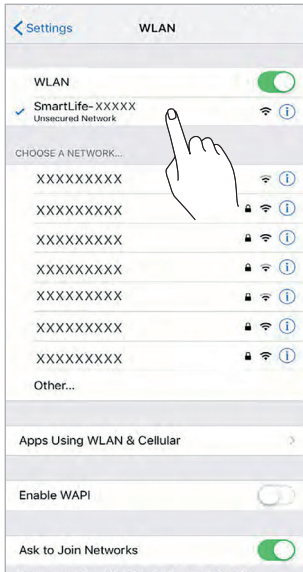

8. Seleccione y conecte “Smart Life-xxx”. Regrese a la APP, una vez conectado. El dispositivo agregado aparecerá en la página de inicio. Una vez ahí puede hacer clic en el aire acondicionado para empezar a usarlo.

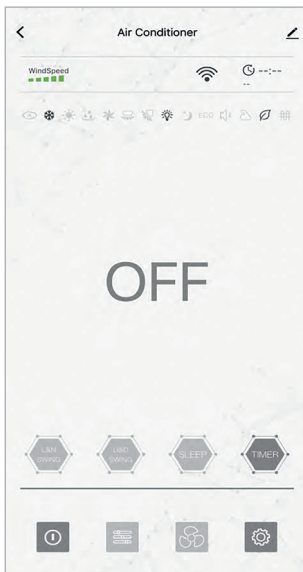

Aire acondicionado Off

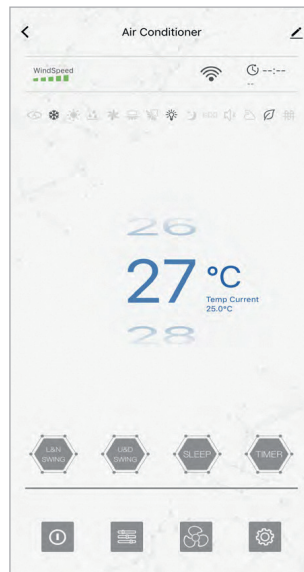

Aire acondicionado On



Compartir dispositivo:
Clic “”
en la página de inicio, luego
haga clic en “Share Device”.

Dispositivo remoto

Opere de la siguiente manera:

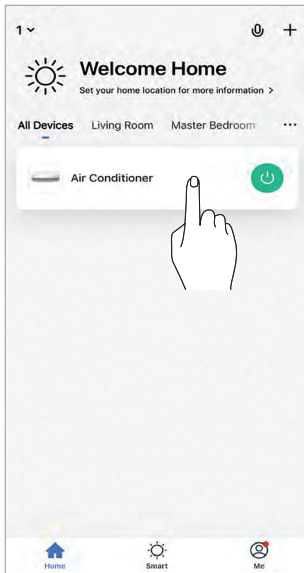

1. Clique “Air Conditioner” para ingresar en la interfaz de control.

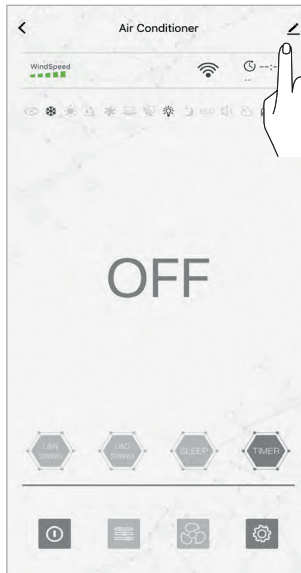

2. Clique “”.

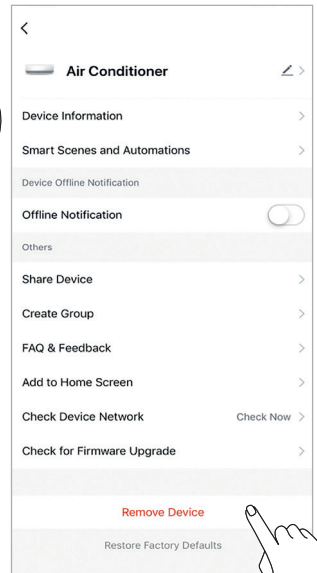

3. Clique “Remove Device”.

giatsu

ENGLISH

OWNER'S MANUAL

SMART APP

Smart APP User Guide

- Please ensure that your phone (PC Tablet) must connect Wi-Fi when operating.
- After binding, you control the air conditioner through APP under the connection of mobile network or Wi-Fi.



1. Scan the QR code to install APP

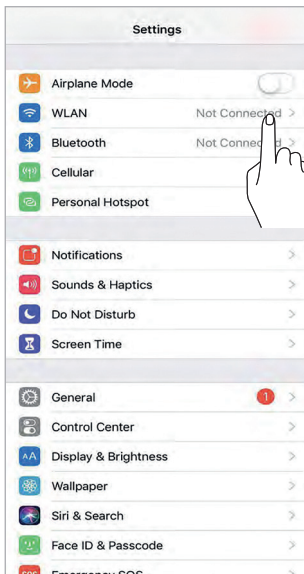

2. Turn on Wi-Fi and connect to internet.

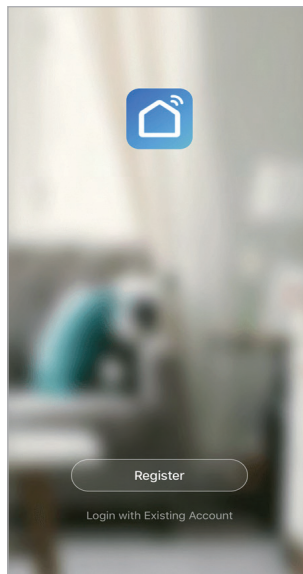

3. Open application. New users operate according to system prompts for registration. Old users input account & password to log in.

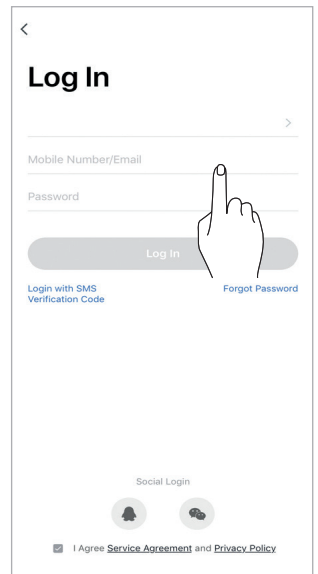

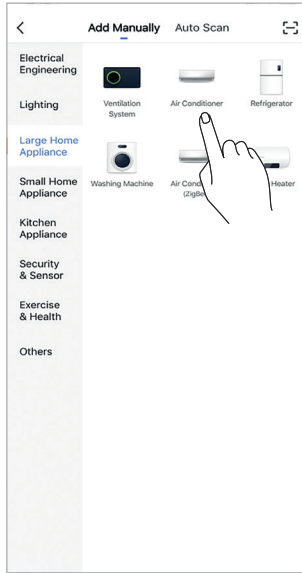
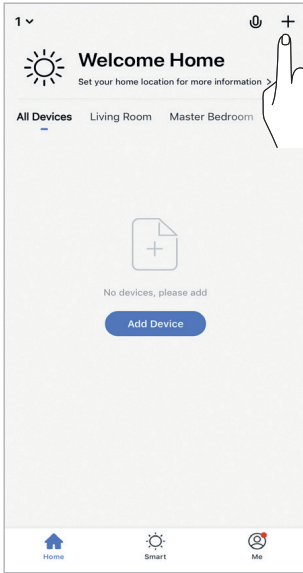

4. After logging in, click “+”. Look for “Air Conditioner” from the product list and add it.

5. Click “Other Mode”.

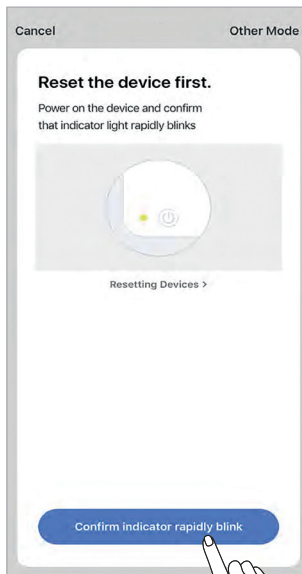
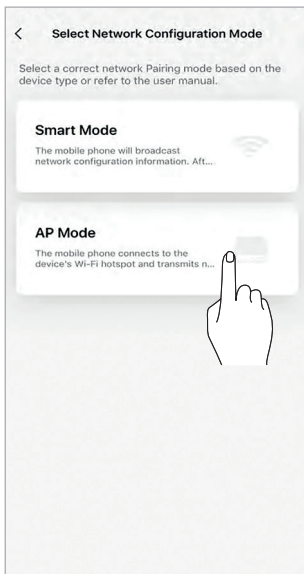

6. Click “AP Mode” Press and hold “” button on remote controller for 3~5s. After front panel appears “A2”, click APP “Confirm Indicator slowly blinks”.

7. Click “Confirm” after inputting password.

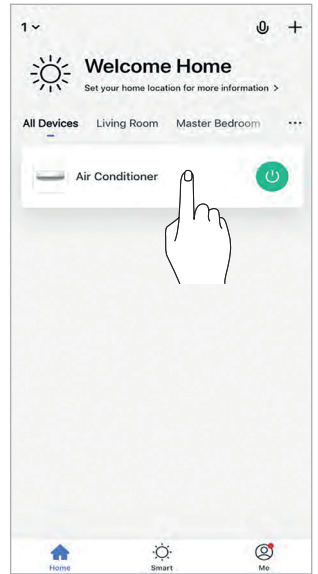
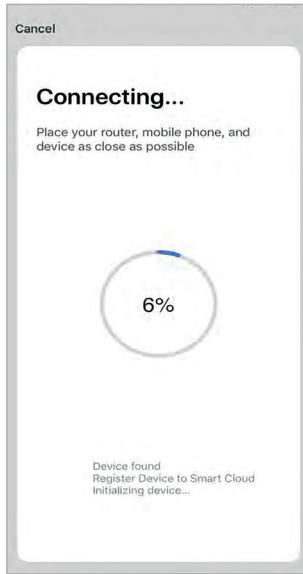
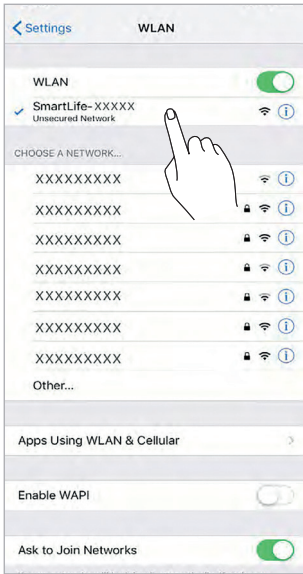

8. Select and connect “Smart Life-xxx”. Turn back to APP, with a successful connection. Device added successfully will appear on home page. Then you can click the air conditioner to operate.

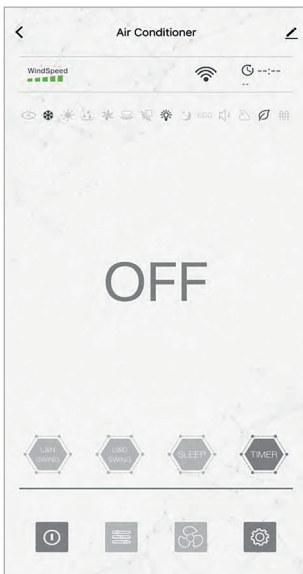

Air Conditioner Off

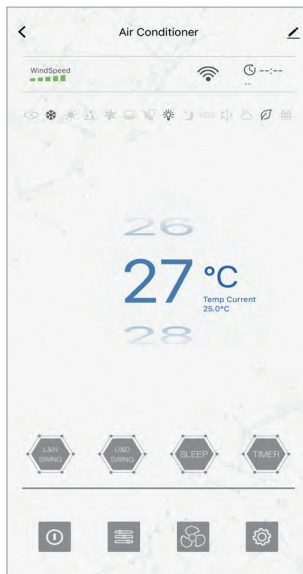

Air Conditioner On



Share Device: Click “” on home page, then click “Share Device”.

Remote Device

Operate as follow:

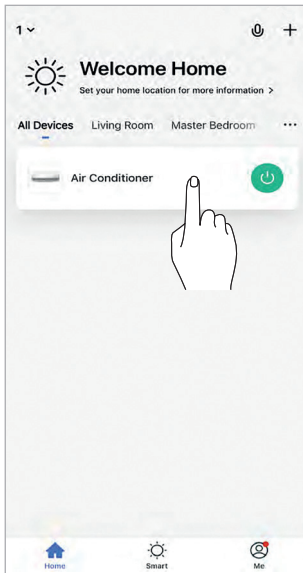

1. Click "Air Conditioner" to enter control interface.

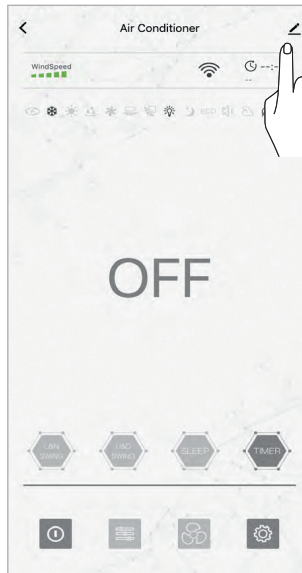

2. Click "✎".

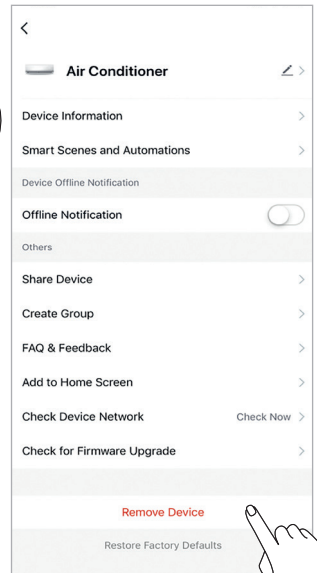

3. Click "Remove Device".

giatsu

FRANÇAIS

MANUEL DE L'UTILISATEUR

SMART APP

Smart APP Manuel de l'utilisateur

- Veuillez vous assurer que votre téléphone (tablette PC) doit être connecté au Wi-Fi pour fonctionner.
- Après la liaison, vous contrôlez le climatiseur avec l'APP sous la connexion d'un réseau mobile ou Wi-Fi.



1. Scannez le code QR pour installer l'application

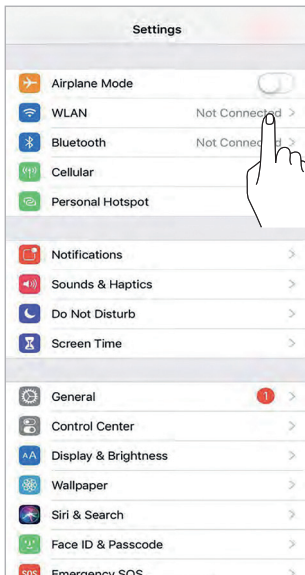

2. Activez le Wi-Fi et connectez-vous à Internet.

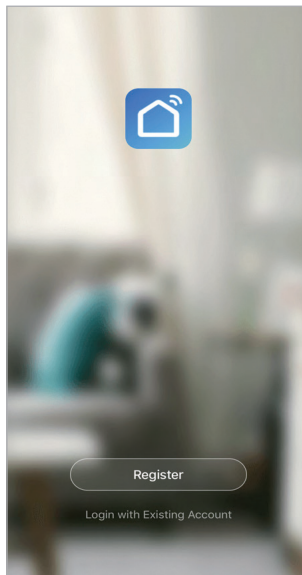

3. Ouvrir l'application. Les nouveaux utilisateurs fonctionnent selon les invites du système pour l'enregistrement. Anciens utilisateurs saisissent un compte et un mot de passe pour se connecter.

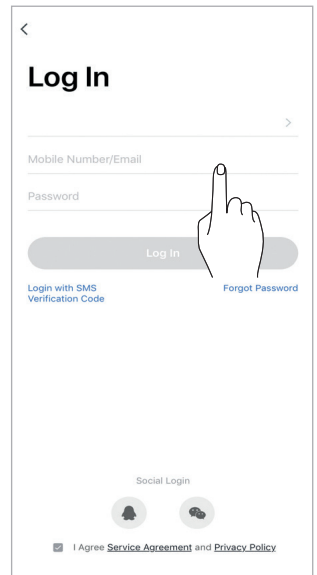

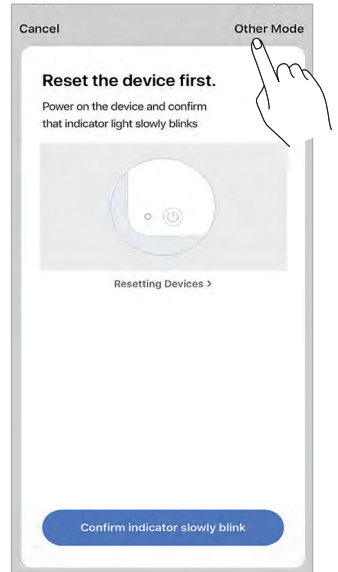
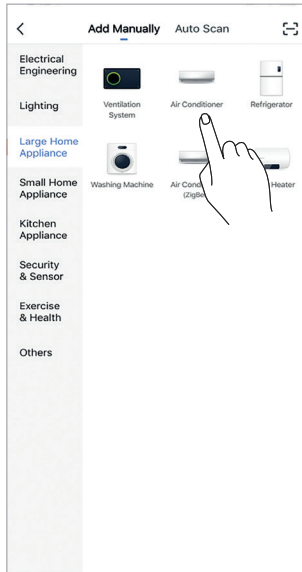
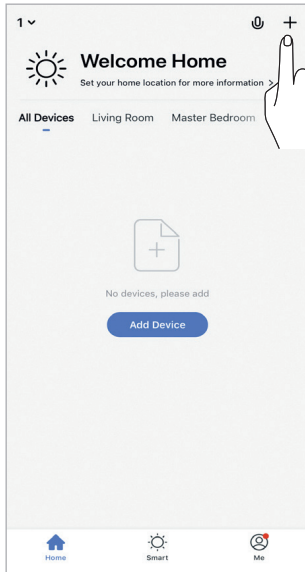

4. Une fois connecté, cliquez sur “+”. Chercher “Air Conditioner” dans la liste de produits et ajoutez-le.

5. Cliquez sur “Other Mode”.

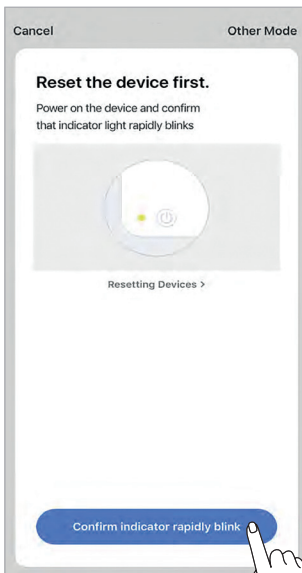
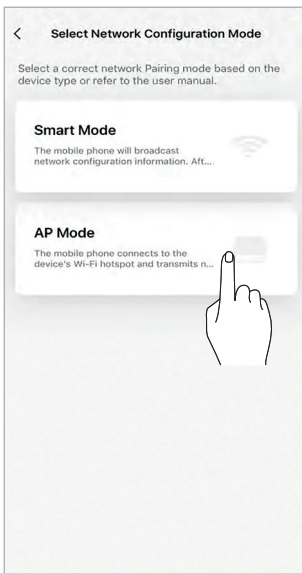

6. Cliquez sur “AP Mode” Appuyez et maintenez “” bouton sur la télécommande pendant 3 ~ 5s. Une fois que le panneau avant apparaît «A2», cliquez sur APP. “Confirm Indicator rapidly blinks”.

7. Cliquez sur “Confirm” après avoir saisi le mot de passe.

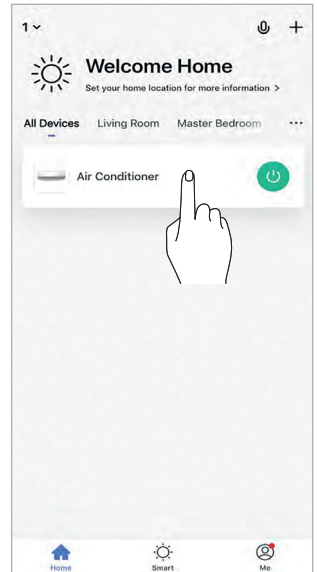
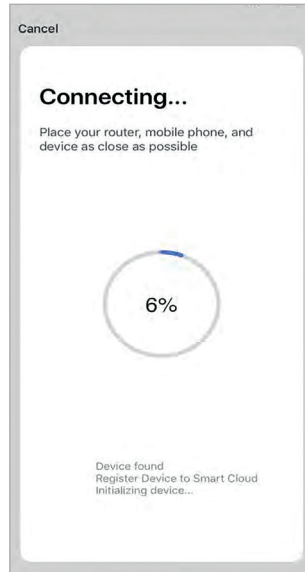
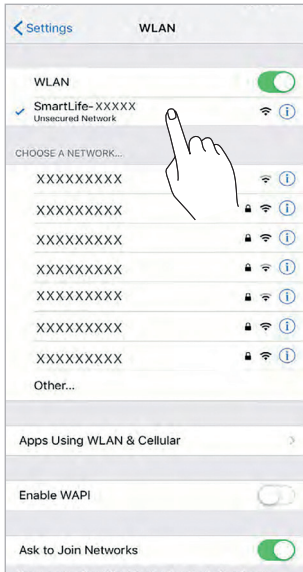

8. Sélectionnez et connectez "Smart Life-xxx". Retournez à APP, avec une connexion réussie. Le périphérique ajouté avec succès apparaîtra sur la page d'accueil. Ensuite, vous pourrez cliquer sur le climatiseur pour le faire fonctionner.

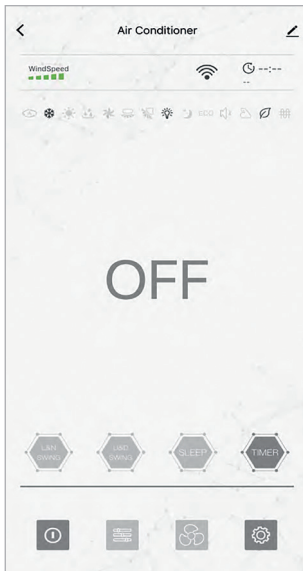

Climatiseur éteint



Climatiseur en marche



Partager l'appareil: Cliquez sur "—" sur la page d'accueil, puis cliquez sur "Share Device".

Appareil distant

Fonctionner comme suit:

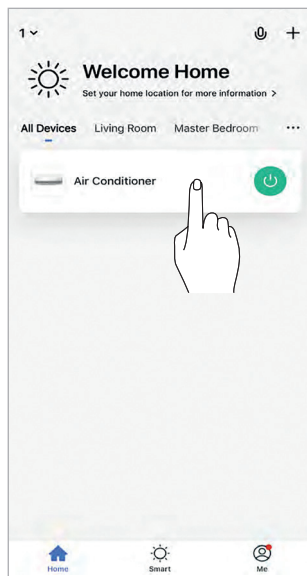

1. Cliquez sur "Air Conditioner" pour entrer dans l'interface de contrôle.

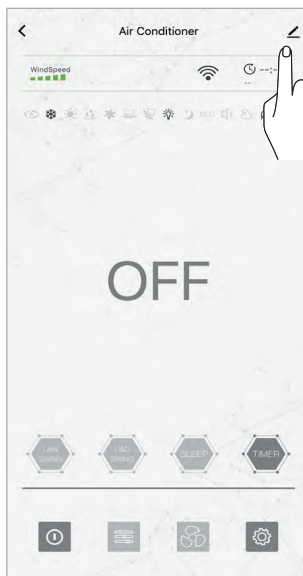

2. Cliquez sur "✎".

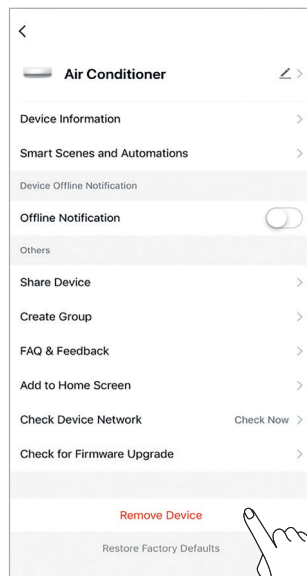

3. Cliquez sur "Remove Device".

giatsu

PORTUGUÊS

MANUAL DO UTILIZADOR

SMART APP

Smart APP Manual do utilizador

- Verifique se o seu telefone (PC Tablet) deve conectar o Wi-Fi quando estiver operando.
- Após a ligação, você controla o ar condicionado através do APP sob a conexão de rede móvel ou Wi-Fi.



1. Digitalize o código QR para instalar o APP

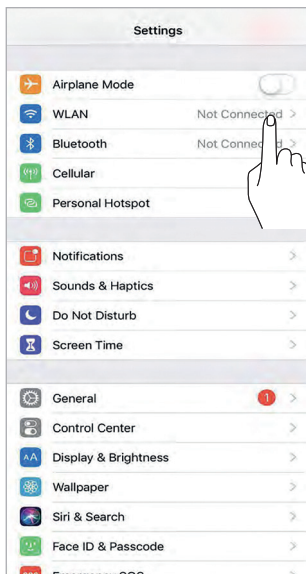

2. Ligue o Wi-Fi e conecte-se à Internet.

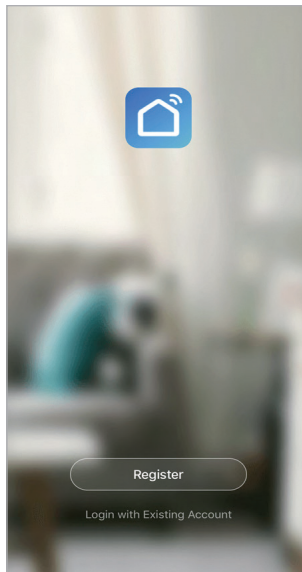

3. Abra o aplicativo. Novos usuários operam de acordo com as solicitações do sistema para registro. Usuários antigos inserem conta e senha para fazer login.

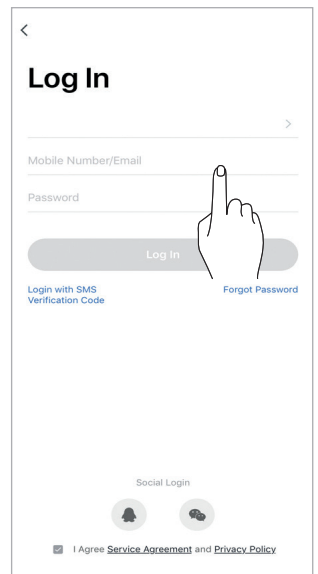

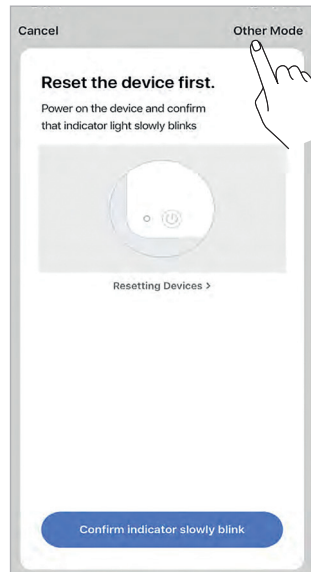
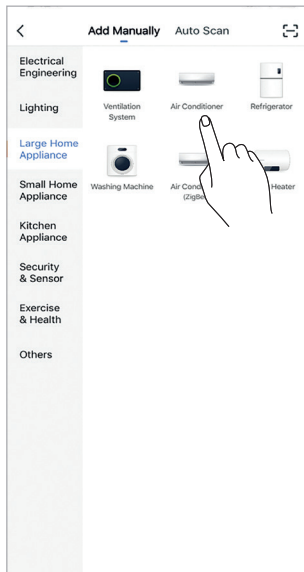
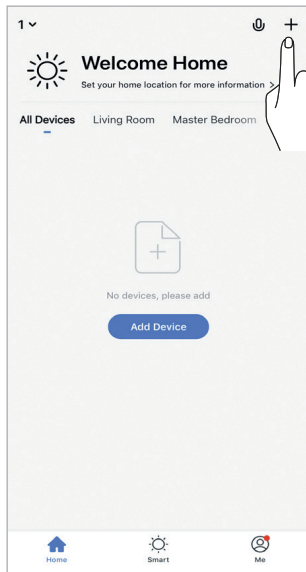

4. Após o login, clique em “+”. Procure por “Air Conditioner” na lista de produtos e adicione-o.

5. Clique em “Other Mode”.

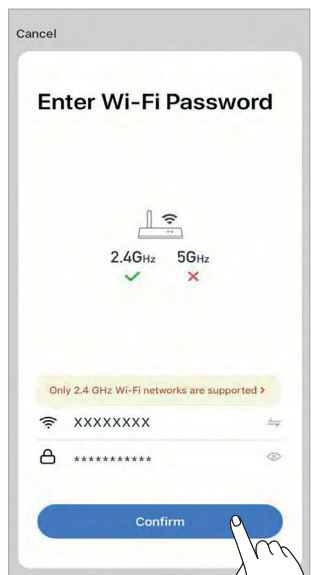
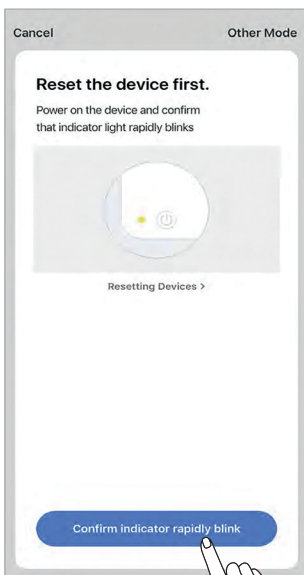
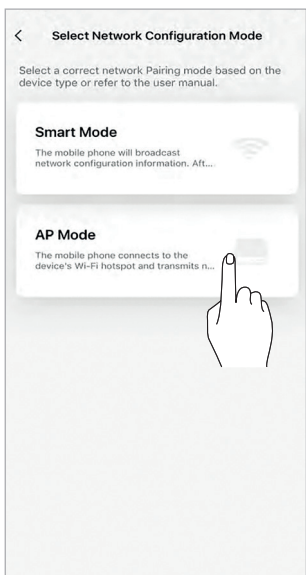

6. Clique em “AP Mode” Pressione e segure o botão “” no controle remoto por 3 ~ 5. Após o painel frontal “A2”, aparecer, clique em APP “Confirm Indicator slowly blinks”.

7. Clique em “Confirm” após inserir a senha.

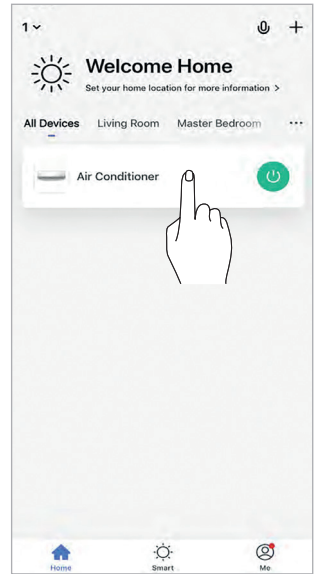
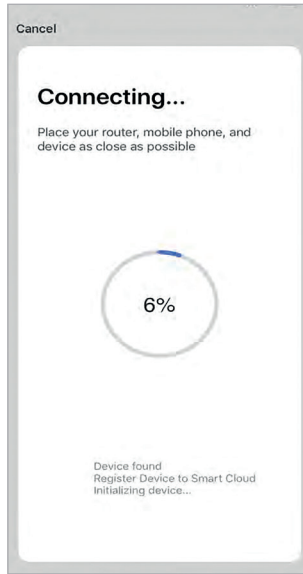
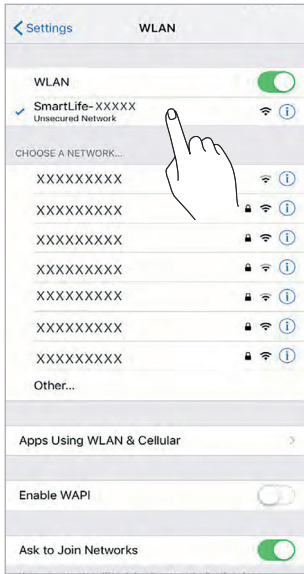

8. Selecione e conecte “Smart Life-xxx”. Volte para a APP, com uma conexão bem-sucedida. O dispositivo adicionado com sucesso será exibido na página inicial. Em seguida, você pode clicar no ar condicionado para operar.

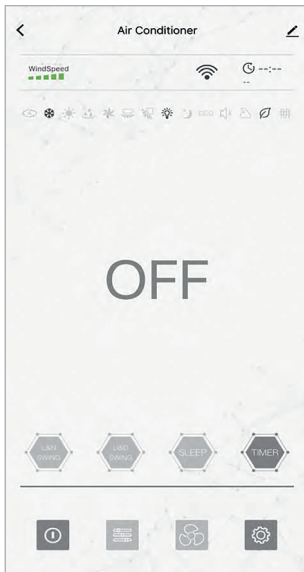

Ar Condicionado Desligado



Ar Condicionado Ligado



Compartilhar dispositivo: clique em “” na página inicial e clique em “Share Device”.

Dispositivo remoto

Opere da seguinte maneira:

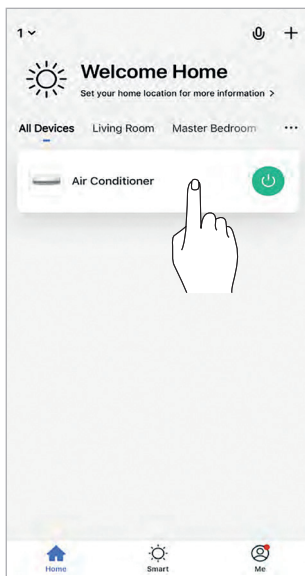

1. Clique em “Air Conditioner” para entrar na interface de controle.

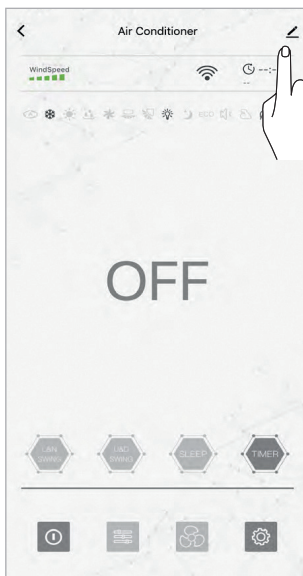

2. Clique em “✎”.

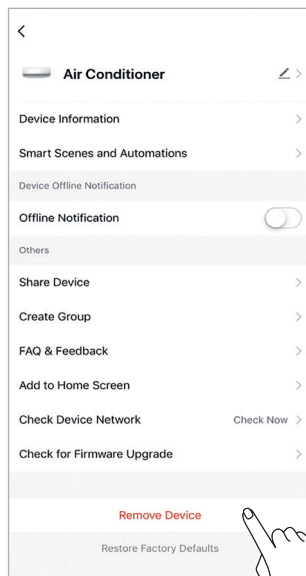

3. Clique em “Remove Device”.

giatsu

ITALIANO

MANUALE DI UTENTE

SMART APP

Smart APP Manuale di utente

- Assicurati che il tuo telefono (tablet PC) deve connettersi al Wi-Fi durante il funzionamento.
- Dopo l'associazione, si controlla il condizionatore d'aria tramite APP sotto la connessione di rete mobile o Wi-Fi.



1. Scansiona il codice QR per installare l'APP

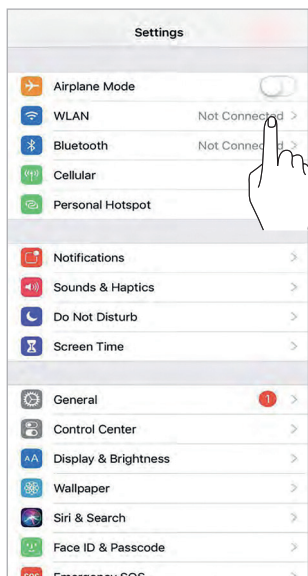

2. Attiva il Wi-Fi e connettiti a Internet.

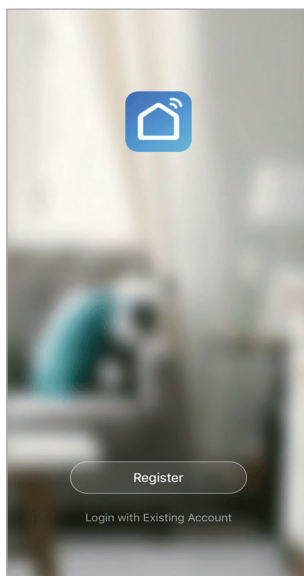

3. Apri l'applicazione. I nuovi utenti operano in base alle istruzioni di sistema per la registrazione. I vecchi utenti inseriscono account e password per accedere.

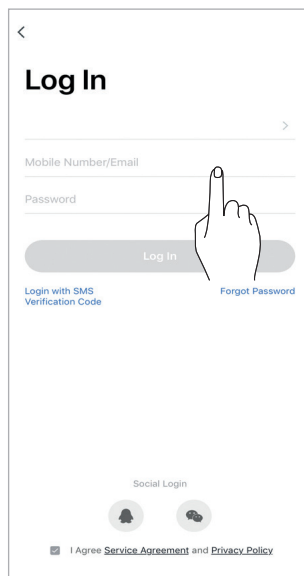

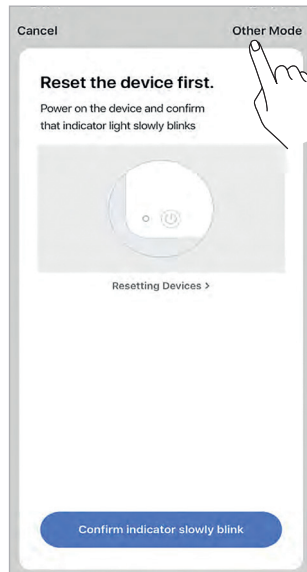
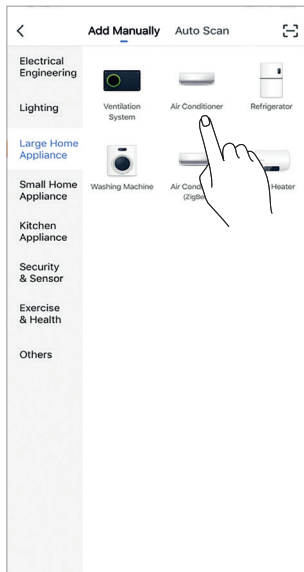
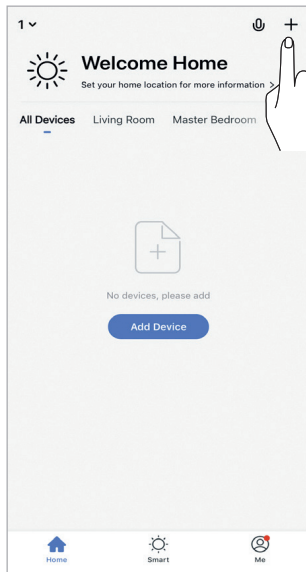

4. Dopo aver effettuato l'accesso, fai clic su “+”. Cerca “Air Conditioner” dall'elenco dei prodotti e aggiungilo.

5. Fai clic su “Other Mode”.

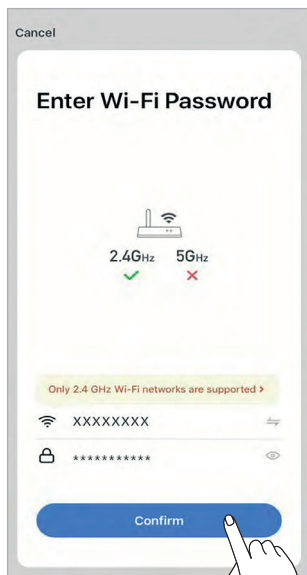
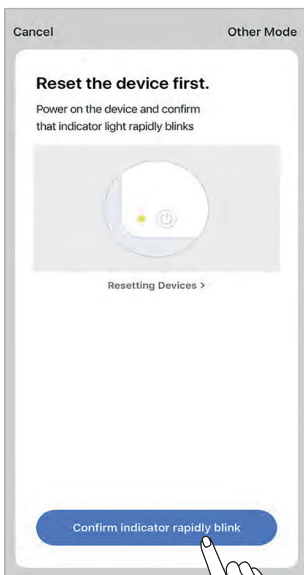
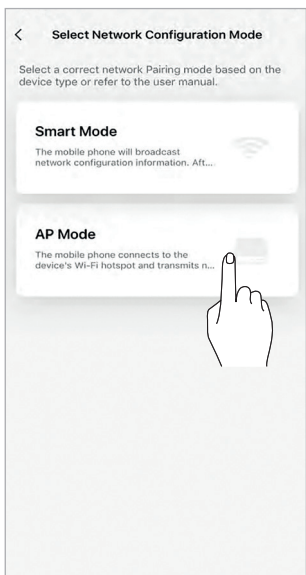

6. Fare clic su “AP Mode” Premere e tenere premuto il “” tasto sul telecomando per 3 ~ 5 secondi. Dopo il pannello frontale appare “A2”, fare clic su APP “Confirm Indicator slowly blinks”.

7. Fai clic su “Confirm” dopo aver inserito la password.

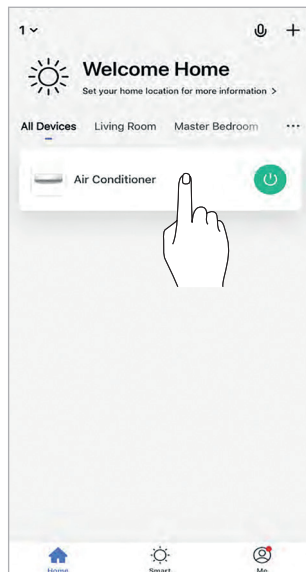
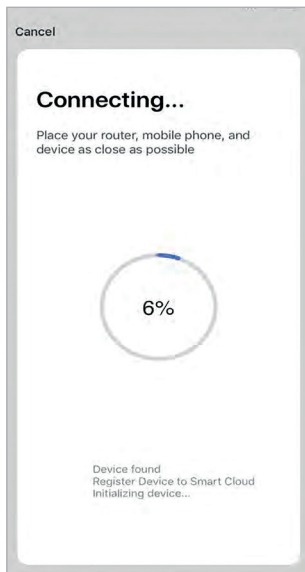
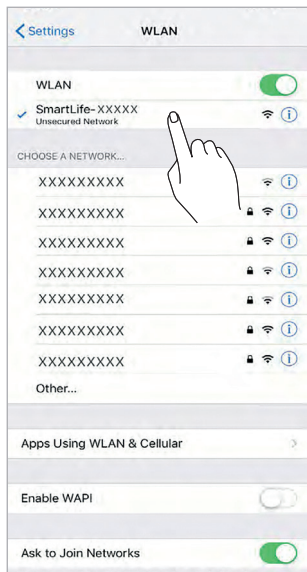

8. Seleziona e collega “Smart Life-xxx” Torna all’APP, con una connessione riuscita. Il dispositivo aggiunto correttamente verrà visualizzato nella home page, quindi è possibile fare clic sul condizionatore d’aria per operare.

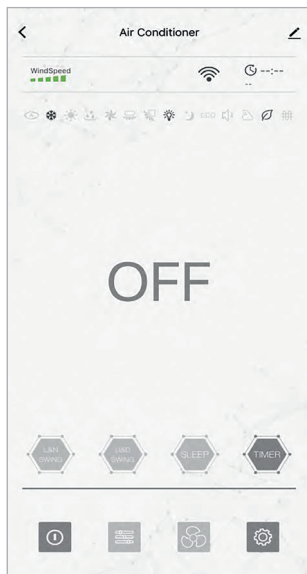

Condizionatore d’aria spento

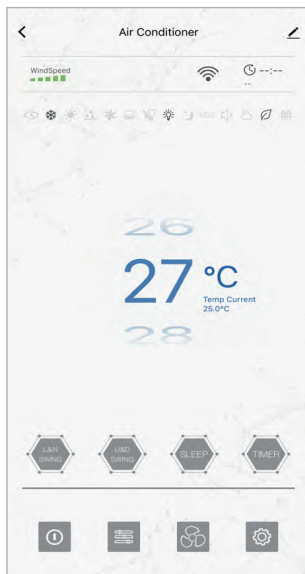

Condizionatore d’aria acceso



Condividi dispositivo: fai clic su “” nella home page, quindi fai clic su “Share Device”.

Dispositivo remoto

Operare come segue:

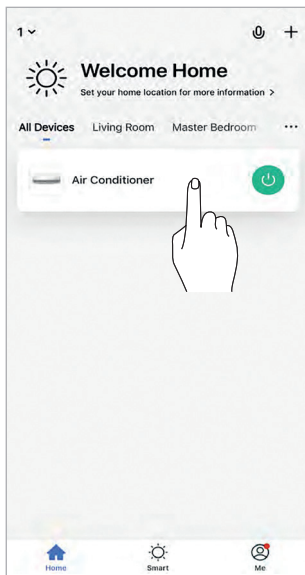

1. Fare clic su "Air Conditioner" per accedere all'interfaccia di controllo.

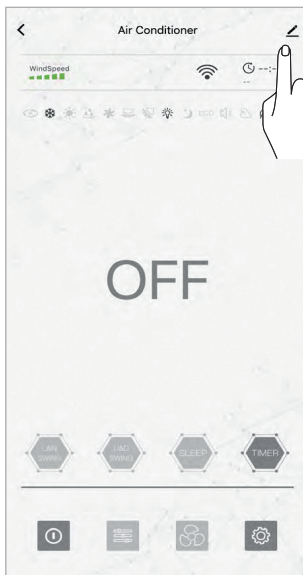

2. Fare clic su "✎".

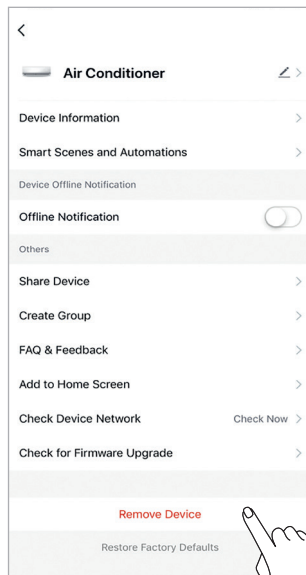

3. Fare clic su "Remove Device".

giatsu

GIA GROUP

C/ Industria, 13, Polígono Industrial El Pedregar. 08160 Montmeló. Barcelona (España)

Tel (0034) 93 390 42 20 - Fax (0034) 93 390 42 05

info@giatsu.com - www.giatsu.com

FRANCE

info.fr@giatsu.com

PORTUGAL

info.pt@giatsu.com

ITALIA

info.it@giatsu.com



ADVERTENCIAS PARA LA ELIMINACIÓN CORRECTA DEL PRODUCTO SEGÚN ESTABLECE LA DIRECTIVA EUROPEA 2002/96/EC.

Al final de su vida útil, el producto no debe eliminarse junto a los residuos urbanos. Debe entregarse a centros específicos de recogida selectiva establecidos por las administraciones municipales, o a los revendedores que facilitan este servicio. Eliminar por separado un aparato eléctrico o electrónico (WEEE) significa evitar posibles consecuencias negativas para el medio ambiente y la salud derivadas de una eliminación inadecuada y permite reciclar los materiales que lo componen, obteniendo así un ahorro importante de energía y recursos. Para subrayar la obligación de eliminar por separado el aparato, en el producto aparece un contenedor de basura móvil listado.

IMPORTANT INFORMATION FOR CORRECT DISPOSAL OF THE PRODUCT IN ACCORDANCE WITH EC DIRECTIVE 2002/96/EC.

At the end of its working life, the product must not be disposed of as urban waste. It must be taken to a special local authority differentiated waste collection centre or to a dealer providing this service. Disposing of a household appliance separately avoids possible negative consequences for the environment and health deriving from inappropriate disposal and enables the constituent materials to be recovered to obtain significant savings in energy and resources. As a reminder of the need to dispose of household appliances separately, the product is marked with a crossed-out wheeled dustbin.

AVERTISSEMENTS POUR L'ÉLIMINATION CORRECTE DU PRODUIT AUX TERMES DE LA DIRECTIVE 2002/96 / CE.

Au terme de son utilisation, le produit ne doit pas être éliminé avec les déchets urbains. Le produit doit être remis à l'un des centres de collecte sélective prévus par l'administration communale ou auprès des revendeurs assurant ce service. Éliminer séparément un appareil électroménager permet d'éviter les retombées négatives pour l'environnement et la santé dérivant d'une élimination incorrecte, et permet de récupérer les matériaux qui le composent dans le but d'une économie importante en termes d'énergie et de ressources. Pour rappeler l'obligation d'éliminer séparément les appareils électroménagers, le produit porte le symbole d'un caisson à ordures barré.

ADVERTÊNCIA PARA A ELIMINAÇÃO CORRECTA DO PRODUCTO SEGUNDO ESTABELECIDO PELA DIRECTIVA EUROPEIA 2002/96/EC

No final da sua vida útil, o produto não deve ser eliminado juntos dos resíduos urbanos. Há centros específicos de recolha selectiva estabelecidos pelas administrações municipais, ou pelos revendedores que facilitam este Serviço. Eliminar em separado um aparelho electrónico (WEEE) significa evitar possíveis consequências negativas para o meio ambiente e para a saúde, derivado de uma eliminação incorrecta, pois os materiais que o compõem podem ser reciclados, obtendo assim uma poupança importante de energia e de recursos. Para ter claro que a obrigação que se tem que eliminar o aparelho em separado, na embalagem do aparelho aparece o símbolo de um contentor de lixo.

AVVERTENZE PER L'ELIMINAZIONE DEL PRODOTTO SECONDO QUANTO PREVISTO DALLA DIRETTIVA EUROPEA 2002/96/EC.

Al termine della loro vita utile, il prodotto non deve essere eliminata insieme ai rifiuti urbani. Deve essere consegnato a centri specifici di raccolta selettiva stabiliti dalle amministrazioni comunali o rivenditori che forniscono questo servizio. Eliminare separatamente un apparecchio elettrico o elettronico (WEEE) significa evitare eventuali conseguenze negative per l'ambiente e la salute derivanti da uno smaltimento inadeguato e consente di recuperare i materiali che lo compon-gono, ottenendo così un importante risparmio di energia e risorse. Per sottolineare l'obbligo di eliminare separatamente.

K4910000753