

**drive**

**DeVilbiss®**  
HEALTHCARE



**TW017**

**Instruction Manual**

**UK**

# Introduction

**Important:** Please read all of these instructions fully before assembly or use of the Tri-Walker.

The Drive DeVilbiss Tri-Walker with seat is suitable for everyday indoor and outdoor use, and is portable whilst offering stability and security to the user.

All Drive DeVilbiss Tri-Walkers are manufactured to the highest quality standards and are marked as Medical Devices.

The Tri-Walker with seat provides a robust and visually appealing product whilst being a cost effective solution to some mobility problems.

The Tri-Walker comes with 7.5" (19cm) diameter wheels with solid grey tyres, and features arthritic loop-lock cable brakes.

The Tri-Walker features pannier bags which fold with the Tri-Walker, when not in use.

## Intended Use

A walking aid manipulated by both arms to assist a person to maintain stability and balance whilst walking.

Ensure the Tri-Walker is only used as an aid for mobility. The Tri-Walker must not be used as a transportation device.

The Tri-walker can support mobility impaired users up to 115 kg (18 st).

The Tri-Walker is designed for occasional and frequent use and can be used both indoors and outdoors, on level surfaces.

Contraindications:

- Weighing in excess of 115 kg (18 st)
- Unable to adequately manoeuvre

Others may be specific to an individual or care environment.

# Personal Safety

For your health and comfort make sure that you adopt a comfortable posture and that you can operate the brakes with ease. Ensure that the handles are at equal heights and securely locked in position.

Ensure the Tri-Walker is always fully unfolded and locked in position before use.

Ensure that all the wheels are stable and are on the ground. Check that the brakes are working properly before using the Tri-Walker.

Ensure that the latest health and safety practice is used for carrying and lifting items, such as wheeled Tri-Walkers.

Do not overload the pannier bags. Distribute the weight evenly between the two bags.

Avoid travelling across a slope, as there is a risk that the Tri-Walker may fall over sideways.

For more information, or assistance with use and maintenance, please contact your provider.

# Parts Description



# Transportation and Assembly

## 1. Assembling the Tri-Walker



Unpack the Tri-Walker and place the wheels on the floor.

Pull the Tri-Walker apart until an audible click is heard. This will signal that the frame is secure.

## 2. Inserting the Handlebars



Insert the handlebars into the frame, as shown in the photo on the left. Repeat for the other handlebar.

Insert the bolts into the holes in the frame, (from the inside) ensuring that the head locates fully into the slot.

Attach the tightening handles to the bolts by rotating them clockwise.

# Transportation and Assembly

## 3. Setting the Handlebar Height

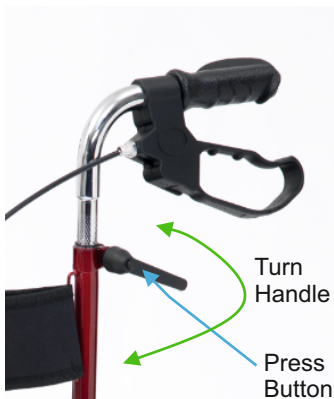

Raise or lower the handlebar to the required height.

Turn the tightening handle clockwise to secure the handlebar at that height. Press the button and rotate the handle so that it is facing downwards.

Repeat for the other handlebar.

Note: Ensure that both handlebars are at the same height and facing backwards, at the same angle.

## 4. Unfolding the Tri-Walker

To fully unfold the Tri-Walker, push the handlebars away from each other until you hear a 'click', which indicates that the folding mechanism is locked in position.

## 5. Folding the Tri-Walker

To fold the Tri-Walker for transportation or storage, pull the strap, located in the centre of the seat, to release the locking mechanism. The handlebars can then be pushed together to fold the Tri-Walker.

## Brake Operation

To operate the brakes:

Squeeze both brake levers up (as indicated by the grey arrow in the image below) to engage the brakes, to slow the Tri-Walker down whilst moving. Release the levers to release the brakes.

To apply the parking brakes:

Push down on the brake levers (as indicated by the black downwards arrow in the image below) until they lock in position.

To release the parking brakes:

Pull up on the brake levers (as indicated by the black upwards arrow in the image below) until the lock removes.

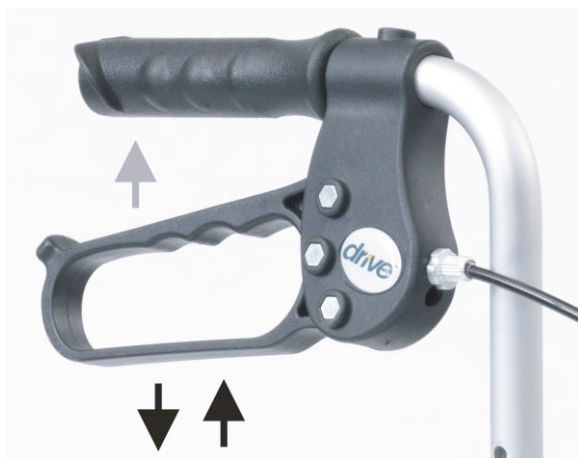

### **Warning!**

Ensure that the brakes are locked on before sitting on the seat.

Note:

The brakes on the Tri-Walker are factory set and should not require adjustment. For technical assistance on the Tri-Walker brakes, contact your Drive DeVilbiss dealer.



## Care and Maintenance

- Ensure the Tri-Walker is kept clean. Wipe down the Tri-Walker with a damp cloth and then dry thoroughly.
- Do not use any abrasive detergents. Solvents can damage the coating and surface of plastic parts.
- Store the Tri-Walker in a dry place and ensure that it is clean and dry before storing.
- Check the moving parts (e.g. wheels and castor) regularly.
- Check that the tightening handles and all fasteners (screws, nuts and bolts) are securely tightened.
- Ensure that both cable brakes are adjusted correctly. If they are not, please do not use the Tri-Walker and contact your dealer for advice.
- Inspect the central locking mechanism regularly to ensure that it is operating correctly.
- If maintained correctly, the Tri-Walker has an expected life of 5 years.
- At the end of the product's useful life, follow local recycling / disposal policies.
- Any serious incident that has occurred in relation to this device should be reported to the manufacturer and the MHRA.

# Specification

The Tri-Walker has a lightweight steel frame with a resting seat, 7.5" (19cm) diameter wheels with grey tyres, arthritic friendly cable brakes and pannier bags.

Models	TW017BL (Blue) TW017R (Red) TW017SI (Silver)
Dimensions	82-99cm H x 64 cm W x 57cm D (32"-39" H x 25" W x 22.5" D)
Seat Height	53 cm (21")
Seat Width	44 cm (17")
Seat Depth	28 cm (11")
Weight including bags	7 kg (15 lb)
Max User Weight	115 kg (18 st)



Ralon Medical Equipment Co., Ltd.  
Xilian Development Zone, Danzao,  
Nahai, Foshan, Guangdong, China



Obelis UK Ltd.  
Sandford Gate, East Point Business Park,  
Oxford, OX4 6LB, Great Britain



Drive DeVilbiss Healthcare Ltd.  
Sidhil Business Park, Holmfield,  
Halifax, West Yorkshire, HX2 9TN,  
Great Britain

# Warranty

Your Drive DeVilbiss product is covered by a one year warranty from date of purchase. Drive DeVilbiss will supply replacements for any parts which have failed as a result of a manufacturing, design or material defect. Contact the retailer from which you purchased the Tri-Walker from in the event of you needing to make a claim.

Failures as a result of accidental damage, misuse, modification or wear and tear, are not covered by this warranty.

Contact the stockist from whom you purchased the Tri-Walker from to apply the warranty.

For full warranty conditions, contact your Drive DeVilbiss stockist or visit:  
[www.drivedevilbiss.co.uk](http://www.drivedevilbiss.co.uk)

This does not affect your statutory rights.

# Symbol Definitions



Manufacturer



Date of Manufacture



Consult the Instructions for Use



Medical Device



Importer



UK Responsible Person



Maximum User Mass

The Team at Drive DeVilbiss develops its products to give our customers the freedom to live independently. This encompasses their daily home life and provides them with the opportunity to enjoy an outing with family and friends. Our goal is to develop a range that will provide individuals with a chance to enjoy everyday life.

Dealer Stamp



Drive DeVilbiss Healthcare Ltd.  
Sidhill Business Park, Halifax, West Yorkshire,  
HX2 9TN, United Kingdom

Tel: 0845 0600 333

Email: [info@drivedevilbiss.co.uk](mailto:info@drivedevilbiss.co.uk)

[www.drivedevilbiss.co.uk](http://www.drivedevilbiss.co.uk)