

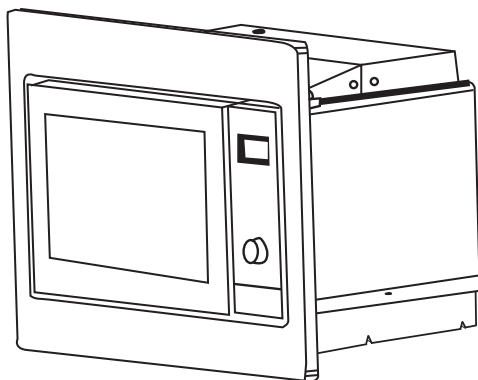

INSTRUCCIONES DE INSTALACION

Por favor lea atentamente el libro antes de la instalación.



Tornillo de ajuste A — 

Tornillo B — 

Cubierta de plástico del panel frontal — 

BLOQUE DE PIES — 

ALMOHADILLA DE GOMA — 

SOPORTE — 

NOTA IMPORTANTE

Conexión Eléctrica

El microondas viene con un enchufe macho que debe ser enchufado en bases de enchufe con conexión a tierra. En cumplimiento de la normativa vigente, tanto la conexión eléctrica como la sustitución del cable sólo puede ser llevado a cabo por un técnico especializado.

A. Huevo de encastre

El hueco para la instalación no debe tener una pared detrás. La altura mínima para la instalación es de 85 cm.

No tape las salidas de ventilación del aparato ni los otros puntos de entrada de aire.

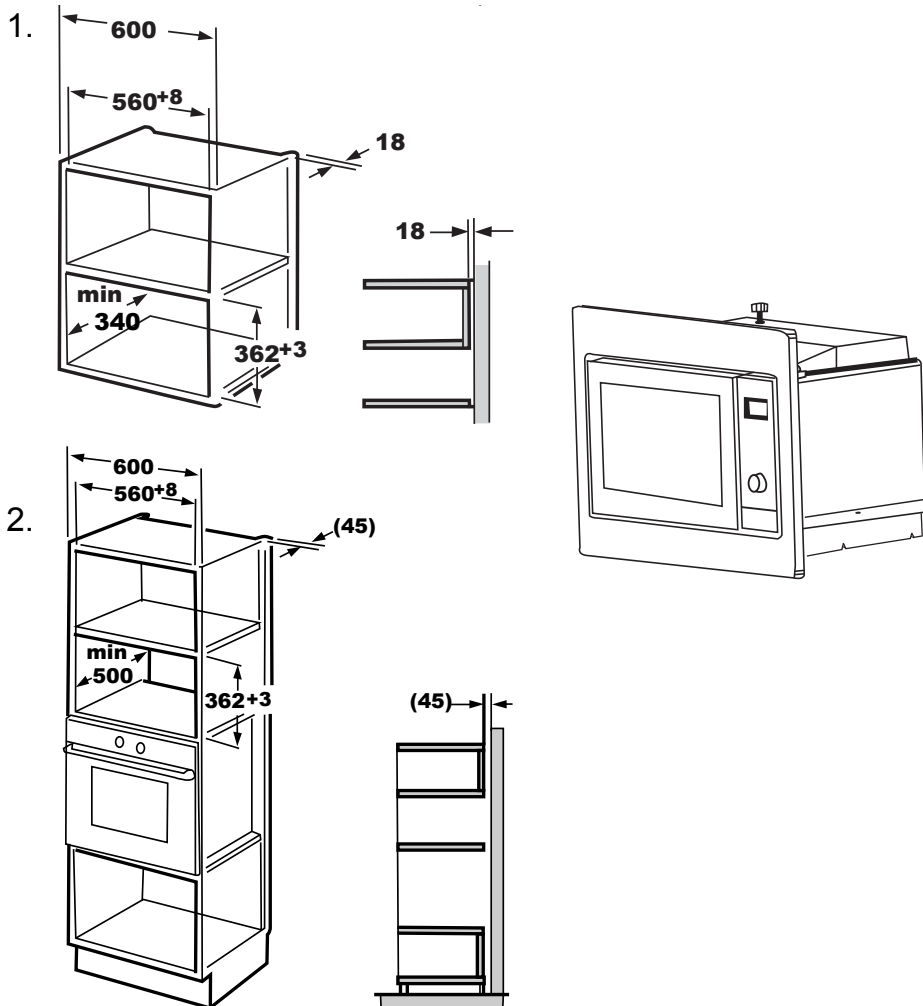

B. Instalar el Microondas

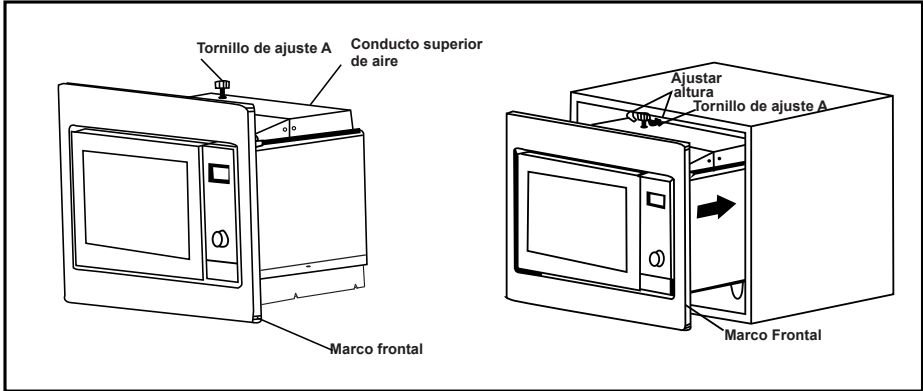

1. Apriete el TORNILLO DE AJUSTE A al CONDUCTO SUPERIOR DE AIRE del del microondas y fije el marco con los TORNILLOS B.

2. Coloque el microondas en el mueble correspondiente.

- Ajuste la altura del TORNILLO DE AJUSTE A de forma que quede una distancia de 1 mm entre el tornillo anteriormente mencionado y la parte superior del mueble.
- No atrape ni doble el cable eléctrico
- Asegúrese de que el horno quede inst alado en el centro del hueco.

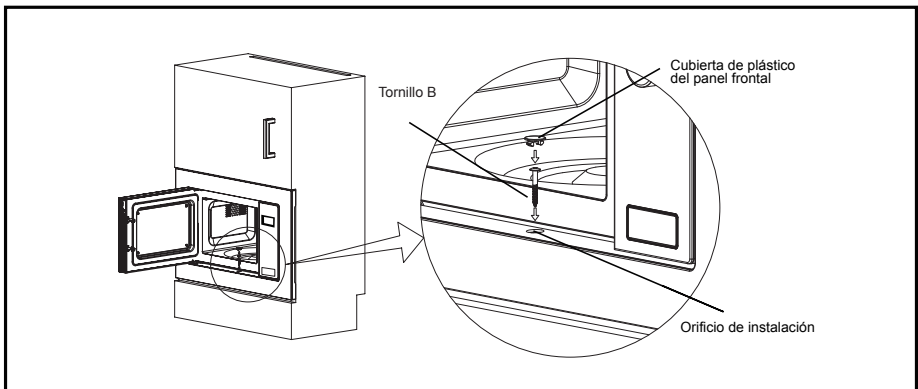

3. Abra la puerta, fije el microondas al mueble introduciendo el TORNILLO B en el AGUJERO PARA INSTALACION del MARCO Después, fije la CUBIERTA DE PLÁSTICO DEL PANEL FRONTAL al ORIFICIO DE INSTALACIÓN.

Para el mueble con una altura de 370mm

A. Mueble empotrado

El mueble empotrado no debe tener un panel trasero detrás del electrodoméstico.
La altura mínima de instalación es de 85cm.
No cubra las ranuras de ventilación y los puntos de entrada de aire.

1.

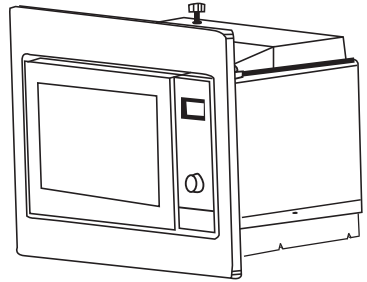
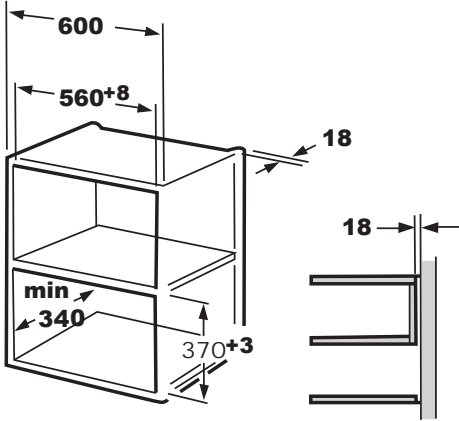

2.

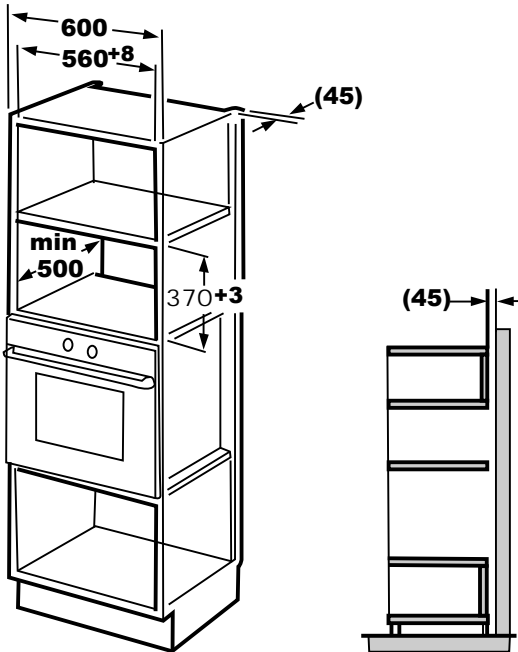

B. Instale el horno

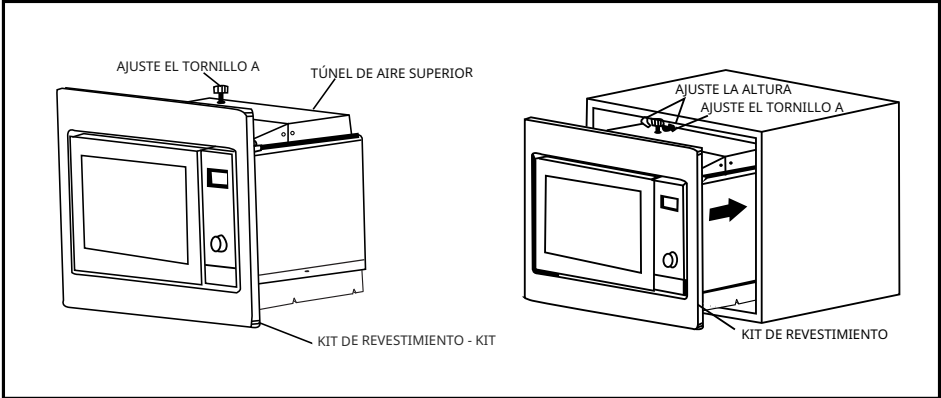
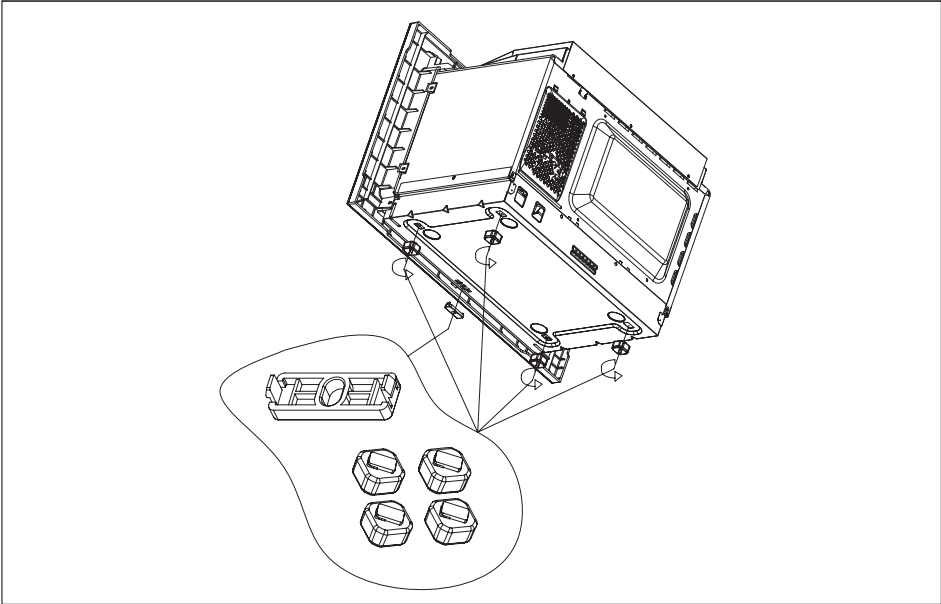

1. Fije el TORNILLO DE AJUSTE A en el TÚNEL DE AIRE SUPERIOR del horno, y luego instale el horno en el gabinete.

- Ajuste la altura del TORNILLO DE AJUSTE A para mantener una brecha de 1mm entre el TORNILLO DE AJUSTE A y el plano superior del mueble.
- No atrape ni doble el cable de alimentación.
- Asegúrese de que el horno esté instalado en el centro del mueble.

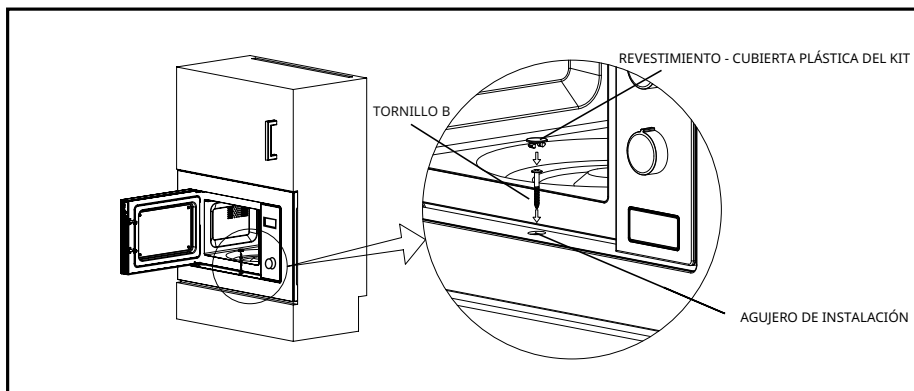

2. Abra la puerta; fije el horno al mueble con el TORNILLO B en el AGUJERO DE INSTALACIÓN del KIT DE REVESTIMIENTO. Luego, fije la CUBIERTA PLÁSTICA DEL KIT DE REVESTIMIENTO al AGUJERO DE INSTALACIÓN.

Para el mueble con una altura de 380 mm

A. Mueble empotrado

El mueble empotrado no debe tener un panel trasero detrás del electrodoméstico.
La altura mínima de instalación es de 85cm.
No cubra las ranuras de ventilación y los puntos de entrada de aire.

1.

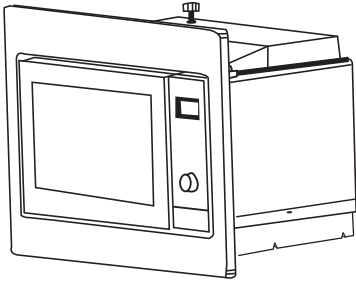
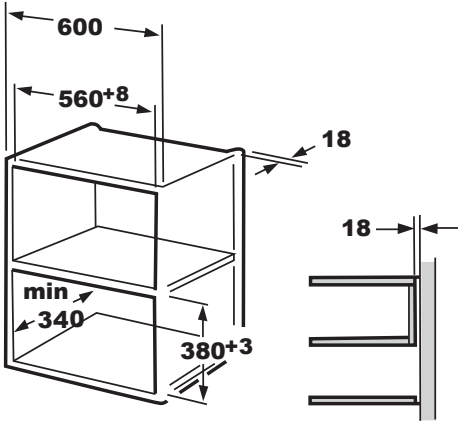

2.

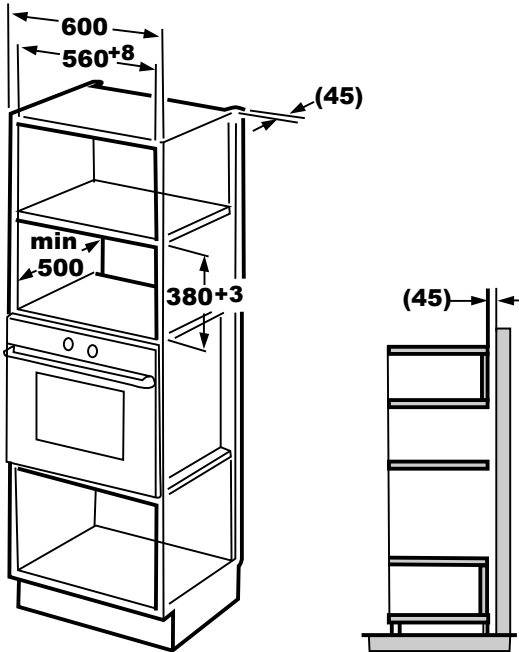

B. Instale el horno

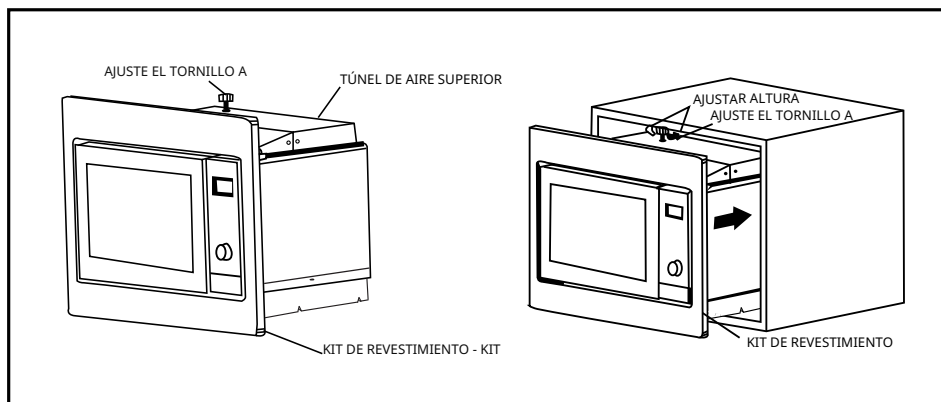
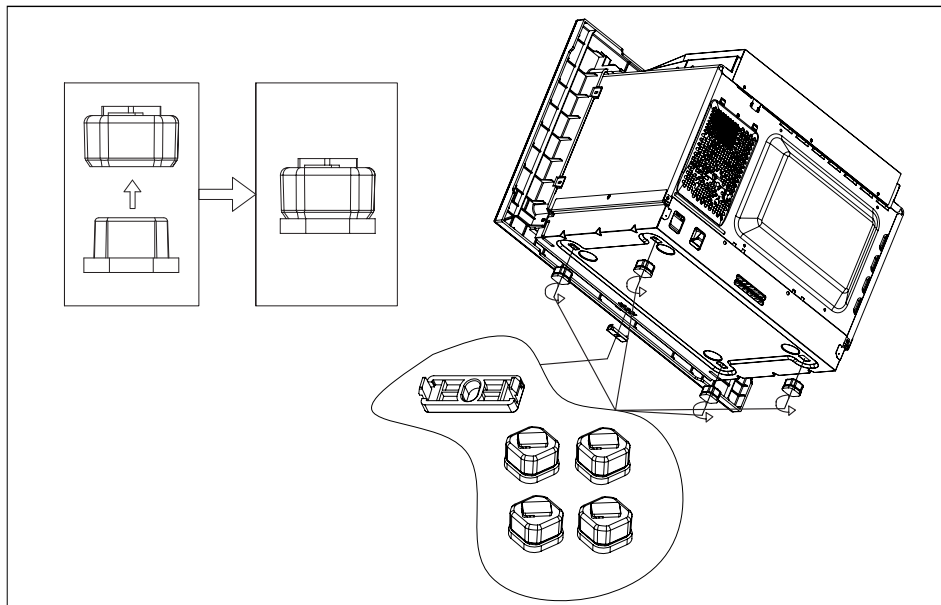

1. Fije el TORNILLO DE AJUSTE A en el TÚNEL DE AIRE SUPERIOR del horno, y luego instale el horno en el gabinete.

- Ajuste la altura del TORNILLO DE AJUSTE A para mantener una brecha de 1 mm entre el TORNILLO DE AJUSTE A y el plano superior del mueble.
- No atrape ni doble el cable de alimentación.
- Asegúrese de que el horno esté instalado en el centro del mueble.

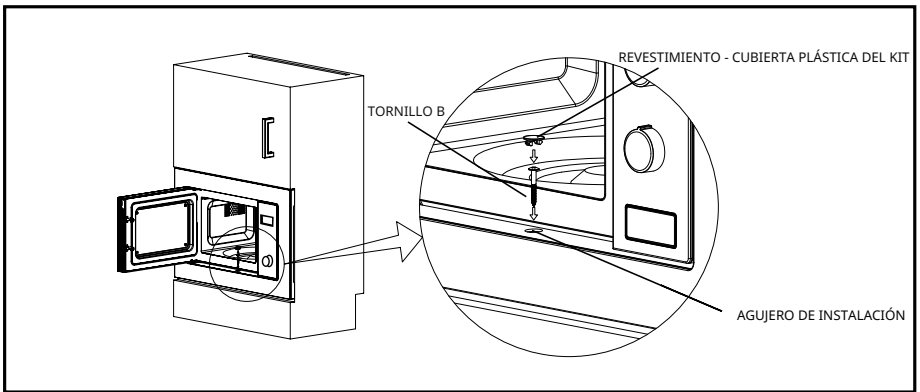

2. Abra la puerta; fije el horno al mueble con el TORNILLO B en el AGUJERO DE INSTALACIÓN del KIT DE REVESTIMIENTO. Luego, fije la CUBIERTA PLÁSTICA DEL KIT DE REVESTIMIENTO al AGUJERO DE INSTALACIÓN.

INSTRUÇÕES DE INSTALAÇÃO

Por favor leia atentamente o manual antes da instalação.

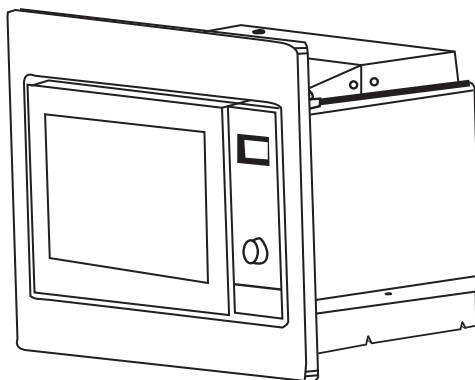
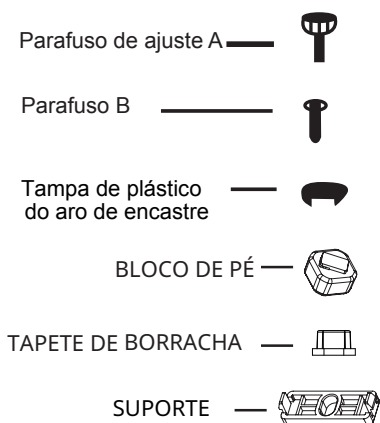

NOTA IMPORTANTE:

Ligação elétrica

O micro-ondas é fornecido com uma ficha e só pode ser conectado a uma tomada com ligação à terra. De acordo com a regulamentação existente, quer a instalação quer a substituição do cabo elétrico caso seja necessário, deverá ser realizado por um técnico qualificado.

A. Encastrar

O espaço previsto para a instalação não deve ter uma parede imediatamente por trás do aparelho. A altura mínima para a instalação é de 85cm

Não feche as saídas para a ventilação do aparelho nem os para pontos de entrada de ar.

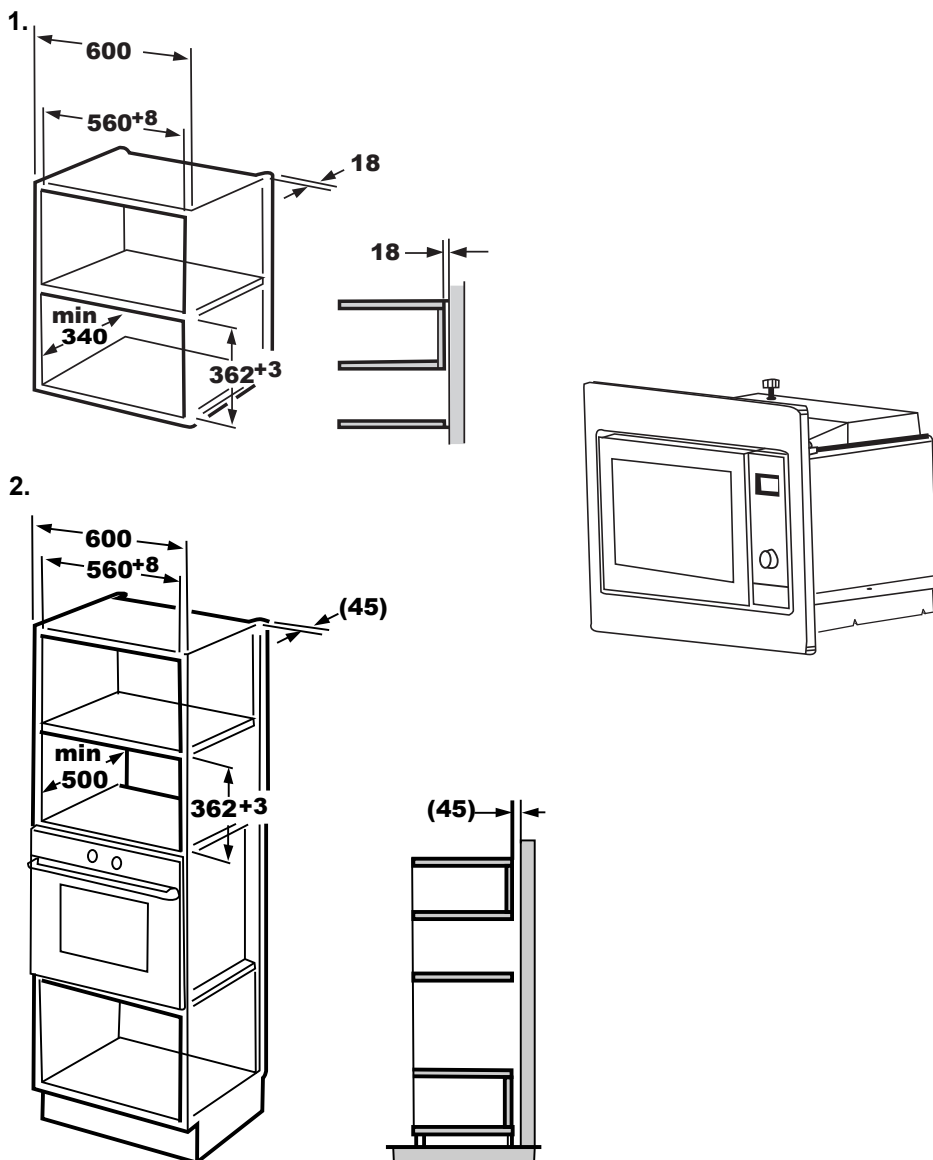

B. Instalar o Microondas

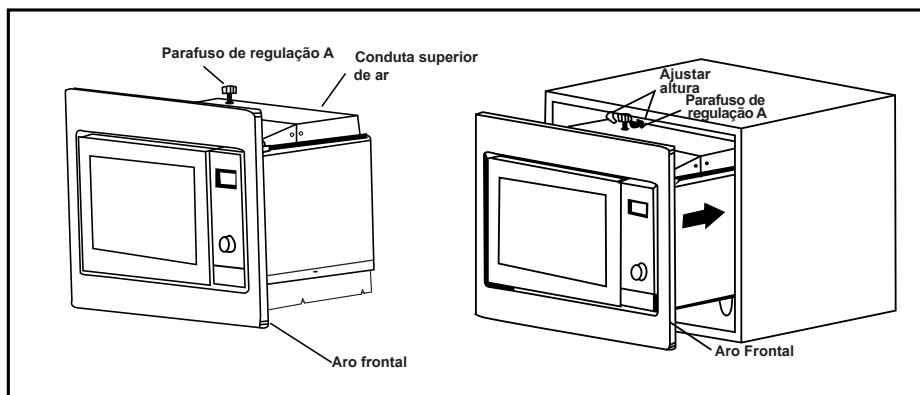

1. Aperte o parafuso de regulação A à conduta superior de ar do micro-ondas e fixe o aro com os parafusos B.
2. Coloque o micro-ondas no respectivo móvel.
 - Ajuste a altura do parafuso de regulação A de forma a deixar uma distância de 1mm entre o parafuso anteriormente mencionado e a parte superior do móvel.
 - Não prenda nem torça o cabo elétrico.
 - Certifique-se que o micro-ondas está instalado no centro da abertura.

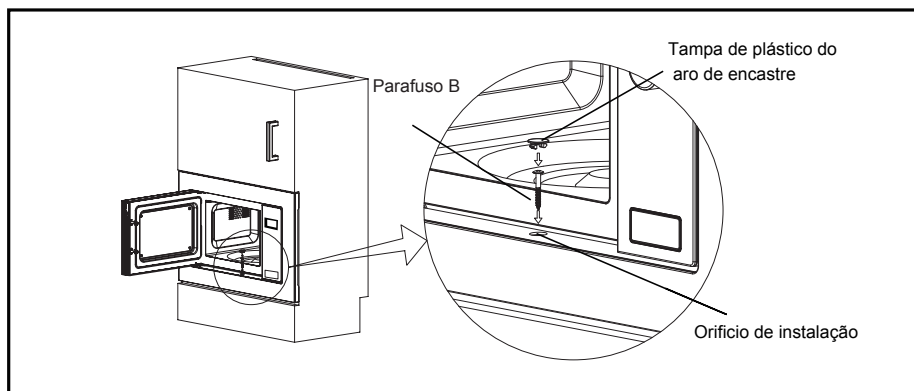

3. Abra a porta; fixe o micro-ondas ao móvel introduzindo o parafuso B no orifício para a instalação do aro de encaixe. De seguida, fixe a tampa de plástico do painel frontal ao orifício de instalação.

Para o armário com uma altura de 370mm

A. Mobiliário embutido

O armário embutido não deve ter uma parede traseira atrás do aparelho.
A altura mínima de instalação é 85cm.

Não cubra as ranhuras de ventilação e os pontos de entrada de ar.

1.

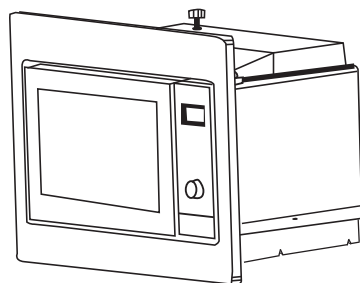
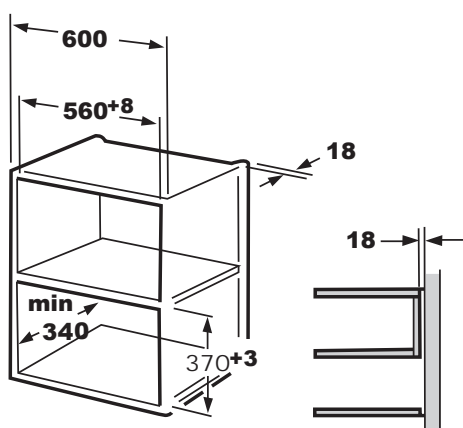

2.

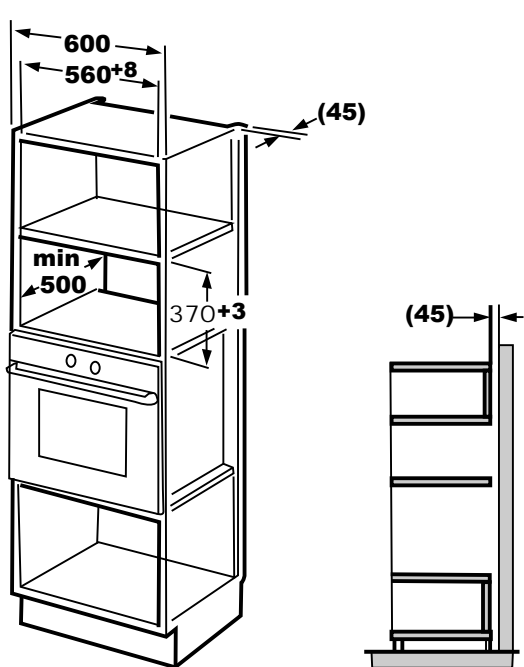

B. Instalar o Forno

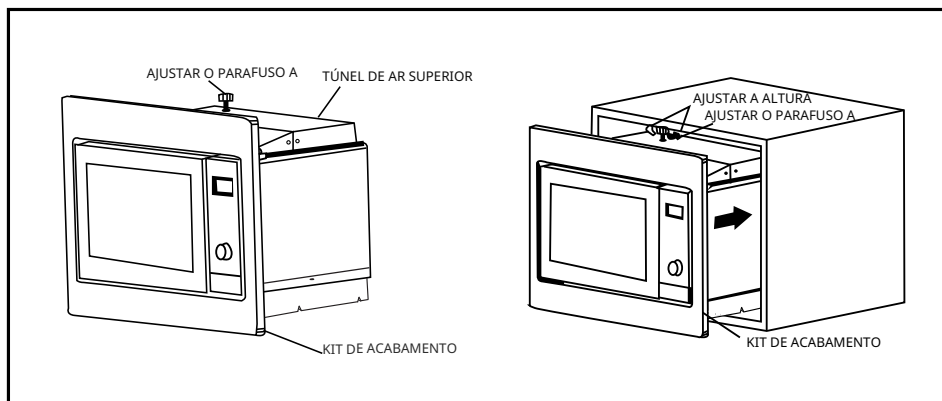
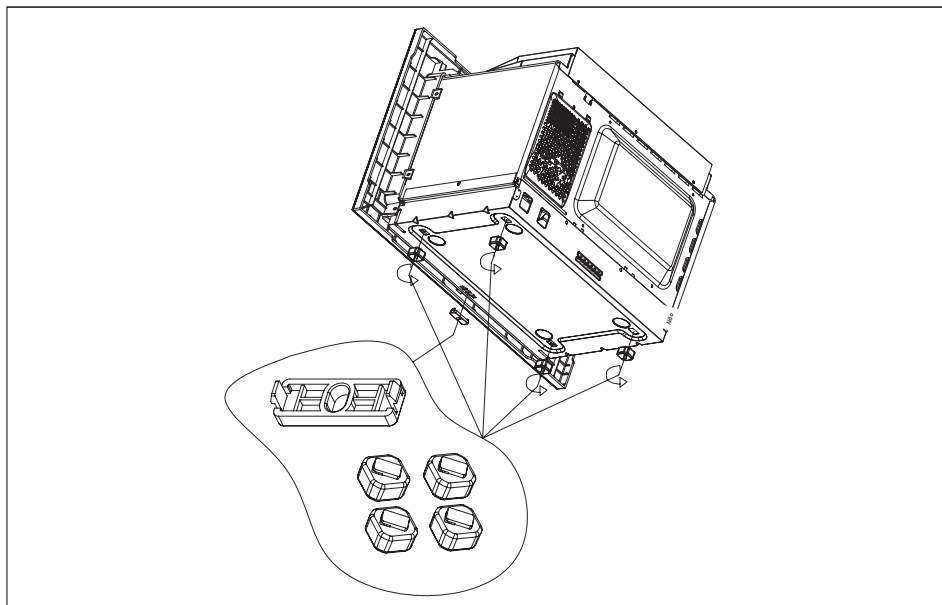

1. Fixe o PARAFUSO DE AJUSTE A no TÚNEL DE AR SUPERIOR do forno e, em seguida, instale o forno no armário.

- Ajuste a altura do PARAFUSO DE AJUSTE A para manter um espaço de 1mm entre o PARAFUSO DE AJUSTE A e a superfície superior do armário.
- Não prenda nem dobre o cabo de alimentação.
- Certifique-se de que o forno está instalado no centro do armário.

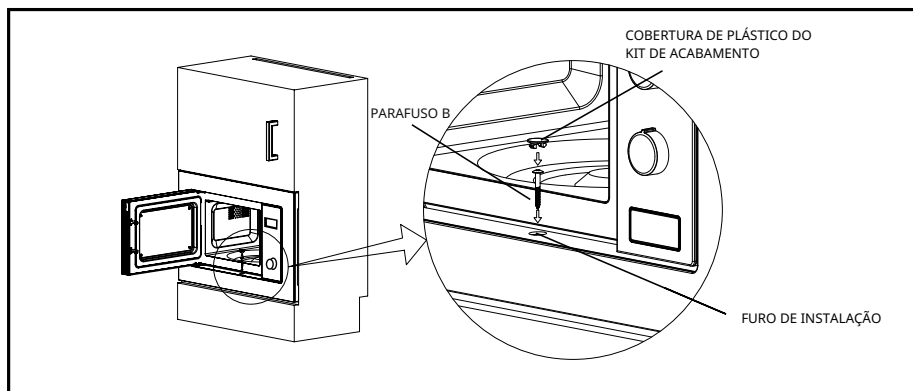

2. Abra a porta; fixe o forno ao armário com o PARAFUSO B no FURO DE INSTALAÇÃO do KIT DE ACABAMENTO. Depois fixe a COBERTURA DE PLÁSTICO DO KIT DE ACABAMENTO ao FURO DE INSTALAÇÃO.

Para armários com altura de 380mm

A. Mobiliário embutido

O armário embutido não deve ter uma parede traseira atrás do aparelho.
A altura mínima de instalação é 85cm.

Não cubra as ranhuras de ventilação e os pontos de entrada de ar.

1.

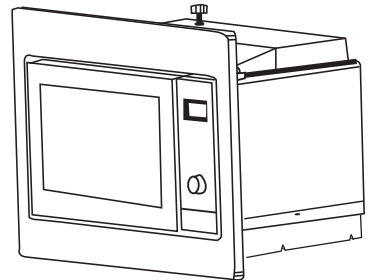
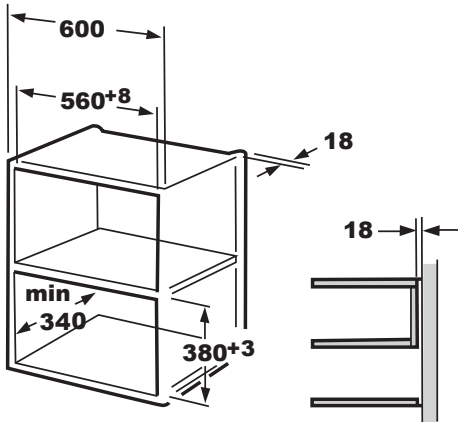

2.

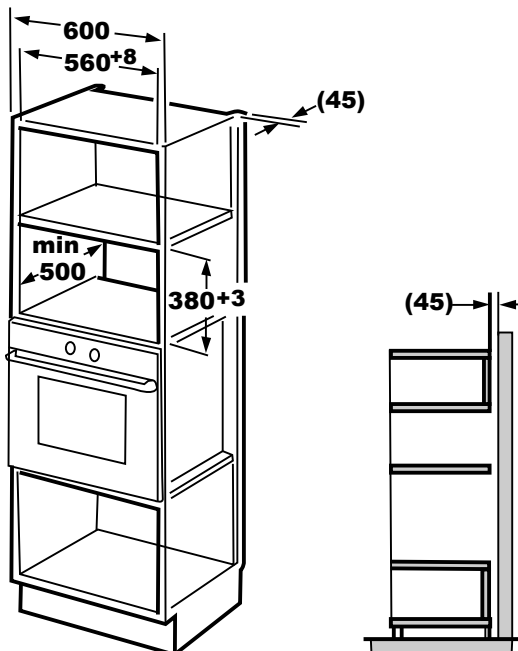

B. Instalar o Forno

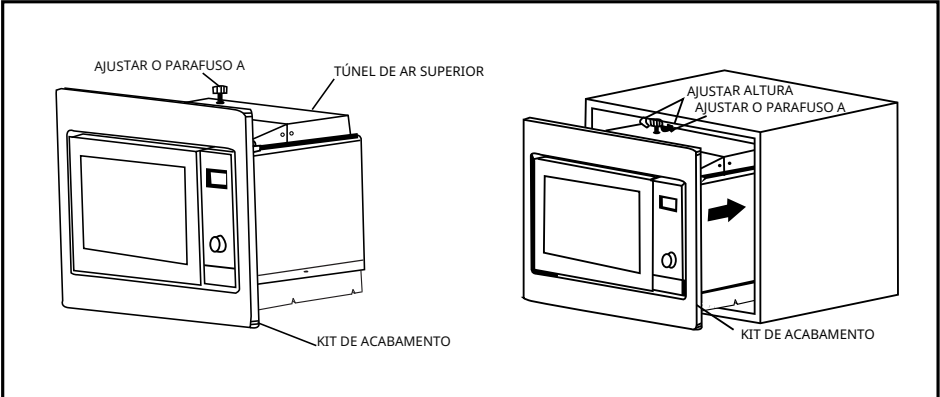
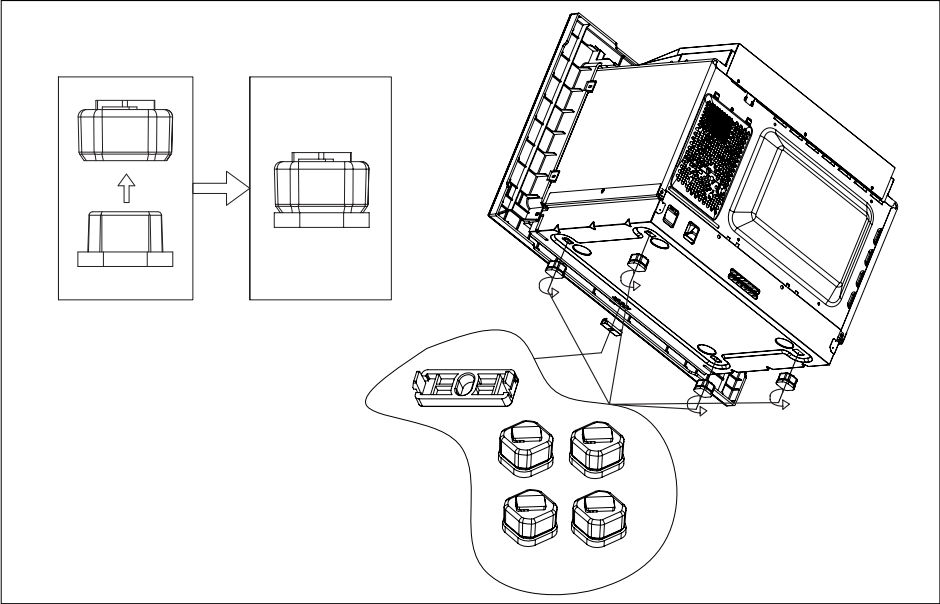

1. Fixe o PARAFUSO DE AJUSTE A no TÚNEL DE AR SUPERIOR do forno e, em seguida, instale o forno no armário.



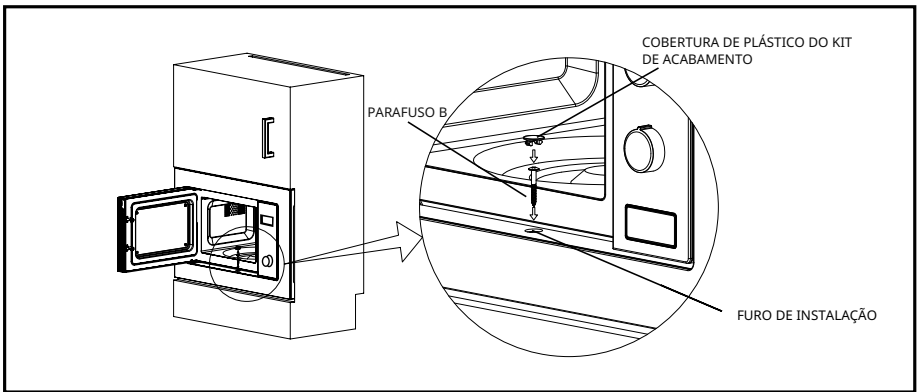



- Ajuste a altura do PARAFUSO DE AJUSTE A para manter um espaço de 1 mm entre o PARAFUSO DE AJUSTE A e a superfície superior do armário.
- Não prenda nem dobre o cabo de alimentação.
- Certifique-se de que o forno está instalado no centro do armário.



2. Abra a porta; fixe o forno ao armário com o PARAFUSO B no FURO DE INSTALAÇÃO do KIT DE ACABAMENTO. Depois fixe a COBERTURA DE PLÁSTICO DO KIT DE ACABAMENTO ao FURO DE INSTALAÇÃO.

Instructions d'installation

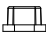
Veillez lire attentivement le manuel avant l'installation

- AJUSTER LA VIS A — 
- VIS B — 
- COUVERCLE EN PLASTIQUE POUR
KIT D'AJUSTEMENT — 
- BLOC DE PATIN — 
- TAPIS EN CAOUTCHOUC — 
- SUPPORT — 

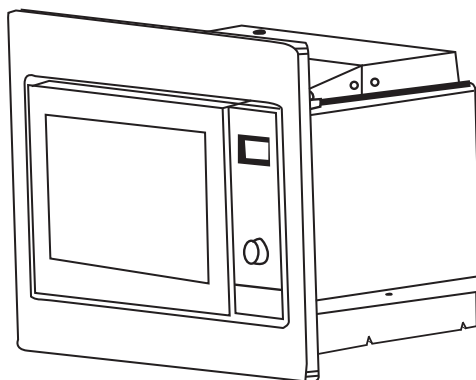

Veillez noter

Connexion électrique

Le four est équipé d'une fiche et ne doit être connecté qu'à une prise de terre correctement installée. Conformément aux réglementations appropriées, la prise ne doit être installée et le câble de connexion ne doit être remplacé que par un électricien qualifié

Si la fiche n'est plus accessible après l'installation, un interrupteur d'isolement tous pôles doit être présent du côté de l'installation avec un écart de contact d'au moins 3 mm.

A. Meubles encastrés

L'armoire encastrée ne doit pas avoir de paroi arrière derrière l'appareil.

La hauteur d'installation minimale est de 85 cm.

Ne pas couvrir les fentes de ventilation et les points d'entrée d'air.

1.

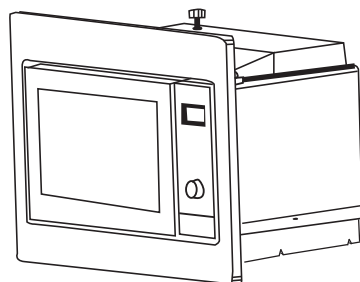
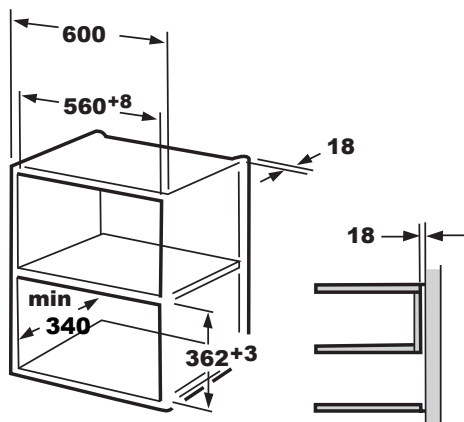

2.

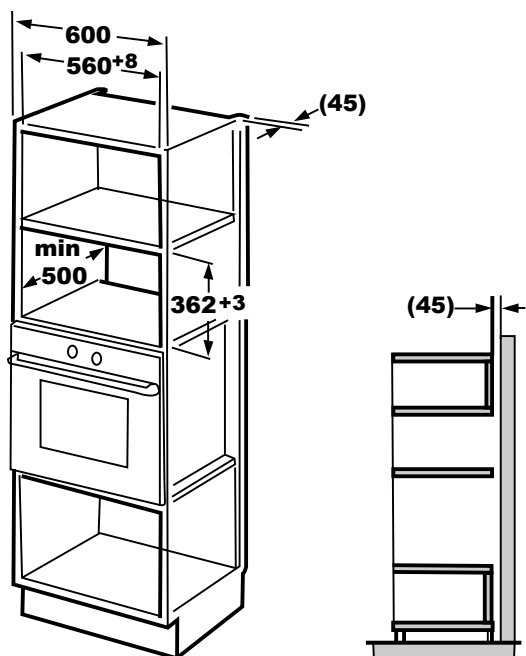

B. Installer le four

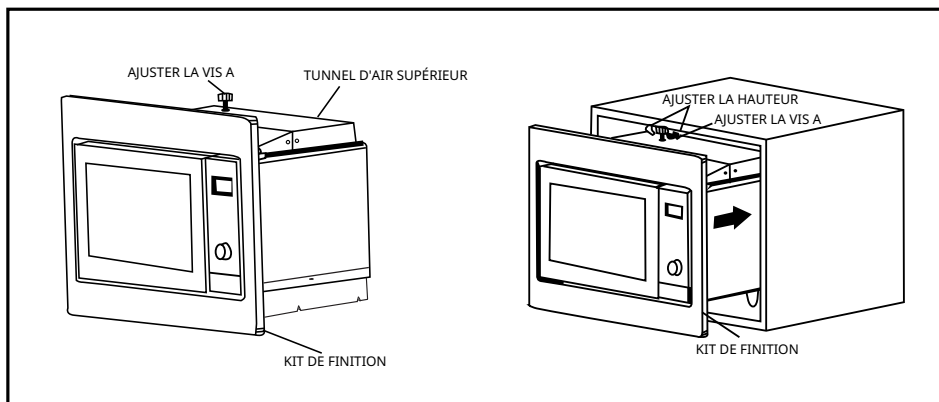

1. Fixez AJUSTER LA VIS A sur le TUNNEL D'AIR SUPÉRIEUR du four, puis installez le four dans l'armoire.

- Ajustez la hauteur de AJUSTER LA VIS A pour maintenir un écart de 1mm entre AJUSTER LA VIS A et le plan supérieur de l'armoire.
- Ne pas piéger ou plier le cordon d'alimentation.
- Assurez-vous que le four est installé au centre de l'armoire.

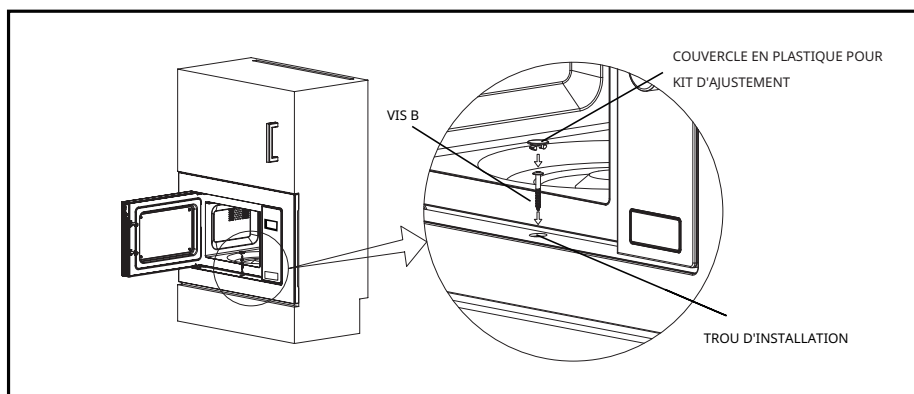

2. Ouvrez la porte ; fixez le four à l'armoire avec la VIS B au TROU D'INSTALLATION DU KIT DE FINITION. Ensuite, fixez le COUVERCLE EN PLASTIQUE DU KIT DE FINITION.

Pour le meuble d'une hauteur de 370 mm

A. Meuble encastré

Le meuble encastré ne doit pas avoir de paroi arrière derrière l'appareil.
La hauteur d'installation minimale est de 85 cm.

Ne pas couvrir les fentes de ventilation et les points d'entrée d'air.

1.

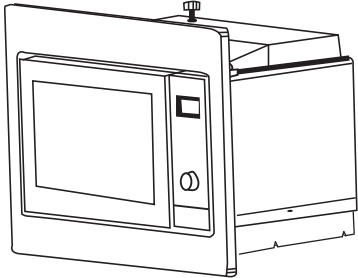
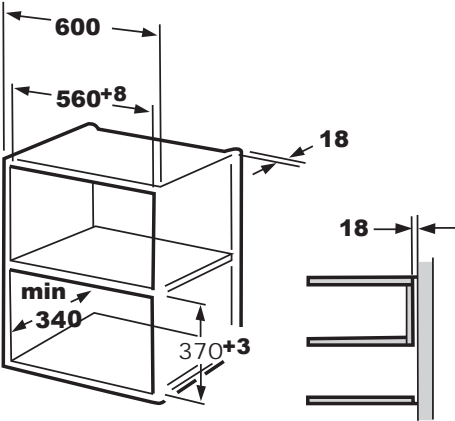

2.

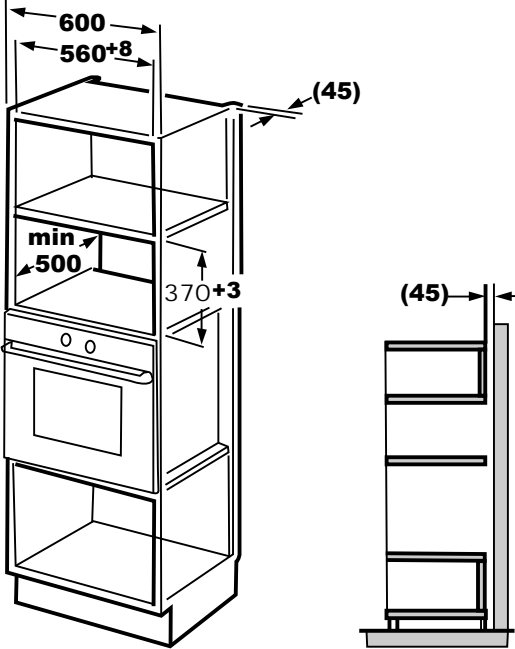

B. Installer le four

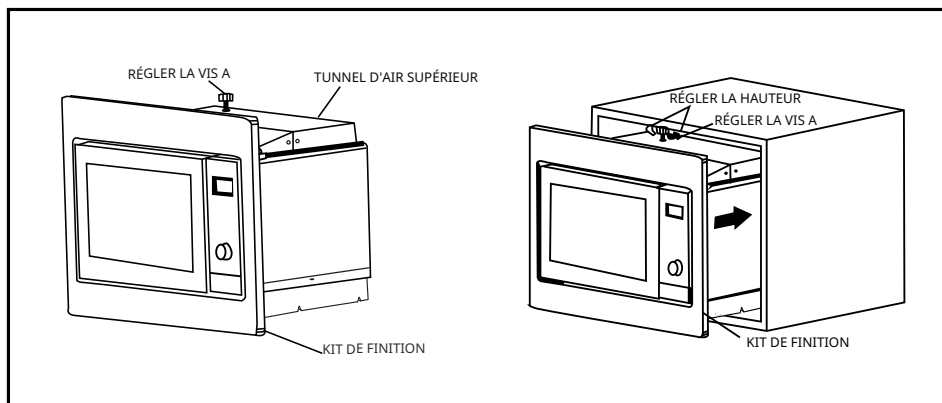
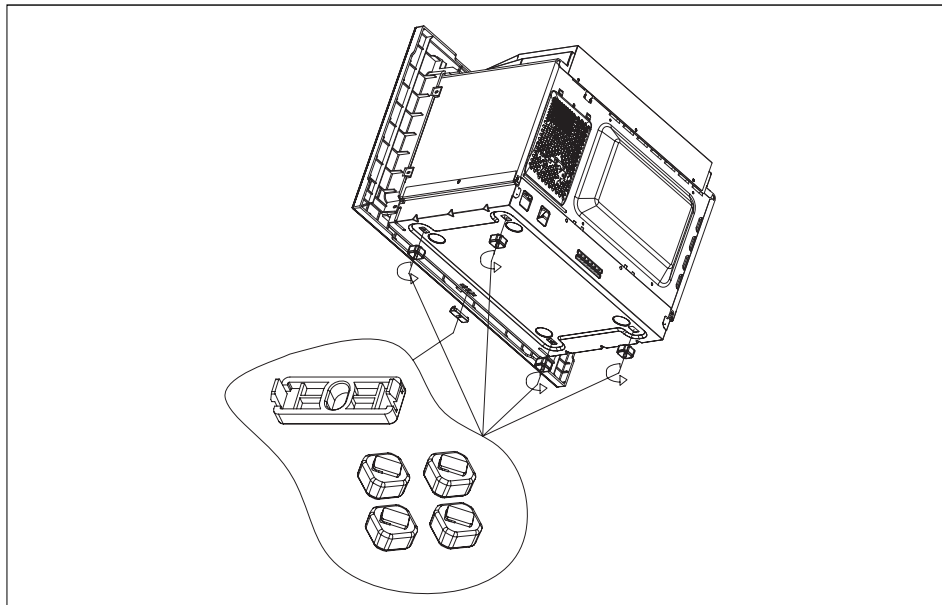

1. Fixez la VIS DE RÉGLAGE A sur le TUNNEL D'AIR SUPÉRIEUR du four, puis installez le four dans le meuble.

- Ajustez la hauteur de la VIS DE RÉGLAGE A pour maintenir un écart de 1 mm entre la VIS DE RÉGLAGE A et la surface supérieure du meuble.
- Ne pas coincer ni plier le cordon d'alimentation.
- Assurez-vous que le four est installé au centre du meuble.

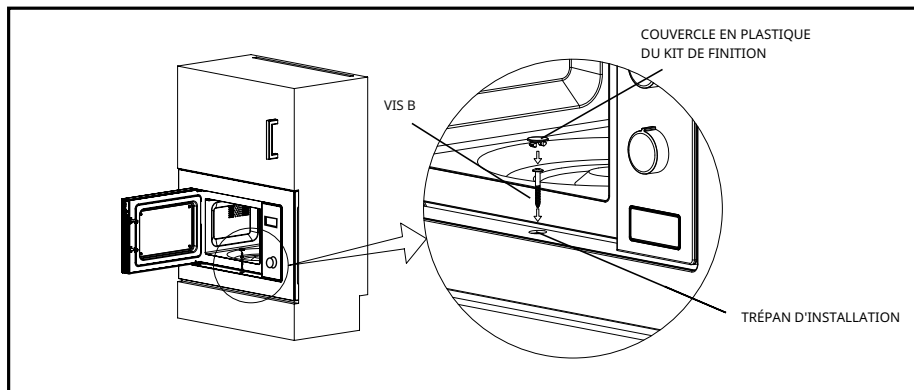

2. Ouvrez la porte ; fixez le four au meuble avec la VIS B au TROU D'INSTALLATION du KIT DE FINITION. Puis fixez le COUVERCLE EN PLASTIQUE DU KIT DE FINITION au TROU D'INSTALLATION.

Pour un meuble d'une hauteur de 380 mm

A. Meuble encastré

Le meuble encastré ne doit pas avoir de paroi arrière derrière l'appareil.

La hauteur d'installation minimale est de 85 cm.

Ne pas couvrir les fentes de ventilation et les points d'entrée d'air.

1.

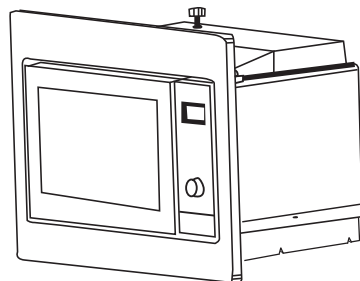
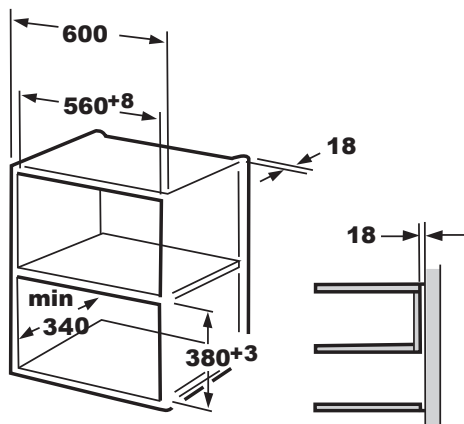

2.

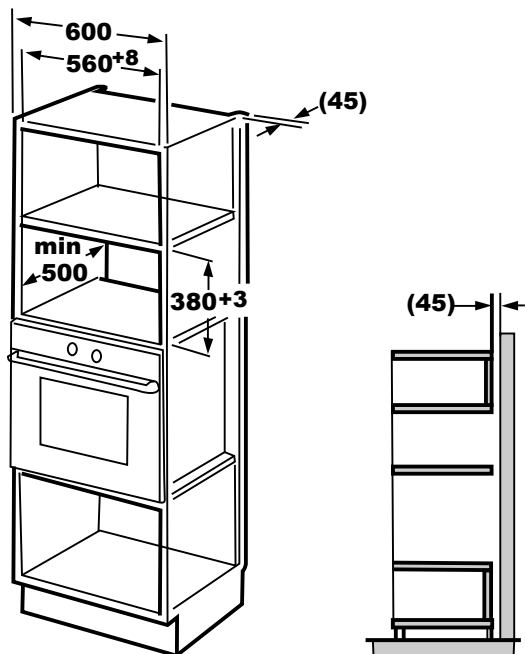

B. Installer le four

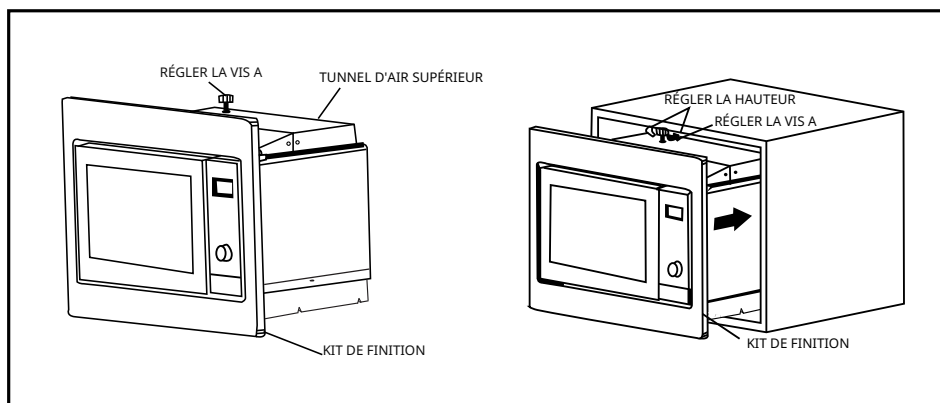
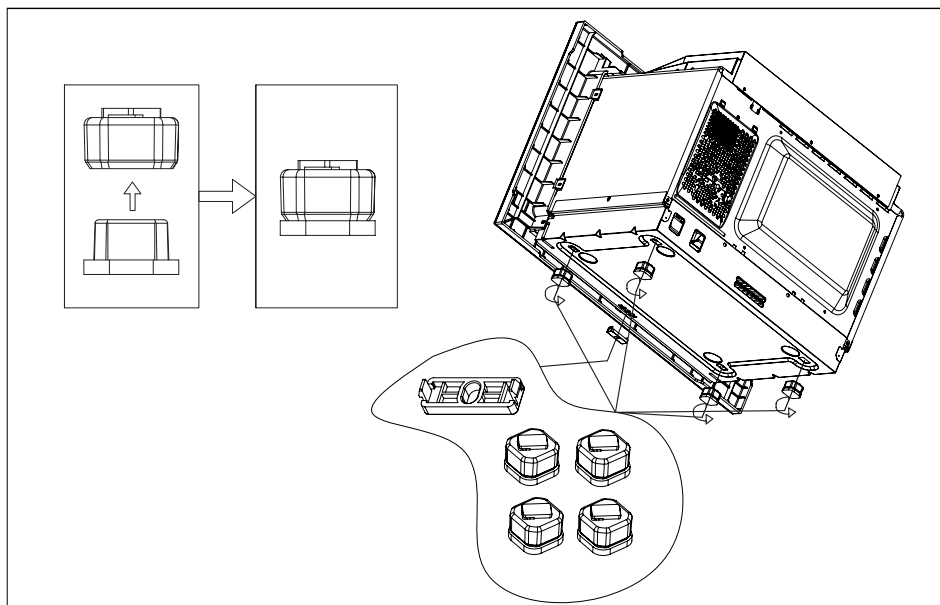

1. Fixez la VIS DE RÉGLAGE A sur le TUNNEL D'AIR SUPÉRIEUR du four, puis installez le four dans le meuble.

- Ajustez la hauteur de la VIS DE RÉGLAGE A pour maintenir un écart de 1 mm entre la VIS DE RÉGLAGE A et la surface supérieure du meuble.
- Ne pas coincer ni plier le cordon d'alimentation.
- Assurez-vous que le four est installé au centre du meuble.

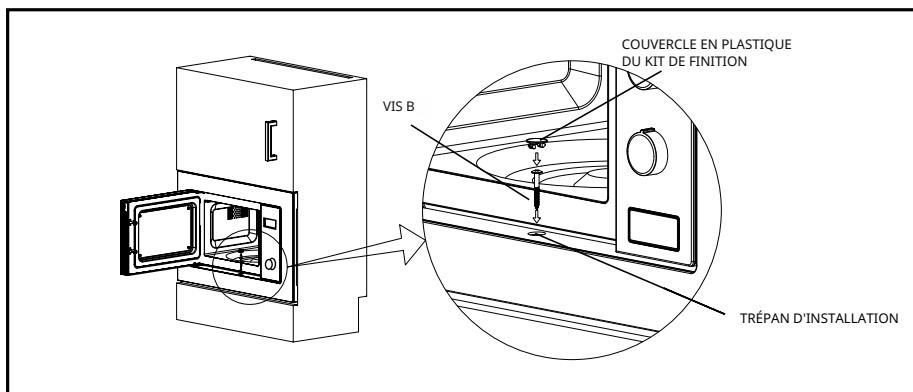

2. Ouvrez la porte ; fixez le four au meuble avec la VIS B au TROU D'INSTALLATION du KIT DE FINITION. Puis fixez le COUVERCLE EN PLASTIQUE DU KIT DE FINITION au TROU D'INSTALLATION.

Installation Instructions

Please Read the Manual Carefully Before Installation

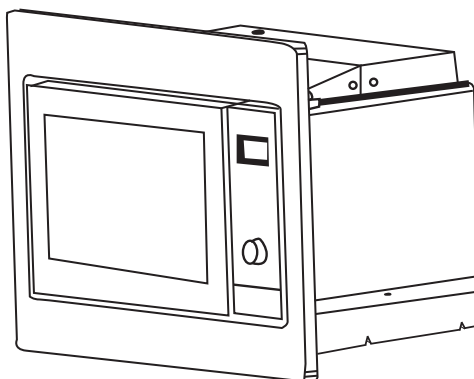
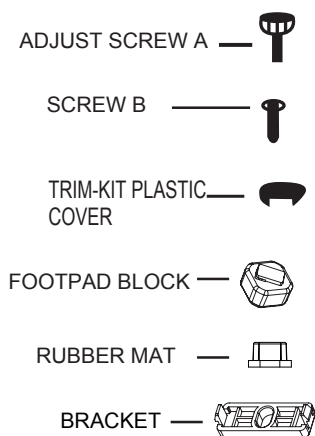

Please Note

Electrical connection

The oven is fitted with a plug and must be only connected to a properly installed earthed socket. In accordance with the appropriate regulations, the socket must only be installed and the connecting cable must only be replaced by a qualified electrician.

If the plug is no longer accessible following installation and all-pole isolating switch must be present on the installation side with a contact gap of at least 3mm.

A. Built-in furniture

The built-in cupboard shall not have a rear wall behind the appliance.

Minimum installation height is 85cm.

Do not cover ventilation slots and air intake points.

1.

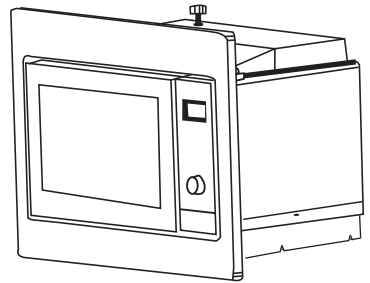
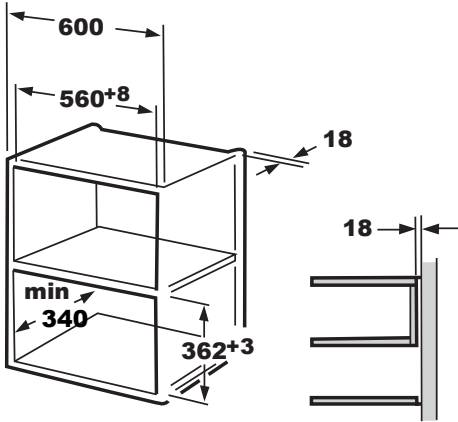

2.

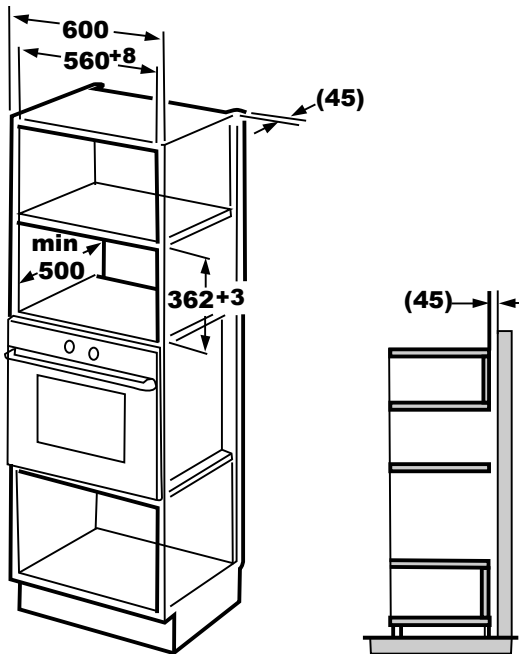

B. Install the Oven

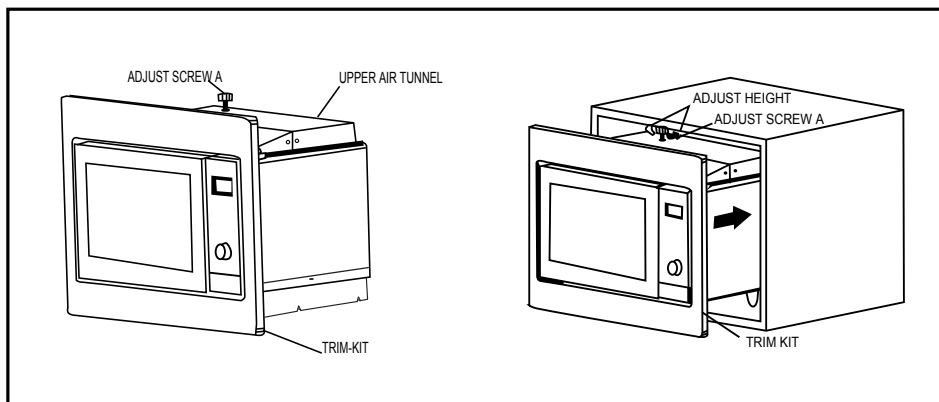

1. Fix ADJUST SCREW A on the UPPER AIR TUNNEL of the oven, and then install the oven into the cupboard.

- Adjust the height of ADJUST SCREW A to keep 1mm gap between the ADJUST SCREW A and the top plane of cupboard.
- Do not trap or kink the power cord.
- Make sure that the oven is installed in the center of the cupboard.

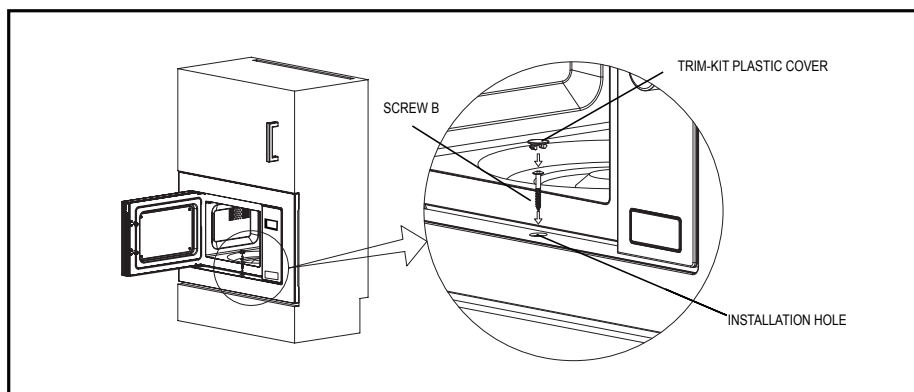

2. Open the door; fix the oven to the cupboard with SCREW B at the INSTALLATION HOLE of TRIM KIT. Then fix the TRIM-KIT PLASTIC COVER to the INSTALLATION HOLE.

For the cupboard with a height of 370mm

A. Built-in furniture

The built-in cupboard shall not have a rear wall behind the appliance.
Minimum installation height is 85cm.
Do not cover ventilation slots and air intake points.

1.

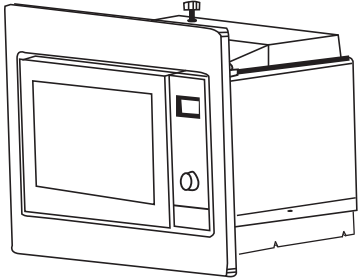
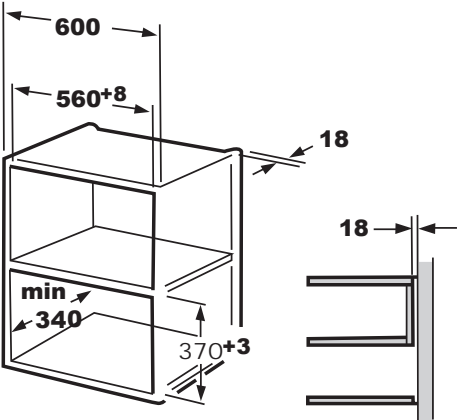

2.

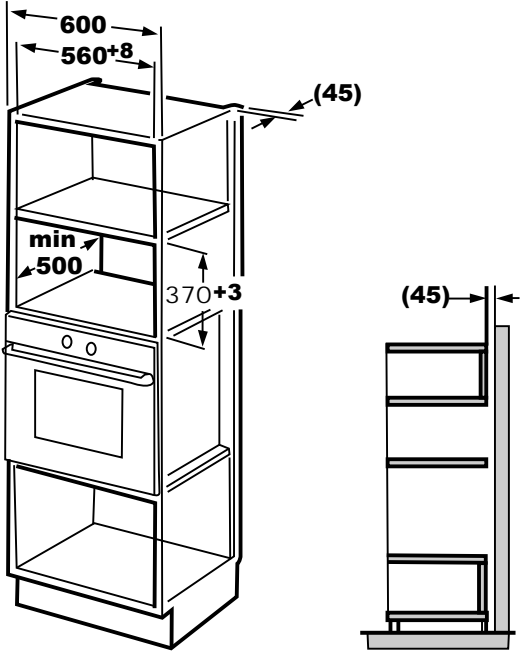

B. Install the Oven

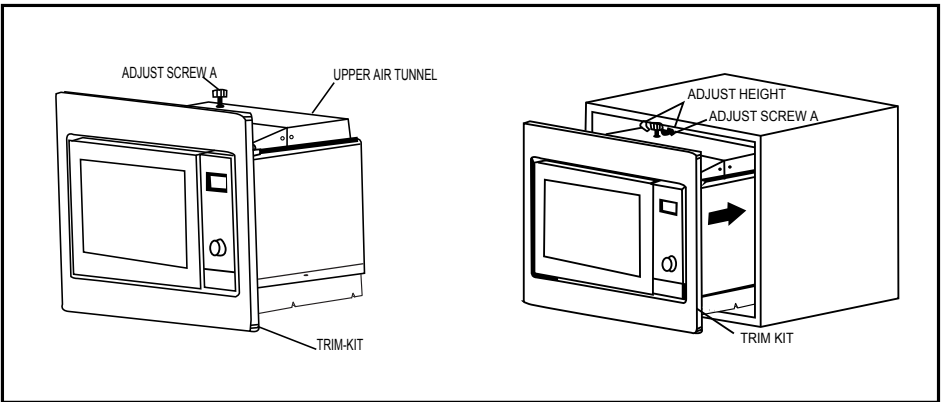
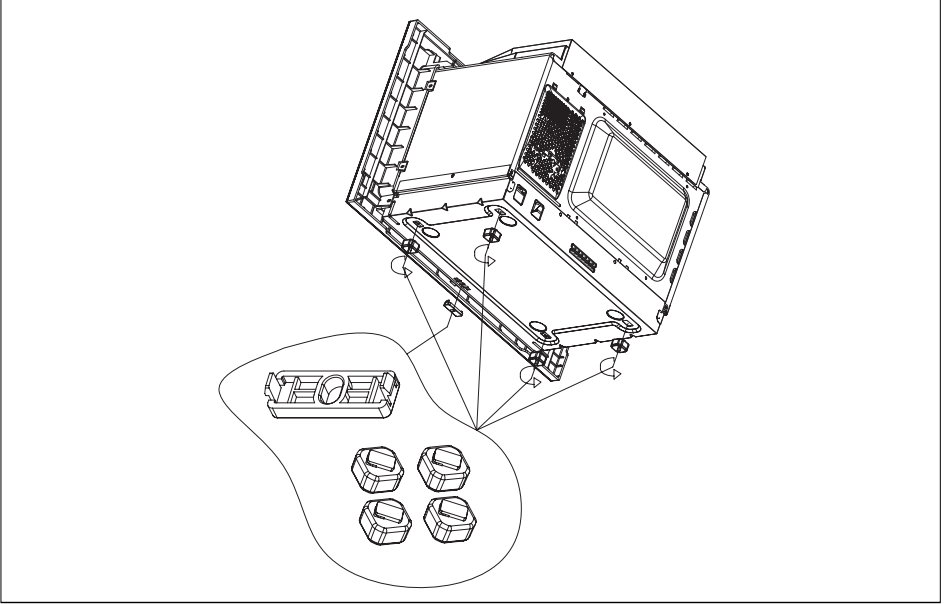

1. Fix ADJSUTSCREW A on the UPPER AIR TUNNEL of the oven, and then install the oven into the cupboard.

- Adjust the height of ADJUST SCREW A to keep 1mm gap between the ADJUST SCREW A and the top plane of cupboard.
- Do not trap or kink the power cord.
- Make sure that the oven is installed in the center of the cupboard.

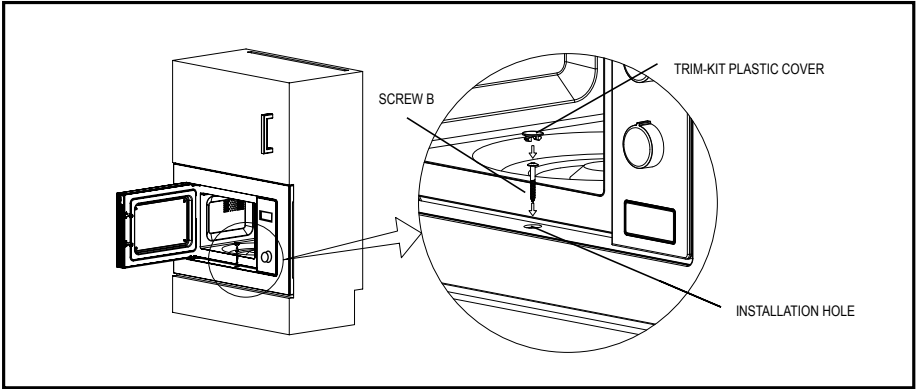

2. Open the door; fix the oven to the cupboard with SCREW B at the INSTALLATION HOLE of TRIM KIT. Then fix the TRIM-KIT PLASTIC COVER to the INSTALLATION HOLE.

For the cupboard with a height of 380mm

A. Built-in furniture

The built-in cupboard shall not have a rear wall behind the appliance.
Minimum installation height is 85cm.

Do not cover ventilation slots and air intake points.

1.

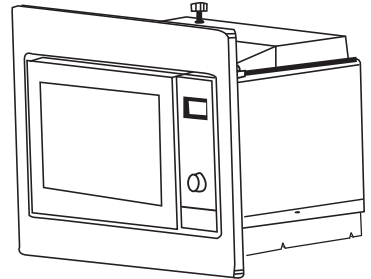
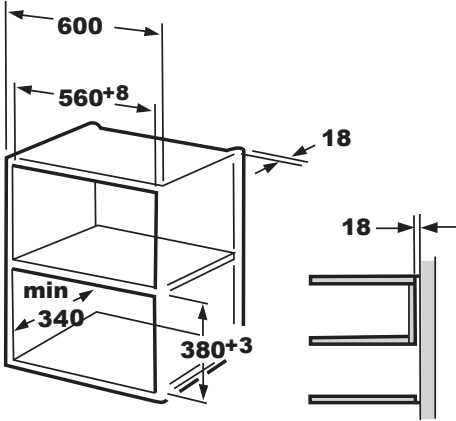

2.

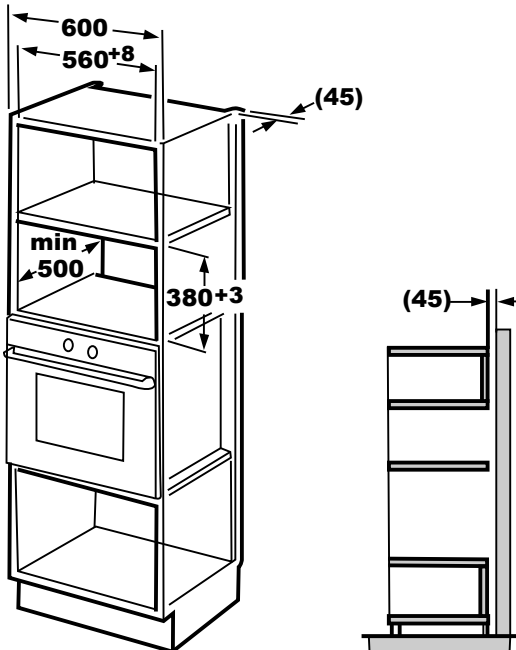

B. Install the Oven

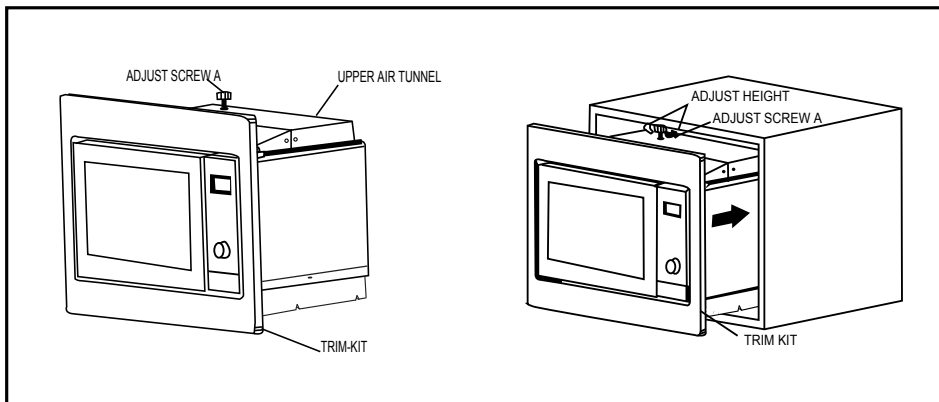
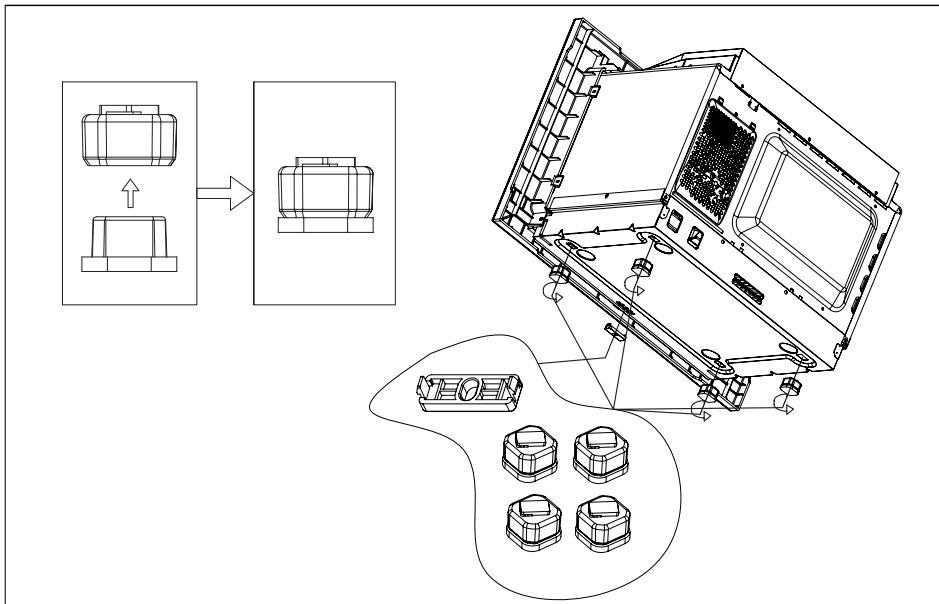

1. Fix ADJSUTSCREW A on the UPPER AIR TUNNEL of the oven, and then install the oven into the cupboard.

- Adjust the height of ADJUST SCREW A to keep 1mm gap between the ADJUST SCREW A and the top plane of cupboard.
- Do not trap or kink the power cord.
- Make sure that the oven is installed in the center of the cupboard.

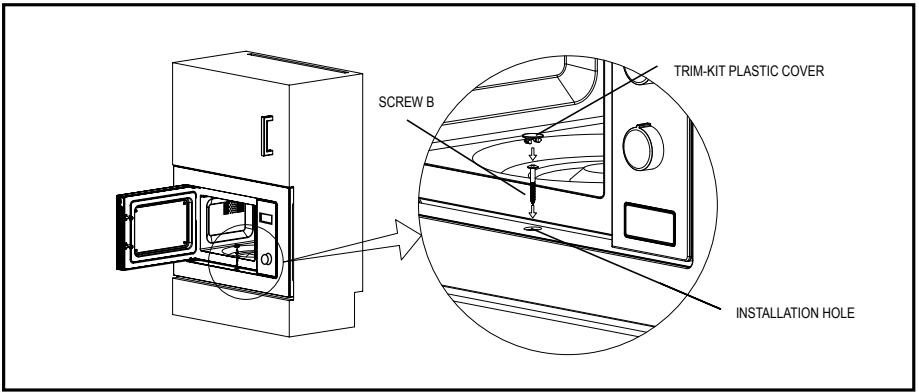

2. Open the door; fix the oven to the cupboard with SCREW B at the INSTALLATION HOLE of TRIM KIT. Then fix the TRIM-KIT PLASTIC COVER to the INSTALLATION HOLE.

Installationsanweisungen

Bitte lesen Sie die Anleitung sorgfältig durch, bevor Sie mit der Installation beginnen

SCHRAUBE A EINSTELLEN



SCHRAUBE B



TRIM-KIT KUNSTSTOFF
ABDECKUNG



FUSSABDECKUNG



GUMMIMATTE



HALTERUNG

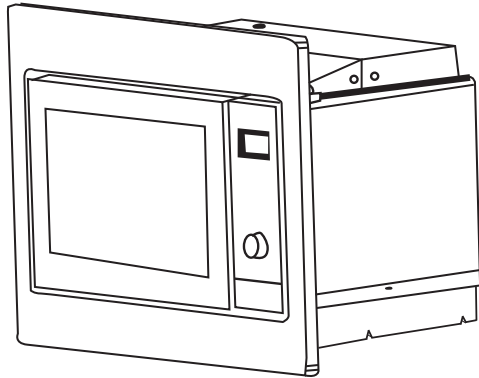

Bitte beachten Sie Elektrischer Anschluss

Der Ofen ist mit einem Stecker ausgestattet und darf nur an eine ordnungsgemäß installierte geerdete Steckdose angeschlossen werden. Gemäß den entsprechenden Vorschriften darf die Steckdose nur von einem qualifizierten Elektriker installiert und das Anschlusskabel nur von diesem ausgetauscht werden.

Wenn der Stecker nach der Installation nicht mehr zugänglich ist, muss auf der Installationsseite ein Allpol-Trennschalter mit einem Kontaktabstand von mindestens 3 mm vorhanden

A. Einbau-Möbel

Der Einbaumöbel darf keine Rückwand hinter dem Gerät haben.
Die minimale Installationshöhe beträgt 85 cm.
Belüftungsschlitze und Lufteinlasspunkte nicht abdecken.

1.

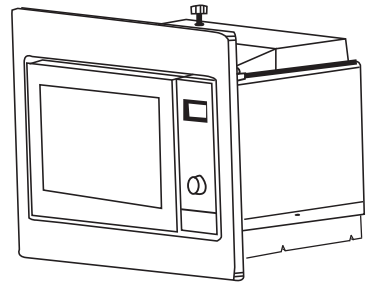
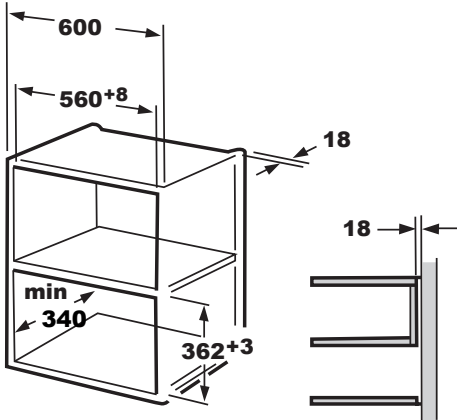

2.

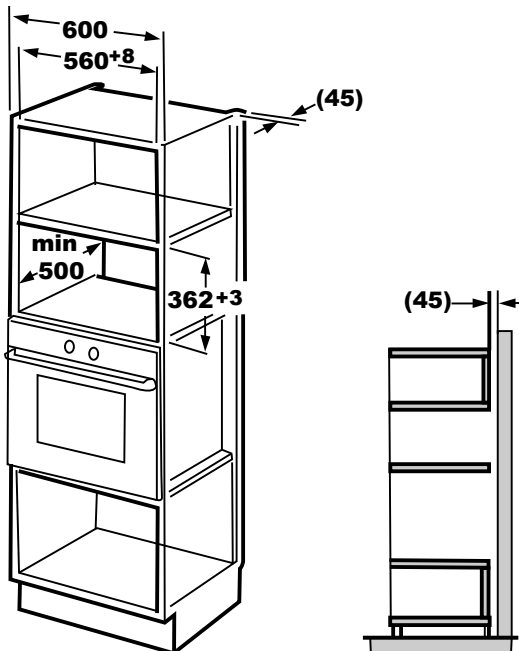

B. Ofen installieren

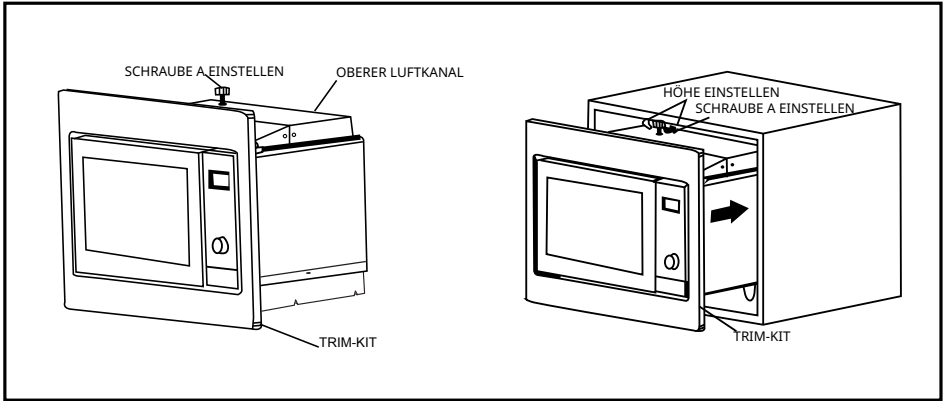

1. Fixieren Sie ADJUSTSCREW A am OBEREN LUFTKANAL des Ofens und installieren Sie dann den Ofen in den Schrank

- Stellen Sie die Höhe von ADJUST SCREW A ein, um einen Abstand von 1 mm zwischen ADJUST SCREW A und der Oberfläche des Schrankes zu halten.
- Klemmen oder knicken Sie das Netzkabel nicht ein.
- Stellen Sie sicher, dass der Ofen in der Mitte des Schrankes installiert ist.

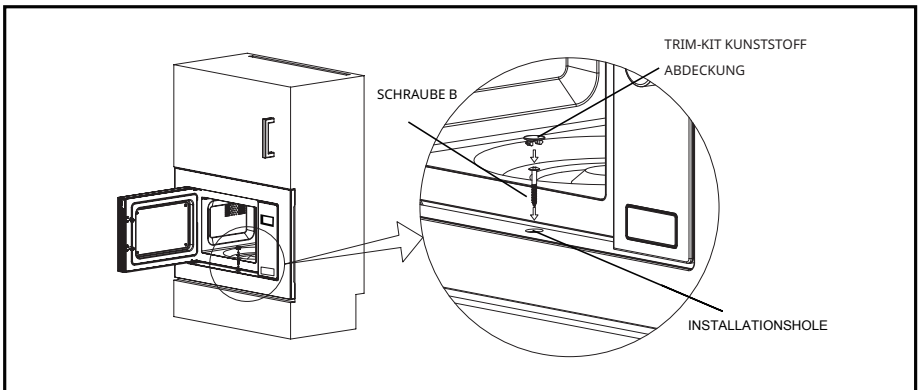

2. Öffnen Sie die Tür ; befestigen Sie den Ofen mit SCHRAUBE B am INSTALLATIONSHOLE des TRIM-KITS. Befestigen Sie dann die TRIM-KIT PLASTIKABDECKUNG .
INSTALLATIONSHOLE.

Für den Schrank mit einer Höhe von 370 mm

A. Einbau - Möbel

Der Einbauschränk darf keine Rückwand hinter dem Gerät haben.
Die Mindestinstallationshöhe beträgt 85 cm.
Belüftungsslitze und Lufteinlassöffnungen nicht abdecken.

1.

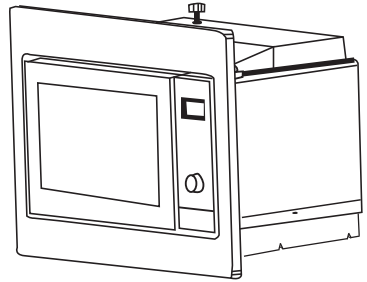
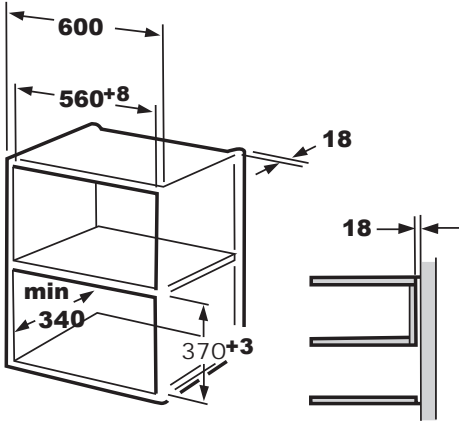

2.

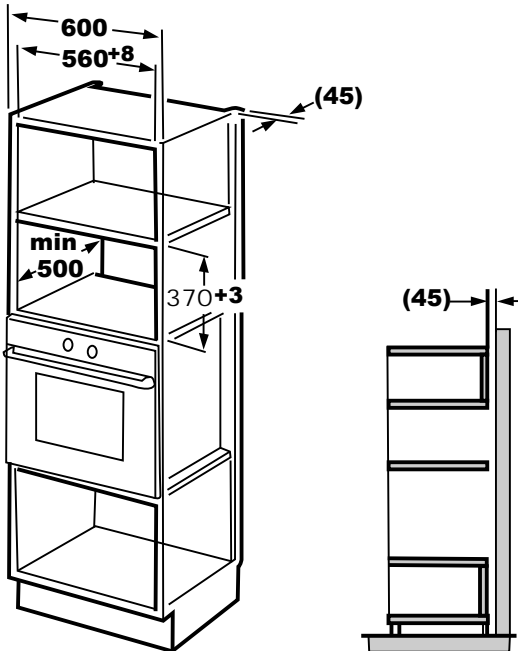

B. Installieren Sie den Ofen

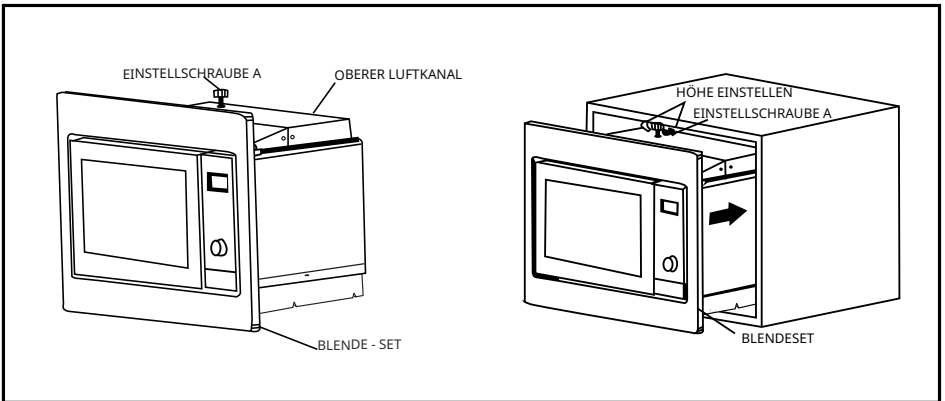
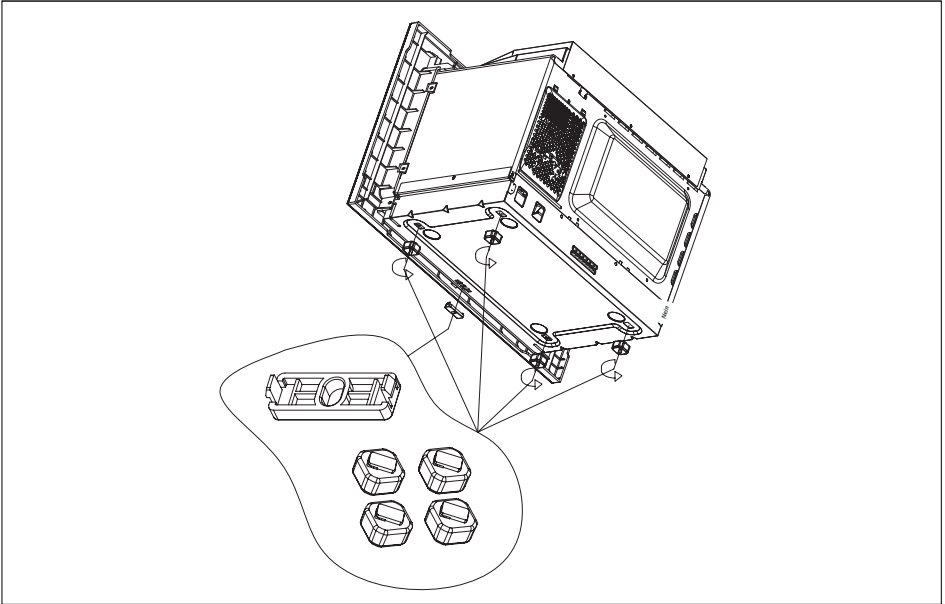

1. Befestigen Sie die EINSTELLSCHRAUBE A am OBEREN LUFTKANAL des Ofens und installieren Sie dann den Ofen in den Schrank.

- Stellen Sie die Höhe der EINSTELLSCHRAUBE A so ein, dass ein Spalt von 1 mm zwischen der EINSTELLSCHRAUBE A und der oberen Fläche des Schrankes bleibt.
- Verknoten oder knicken Sie das Netzkabel nicht.
- Stellen Sie sicher, dass der Ofen in der Mitte des Schrankes installiert ist.

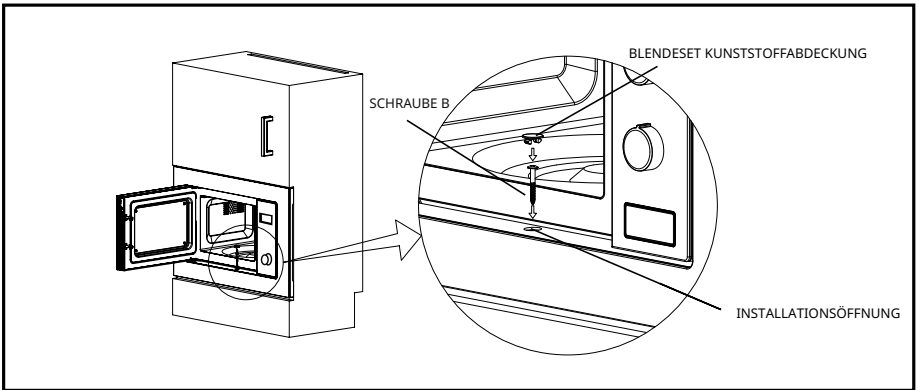

2. Öffnen Sie die Tür; befestigen Sie den Ofen mit SCHRAUBE B an der INSTALLATIONSÖFFNUNG des BLENDESETS am Schrank. Befestigen Sie dann die KUNSTSTOFFABDECKUNG DES BLENDESETS an der INSTALLATIONSÖFFNUNG.

Für den Schrank mit einer Höhe von 380 mm

A. Eingebautes Möbel

Der Einbauschränk darf keine Rückwand hinter dem Gerät haben.
Die Mindestinstallationshöhe beträgt 85 cm.
Belüftungsschlitze und Lufteinlassöffnungen nicht abdecken.

1.

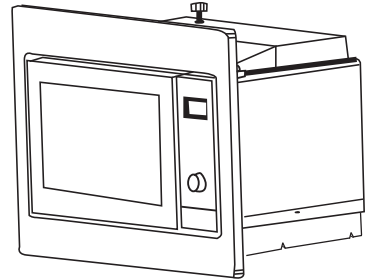
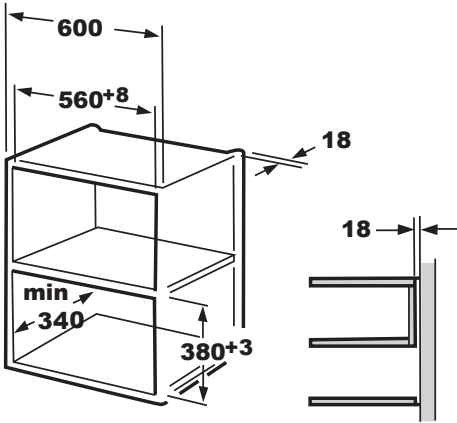

2.

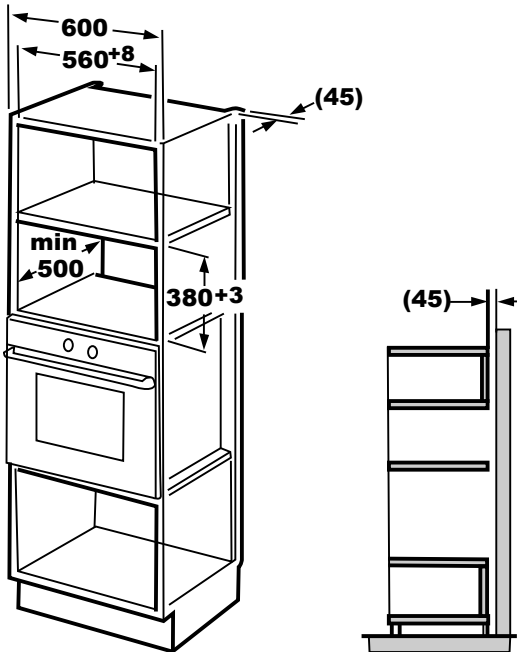

B. Installieren Sie den Ofen

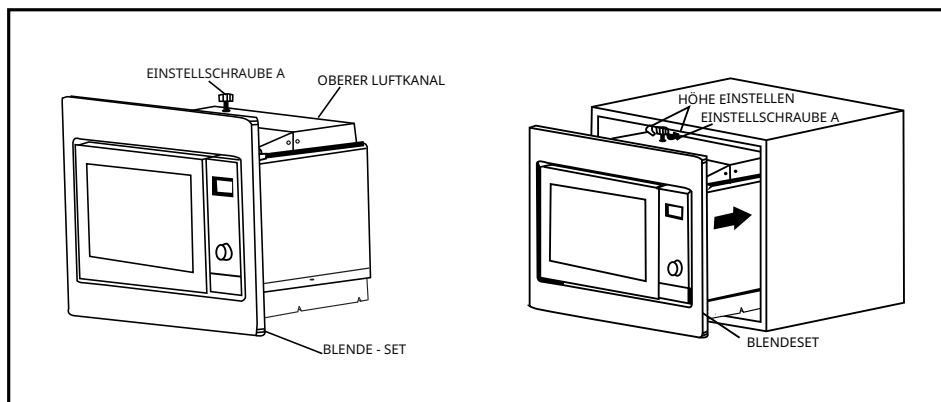
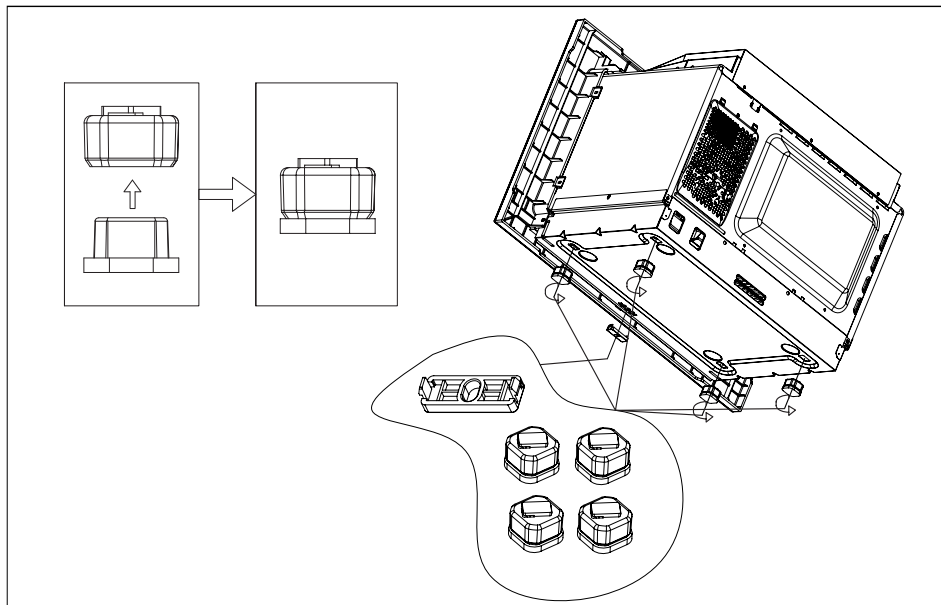

1. Befestigen Sie die EINSTELLSCHRAUBE A am OBEREN LUFTKANAL des Ofens und installieren Sie dann den Ofen in den Schrank.

- Stellen Sie die Höhe der EINSTELLSCHRAUBE A so ein, dass ein Spalt von 1 mm zwischen der EINSTELLSCHRAUBE A und der oberen Fläche des Schrankes bleibt.
- Verknoten oder knicken Sie das Netzkabel nicht.
- Stellen Sie sicher, dass der Ofen in der Mitte des Schrankes installiert ist.

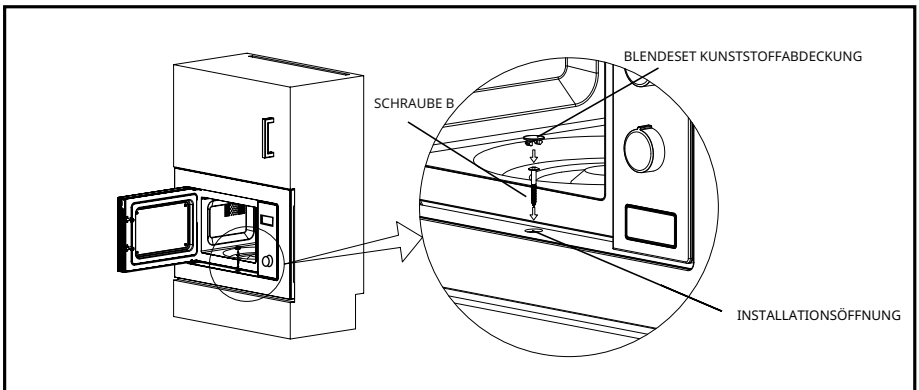

2. Öffnen Sie die Tür; befestigen Sie den Ofen mit SCHRAUBE B an der INSTALLATIONSÖFFNUNG des BLENDESETS am Schrank. Befestigen Sie dann die KUNSTSTOFFABDECKUNG DES BLENDESETS an der INSTALLATIONSÖFFNUNG.