

| 1 | 2 | 3 | 4 | 5 | 6 |
|----|-----------|----|--------|----|----|
| 标记 | 更改内容 | 区域 | 更改文件编号 | 日期 | 登记 |
| △ | 说明书封面封底有变 | | | | |

| 公差等级 | >0.5~6 | >6~30 | >30~120 | >120~315 | >315~1000 | >1000~2000 |
|------|--------|-------|---------|----------|-----------|------------|
| A级 | ±0.05 | ±0.1 | ±0.15 | ±0.2 | ±0.3 | ±0.5 |
| B级 | ±0.1 | ±0.2 | ±0.3 | ±0.5 | ±0.8 | ±1.2 |
| C级 | ±0.2 | ±0.5 | ±0.8 | ±1.2 | ±2.0 | ±3.0 |
| D级 | ±0.5 | ±1.0 | ±1.0 | ±1.5 | ±3.0 | ±4.0 |

说明书封面封底有变

封面

封底

全部 63

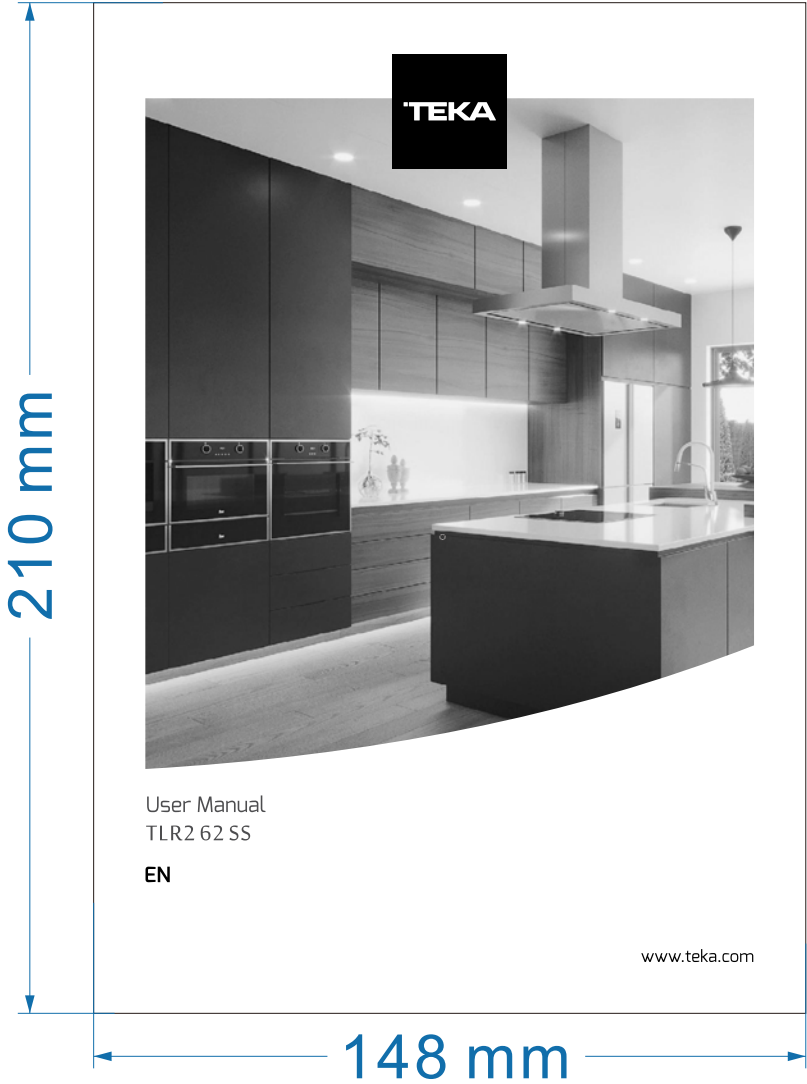

技术求
1.字体求印刷清晰不出现印漏印现。
2.尺寸按格求。
3.印刷版参照电子档。

| | | | | | | | | |
|----|----|----|----|------|------|-------------|-----|---------------------|
| 项目 | 批准 | 校核 | 设计 | 重要零件 | 材质 | 80克双胶纸 | 单 | PI-1029-18-1 |
| 签字 | | | | 服务零件 | 规格 | 210*143,21页 | 编号 | |
| 日期 | | | | 安规零件 | 表面处理 | | 料号 | B53-TH10-1768-01-XX |
| | | | | 比例 | | | 图号 | C |
| | | | | 第一角法 | 数量 | 重量 | 件名称 | 1768说明书 |
| | | | | 单位 | mm | 图幅 | | 1/1 |

CONTENT

| | |
|-------------------------------------|-------|
| INTRODUCTION..... | 2 |
| SAFETY PRECAUTION..... | 3 |
| WALL MOUNTING INSTALLATION..... | 4-8 |
| PREPARE FOR INSTALLATION..... | 4 |
| INSTALLATION (VENT OUTSIDE)..... | 5-7 |
| INSTALLATION (VENT INSIDE)..... | 8 |
| CEILING MOUNTING INSTALLATION..... | 9-10 |
| SLIM MODEL..... | 11-13 |
| TELESCOPIC MODEL INSTALLATION | 14 |
| BUILT-IN MODEL | 15-16 |
| OPERATION..... | 17 |
| MAINTENANCE..... | 18-19 |
| TROUBLESHOOTING..... | 20 |
| ENVIRONMENTAL PROTECTION..... | 20 |

INTRODUCTION

Thank you for choosing this cooker hood.

This instruction manual is designed to provide you with all required instructions related to the installation, use and maintenance of the appliance.

In order to operate the unit correctly and safety, please read this instruction manual carefully before installation and usage.

The cooker hood use high quality materials, and is made with a streamlined design. Equipped with large power electric motor and centrifugal fan, it also provides strong suction power, low noise operation, non-stick grease filter and easy assembly installation.

SAFETY PRECAUTION

- ☐ Never let the children operate the machine.
- ☐ The cooker hood is for home use only, not suitable for barbecue, roast shop and other commercial purpose.
- ☐ The cooker hood and its filter should be clean regularly in order to keep in good working condition.
- ☐ Clean the cooker hood according to the instruction manual and keep the unit from danger of burning.
- ☐ Forbid the direct baking from the gas cooker.
- ☐ Please keep the kitchen room a good convection.
- ☐ Before connecting this appliance check that the power supply cord is not damaged. A damage supply cord must be replaced by qualified service personnel only.
- ☐ There shall be adequate ventilation of the room when the range hood is used at the same time as appliances burning gas or other fuels;
- ☐ The air must not be discharged into a flue that is used for exhausting fumes from appliances burning gas or other fuels;
- ☐ Regulations concerning the discharge of air have to be fulfilled.
- ☐ This appliance if not intended for use by persons(including children) with reduced physical, sensory or mental capabilities, or lack of experience and knowledge, unless they have been given supervision or instruction concerning use of the appliance by a person slide for their safety.
- ☐ Children should be supervised to ensure that they do not play with the appliance.
- ☐ Do not flambé under the range hood.
- ☐ The range hood is not intended to be installed over a hob having more than four hob elements

Electrical Shock Hazard

- ☐ Only plug this unit into a properly earthed outlet. If in doubt seek advice from a suitably qualified engineer.
- ☐ Failure to follow these instructions can result in death, fire, or electrical shock.

WALL MOUNTING INSTALLATION

1. Prepare for installation:

- a. If you have an outlet to the outside, your cooker hood can be connected as below picture by means of an extraction duct (enamel, aluminum, flexible pipe or inflammable material with an interior diameter of 150mm)

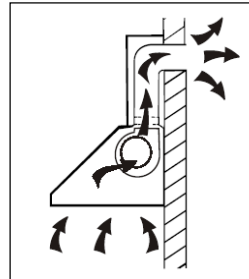

- b. Before installation, turn the unit off and unplug it from the outlet.

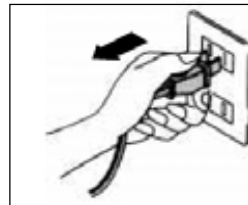

- c. The cooker hood should be placed at a distance of 65~75cm above the cooking plane for best effect.

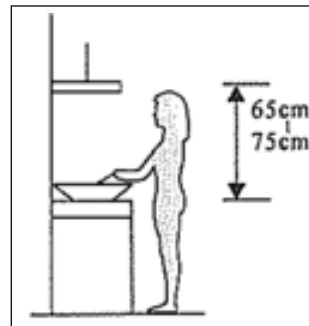

2. Installation (Vent outside):

- Drill 3 x 8mm holes to accommodate the bracket. Screw and tighten the bracket onto the wall with the screws provided.

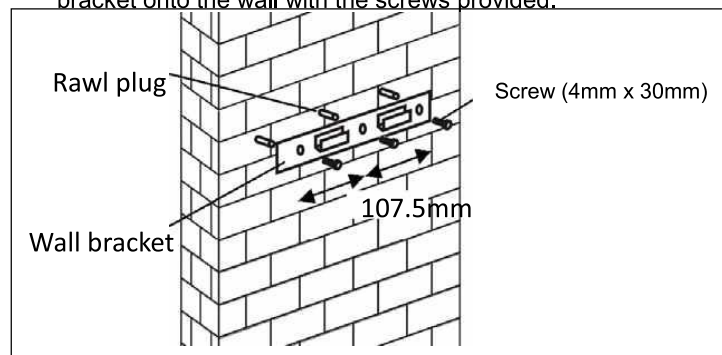

- Leave up the cooker hood and hang onto the wall bracket hook.

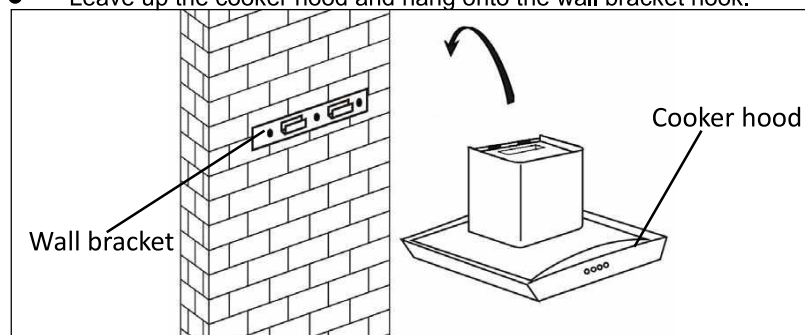

- Fix the one-way-valve to the air outlet of the cooker hood. Then, attached the exhaust pipe onto the one-way-valve as shown below.

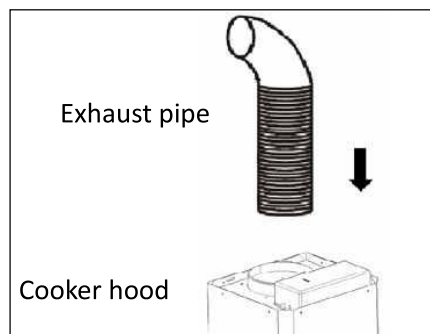

- Chimney installation.

For glass model and T shape model

- ◆ By Put the upper chimney into lower chimney .Then pulling out the upper chimney upwards. Adjust to reach the height required.

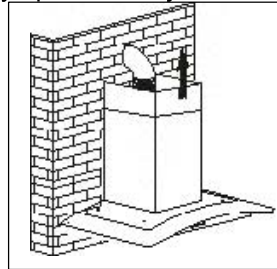

- ◆ Sliding the chimney to adjust the chimney height. When the height you required is reached, then hang the fixing hole to the fixing screws as showed in below pictures.

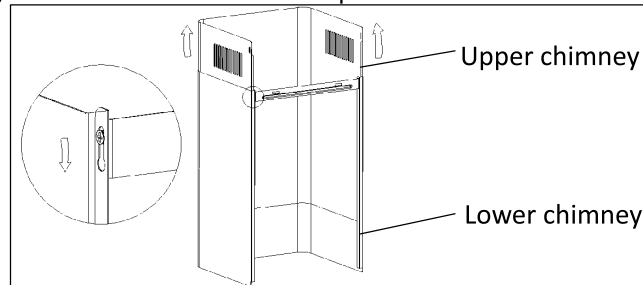

- ◆ Drill 2×8mm holes to accommodate the plate II. Screw and tighten the plate II onto the wall with 2 screws provided. Assembly the chimney onto the unit and fix it with 2 screws.

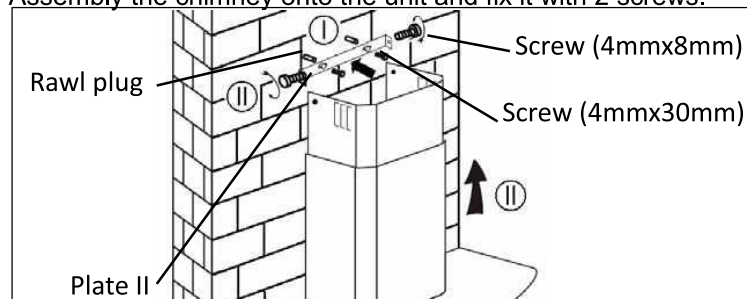

For Tower model

- ◆ By Put the inner chimney into upper chimney .Then pulling out the upper chimney upwards. Adjust to reach the height required.

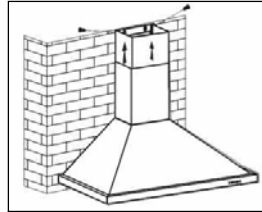

- ◆ Fix the lower chimney with 2 pcs of 4x8mm screws.

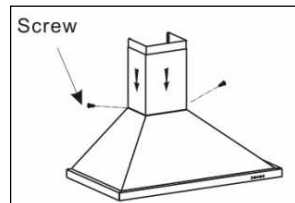

- ◆ Sliding the chimney to adjust the chimney height. When the height you required is reached, then fix 2 pcs of 4x8mm screws onto the hole fixing with plate I as showed in below pictures.

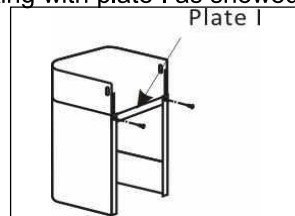

- ◆ Drill 2 x 8mm holes to accommodate the plate II. Screw and tighten the plate II onto the wall with 2 screws provided.
- ◆ Assembly the chimney onto the unit and fix it with 2 screws.

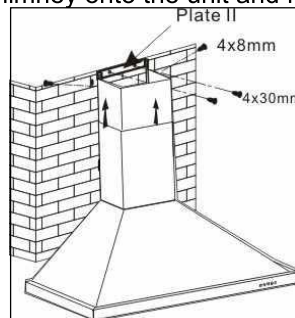

Installation (Vent inside)

If you do not have an outlet to the outside, exhaust pipe is not required and the installation is similar to the one show in section “**Installation (Vent outside)**”.

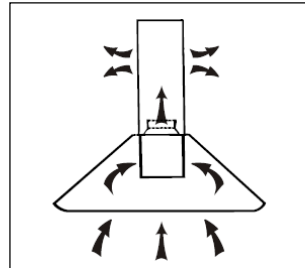

Activated carbon filter can be used to trap odors.

In order to install the activated carbon filter, the grease filter should be detached first. Press the lock and pull it downward.

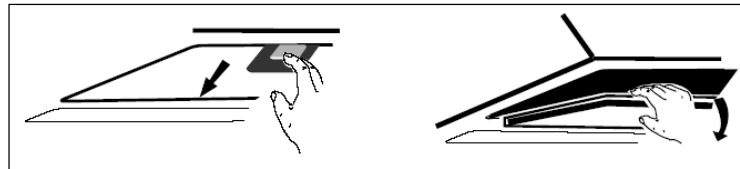

Plug the activated carbon filter into the unit and turn it in clockwise direction. Repeat the same on the other side.

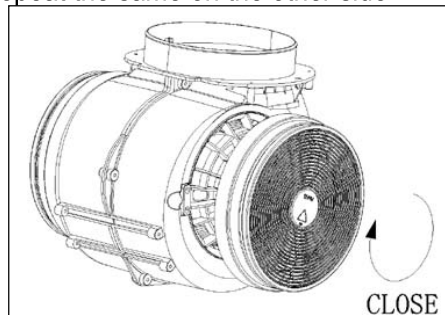

NOTE:

- *Make sure the filter is securely locked. Otherwise, it would loosen and cause dangerous.*
- *When activated carbon filter attached, the suction power will be lower.*

CEILING MOUNTING INSTALLATION

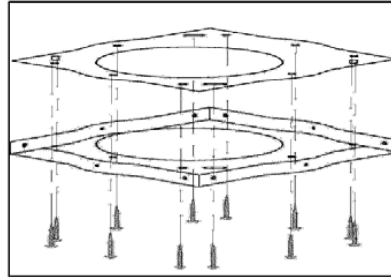

1) Position the hanging plate on the ceiling and then mark the position of the screw holes.

The hanging plate should be securely fixed to the ceiling,

- 11 x ST6 (40 mm) screws for wooden ceiling
- 8 x expansion bolts for cement ceiling

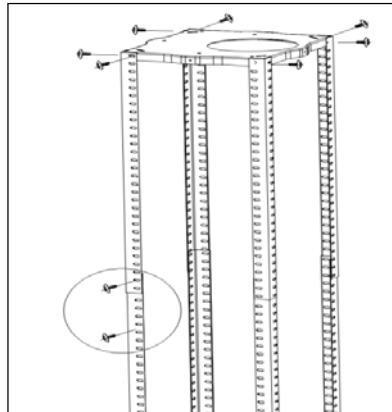

2) Fix the angle bars to the hanging plate, using the 8 x M5 screws.

3) Extend the angle bars to the required height and then fix them in position using the 16 x M5 screws and nuts with metal washers.

- **IMPORTANT:** The angle bars must have an overlap of AT LEAST 100 mm.

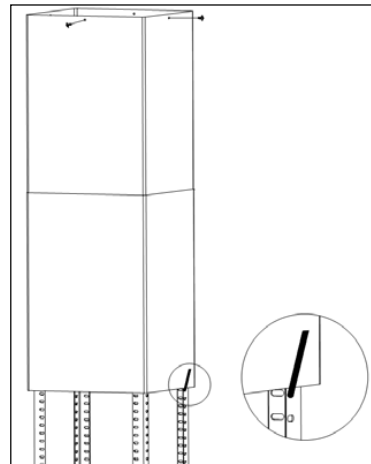

4) If your cooker hood is going to be used in extraction mode, then you should connect the ducting hose to the ceiling adaptor at this point.

Fix the upper chimney section to the hanging plate, using the 4 x self tapping screws.

Slide the lower chimney section onto the angle bars and raise it until it sits just below the upper chimney section.

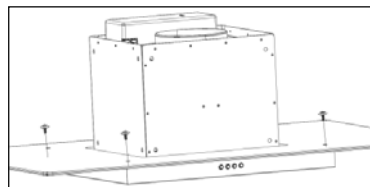

5) If the glass canopy has not been pre-assembled by the factory, then it should be fixed to the top of the main body of the cooker hood at this stage.

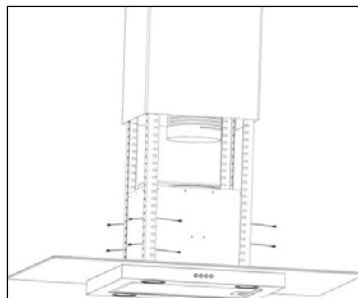

6) Lift the main body of the cooker hood onto the angle bar and then fix it into position using the 16 x M5 screws.

- **IMPORTANT:** This stage of the installation process **MUST** be completed by two people.
- **IMPORTANT:** The 16 x M5 screws **MUST** be securely tightened.

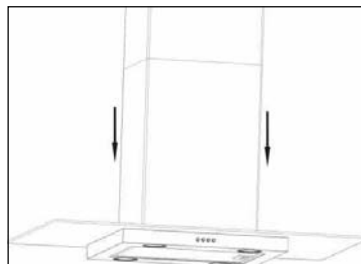

7) If you are going to be using the hood in extraction mode, you should fix the ducting hose to the spigot.

- The electrical connection must correspond to the electrical requirement noted on the rating plate, which is placed inside the cooker hood. The appliance should now be connected to the electrical supply. See page 16-17 for detailed information on the electrical connection.
- Check that the appliance is operating correctly by selecting each speed and switching the light bulbs on and off.
- Remove the hanging hook and then slide the lower chimney section downwards, until it rests against the main body of the cooker hood.
- Use a stainless steel cleaner and polish on the stainless steel sections of the appliance.
- If you are using the appliance in recirculation mode, then you should now fit the carbon filter. See the "fitting the carbon filter" section on pages 14 — 15.

Slim model

Way one:

- To install onto the wall drill 2 holes of Ø8mm on a suitable place according with the centre distance of hole in the back of the cooker hood.
- Insert the nut into the holes.
- Insert the screws into the nuts and tight. Put the cooker hood onto the tighten screws.

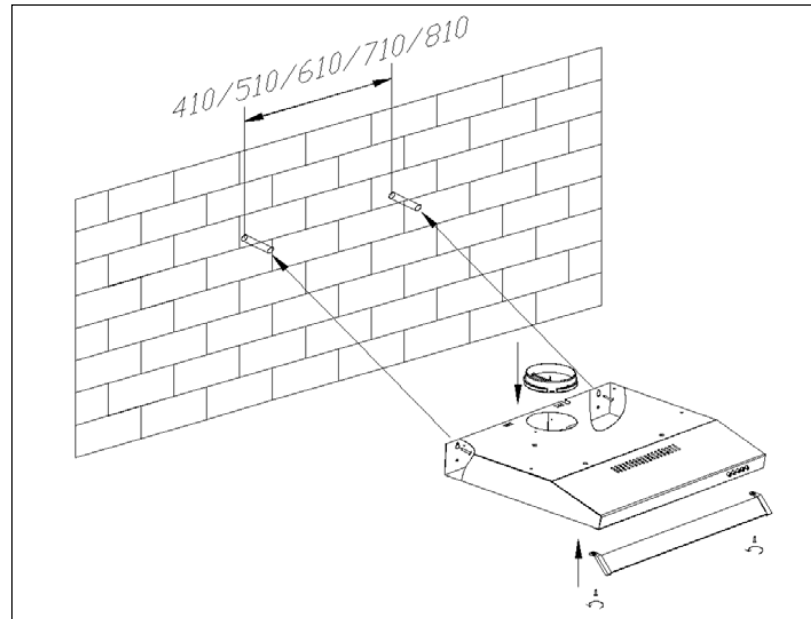

- Fix the cooker hood with safety screw. The two safety vents are positioned on the back casing, with diameter of 6mm.
- Put the one way valve onto the cooker hood.

Way two:

- Drill 4 holes of 6mm diameter at the bottom of the hanging cupboard
- Put the one way valve on the cooker hood, then install the cooker hood on the bottom of the cupboard, tighten the hood with enclosed 4 screws.
- Install the adjusted board on the bottom of the hood in order to keep out the gap between hood back and cupboard.

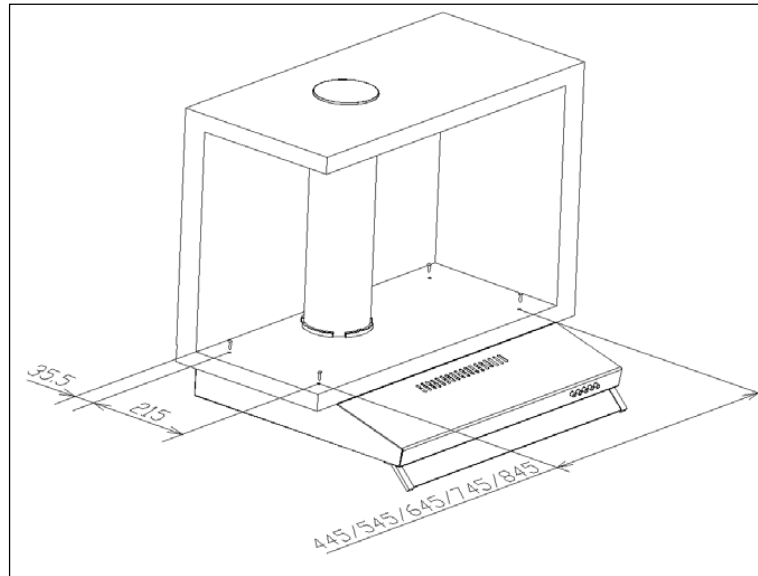

Note:

- 1.The extensible pipe are optional accessory, not supplied.
- 2.Take off protection film before installation.
- 3.There are 2 methods for ventilation , including ' horizontal ventilation' and ' vertical ventilation'. Please pay attention to the ventilation method when installation.

Vertical ventilation: See Pic A, please use tool take out the round cover before using, and the air can be vented from top

horizontal ventilation: See Pic B, please use tool take out the round cover before using, and the air can be vented from back.

The square air outlet for horizontal ventilation is not supplied.

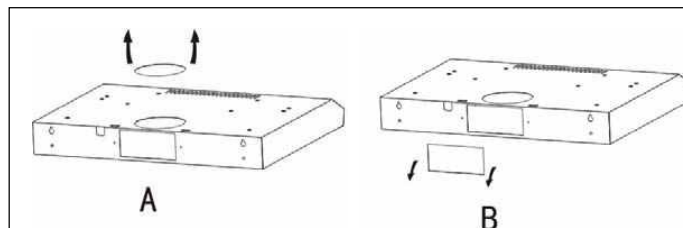

Air ventilation setting

- Outdoor exhausting: Turn the adjuster to outdoor position(pic.7A), install the outlet, turn on the cooker hood, then the air will be vented from the outside outlet.
- Recycling: the recycling mode with carbon filter ,Turn the adjuster to indoor position (pic.7B), install the outlet cover, turn on the cooker hood, then the air can be vented from the inside outlet. See Pic 7D
- Note: The charcoal filter is mounted on the back of the grill and must be changed once three month.
- Warning: the charcoal cannot be washed or recycled. It should be changed at most after 120 hours using. The carbon filter shouldn't be exposed to heat.

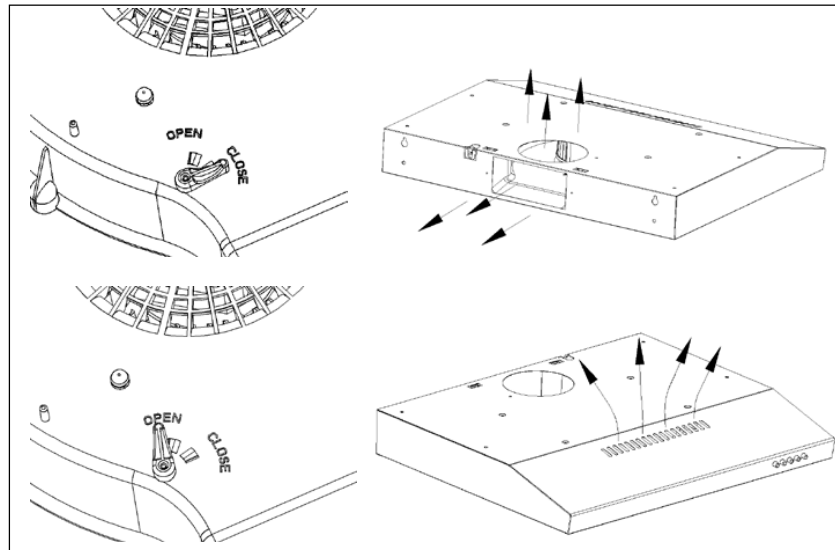

TELESCOPIC MODEL INSTALLATION

Way 1:

To install onto the wall drill 2 holes of $\phi 8\text{mm}$ on a suitable place according with the centre distance of hole in the back of the cooker hood.

Insert the nut into the holes.

Insert the screws into the nuts and tight. Put the cooker hood onto the tighten screws.

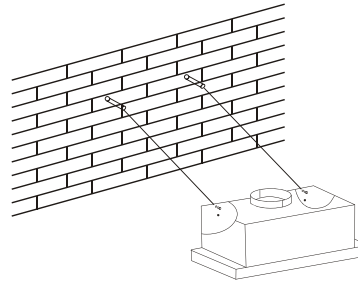

Fix the cooker hood with safety screw. The two safety vents are positioned on the back casing, with diameter of 6mm.

Put the one way valve onto the cooker hood.

Way 2:

Drill 4 holes of 6mm diameter at the bottom of the hanging cupboard

Put the one way valve on the cooker hood, then install the cooker hood on the bottom of the hanging cupboard, tighten the hood with enclosed 4 screws.

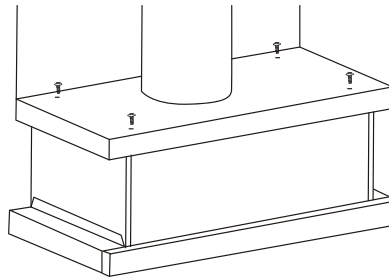

Note:

- 1.The extensible pipe are optional accessory, not supplied.
- 2.Take off protection film before installation.

Built-in model

Before installation, you need to check and make a hole on your kitchen cabinet in appropriate size to fit the hood. See below drawings.

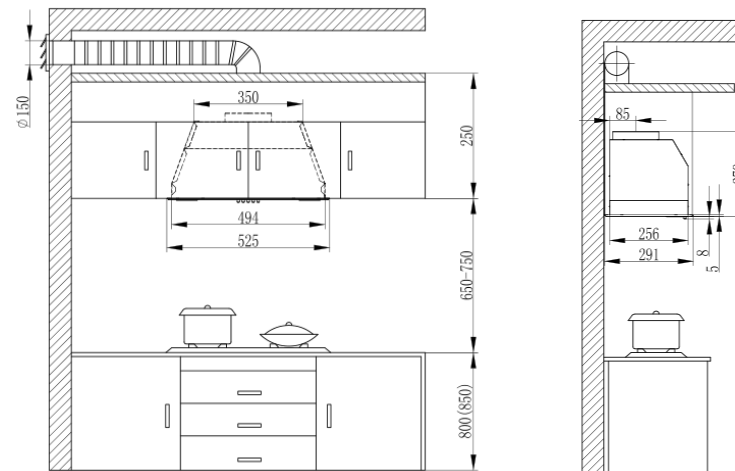

1. Take the filter off the hood.
Remove the panel off body by unscrewing screws at two sides.
Put the panel and screws(4pcs) away.

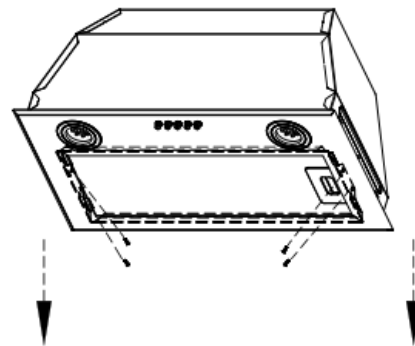

2. Fix the hood body into cabinet with 12pcs of screws.

Attention: This step couldn't be finished by yourself, at least 2 people needed. One to lift up the hood, one to fix the hood by screws.

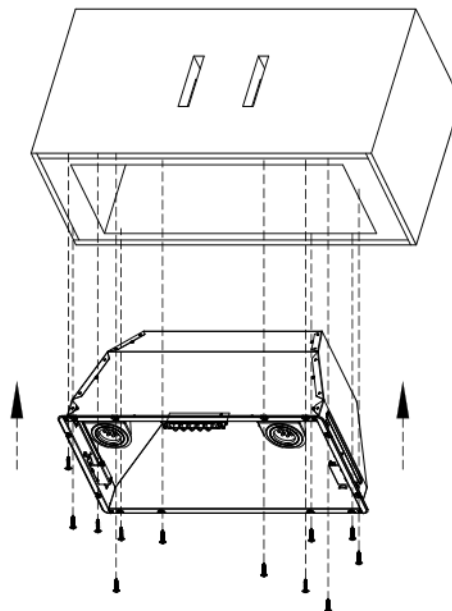

3. Check and make sure the hood body is well fixed into cabinet, then, assemble the panel back onto the body with 4 pcs of screws disassembled at first step.

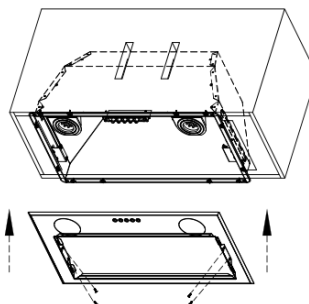

OPERATION

Push button/Electronic button 1



0 Off button

It's used for turning off the fan.

Low Speed button

It's used for Ventilation on the kitchen. It is suitable for simmering and cooking which do not make much steam.

Medium Speed button

Airflow speed is ideally for ventilation in standard cooking operation.

High Speed button

When high density of smoke or steam produced, press high-speed button for highest effective ventilation.

Light button

Electronic button 2

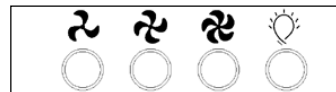

Low Speed button

It's used for Ventilation on the kitchen. It is suitable for simmering and cooking which do not make much steam.

Medium Speed button

Airflow speed is ideally for ventilation in standard cooking operation.

High Speed button

When high density of smoke or steam produced, press high-speed button for highest effective ventilation.

Light button

NOTE: If Low / Medium / High speed buttons are press at the same time, the unit will only operate at the highest speed.

MAINTENANCE

Before cleaning switch the unit off and pull out the plug.

I. Regular Cleaning

Use a soft cloth moistened with hand-warm mildly soapy water or household cleaning detergent. Never use metal pads, chemical, abrasive material or stiff brush to clean the unit.

II. Monthly Cleaning for Grease Filter

ESSENTIAL: Clean the filter every month can prevent any risk of fire.

The filter collects grease, smoke and dust..... so the filter is directly affecting the efficiency of the cooker hood. If not cleaned, the grease residue (potential flammable) will saturate on the filter. Clean it with household cleaning detergent.

III. Annual Cleaning for Activated Carbon Filter

Apply SOLELY to unit that installed as a recirculation unit (not vented to the outside). This filter traps odours and must be replaced at least once a year depending on how frequent the cooker hood used.

IV. Bulb Replacement

- 1.Switch the unit off and unplug the appliance.
 - 2.Remove the lamp cover by unscrewing the 2 screws.
 - 3.Unscrew the incandescent bulb
 - 4.Replace with the same type and rated bulb/lamp
- E14 Incandescent Bulb: (220V E14 Max 40W).

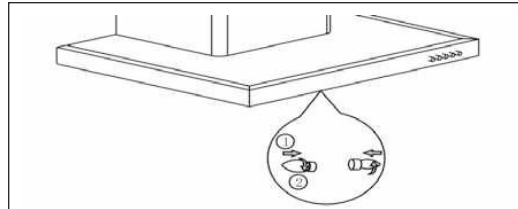

- Halogen lamp (max, 20W) & LED lamp (max,1.5W).

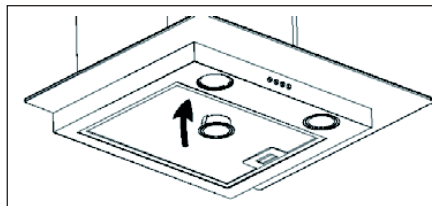

- For Slim model.

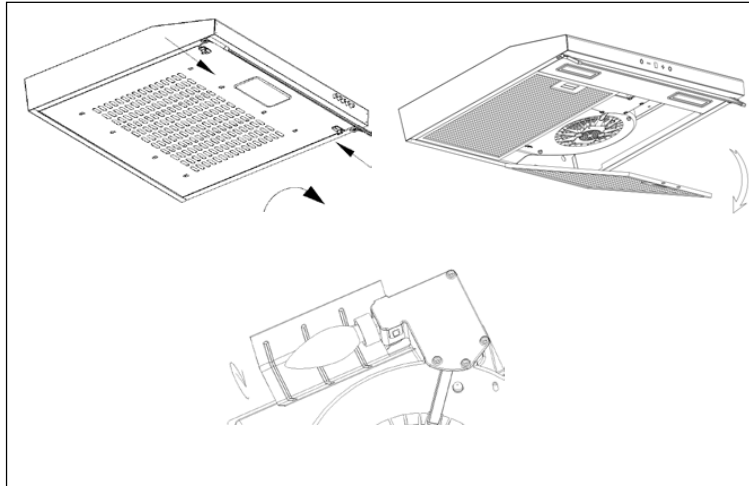

TROUBLESHOOTING

| Fault | Cause | Solution |
|---------------------------------|--|---|
| Light on, but fan does not work | The fan blade is jammed. | Switch of the unit and repair by qualified service personnel only. |
| | The motor is damaged. | |
| Both light and fan do not work | light bulb burn. | Replace the bulb with correct rating. |
| | Power cord looses. | Plug in to the power supply again. |
| Serious Vibration of the unit | The fan blade is damaged. | Switch of the unit and repair by qualified service personnel only. |
| | The fan motor is not fixed tightly. | Switch of the unit and repair by qualified service personnel only. |
| | The unit is not hung properly on the bracket. | Take down the unit and check whether the bracket is in proper location. |
| Suction performance not good | Too long distance between the unit and the cooking plane | Readjust the distance to 65-75cm |

ENVIRONMENTAL PROTECTION

Waste electrical products should not be disposed of with household waste. Please recycle where facilities exist. Check with your Local Authority or retailer for recycling advice.



This appliance is marked according to the European directive 2002/96/EC on Waste Electrical and Electronic Equipment (WEEE).

By ensuring this product is disposed of correctly, you will help prevent potential negative consequences for the environment and human health, which could otherwise be caused by inappropriate waste handling of this product.

The symbol on the product indicates that this product may not be treated as household waste. Instead it shall be handed over to the applicable collection point for the recycling of electrical and electronic equipment

Disposal must be carried out in accordance with local environmental regulations for waste disposal.

For more detailed information about treatment, recovery and recycling of this product, please contact your local city office, your household waste disposal service or the shop where you purchased the product.