

UBT 12/55

Rechargeable AGM battery 55 Ah / 12 V

UBT: Powerful and reliable back-up storage

Salicru's **UBT** series batteries are extremely powerful and compact rechargeable lead-lead dioxide energy accumulators particularly suitable for UPSs and other security systems that require reliable and high-quality energy back-up.

Salicru's **UBT** battery range includes 55 Ah at 12 V.

The sulphuric acid electrolyte is absorbed by the separators and plates. And these in turn immobilised. They are designed using gas recombination technology which eliminates the need for the regular addition of water by controlling the evolution of hydrogen and oxygen during charging. The battery is completely sealed and watertight and therefore maintenance free, enabling it to be used in any position. If the battery is accidentally overcharged, resulting in the production of hydrogen and oxygen, a number of special one-way valves allow the gases to escape to avoid interior overpressure.



Applications:

Uninterruptible power supply systems (UPS), emergency lighting systems, signalling systems, communications and electrical equipment, broadcasting systems, lift automation panels, electronic cash registers, etc.

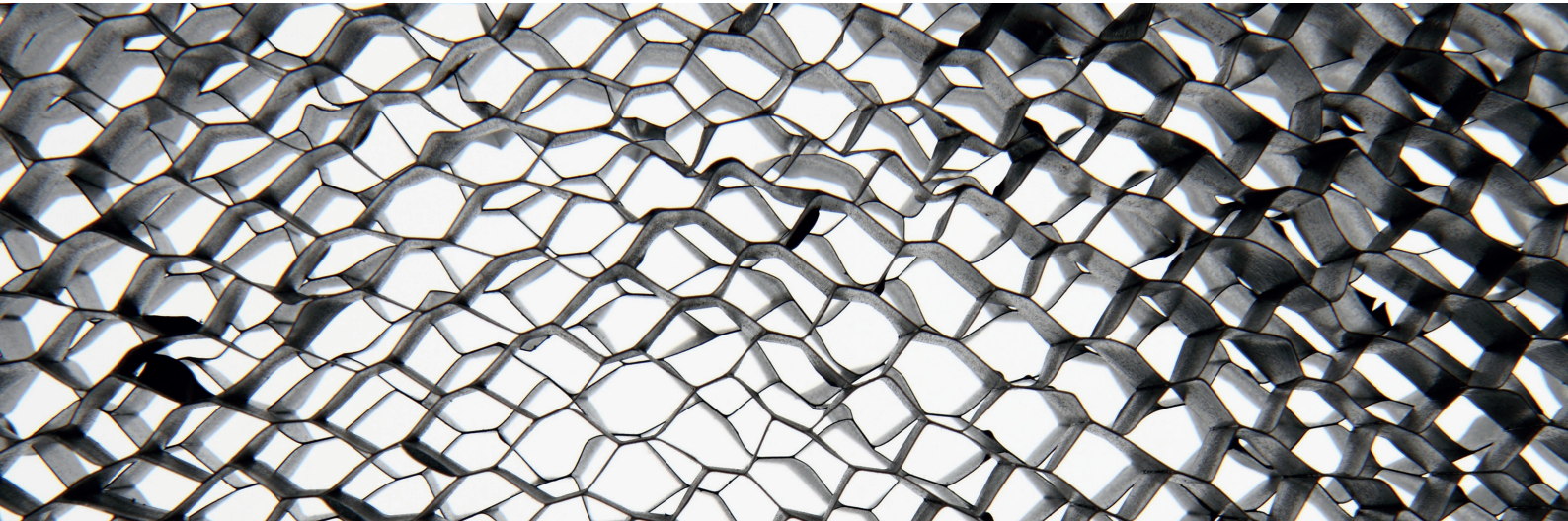

SALICRU

Performances

- AGM technology for efficient gas recombination of up to 99% and free of maintenance or adding water.
- No restrictions for air transport, compliance with IATA/ICAO Special Provision A67.
- Can be mounted in any position.
- Lead designed by computer with calcium/tin alloy rack for high energy density.
- Long service life in both float and cyclic applications.
- Maintenance-free.
- Low self-discharge



Battery compatibility vs series

	UBT 12/55
SLC CUBE3+	•
SLC CUBE4	•
SLC ADAPT2	•
SLC X-PERT	•
SLC X-TRA	•

Battery construction

COMPONENT	RAW MATERIAL
Positive plate	Lead dioxide
Negative plate	Lead
Container	ABS
Lid	ABS
Safety valve	Rubber
Terminal	Copper
Separator	AGM
Electrolyte	Sulphuric acid

Dimensions



UBT 12/55

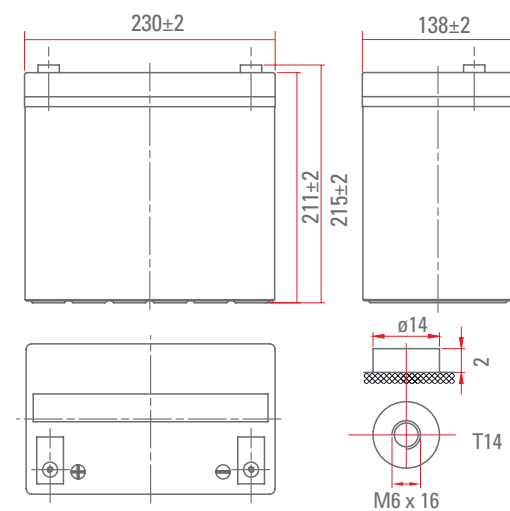

Behaviour charts

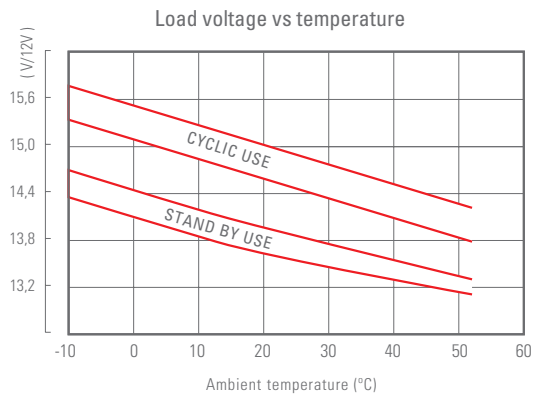
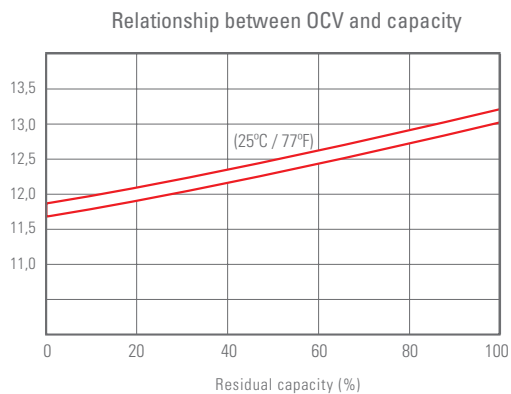
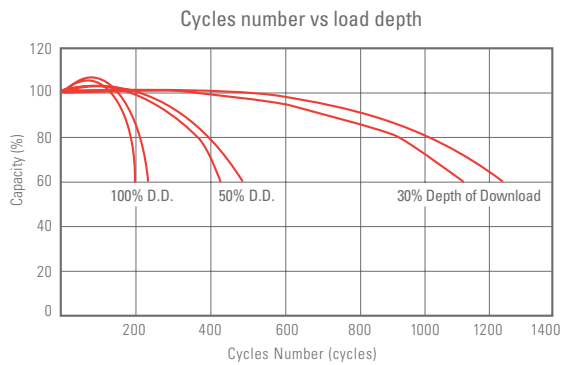
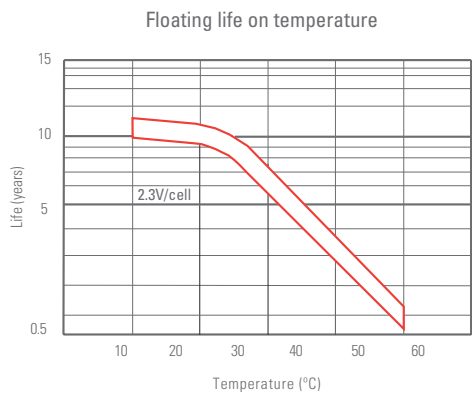
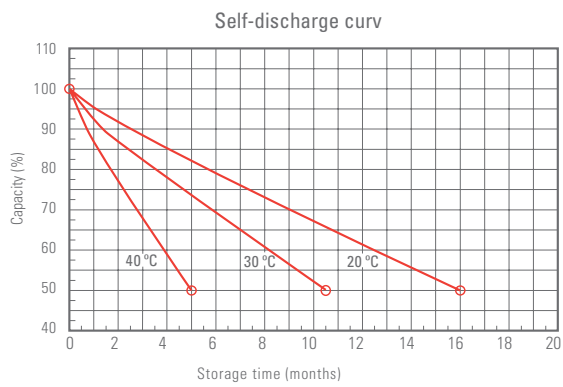
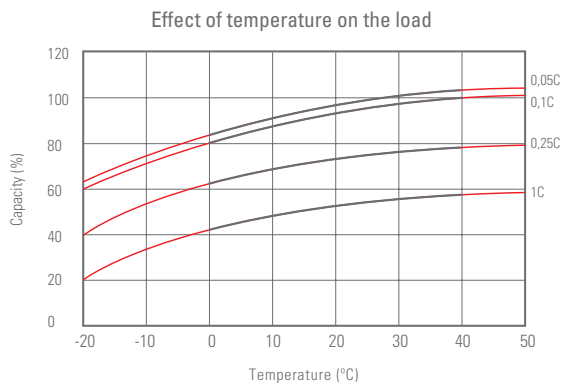
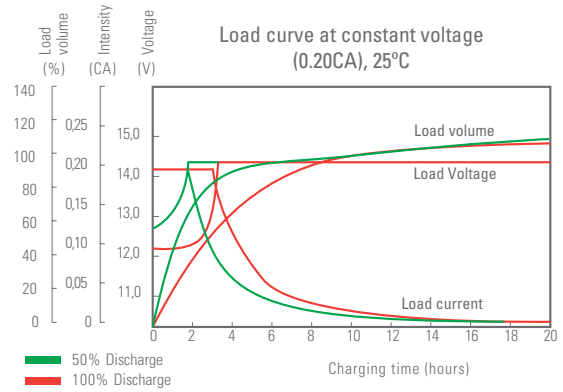
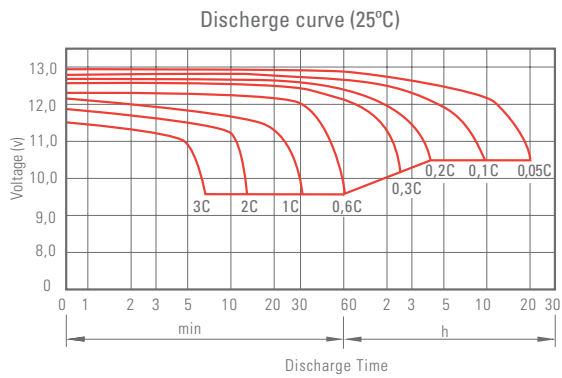

Technical specifications

MODEL		UBT 12/55
Nominal voltage (V)		12
Number of cells		6
Rated capacity at 25°C	20 hours	58.40 Ah (2.92 A, 10.8 V)
	10 hours	55 Ah (5.50 A, 10.8 V)
	5 hours	47 Ah (9.39 A, 10.8 V)
	1 hour	30.60 Ah (30.60 A, 10.8 V)
Internal resistance		≤6.5 mΩ ⁽¹⁾
Self-discharge		3% ⁽²⁾
Operating temperature range	Discharge	-15°C ÷ +50°C
	Charge	-10°C ÷ +50°C
	Storage	-20°C ÷ +50°C
Maximum discharge current		550 A (5s)
Dimensions	Depth	230 mm ±2 mm
	Width	138 mm ±2 mm
	Height	211 mm ±2 mm
Overall dimensions (with connectors)	Height	215 mm ±2 mm
Weight		17.30 Kg
CODE		013BS000021

(1) Fully charged battery at 25°C

(2) Reduction of capacity per month at 20°C (average)

Information subject to change without notice.

Constant discharge current (25°C)

Cut-off voltage per cell (V/cell)	10 min	15 min	30 min	60 min	2 h	3 h	4 h	5 h	8 h	10 h	20 h
9.60 V	120	92.4	55.3	34.0	20.1	14.5	11.6	9.87	6.79	5.60	2.97
9.90 V	116	90.2	54.2	33.5	20.0	14.4	11.5	9.82	6.75	5.59	2.96
10.2 V	112	86.9	52.5	32.6	19.8	14.3	11.4	9.75	6.70	5.57	2.95
10.5 V	107	83.9	51.2	31.6	19.5	14.2	11.3	9.68	6.66	5.54	2.94
10.8 V	101	79.5	49.4	30.6	19.0	13.8	11.0	9.39	6.46	5.50	2.92

Constant discharge power (25°C)

Cut-off voltage per cell (V/cell)	10 min	15 min	30 min	60 min	2 h	3 h	4 h	5 h	8 h	10 h	20 h
9.60 V	1295	1015	620	387	233	170	136	117	80.6	66.9	35.6
9.90 V	1256	990	608	382	231	169	135	116	80.2	66.7	35.5
10.2 V	1204	954	589	372	229	168	134	115	79.6	66.5	35.4
10.5 V	1152	921	575	360	226	167	133	114	79.1	66.1	35.2
10.8 V	1088	873	554	349	220	162	129	111	76.7	65.7	35.0

The data shown above relates to average values obtained after 3 charge/discharge cycles, not minimum values.

