

# UBT 12/90

Rechargeable AGM battery 90 Ah / 12 V



## UBT: Powerful and reliable back-up storage

Salicru's **UBT** series batteries are extremely powerful and compact rechargeable lead-lead dioxide energy accumulators particularly suitable for UPSs and other security systems that require reliable and high-quality energy back-up.

Salicru's **UBT** battery range includes 90 Ah at 12 V.

The sulphuric acid electrolyte is absorbed by the separators and plates. And these in turn immobilised. They are designed using gas recombination technology which eliminates the need for the regular addition of water by controlling the evolution of hydrogen and oxygen during charging. The battery is completely sealed and watertight and therefore maintenance free, enabling it to be used in any position. If the battery is accidentally overcharged, resulting in the production of hydrogen and oxygen, a number of special one-way valves allow the gases to escape to avoid interior overpressure.

## Applications:

Uninterruptible power supply systems (UPS), emergency lighting systems, signalling systems, communications and electrical equipment, broadcasting systems, lift automation panels, electronic cash registers, etc.

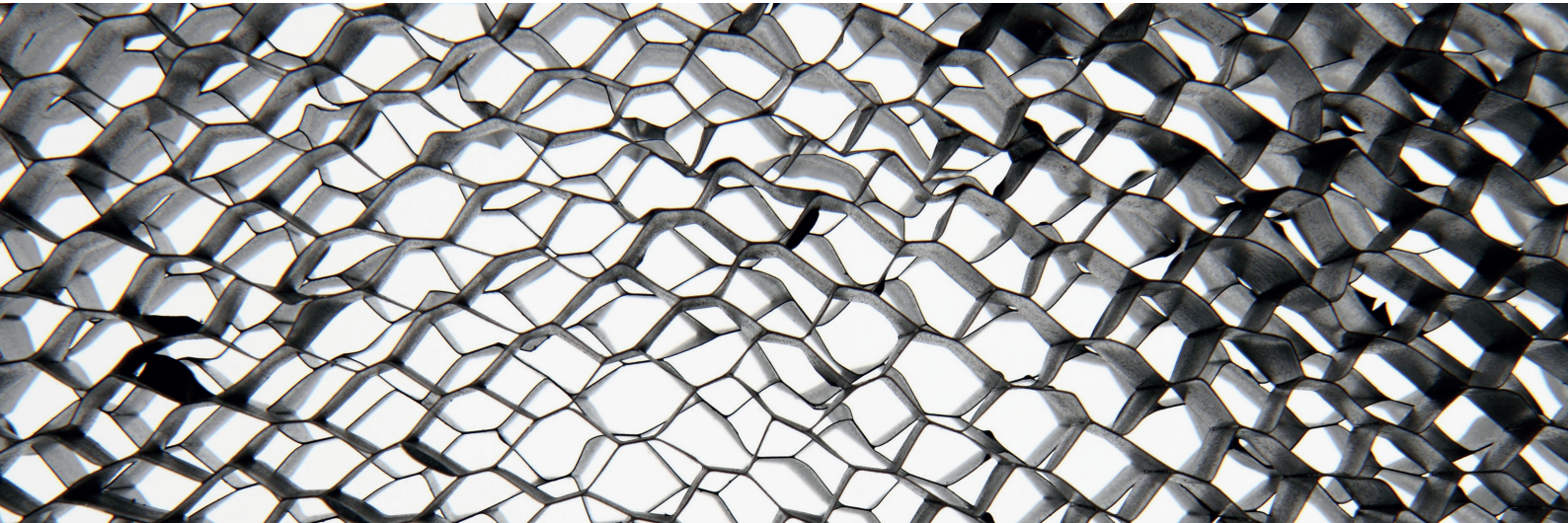

**SALICRU**

## Performances

- AGM technology for efficient gas recombination of up to 99% and free of maintenance or adding water.
- No restrictions for air transport, compliance with IATA/ICAO Special Provision A67.
- Can be mounted in any position.
- Lead designed by computer with calcium/tin alloy rack for high energy density.
- Long service life in both float and cyclic applications.
- Maintenance-free.
- Low self-discharge



## Battery compatibility vs series

	UBT 12/90
SLC CUBE3+	•
SLC CUBE4	•
SLC ADAPT2	•
SLC X-PERT	•
SLC X-TRA	•

## Battery construction

COMPONENT	RAW MATERIAL
Positive plate	Lead dioxide
Negative plate	Lead
Container	ABS
Lid	ABS
Safety valve	Rubber
Terminal	Copper
Separator	AGM
Electrolyte	Sulphuric acid

## Dimensions



UBT 12/90

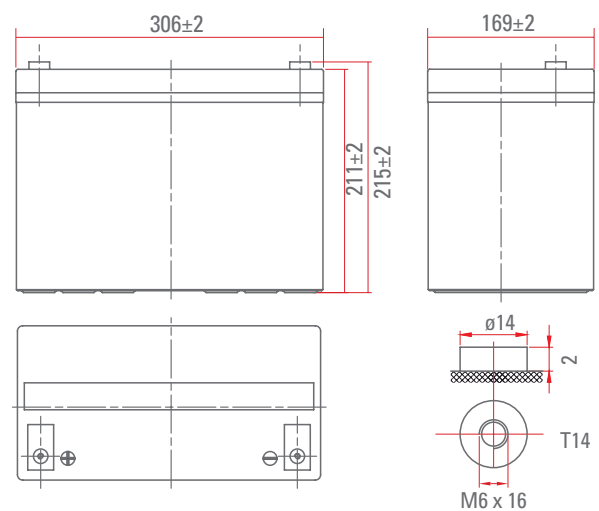

# Behaviour charts

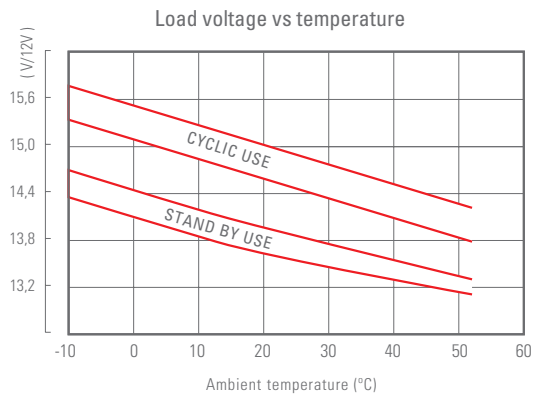
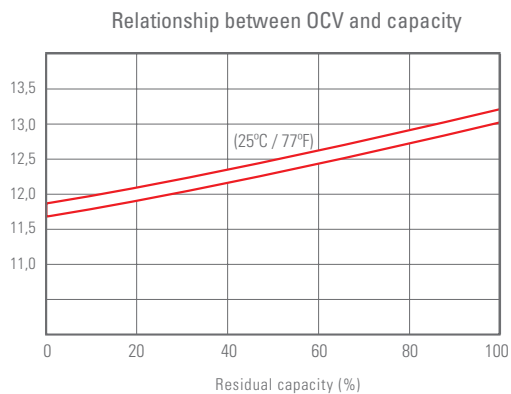
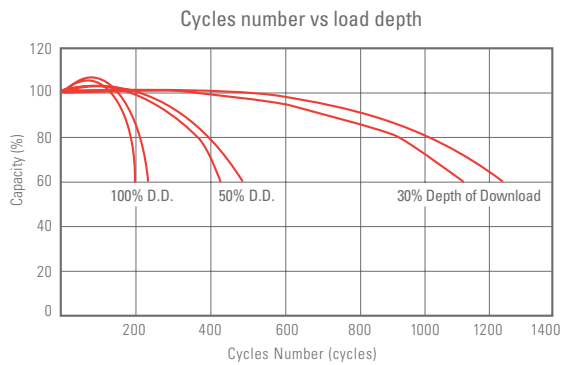
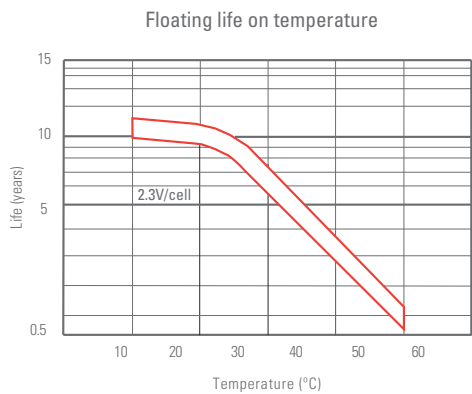
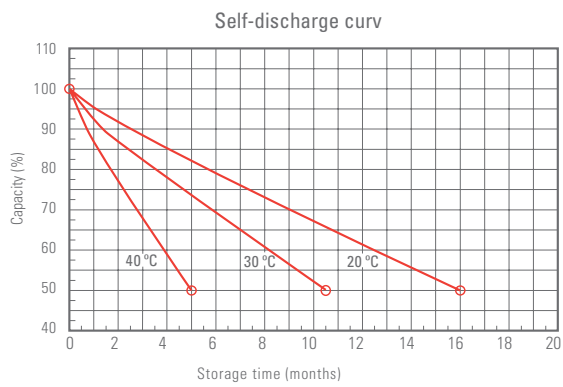
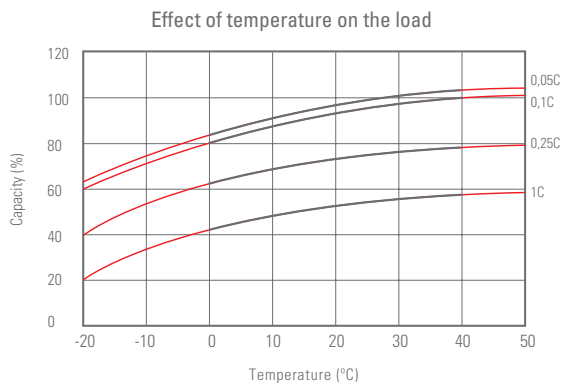
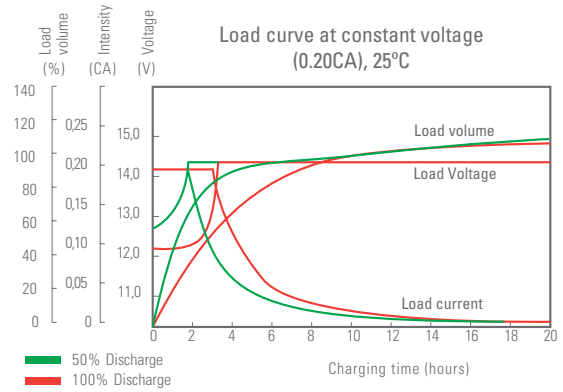
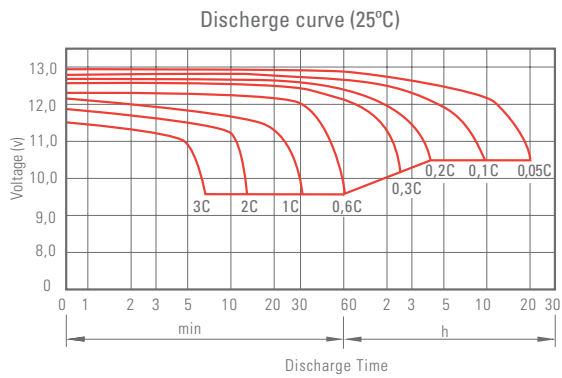

## Technical specifications

MODEL		UBT 12/90
Nominal voltage (V)		12
Number of cells		6
Rated capacity at 25°C	20 hours	95.40 Ah (4.77 A, 10.8 V)
	10 hours	90 Ah (2.24 A, 10.8 V)
	5 hours	77 Ah (4.10 A, 10.8 V)
	1 hour	50.10 Ah (15.40 A, 10.8 V)
Internal resistance		≤5 mΩ <sup>(1)</sup>
Self-discharge		3% <sup>(2)</sup>
Operating temperature range	Discharge	-15°C ÷ +50°C
	Charge	-10°C ÷ +50°C
	Storage	-20°C ÷ +50°C
Maximum discharge current		800 A (5s)
Dimensions	Depth	306 mm ±2 mm
	Width	169 mm ±2 mm
	Height	211 mm ±2 mm
Overall dimensions (with connectors)	Height	215 mm ±2 mm
Weight		27 Kg
CODE		013BS000023

(1) Fully charged battery at 25°C

(2) Reduction of capacity per month at 20°C (average)

Information subject to change without notice.

## Constant discharge current (25°C)

Cut-off voltage per cell (V/cell)	10 min	15 min	30 min	60 min	2 h	3 h	4 h	5 h	8 h	10 h	20 h
9.60 V	196	151	90.5	55.6	32.9	23.7	18.9	16.2	11.1	9.16	4.86
9.90 V	190	148	88.6	54.8	32.7	23.5	18.8	16.1	11.0	9.14	4.85
10.2 V	182	142	85.9	53.4	23.4	23.4	18.7	16.0	11.0	9.12	4.83
10.5 V	175	137	83.8	51.7	31.9	23.2	18.5	15.8	10.9	9.06	4.80
10.8 V	165	130	80.8	50.1	31.1	22.5	18.0	15.4	10.6	9.00	4.77

## Constant discharge power (25°C)

Cut-off voltage per cell (V/cell)	10 min	15 min	30 min	60 min	2 h	3 h	4 h	5 h	8 h	10 h	20 h
9.60 V	2119	1660	1015	634	381	279	222	191	132	109	58.3
9.90 V	2055	1620	995	625	379	277	221	190	131	109	58.2
10.2 V	1971	1561	964	609	375	275	220	189	130	109	58.0
10.5 V	1886	1507	941	590	370	273	218	187	129	108	57.6
10.8 V	1780	1428	906	571	360	265	211	182	125	107	57.2

The data shown above relates to average values obtained after 3 charge/discharge cycles, not minimum values.

