

FORREY 12 (FOR-20042-SO-20) (Version 1)



Product description

Made to order for 20 W Vertical solar PV pole



Luminaire Structure

- High-efficiency PMMA lens

- Integral control gear

Optic

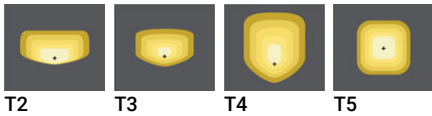

Product colour

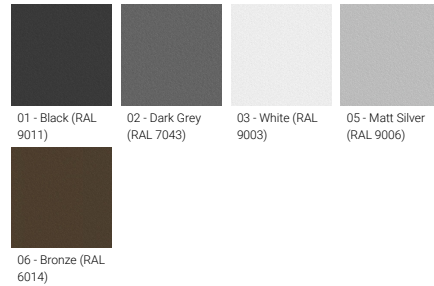

Special finishes upon request

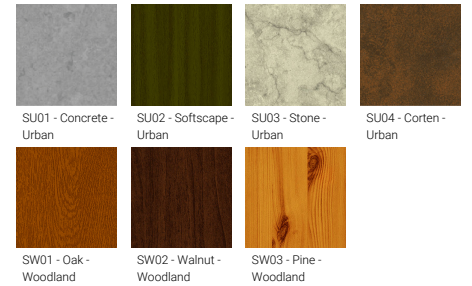

FORREY 12 (FOR-20042-SO-20) (Version 1)

Technical information

Material	Aluminium
Light source	1 COB
Power	20 W
Lumen	1704 - 1982 lm
Efficacy	85 - 99 lm/W
Driver option	Integral control gear
Driver	Constant current (CC)

Input voltage	Solar 36 VDC
Optic	T2, T3, T4, T5
Optic value	140°x100°, 132°x103°, 137°x117°, 73°
CCT / CRI	3000K CRI80, 4000K CRI80
Dimming type	Dusk to Dawn, 2 Step dimming with motion sensor override, Solar Custom
Product colours	Black, Dark Grey, White, Matt Silver, Bronze, Concrete - Urban, Softscape - Urban, Stone - Urban, Corten - Urban, Oak - Woodland, Walnut - Woodland, Pine - Woodland
Weight	17.0 kg

Operating temperature	-20 °C to 40 °C
Lens / Reflector / Optic	High-efficiency PMMA lens
MacAdam Ellipse	3 SDCM
Lifetime L90B10 (hours)	> 50,700
Lifetime L80B10 (hours)	> 63,500
Lifetime L80B50 (hours)	> 63,500

FOR-20042

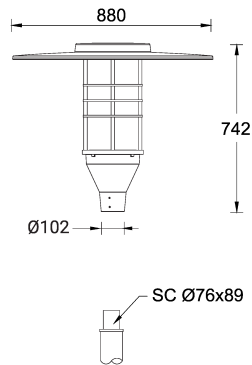

FORREY 12 (FOR-20042-SO-20) (Version 1)

Accessory



Remote solar charge controller
for Solar Integrated Bollards and
Vertical Solar PV poles
A92691



Vertical solar PV pole 1
SOL-20001



Vertical solar PV pole 2
SOL-20011



Vertical solar PV pole 6
SOL-20051



Auto dimming feature
auto-dim
