

**STEAMER 1 (SE-90002-SO-60) (Version 1)**



**Product description**

Made to order for 60 W Vertical solar PV pole



**Luminaire Structure**

- Clear toughened glass

- High-efficiency PMMA lens

**Optic**

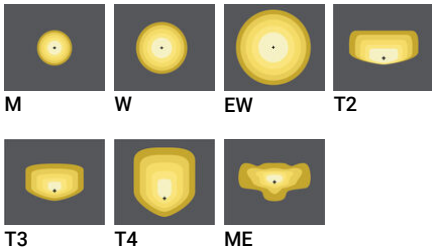

**Product colour**

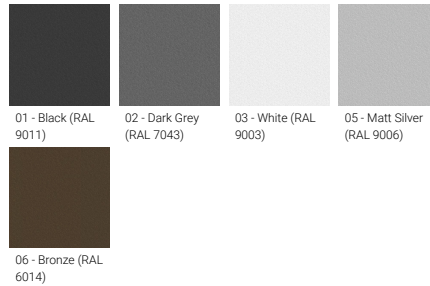

**Special finishes upon request**

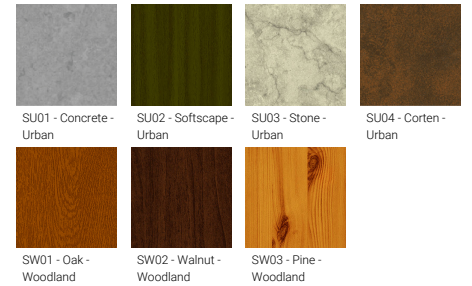

**STEAMER 1 (SE-90002-SO-60) (Version 1)**

**Technical information**

<b>Material</b>	Aluminium
<b>Light source</b>	24 LED
<b>Power</b>	60 W
<b>Lumen</b>	6647 - 8116 lm
<b>Efficacy</b>	111 - 135 lm/W
<b>Driver</b>	Constant current (CC)
<b>Input voltage</b>	Solar 36 VDC

<b>Optic</b>	M, W, EW, T2, T3, T4, ME
<b>Optic value</b>	30°, 57°, 105°x115°, 136°x51°, 119°x86°, 102°x74°, 137°x58°
<b>CCT / CRI</b>	2700K CRI80, 3000K CRI80, 4000K CRI80
<b>Bug</b>	B1-U0-G1, B2-U0-G0, B2-U0-G1, B2-U0-G2, B3-U0-G0, B3-U0-G1
<b>ULR</b>	<1%
<b>ULOR</b>	<1%
<b>CIE flux code n°3</b>	97, 98, 99

<b>Dimming type</b>	Dusk to Dawn, 2 Step dimming with motion sensor override, Solar Custom
<b>Product colours</b>	Black, Dark Grey, White, Matt Silver, Bronze, Concrete - Urban, Softscape - Urban, Stone - Urban, Corten - Urban, Oak - Woodland, Walnut - Woodland, Pine - Woodland
<b>Weight</b>	10.1 kg
<b>Operating temperature</b>	-20 °C to 40 °C
<b>Lens / Reflector / Optic</b>	Clear toughened glass, High-efficiency PMMA lens

SE-90002

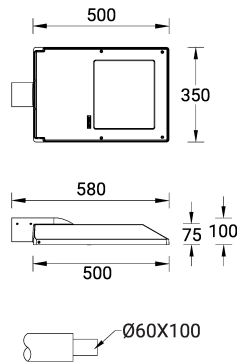

**STEAMER 1** (SE-90002-SO-60) (Version 1)**Accessory**

---



Remote solar charge controller  
for Solar Integrated Bollards and  
Vertical Solar PV poles  
**A92691**



Vertical solar PV pole 3  
**SOL-20021**



Vertical solar PV pole 4  
**SOL-20031**



Vertical solar PV pole 5  
**SOL-20041**



Vertical solar PV pole 7  
**SOL-20061**



IoT Module  
**A95591**



Auto dimming feature  
**auto-dim**