

**ARDEN 3 (ARD-80245)**



**Product description**

Down - 875 mm - RGBW DMX



microPrim™

**Luminaire Structure**

- Extruded aluminium bended profile with powder coating
- Passive thermal management
- Stainless steel fasteners in grade 304 with zinc flake coating (ZFC)

- PMMA diffuser with Opal (UGR <19) and micro prismatic (UGR <13) options for better glare control
- Integral control gear
- Down light distribution only

- Wireless control available through Bluetooth connection
- Emergency module (1 or 3 hours) is available upon request with 3 options (BASIC, SELF-TEST, PRO-DALI)

**Optic**

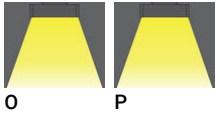

**Product colour**



**Special finishes upon request**

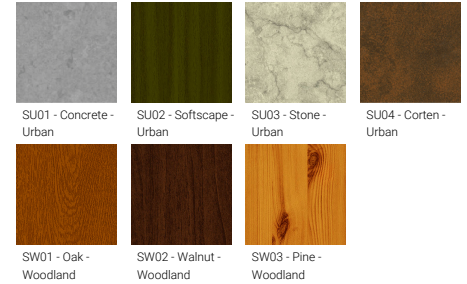

**ARDEN 3 (ARD-80245)**

**Technical information**

<b>Material</b>	Aluminium
<b>Light source</b>	6048 LED
<b>Power</b>	189 W
<b>Lumen</b>	5716 lm
<b>Efficacy</b>	30 lm/W
<b>Driver option</b>	Integral control gear

<b>Driver</b>	Constant current (CC)
<b>Input voltage</b>	220-240 V 50/60 Hz
<b>Optic</b>	O, P
<b>Optic value</b>	108°, 93°
<b>CCT / CRI</b>	RGBW40
<b>Dimming type</b>	DMX, DMX/RDM

<b>Product colours</b>	Black, White, Matt Silver, Concrete - Urban, Softscape - Urban, Stone - Urban, Corten - Urban, Oak - Woodland, Walnut - Woodland, Pine - Woodland
<b>Weight</b>	14.6 kg
<b>Operating temperature</b>	-20 °C to 40 °C
<b>Lens / Reflector / Optic</b>	PMMA diffuser with Opal (UGR <19) and micro prismatic (UGR <13) options for better glare control
<b>Variants (DMX/RDM)</b>	Compatible with EN/ IEC 60598-2-22: Suitable for emergency installations as central supply, non-maintained (Z0)

ARD-80245

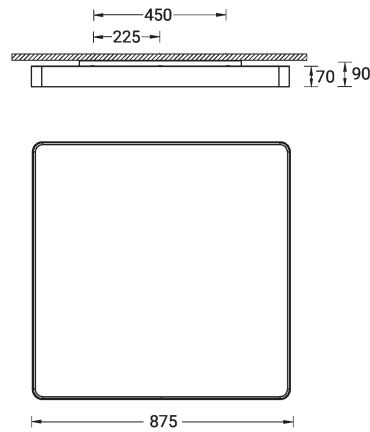

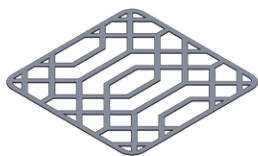
**ARDEN 3 (ARD-80245)****Accessory**

Decorative pattern - Type A for  
ARDEN 300 mm  
**A91421**

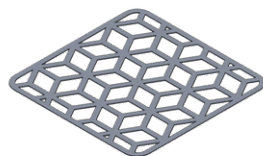

Decorative pattern - Type B for  
ARDEN 300 mm  
**A92821**

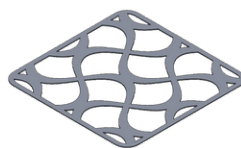

Decorative pattern - Type C for  
ARDEN for ARDEN 300 mm  
**A94221**



PoE Connect  
**A64591**



DMX Control System  
**Control-DMX**



DMX/RDM Control System  
**Control-DMX-RDM**