

**SANDY 7 (SA-31533)**



**Product description**

Large - Tunable White



microPrim™

**Luminaire Structure**

- Die-cast aluminium housing and frame
- Pre-treated before powder coating ensuring high corrosion resistance
- Two cable entries for through wiring
- Stainless steel fasteners in grade 304 with zinc flake coating (ZFC)
- Durable silicone rubber gasket
- Opal UV-stabilised polycarbonate diffuser
- Integral control gear
- Optional surface mounting box for easy wiring or conduit connection when wiring from behind is not possible

**Optic**

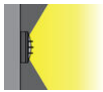

6

**Product colour**



**Special finishes upon request**



**SANDY 7 (SA-31533)**

**Technical information**

<b>Material</b>	Aluminium	<b>Optic</b>	G	<b>Product colours</b>	Black, Dark Grey, White, Matt Silver, Bronze, Concrete - Urban, Softscape - Urban, Stone - Urban, Corten - Urban, Oak - Woodland, Walnut - Woodland, Pine - Woodland
<b>Light source</b>	192 LED	<b>Optic value</b>	114°x103°	<b>Weight</b>	4.0 kg
<b>Power</b>	28 W	<b>CCT / CRI</b>	TW (2700K - 6500K)	<b>Operating temperature</b>	-20 °C to 40 °C
<b>Lumen</b>	2044 lm	<b>Bug</b>	B0-U4-G2	<b>Through wiring</b>	Two cable entries for through wiring
<b>Efficacy</b>	73 lm/W	<b>ULR</b>	49	<b>Lens / Reflector / Optic</b>	Opal UV-stabilised polycarbonate diffuser
<b>Driver option</b>	Integral control gear	<b>ULOR</b>	49	<b>Variants (DALI)</b>	Compatible with EN/ IEC 60598-2-22: Suitable for emergency installations as central supply, non-maintained (Z0)
<b>Driver</b>	Constant current (CC)	<b>CIE flux code n°3</b>	69		
<b>Input voltage</b>	220-240 V 50/60 Hz	<b>Dimming type</b>	DALI		

**SA-31533**

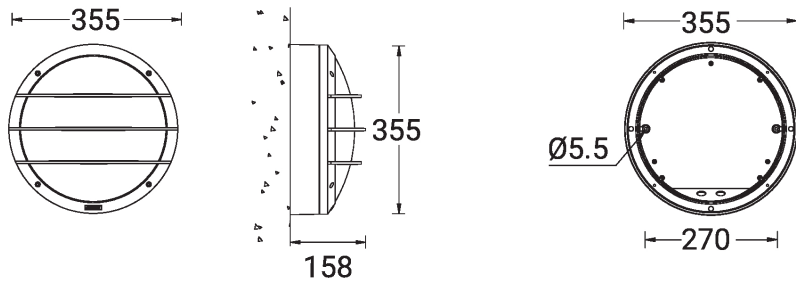

**SANDY 7** (SA-31533)**Accessory**

---



---

Surface mounting box for easy  
cabling (SANDY 6)  
**SCE-SANDY-6**

---