

VERANDA 3 (VR-70293)



Product description

Large



microPrim™

Luminaire Structure

- Die-cast aluminium housing
- Pre-treated before powder coating ensuring high corrosion resistance
- Single cable entry
- One IP68 connector supplied with 0.2 m of 3x1.0 sqmm outdoor cable
- Stainless steel fasteners in grade 304 with zinc flake coating (ZFC)
- Durable silicone rubber gasket
- High-efficiency polycarbonate lens
- Integral control gear

Optic

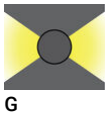

G

Product colour

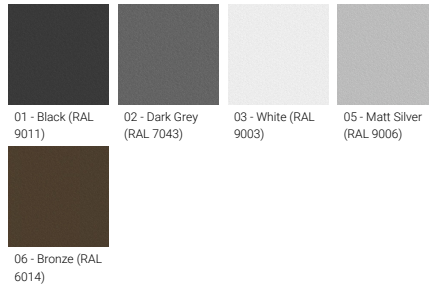

Special finishes upon request

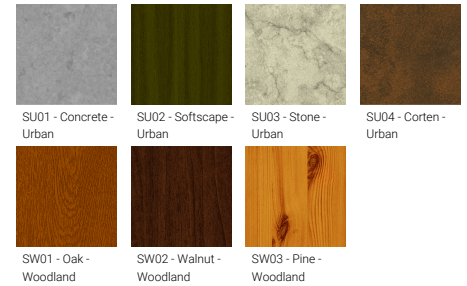

VERANDA 3 (VR-70293)

Technical information

| | |
|----------------------|-----------------------|
| Material | Aluminium |
| Light source | 2 x 1 COB |
| Power | 8 W |
| Lumen | 250 - 269 lm |
| Efficacy | 31 - 34 lm/W |
| Driver option | Integral control gear |
| Driver | Constant current (CC) |

| | |
|------------------------|--|
| Input voltage | 220-240 V 50/60 Hz |
| Optic | G |
| Optic value | 90° / 90° |
| CCT / CRI | 3000K CRI80, 4000K CRI80 |
| Dimming type | On/Off, 1-10V, DALI |
| Product colours | Black, Dark Grey, White, Matt Silver, Bronze, Concrete - Urban, Softscape - Urban, Stone - Urban, Corten - Urban, Oak - Woodland, Walnut - Woodland, Pine - Woodland |
| Weight | 5.8 kg |

| | |
|---------------------------------------|---|
| Operating temperature | -20 °C to 40 °C |
| Cable | One IP68 connector supplied with 0.2 m of 3x1.0 sqmm outdoor cable |
| Through wiring | Single cable entry |
| Lens / Reflector / Optic | High-efficiency polycarbonate lens |
| MacAdam Ellipse | 3 SDCM |
| Lifetime L90B10 (hours) | > 50,000 |
| Variants (On/Off, 1-10V, DALI) | Compatible with EN/ IEC 60598-2-22: Suitable for emergency installations as central supply, non-maintained (Z0) |

Veranda 3

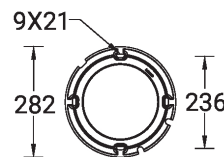
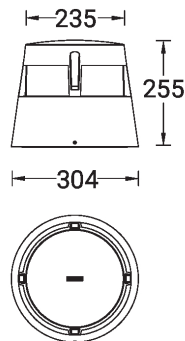

Mounting detail

VERANDA 3 (VR-70293)**Accessory**

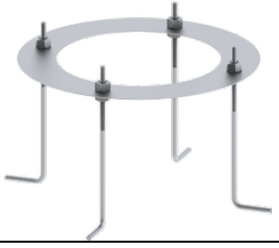

Anchor bolt
A70191
