

**COLUMBUS 1 (CO-10117-2-1MS)**



**Product description**

Ø216 - 711 mm - Flat top - With integrated motion sensor - 1 side



**Luminaire Structure**

- Die-cast aluminium housing
- Extruded aluminium column
- Pre-treated before powder coating ensuring high corrosion resistance
- Single cable entry
- One IP68 connector supplied with 0.2 m of 3x1.0 sqmm outdoor cable
- Stainless steel fasteners in grade 304 with zinc flake coating (ZFC)
- Durable silicone rubber gasket
- Anodised, high-purity aluminium reflector
- Clear UV-stabilised polycarbonate diffuser
- Integral control gear

**Optic**



G

**Product colour**



**Special finishes upon request**



**COLUMBUS 1 (CO-10117-2-1MS)**

**Technical information**

|                      |                       |
|----------------------|-----------------------|
| <b>Material</b>      | Aluminium             |
| <b>Light source</b>  | 1 COB                 |
| <b>Power</b>         | 41 W                  |
| <b>Lumen</b>         | 983 - 995 lm          |
| <b>Efficacy</b>      | 25 - 26 lm/W          |
| <b>Driver option</b> | Integral control gear |
| <b>Driver</b>        | Constant current (CC) |
| <b>Input voltage</b> | 220-240 V 50/60 Hz    |

|                          |                          |
|--------------------------|--------------------------|
| <b>Optic</b>             | G                        |
| <b>Optic value</b>       | 115°x 129°               |
| <b>CCT / CRI</b>         | 3000K CRI80, 4000K CRI80 |
| <b>Bug</b>               | B1-U3-G1                 |
| <b>ULR</b>               | 21%                      |
| <b>ULOR</b>              | 21%                      |
| <b>CIE flux code n°3</b> | 88                       |
| <b>Dimming type</b>      | 1-10V                    |

|                                 |  |
|---------------------------------|--|
| <b>Product colours</b>          | Black, Dark Grey, White, Matt Silver, Bronze, Concrete - Urban, Softscape - Urban, Stone - Urban, Corten - Urban, Oak - Woodland, Walnut - Woodland, Pine - Woodland |
| <b>Weight</b>                   | 8.4 kg   |
| <b>Operating temperature</b>    | -20 °C to 40 °C  |
| <b>Cable</b>                    | One IP68 connector supplied with 0.2 m of 3x1.0 sqmm outdoor cable   |
| <b>Through wiring</b>           | Single cable entry   |
| <b>Lens / Reflector / Optic</b> | Anodised, high-purity aluminium reflector, Clear UV-stabilised polycarbonate diffuser  |
| <b>Variants (1-10V)</b>         | Compatible with EN/ IEC 60598-2-22: Suitable for emergency installations as central supply, non-maintained (Z0)  |

**COLUMBUS**

Adjustable sensor (5 seconds – 30 minutes)  
 30° ~ 150° Sensitivity  
 Sensor detection area: 9 m

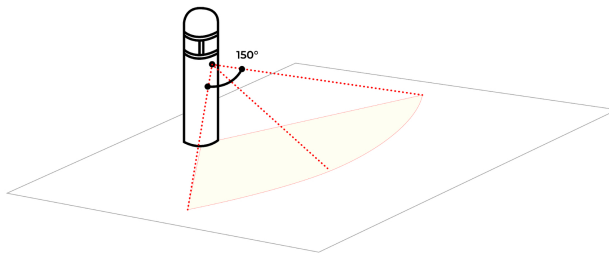

CO-10117-2-1MS

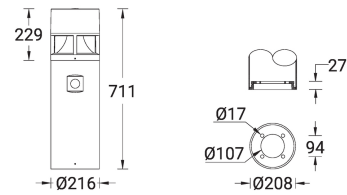

**COLUMBUS 1** (CO-10117-2-1MS)**Accessory**

---



---

Anchor bolt  
**A10491**

---



---

Remote controller for the motion  
sensor - 1-10V  
**A14291**

---