

## For Installation of Line 11 LED tape IP65 Model. ITRB2030000565, ITRB2042000565 (20W/M 24VDC)

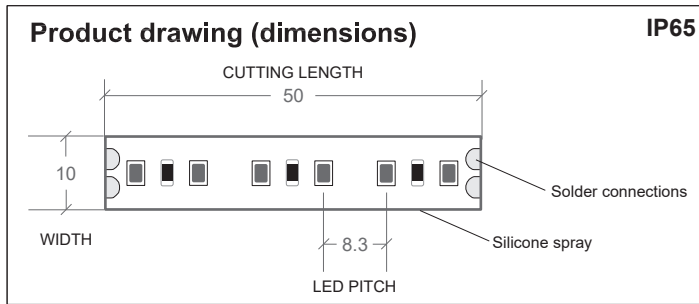

IP65

NOTE:

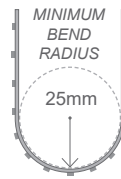
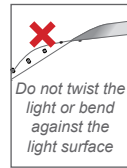

### IP65 WATER-RESISTANT

With an IP65 rating, LED tape can be used in an outside setting and is water-resistant, but is not waterproof and is not suitable to be submerged. Please consider outdoor usage carefully and ensure adequate drainage.

To ensure the IP65 rating, silicone needs to be applied to all LED tape ends / joins.

### CUT

Cut LED tape at the cut marks outlined only.

Silicone needs to be applied to all ends to ensure the LED tape remains water-resistant.

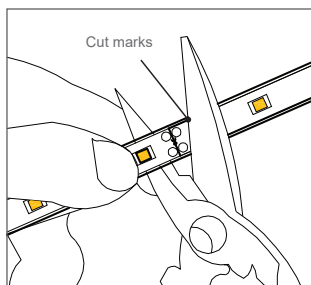

### TO ADD A CABLE CONNECTION

Cut and trim the wires to the appropriate length required. Carefully remove the silicone spray from ends of the LED tape to be connected (can be scratched off). Solder the wires to the soldering pads at the end of the LED tape ensuring the correct +/- polarity to form a continuous electrical circuit.

Reapply silicone to completely cover the strip connection point and end to ensure the LED tape remains water-resistant.

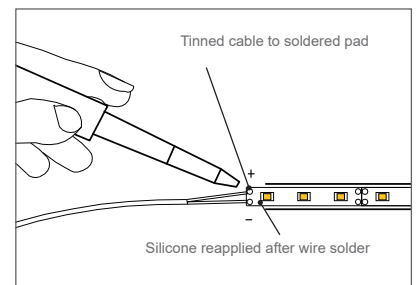

### TO MAKE AN END TO END CONNECTION

To connect one length of LED tape to another, carefully remove the silicone spray from end of the LED tape (can be scratched off). Align LED tape strips end to end matching the correct +/- polarity between both lengths. Heat and solder the two lengths of LED tape together, using the soldering pads on both strips to form a continuous electrical circuit.

Reapply silicone to completely cover both connection ends to ensure the LED tape remains water-resistant.

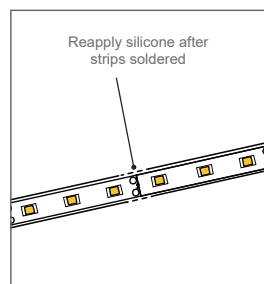
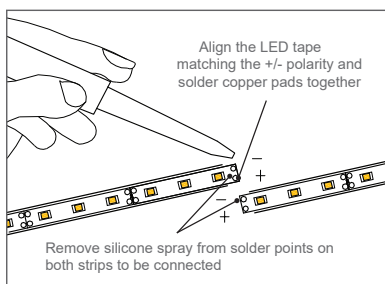

### TO PROVIDE A CORNER CONNECTION

Cut and trim the wires to the appropriate length for the corner. Carefully remove the silicone spray from ends of the LED tape to be connected (can be scratched off). Solder the wires to the soldering pads at end of the LED tape and to the beginning of the new LED tape ensuring the correct +/- polarity to form a continuous electrical circuit.

Reapply silicone to completely cover both connection ends to ensure the LED tape remains water-resistant.

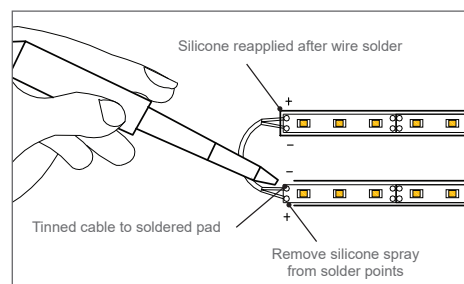

Please note drawings are an installation guide only. Each LED tape application may have variable factors. Cable size may need to be specified to limit the voltage drop throughout the circuit.

Actual product characteristics may vary. Ligman Lighting reserves the right to improve, modify or update the product designs without prior notice.

**ALWAYS UNCOIL BEFORE USE**

- LIGMAN standard products are supplied with the control gear 24VDC  
The control gear for other voltages and frequencies is available upon request, please consult us for more details.
- LIGMAN luminaires are designed to conform IEC 60598 2-2 standard.

Technical amendments and modifications techniques reserved.

## Ligman Lighting

THAILAND  
LIGMAN Lighting Co.,Ltd.  
17/2 Moo 4, Monthong, Bang Nam Prio,  
24150 Chachoengsao - Thailand  
info@ligman.com