

RE DMS 001

1/10V_{DC} Constant Light Control

Description

- Automatic energy saving system for 1/10V_{DC} LED and Fluorescent luminaires: automatically applies to the lamps the level of luminosity required to maintain a previously set minimum illumination level (eg 500lux), compensating daylight.
- It incorporates motion sensor (PIR) function, which allows limiting the activation of the lighting to the presence of people (optional).
- Two working modes: Automatic (Automatic dimming + Motion detection) or Automatic dimming (without motion detection).
- Pre-adjusted from factory to achieve a level of approximately 500lux in the workplace assuming the installation in a "standard" office.
- Possibility of adjusting the minimum level of dimming, avoiding that the luminaires will be switched off.
- Output relay to completely disconnect and switch off the lighting fixtures.
- Flush-ceiling mounting.
- Possibility of expanding the motion detection area using slave sensors.
- Possibility of switching and manual control via pushbutton / switch, using the accessory AC DMS 001.
- Application examples: offices, schools, hospitals...



Technical Characteristics

Reference	RE DMS 001
Power Supply	230V~ 50Hz
Consumption	< 2W
Load Type	1/10V _{DC} Ballast or Driver
Maximum Number of Equipments	80*
*Breaking Capacity	16A
* 1/10V Signal: <ul style="list-style-type: none">· Max. Input Current· Max. Output Current	500mA 40mA
Motion Detection Coverage	360° & Ø7m at 2,5m high
Motion Detection Time Delay	10min ~ 30min
Max. Number of Extra Motion Sensors (DM SEN T03)	Up to 14
Working Temperature	0°C ~ +40°C
Protection Degree	IP20, according to EN20324
Connection Terminals	"Lift" type. Up to 6mm ² section of wire
According to the Standard	EN60730

RE DMS 001

1/10V_{DC} Constant Light Control

Wiring Diagrams

· With Motion Detection:

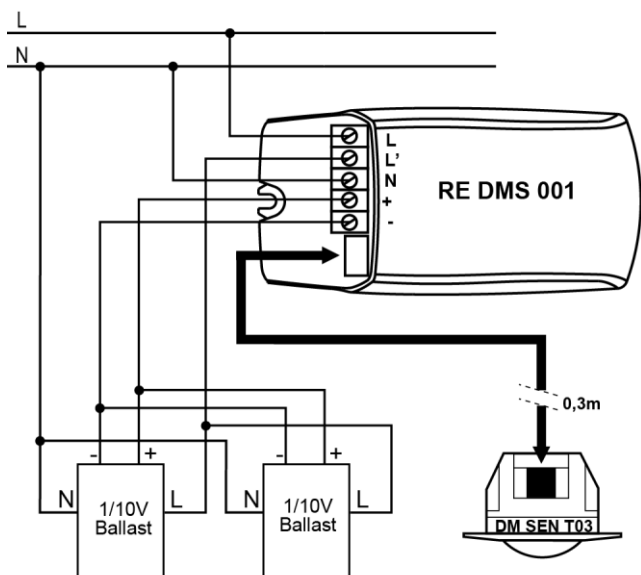

· Without Motion Detection:

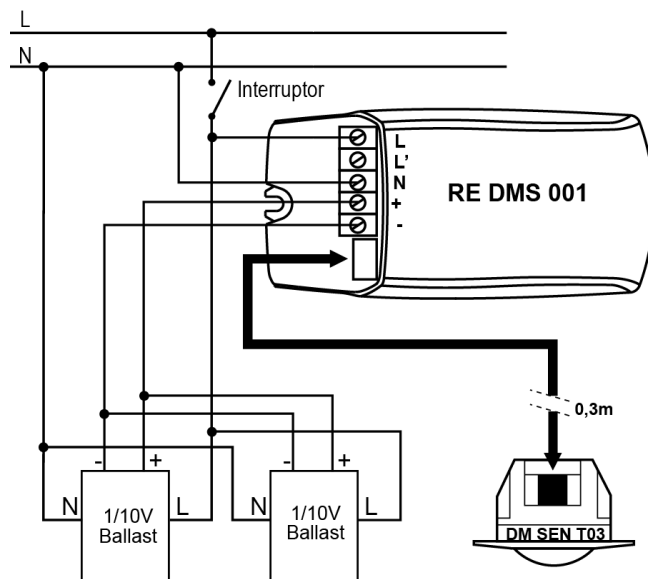

Dimensions

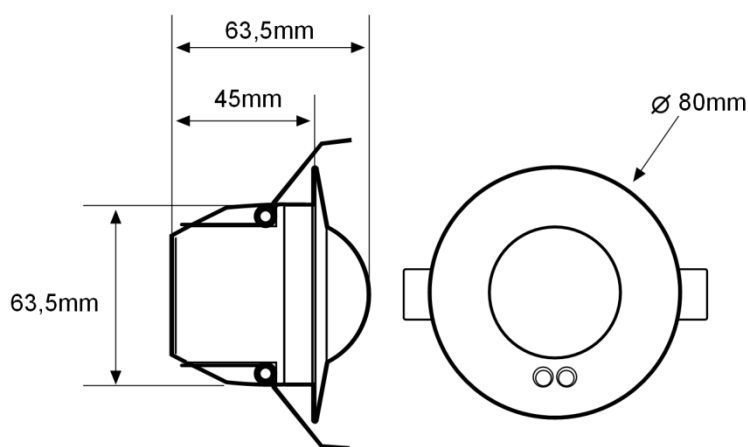

Accessories

CO REG R05 –IR Remote Control for settings adjustment

· It allows re-adjusting the programming of the day and night light points without the need to access to the ceiling, as well as to make a manual dimming in a certain moment.

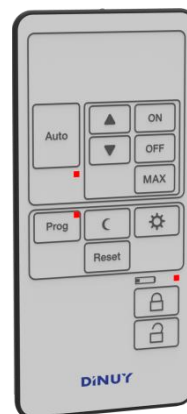

RE DMS 001

1/10V_{DC} Constant Light Control

AC DMS 001 – Accessory for Manual control:

- It allows manual control of the RE DMS 001 from a switch (to select between automatic or manual mode) and a pushbutton (to manually dim or switch).

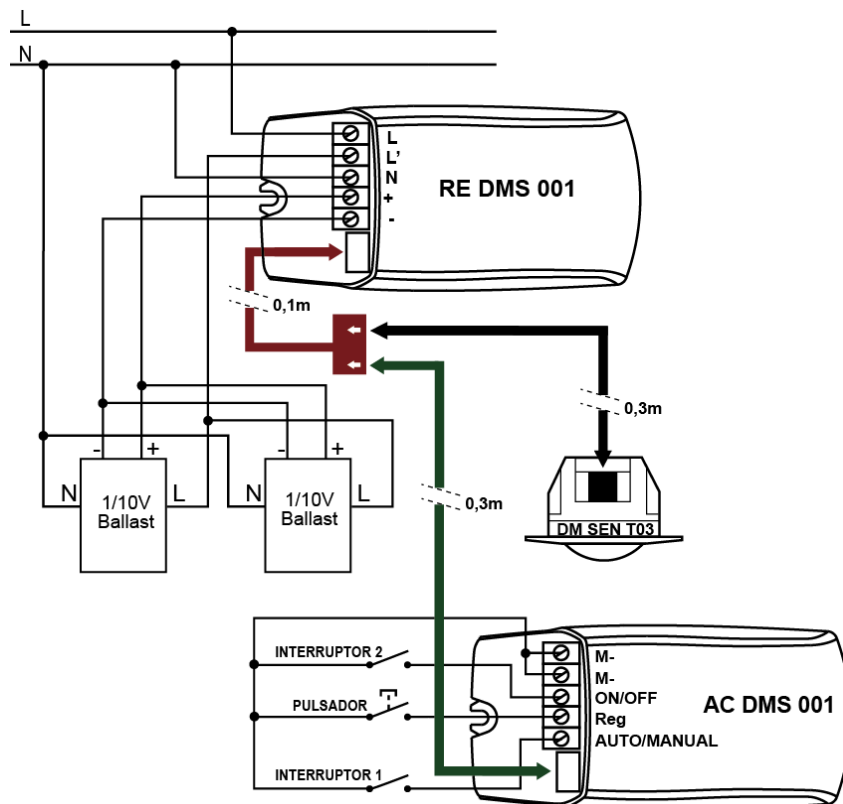

DM SEN T03 – Slave Motion Sensor:

- Allows extending the coverage area of the motion detection cover with a single RE DMS 001.

