

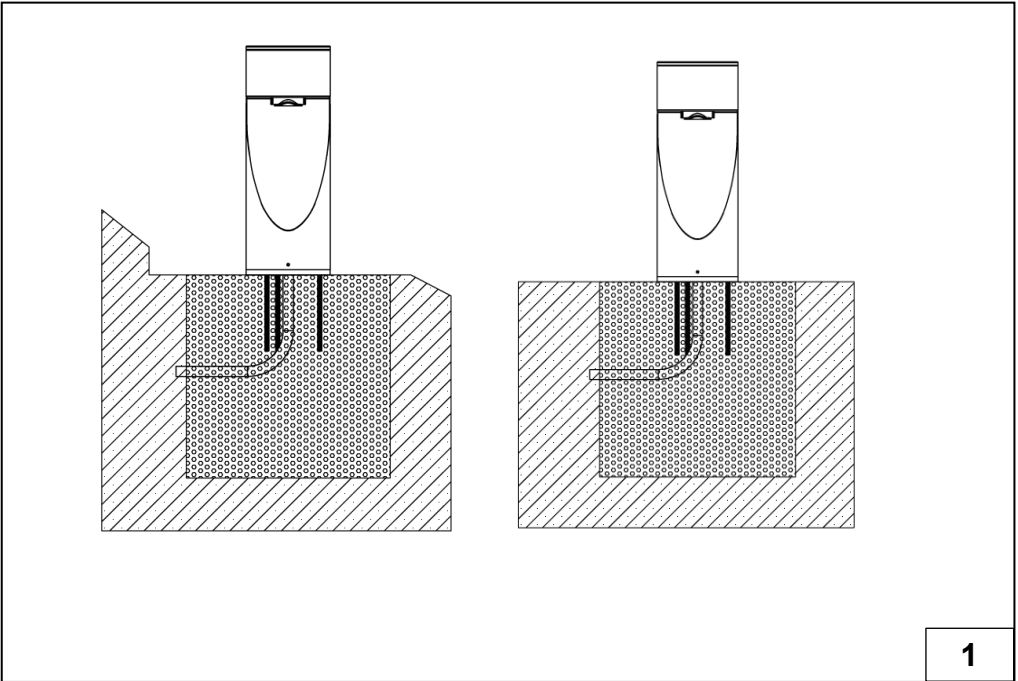

HEPER USA LLC
W227 N546 Westmound Drive
Waukesha
WI 53186 – USA
Tel: +1 917 244 20 32
info@hepergroup.com
www.heperlighting.com

TRIAN S
Installation&Maintenance Instructions



1

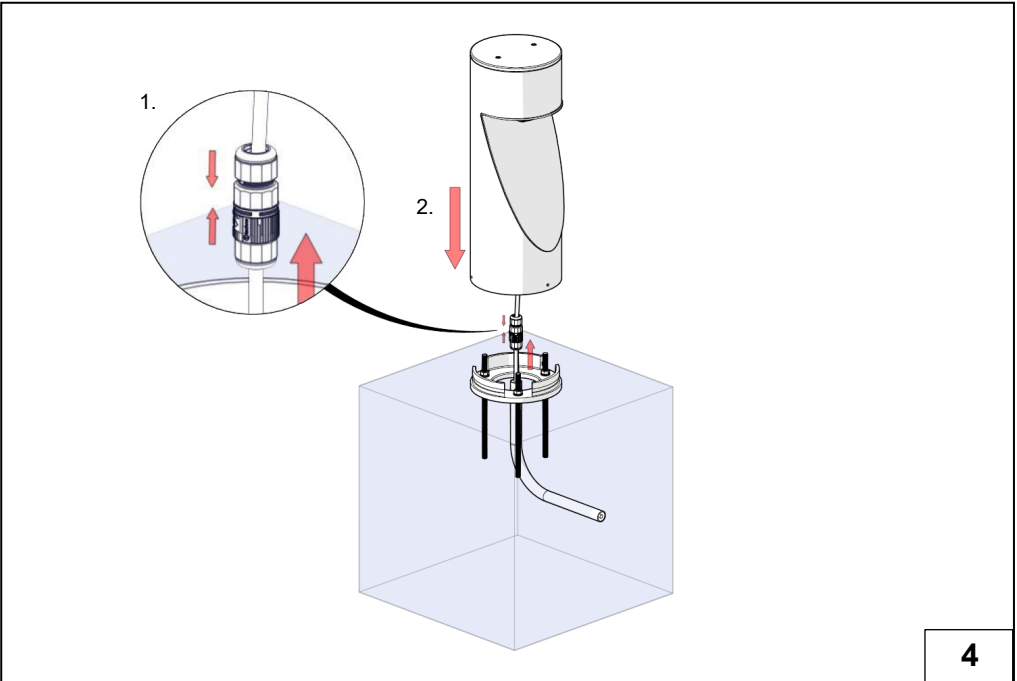

4

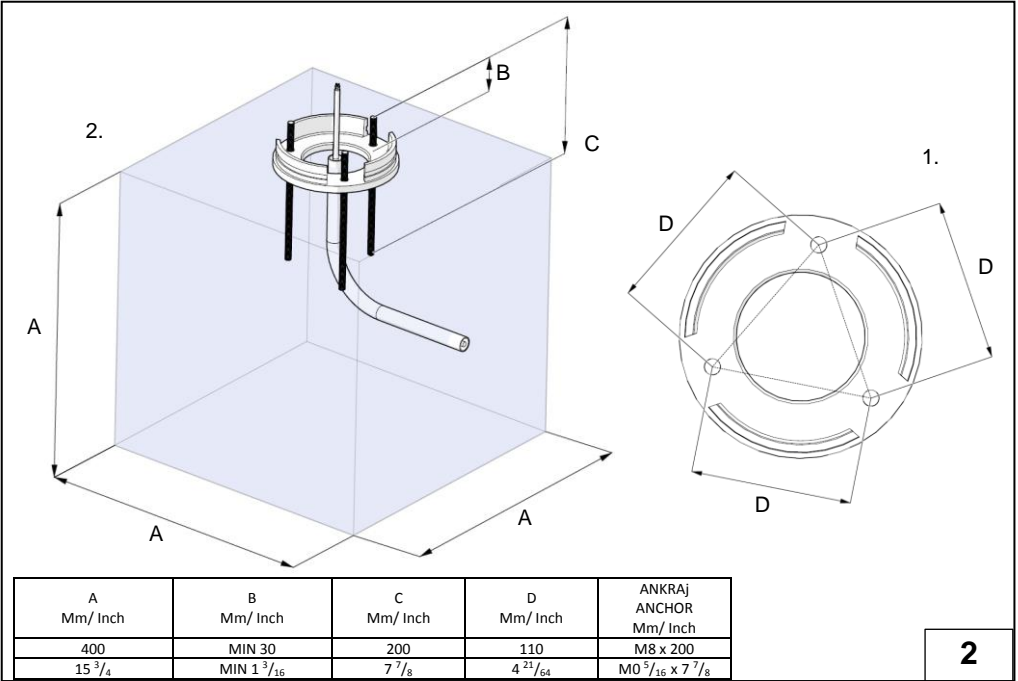

A Mm/ Inch	B Mm/ Inch	C Mm/ Inch	D Mm/ Inch	ANKRAJ ANCHOR Mm/ Inch
400	MIN 30	200	110	M8 x 200
15 3/4	MIN 1 3/16	7 7/8	4 21/64	M0 5/16 x 7 7/8

2

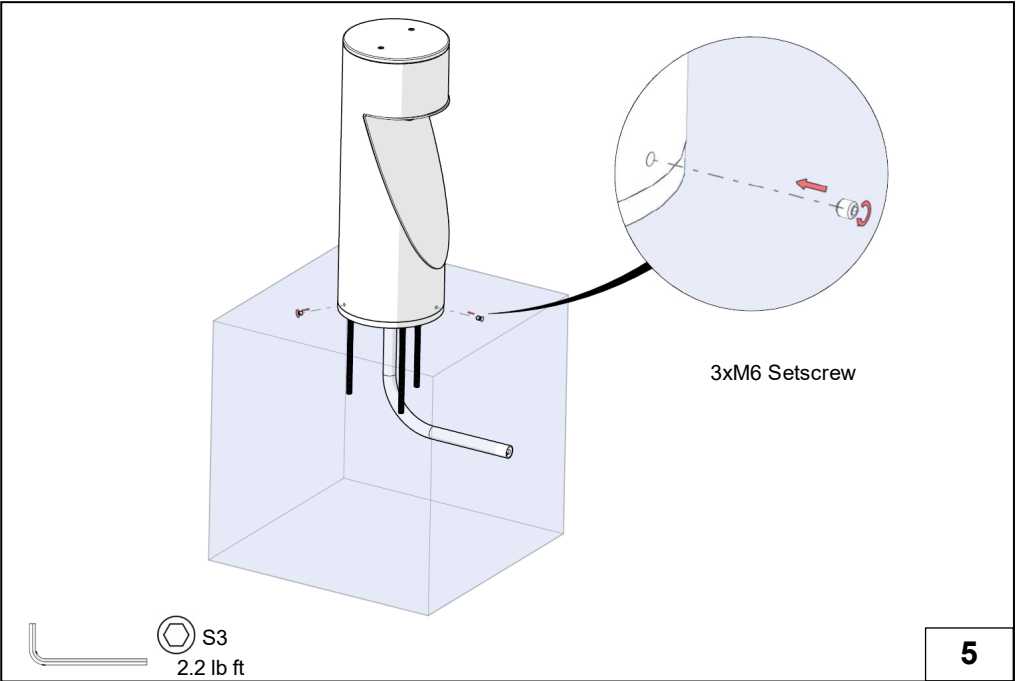

5

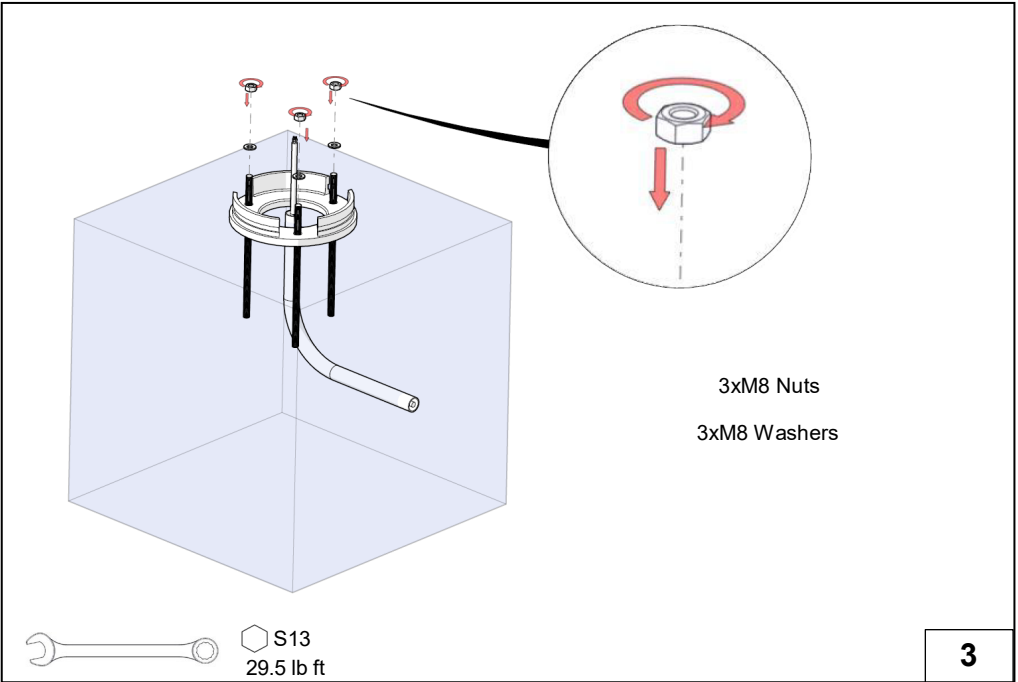

3

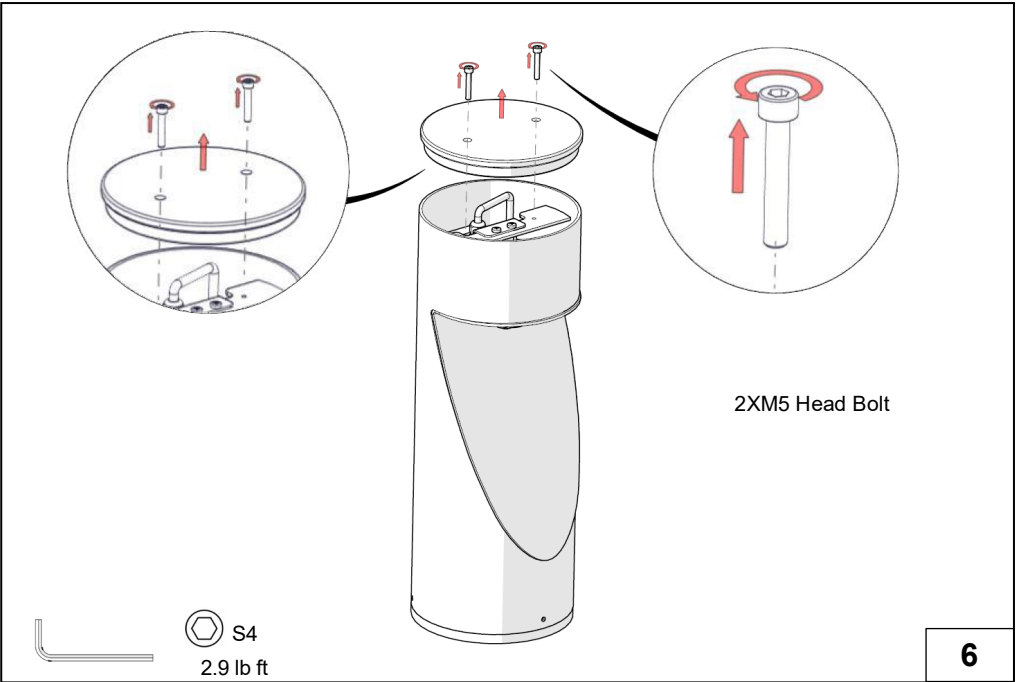

6

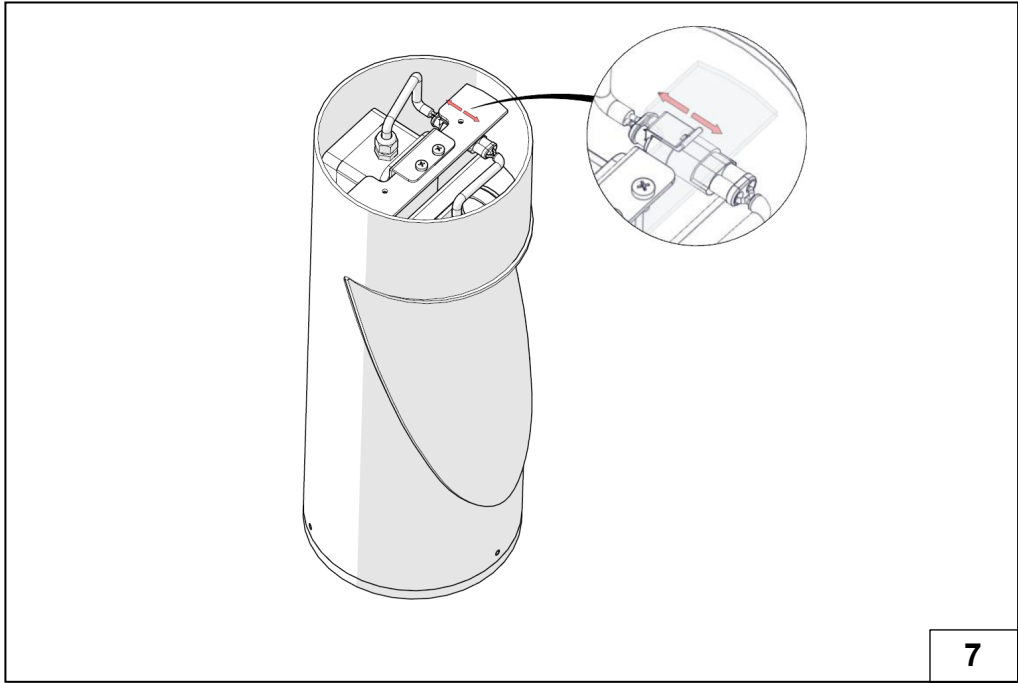

7

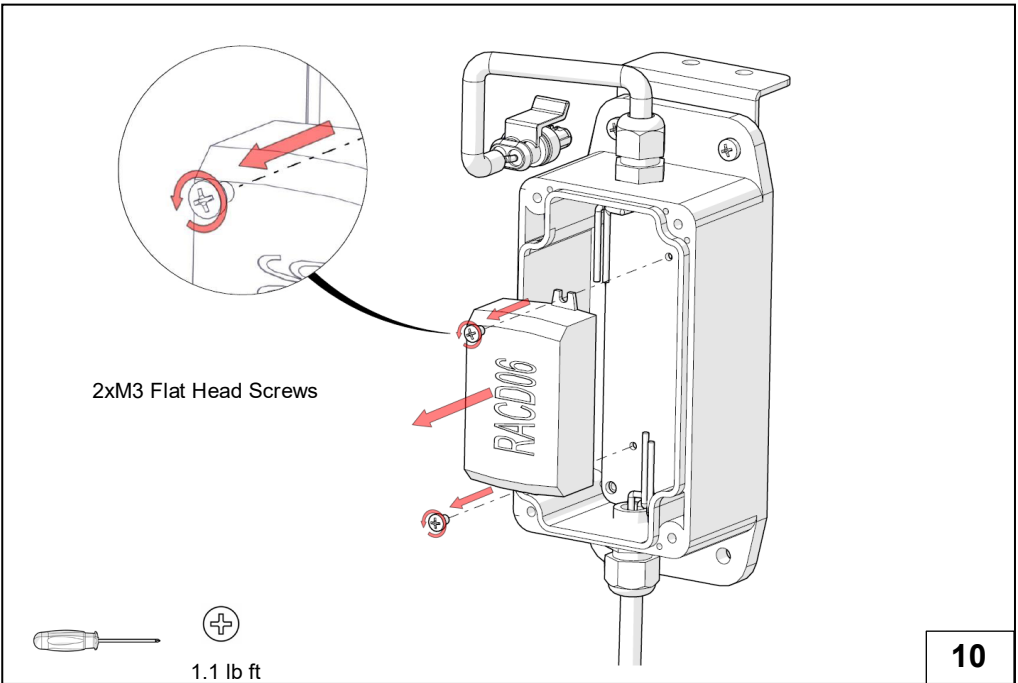

10

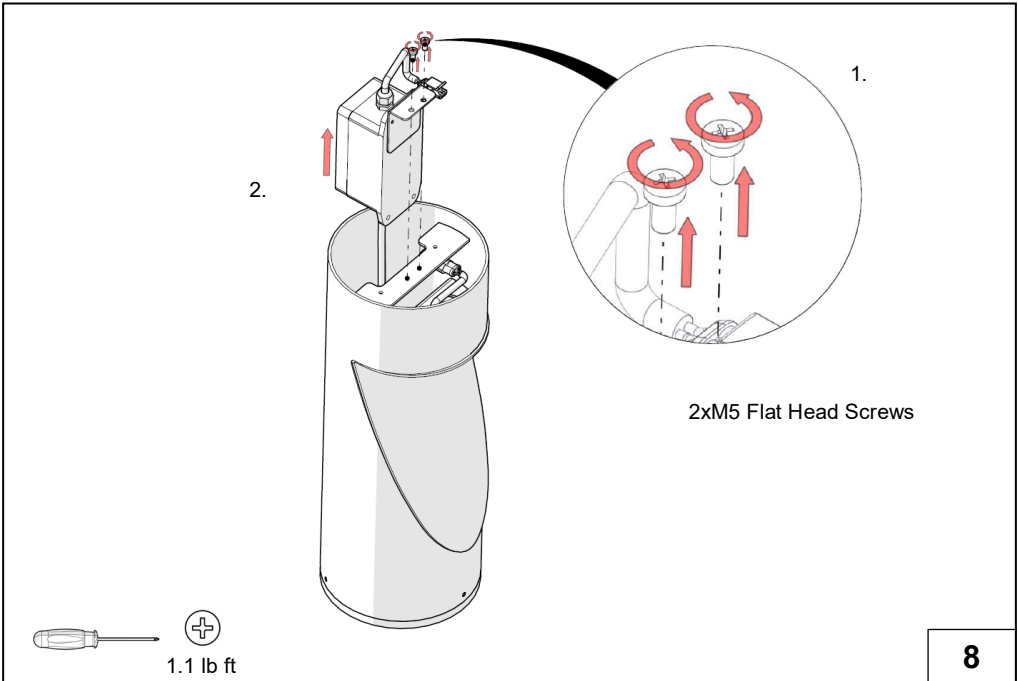

8

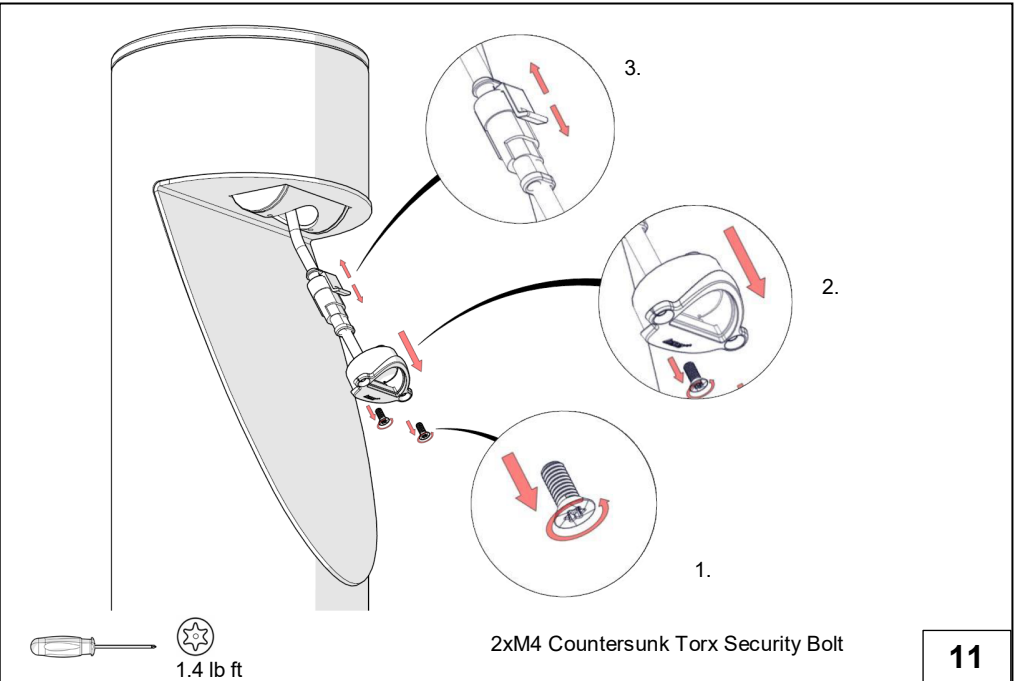

11

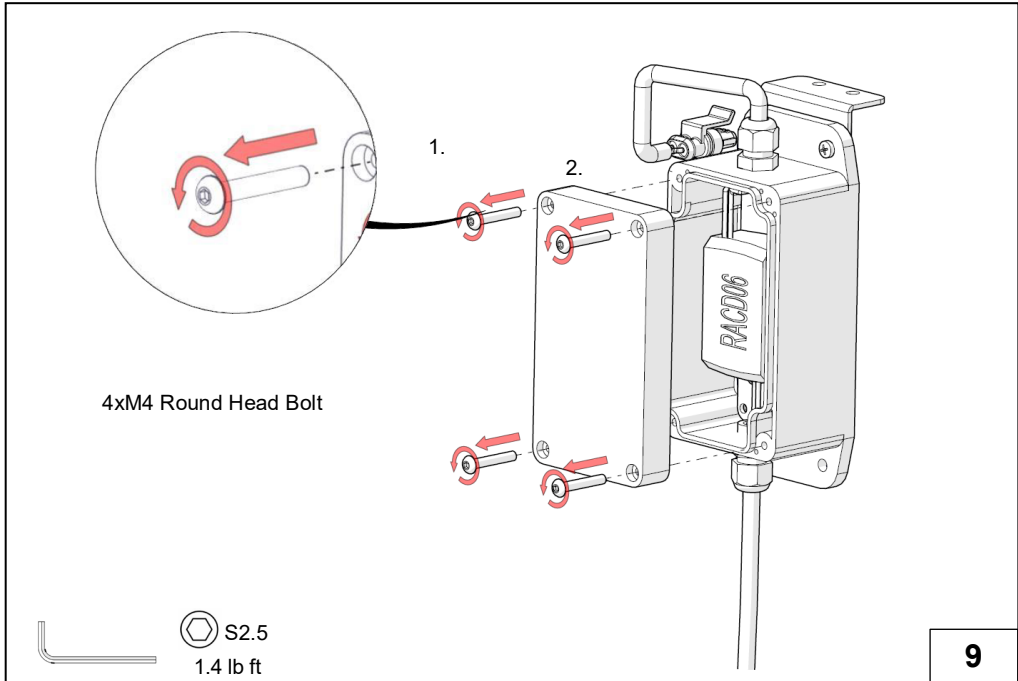

9

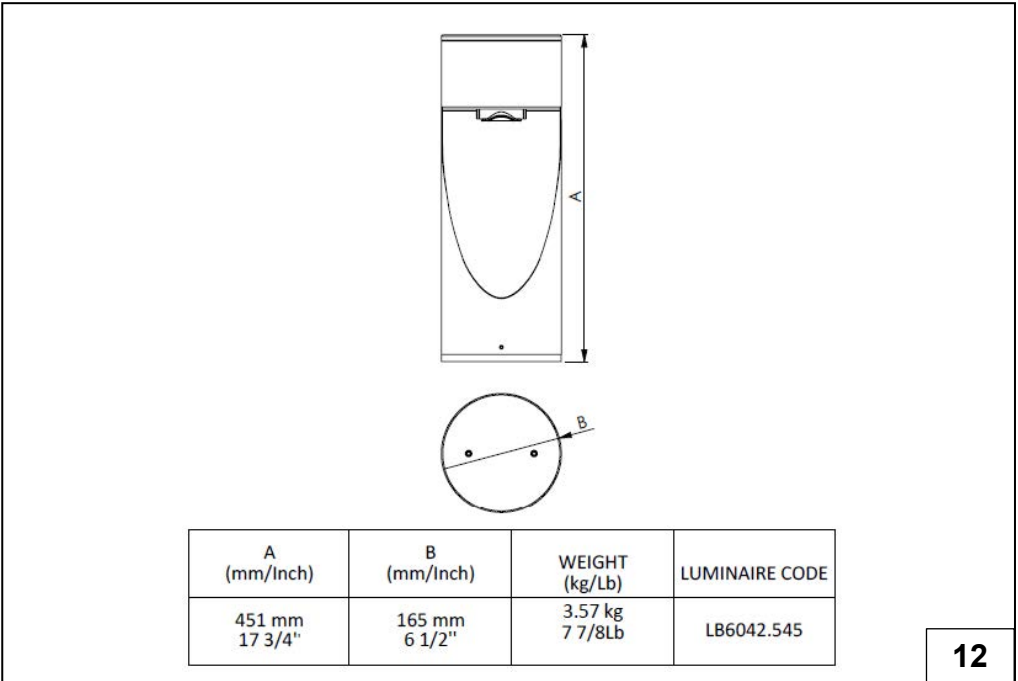

12

English

ASSEMBLY INSTRUCTIONS

The Installation of the Bollard onto the ground;

1. The installation ground must be flat.
2. According to the given concrete dimensions, the empty space in the ground is adjusted.
- 2.1. To make sure that connection holes are aligned perfectly, anchorage plate must be used.
- 2.2. Anchorage end must be higher than 40 mm from the ground using with screws.
3. After the flange of the Bollard is placed, flat washers are placed and the nuts are screwed with 29.5 lb ft torque and at the end lock-nuts are used additionally.(3xM8 Nuts)

4. Stabilization of the Bollard;

- 4.1. The cable coming from the ground and the cable coming out of the product are mounted to each other with the help of the socket.

Note1:The socket that enables the connection between the cables is not provided with the product.Please provide a socket that compatible with the product and has minimum IP66 rating.

Note2:While disconnecting, make sure that the socket is seperated properly.

- 4.2. Bollard is seated in the direction of the figure.
5. The bollard is screwed applying 2.2lb ft torque with a setscrew bolt from the sides.(3xM6 Setscrew Bolt)

To reach the LED Driver;

Note: The mains electrical cables are disconnected.

6. The upper cover and bolts are removed.(2XM5 Imbus Bolt)
7. Handra module and junction box cable connection socket is removed.
- 8.**Taking out of Junction Box;**
- 8.1. Star cylindrical head bolts that hold the junction box sheet are removed.(2xM5 Imbus Bolts)
- 8.2. Junction box is taken out from the bollard.

9.To take the LED Driver out;

- 9.1. The round head bolts on the junction box are removed.
- 9.2. Junction box cover is removed.
10. The bolts that hold the led driver are removed. Accordingly,the led driver is removed.

Note: Be careful not to drop the led driver.

11.To dismantle the Lighting source(Luminaire Part);

- 11.1. To demount the Handra Module;
- 11.2. The bolts that hold the Handra module are taken out.(2xM4 Countersunk Torx Socket Screw)
- 11.3. The socket that connects the cable from the LED driver with the cable that comes out of the Handra module is then removed.

WARNINGS AND REMARKS FOR INSTALLATION AND MAINTENANCE

Safety Instructions

- The light source contained in this luminaire shall only be replaced by the manufacturer or his service agent or a similar qualified person. Always switch off the power prior to installation, maintenance or repair activities.
- The manufacturer is then discharged from liability when damage is caused by improper use or installation.
- If any luminaire is subsequently modified, the persons responsible for the modification shall be considered as manufacturer.
- To reduce the risk of death, personal injury or property damage from fire, electric shock, falling parts, cuts, abrasions and other hazards, please read all warnings and instructions included with the luminaire, on the luminaire's packaging and affixed to the luminaire itself.

Installation

- LEDs are high-quality electronic components! Please avoid contacting the light output opening of the LED directly during installation or relamping.

IMPORTANT

- To ensure secure connection, the luminaire housing must be positioned precisely in relation to the mounting plate.
- Cleaning And Maintenance
 - Clean luminaire regularly with solvent-free cleaners from dirt. Please do not do not clean the luminaire with using high-pressure liquids.

