

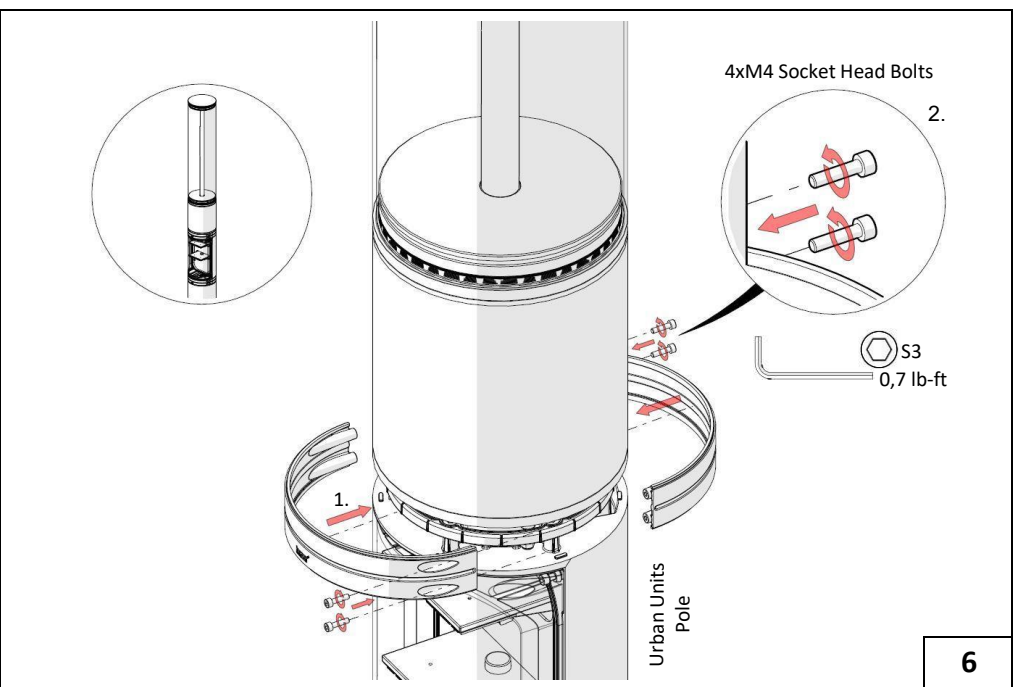

HEPER USA, LLC
W227 N546 Westmound Drive
Waukesha, WI 53186 - USA

Tel: +1 262 888 0262
infoUS@hepergroup.com
www.heperlighting.com

URBAN UNITS TOP MODULE V3
Installation&Maintenance Instructions

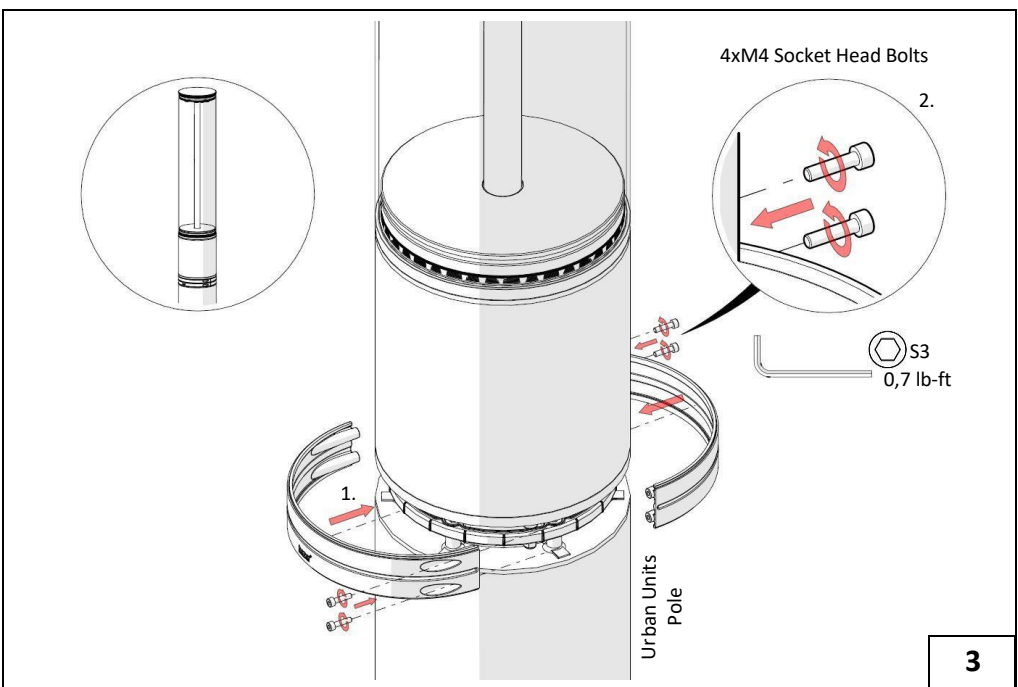
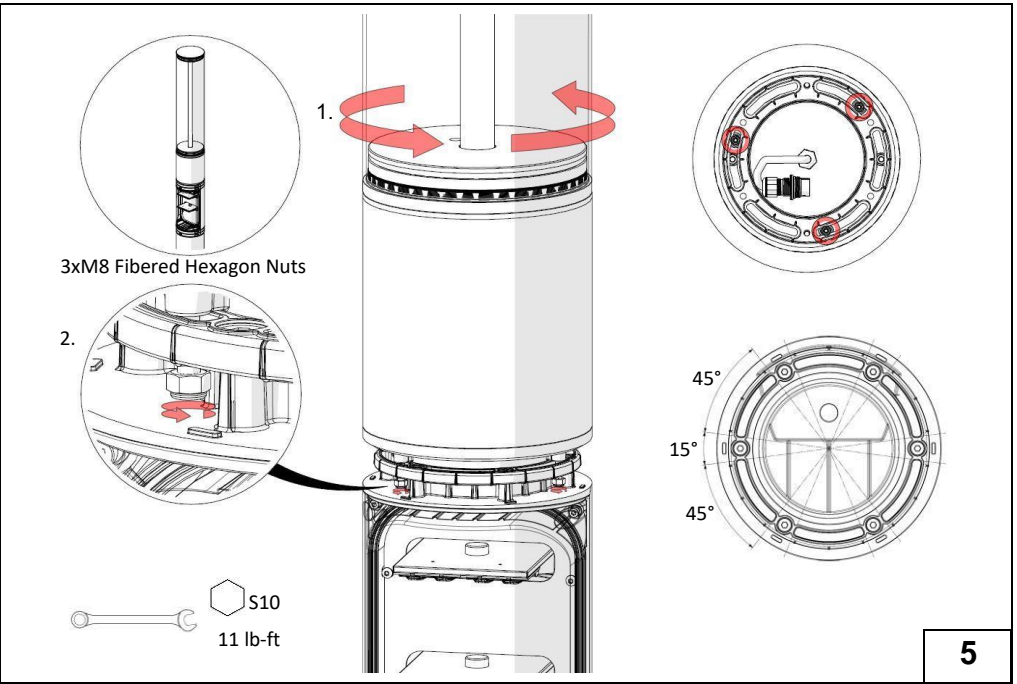
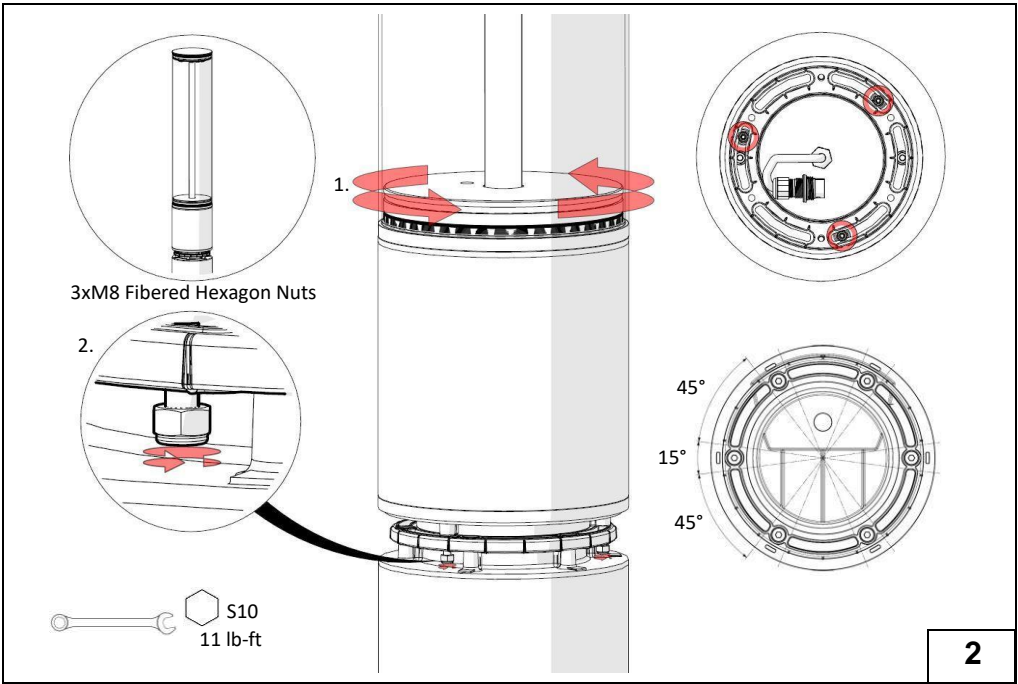
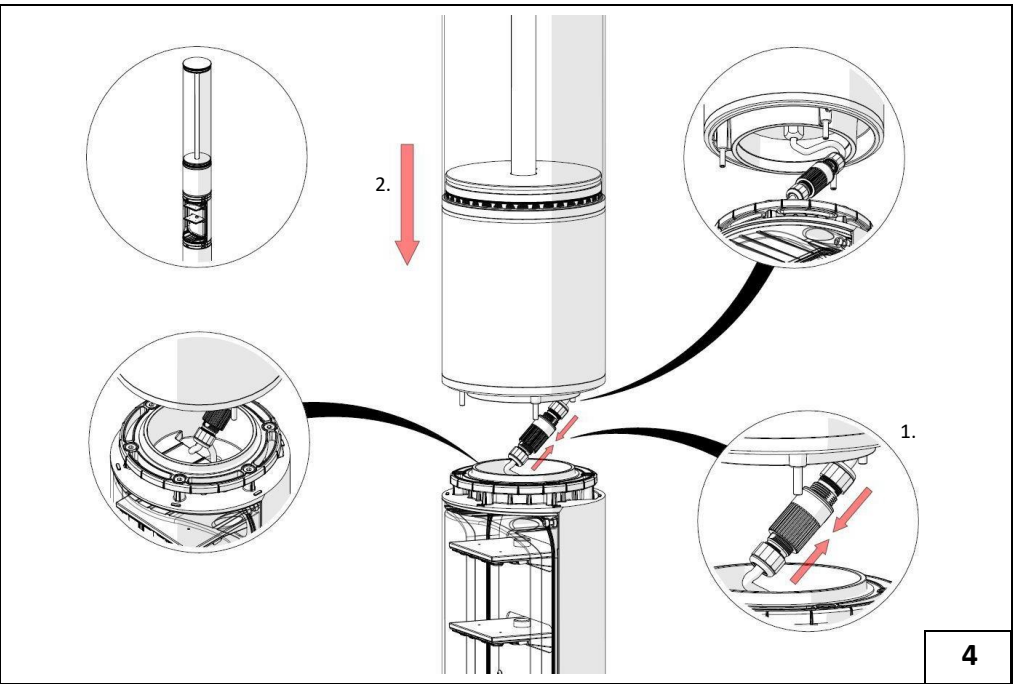
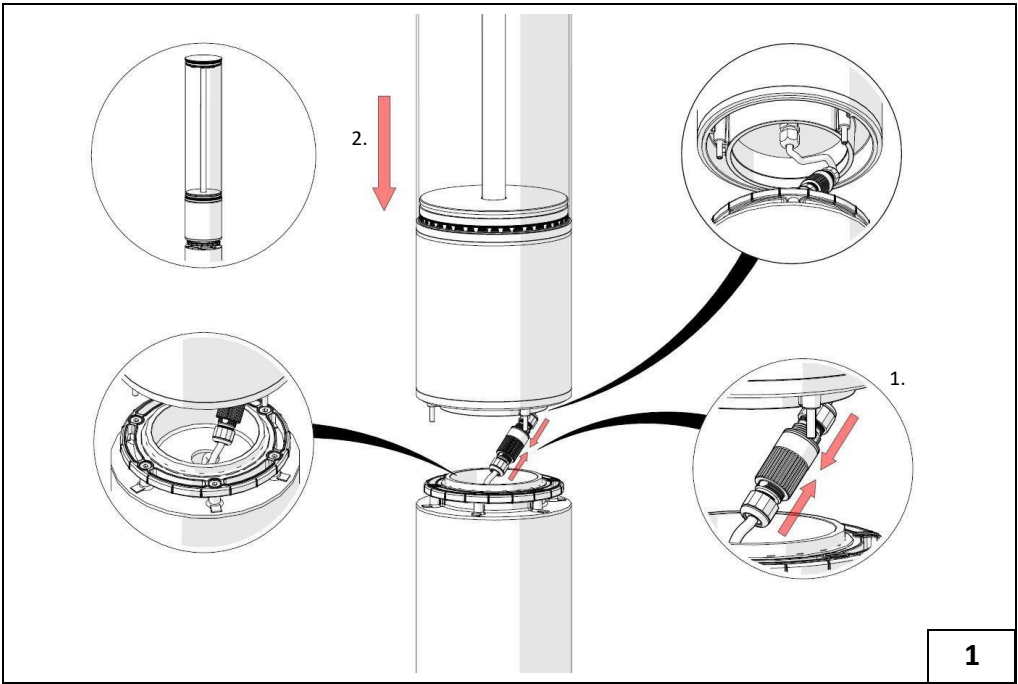

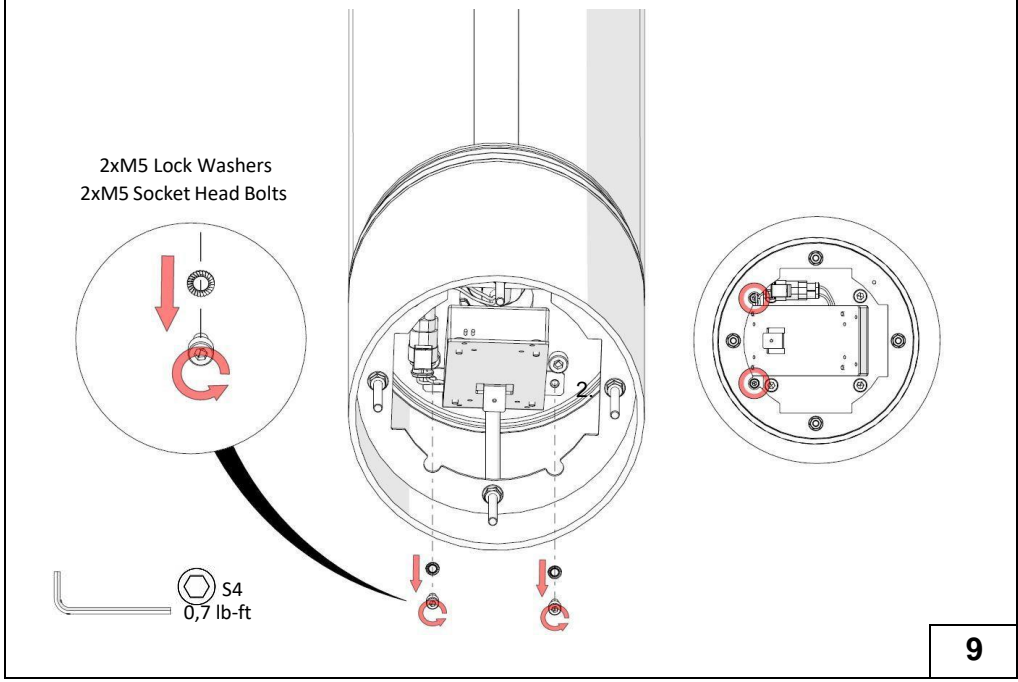
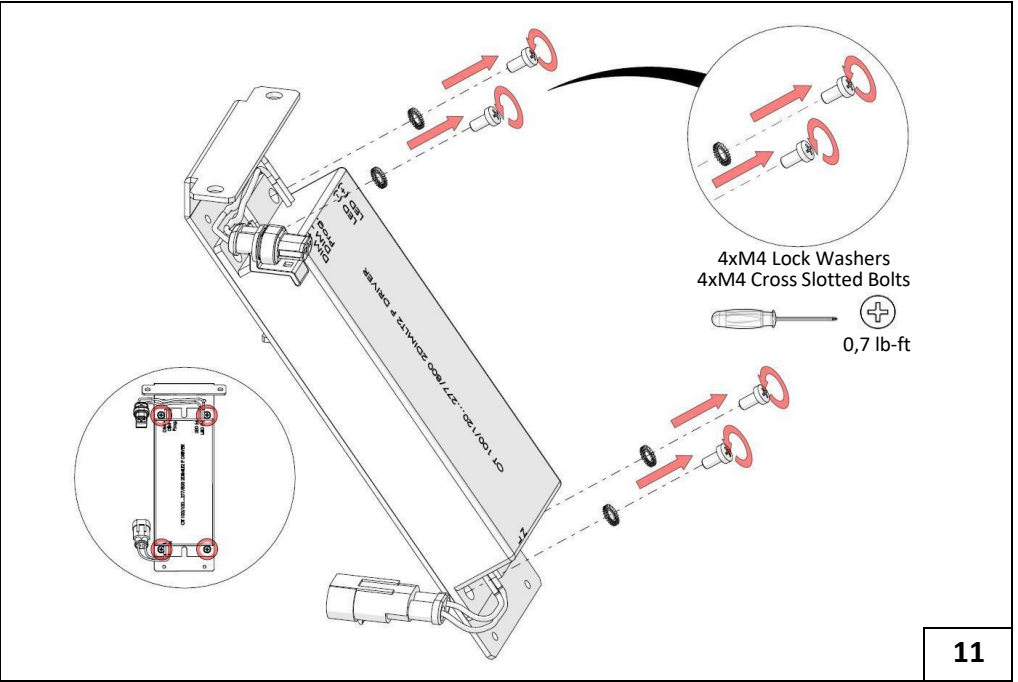
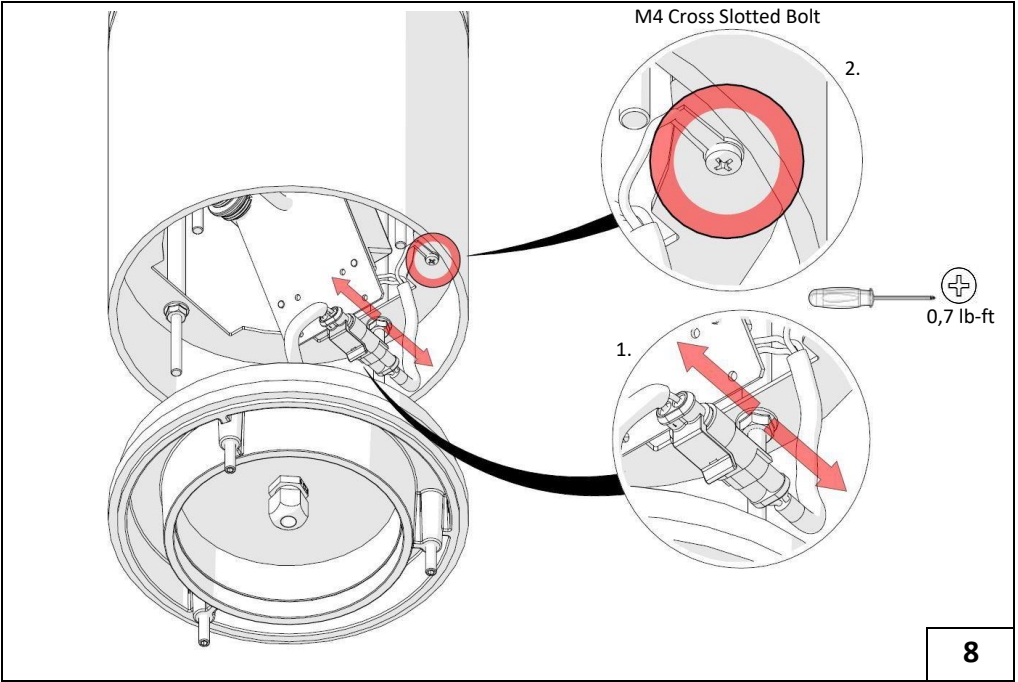
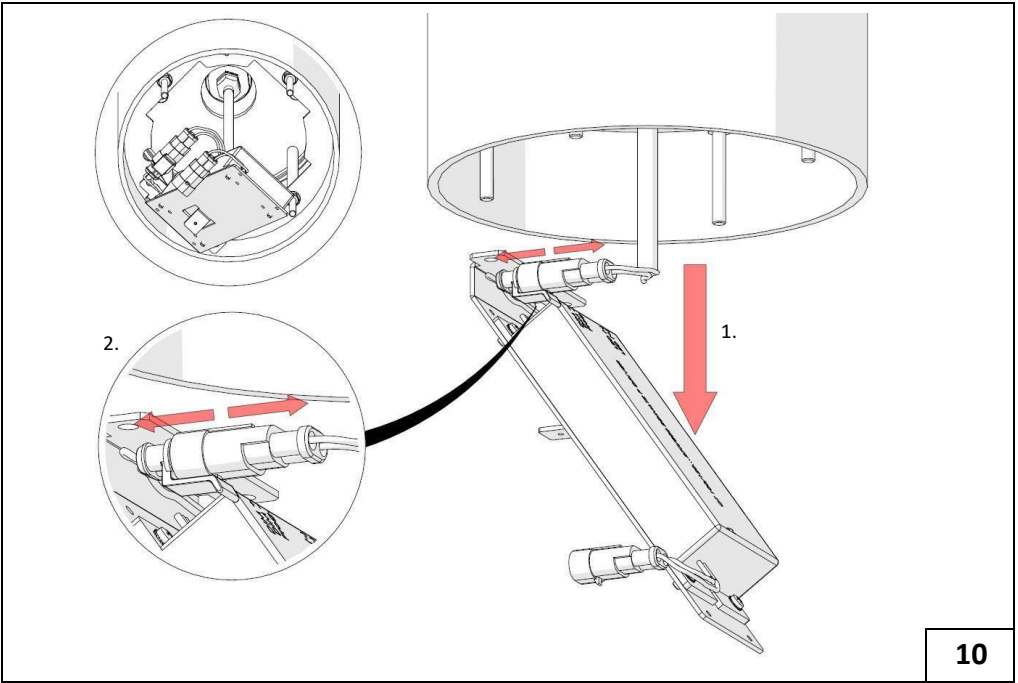
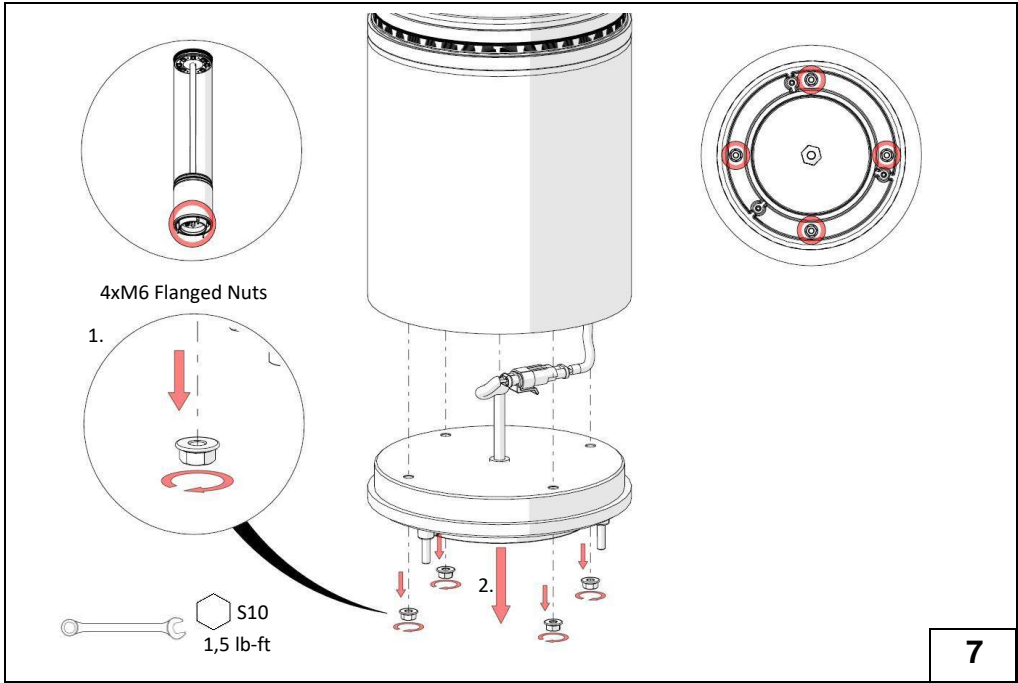

A (Inch)	B (Inch)	C (Inch)	WEIGHT (lb)	PRODUCT CODE
$\varnothing 7 \frac{7}{8}$	$39 \frac{59}{64}$	$30 \frac{1}{8}$	27 lb	LP4054.841 LP4054.842
$\varnothing 7 \frac{7}{8}$	$39 \frac{59}{64}$	$30 \frac{1}{8}$	28 lb	LP4054.843 LP4054.844
$\varnothing 7 \frac{7}{8}$	$39 \frac{59}{64}$	$30 \frac{1}{8}$	30 lb	LP4054.845 LP4054.846
$\varnothing 7 \frac{7}{8}$	$39 \frac{59}{64}$	$30 \frac{1}{8}$	35 lb	LP4054.847 LP4054.848

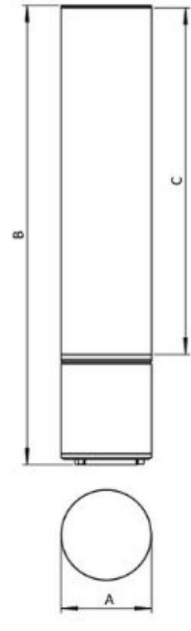

ASSEMBLY INSTRUCTIONS

Assembly of Module to the Top of the Pole;

Note: To avoid the risk of electrocution, ensure power has been turned off at the supply before installing or maintaining this product.

- 1. Affixing Module to pole top ;
 - 1.1. Attach the cables from the module and pole by securing male and female components of connector.
 - 1.2. Align locator pins from top module assembly with the appropriate receiving slots on the top of the pole portion.
- 2. Assembly of the module;
 - 2.1. Adjust the Module to desired orientation.

Note 1: Refer to the image regarding the Module’s rotation capabilities. The upper Module must be lifted, re-oriented and it’s locating pins re-inserted into a secondary set of slots to enable rotation/orientation at angles over 45 degree increments.

Note 2: While adjusting the orientation of the module, be careful not to damage or twist the socket connection cable, if possible, the connection should be made after the module orientation is finalized.

- 2.2. After the Module’s orientation is finalized 3 pieces of M6 Hexagonal Head Fiber Nut tightened with 11 lb-ft torque.
- 3. Assembly of Module and pole joint concealing clamp;
 - 3.1. Place two joint concealing components in gap as shown in the figure.

Note: Make sure that the HEPER logo is centered above the hand hole/fuse cover of the pole base.
 - 3.2. 4 pieces M4 Hex Key Bolts are tightened with 0,7 lb-ft torque to join the concealing clamp assembly.

Affixing a Module to the top of another Module;

- 4. Affixing Module to another Module top;
 - 4.1. Attach the cables from the lower module to the top module by securing male and female components of connector.
 - 4.2. Align locator pins from top module assembly with the appropriate receiving slots on the top of the lower module.
- 5. Assembly of the module;
 - 5.1. Adjust the top Module to desired orientation.

Note 1: Refer to the image regarding the Module’s rotation capabilities. The upper Module must be lifted, re-oriented and it’s locating pins re-inserted into a secondary set of slots to enable rotation/orientation at angles over 45 degree increments.

Note 2: While adjusting the orientation of the module, be careful not to damage or twist the socket connection cable, if possible, the connection should be made after the module orientation is finalized.

- 5.2. After the Module’s orientation is finalized 3 pieces of M6 Hexagonal Head Flanged Nut tightened with 11 lb-ft torque.
- 6. Assembly of Module to Module joint concealing clamp;
 - 6.1. Place two joint concealing components in gap as shown in the figure.

Note: Make sure that the HEPER logo is centered on the lower Module’s plexi portion.
 - 6.2. 4 pieces M4 Hex Key Bolts are tightened with 0,7 lb-ft torque to join the concealing clamp assembly.



Attention : No other module can be mounted on this module.

Change of Luminaire’s LED Driver;

- 7. Removal of the Driver chamber cover;
 - 7.1. Remove 4 pieces M6 flanged hexagon head nuts.

Note: After the LED driver replacement completed, flanged hexagon head nuts should be tightened with 1,5 lb-ft torques while mounting the cover to its place.
 - 7.2. Driver chamber cover can now be carefully removed. Care should be taken not to separate the cover too far from the module. This could result in damage to the cables and connectors.
- 8. Before fully removing driver chamber cover;
 - 8.1. Disconnect mate and lock connector that is holding driver chamber cover and LED driver together.
 - 8.2. Remove 1 piece M4 star cylinder head bolt which secures the grounding cable.

Note: After driver replacement is completed the grounding cable screw is tightened to 0,7 lb-ft of torque.

- 9. 2 piece M5 Hex Key bolts and 2 piece M5 knurled washers holding the LED driver assembly in place are removed.

Note: After driver replacement is completed the bolts and knurled washers tightened to 0,7 lb-ft torque.
- 10. Removing LED driver assembly;
 - 10.1. LED Driver assembly can now be removed. Care should be taken not to separate the driver assembly too far from the module. This could result in damage to the cables and connectors.

10.2. Disconnect mate and lock connector that is holding LED driver and LED module together.

11. 4 piece M4 Phillips Head head bolts and 4 piece M4 knurled washers holding the LED driver connection sheet are removed, LED driver can now be removed and replaced.

Note: After driver replacement is completed the bolts and knurled washers tightened with 0,7 lb-ft torque.

WARNINGS AND REMARKS FOR INSTALLATION AND MAINTENANCE

Safety Instructions



- The light source contained in this luminaire shall only be replaced by the manufacturer or his service agent or a similar qualified person. Always switch off the power prior to installation, maintenance or repair activities.
- The manufacturer is then discharged from liability when damage is caused by improper use or installation.
- If any luminaire is subsequently modified, the persons responsible for the modification shall be considered as manufacturer.
- To reduce the risk of death, personal injury or property damage from fire, electric shock, falling parts, cuts, abrasions and other hazards, please read all warnings and instructions included with the luminaire, on the luminaire’s packaging and affixed to the luminaire itself..

Installation



- LEDs are high-quality electronic components! Please avoid contacting the light output opening of the LED directly during installation or relamping.

IMPORTANT



- To ensure secure connection, the luminaire housing must be positioned precisely in relation to the mounting plate.

Cleaning And Maintenance

- Clean luminaire regularly with solvent-free cleaners from dirt. Please do not clean the luminaire with using high-pressure liquids.

Replacing the LED module

- The designation of the LED module is noted on a label in the luminaire.
- The light colour and light output of HEPER replacement modules correspond to those of the modules originally fitted. The module can be replaced by qualified persons using standard tools.
- Disconnect the electrical installation.
- Open the luminaire.
- Please follow the installation instructions for the LED module.
- Close the luminaire.