



HEPER USA LLC

W227 N546  
Westmound Drive  
Waukesha  
WI 53186 – USA

Tel: +1 917 244 20 32  
info@hepergroup.com  
www.heperlighting.com

**DRAGO**  
Installation&Maintenance Instructions

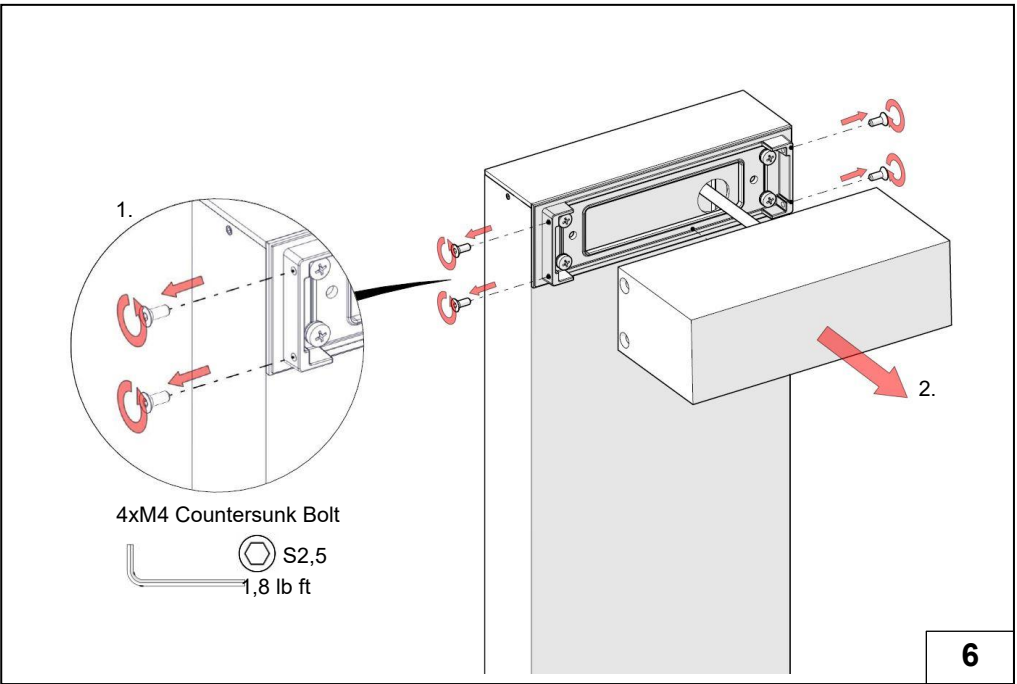
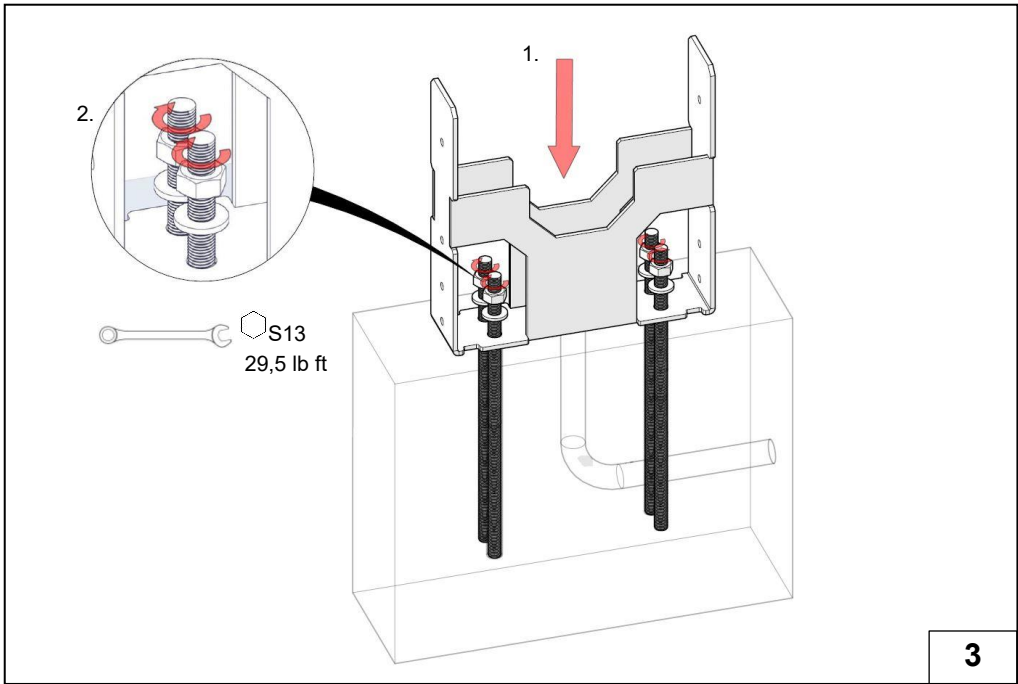
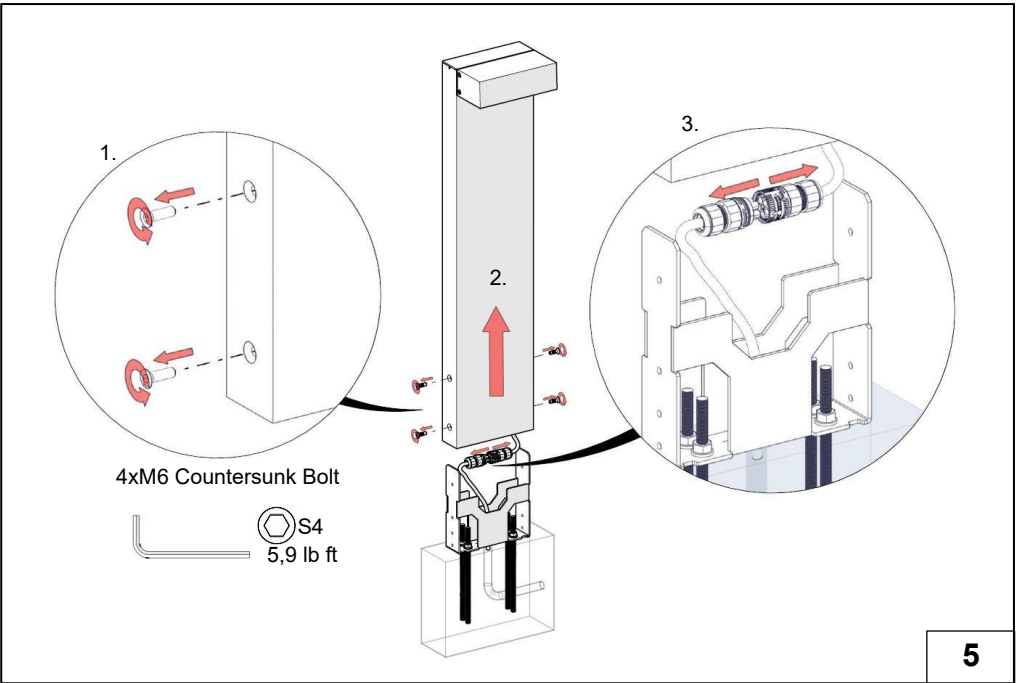
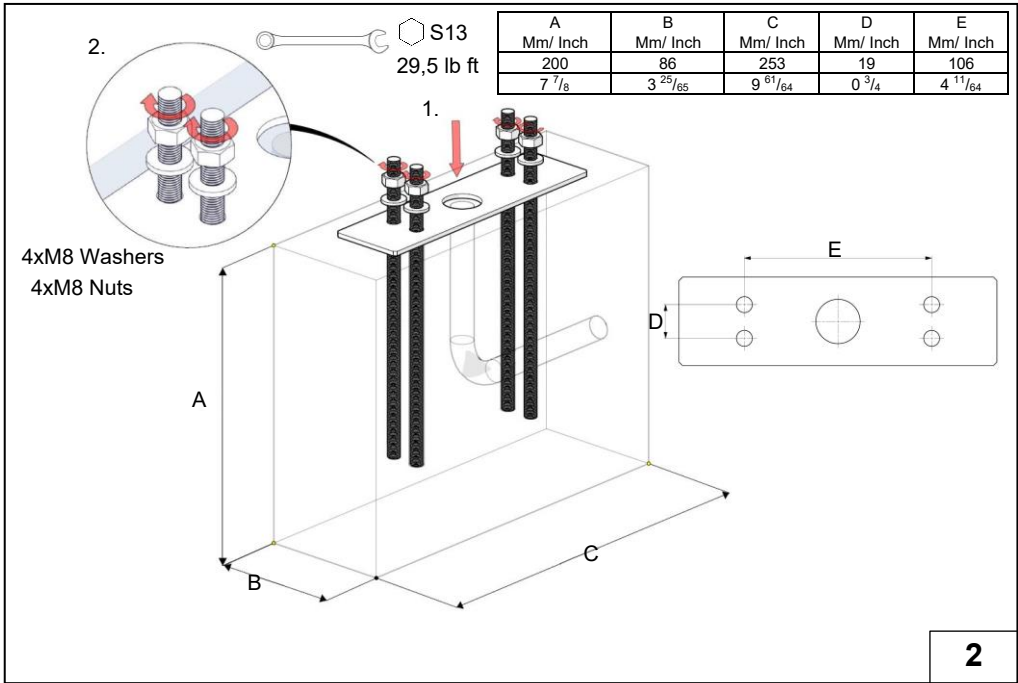
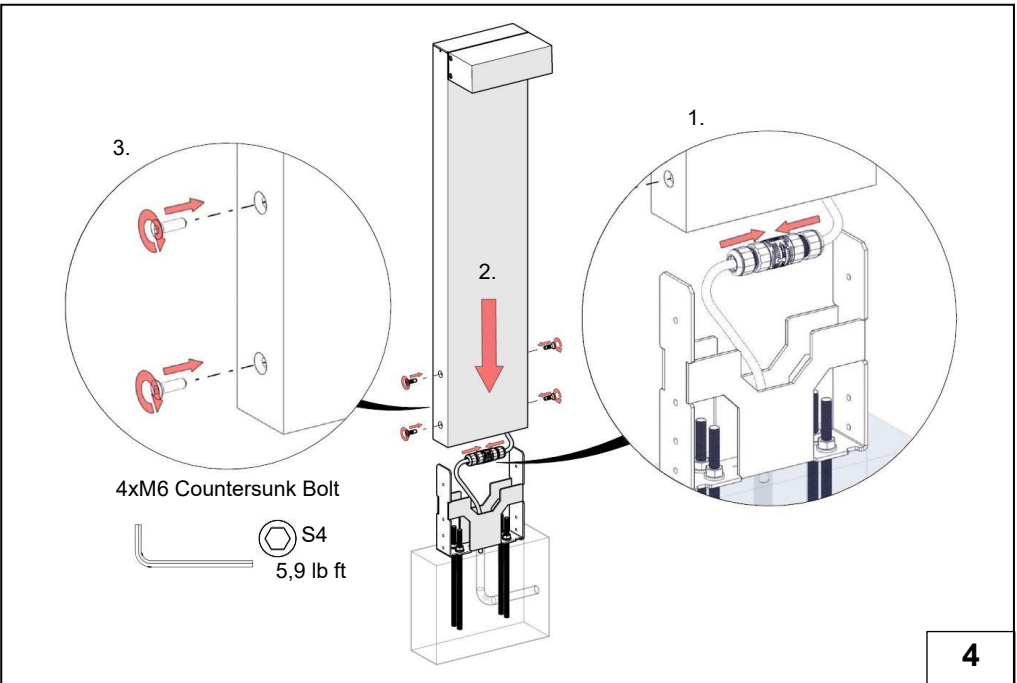
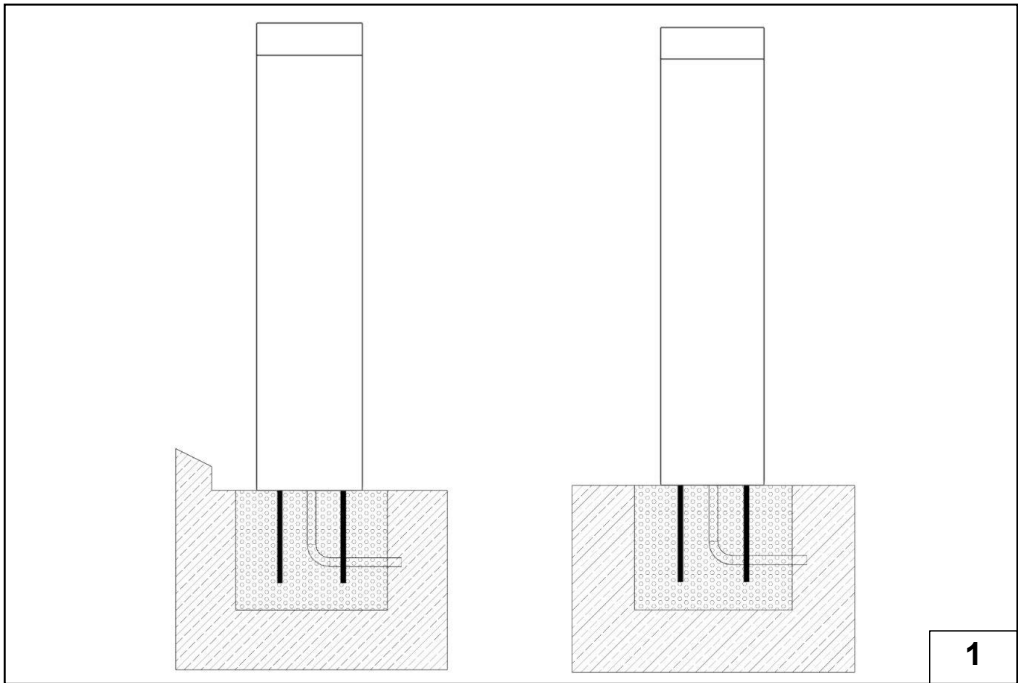

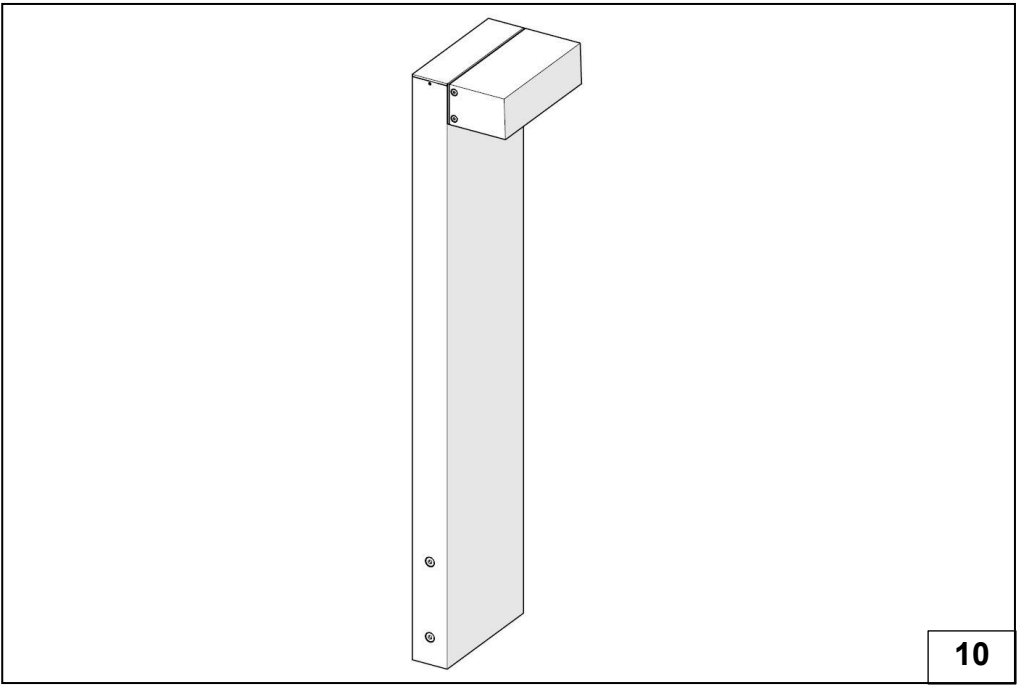
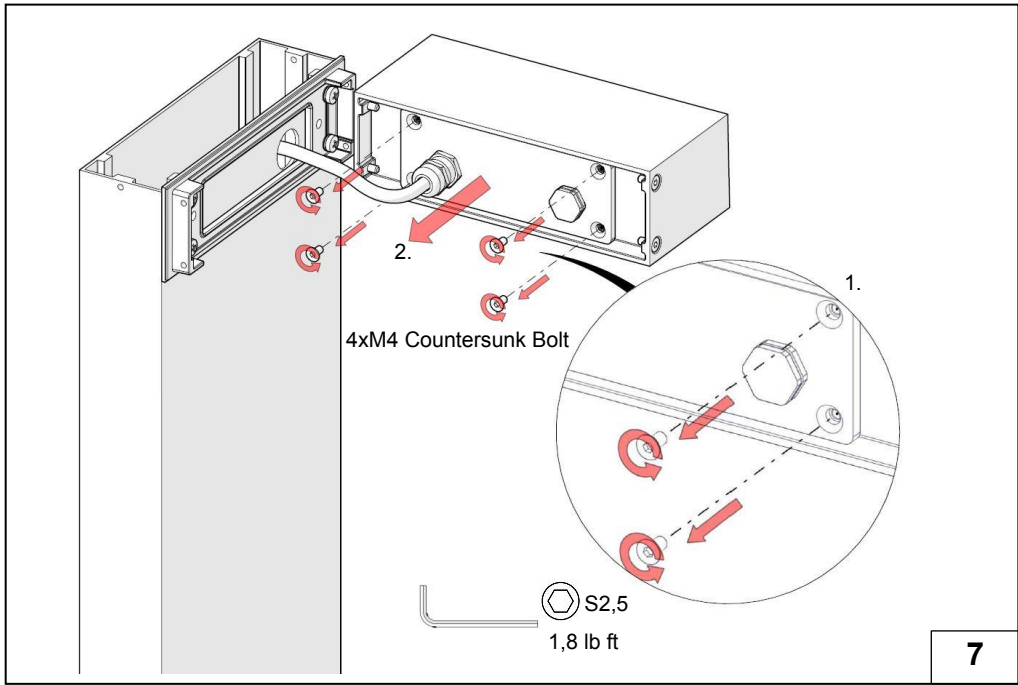

ASSEMBLY INSTRUCTIONS

The Installation of the Bollard onto the ground;

1. The installation ground must be flat.
2. According to the given concrete dimensions, the empty space in the ground is adjusted.
  - 2.1. To make sure that connection holes are aligned perfectly, anchorage plate must be used.
  - 2.2. The anchorage plate is assembled with anchor rods applying 29,5 lb ft torque and using flat washers, bolts.(4xM8 Washer,4xM8 Bolt)

Note:After concrete is poured and the anchor rods are stabilized, the anchorage plate, that enables appropriate orientation, is removed.

3. The Assembly of the middle connection part onto the ground;
  - 3.1. The part in the figure is placed onto the ground.
  - 3.2. The placed part is assembled with anchor rods applying 29,5 lb ft torque using with nuts.(4xM8 Washer,4xM8 bolts)
4. Assembly of the Bollard onto the ground;
  - 4.1. The cable coming from the ground and the cable coming out of the product are mounted to each other with the help of the socket.

Note:The socket that enables the connection between the cables is not provided with the product.Please provide a socket that compatible with the product and has minimum IP66 rating.

- 4.2. The product is placed on the ground such that connection plate should be inside the ground.
- 4.3. Countersunk head imbus bolts for fixing the product to the connection plate are screwed with 5,9 lb ft torque.(4xM6 Countersunk Imbus Bolts)

Replacement of the LED Driver

5. Disconnection of the Electrical Connections of the Product;
  - 5.1. Countersunk Imbus bolts that fasten the product to connection plate, are removed.(4xM6Countersunk Imbus Bolts)

Note:After the LED Driver replacement is done, the Countersunk Imbus Bolts are screwed again applying 5,9 lb ft.(4xM6Countersunk Imbus Bolts)
  - 5.2. The bollard is lifted up such that it does not contact with middle connection part.
  - 5.3. The socket that connects the cable comes from the ground and the cable gets out from the product is disconnected.

Note:The socket that enables the connection between the cables is not provided with the product.Please provide a socket that compatible with the product and has minimum IP66 rating.

6. To disassemble the Product;
  - 6.1. Countersunk head imbus bolts that provide the connection of the product to the body are removed from their places.(4xM4 Countersunk Imbus Bolts)

Note:After the LED driver replacement is completed, the product is slotted into place and countersunk imbus bolts are tightened with 1,8 lb ft torque.
  - 6.2. The part is removed.
7. Removal of the rear cover of the part;
  - 7.1. Countersunk head imbus bolts holding rear cover are removed.(4xM4 Countersunk Head Imbus Bolt)
  - 7.2. The rear cover is removed.

Note:During this operation the electrical connections inside the product, must be protected from any damage. This process must be done gently.

Note:After the LED Driver replacement is done, the rear cover is reoriented to its place and Countersunk Imbus Bolts are screwed again applying 1,8 lb ft.(4xM4Countersunk Imbus Bolts)

8. Removal of the Cartridge part;
  - 8.1. Star cylindrical head bolts holding the cartridge sheet are removed.
  - 8.2. Cartridge part is removed from its place.

Note:During this operation the electrical connections inside the product, must be protected from any damage. This process must be done gently.

Note:After the LED Driver replacement is done, the Cartridge part is reoriented to its place and Star cylindrical head bolts are screwed again applying 0,7 lb ft.(2xM3 Star cylindrical head bolts)

9. To remove the LED Driver;
  - 9.1. Star cylindrical head bolts holding the LED Driver are removed and cables connected to the LED driver are dismantled.
  - 9.2. LED Driver is taken out.

Note:During this operation the electrical connections inside the product, must be protected from any damage. This process must be done gently.

Note:New LED Driver is placed and Star cylindrical head bolts are screwed applying 0,7 lb ft.(2xM3 Star cylindrical head bolts)

Note:Electrical connections are done to the new LED Driver.

Note:The same processes in the 6,7,8 and 9 are applied and the product is closed.

10. The product is ready to use.

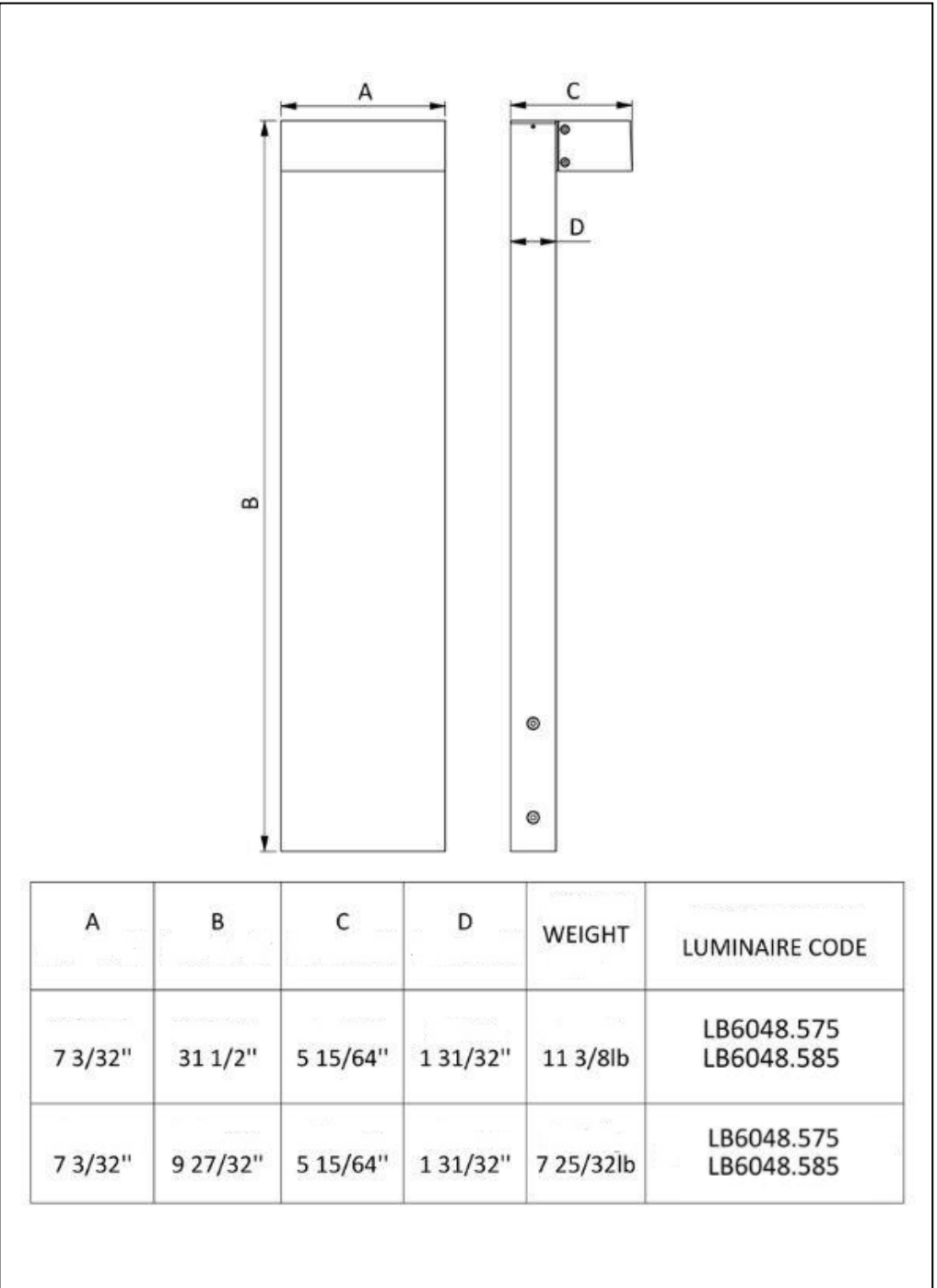
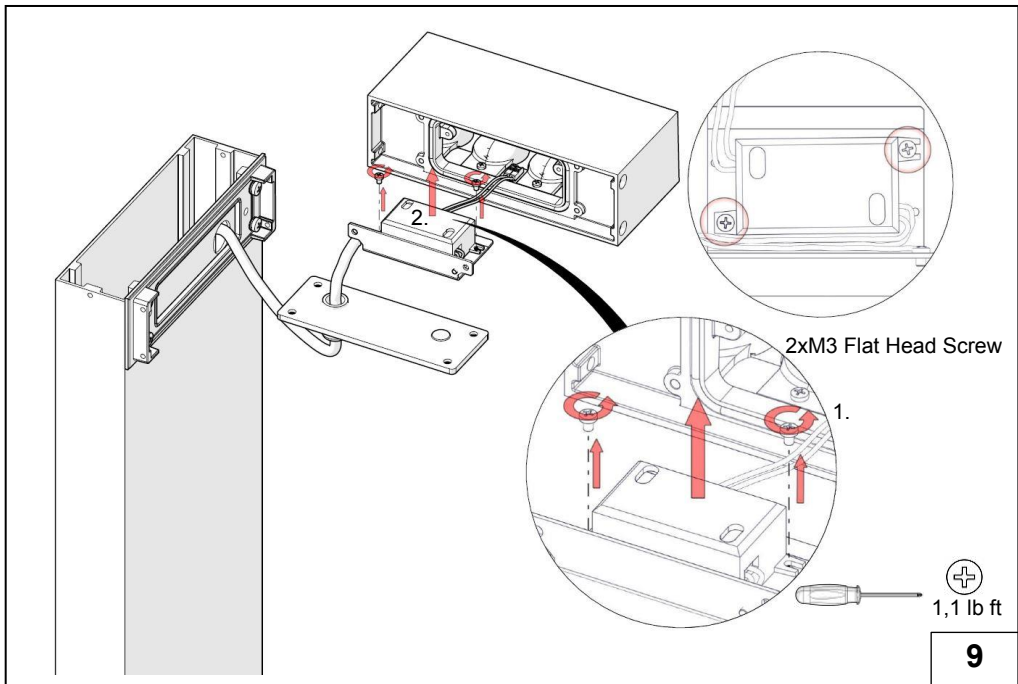
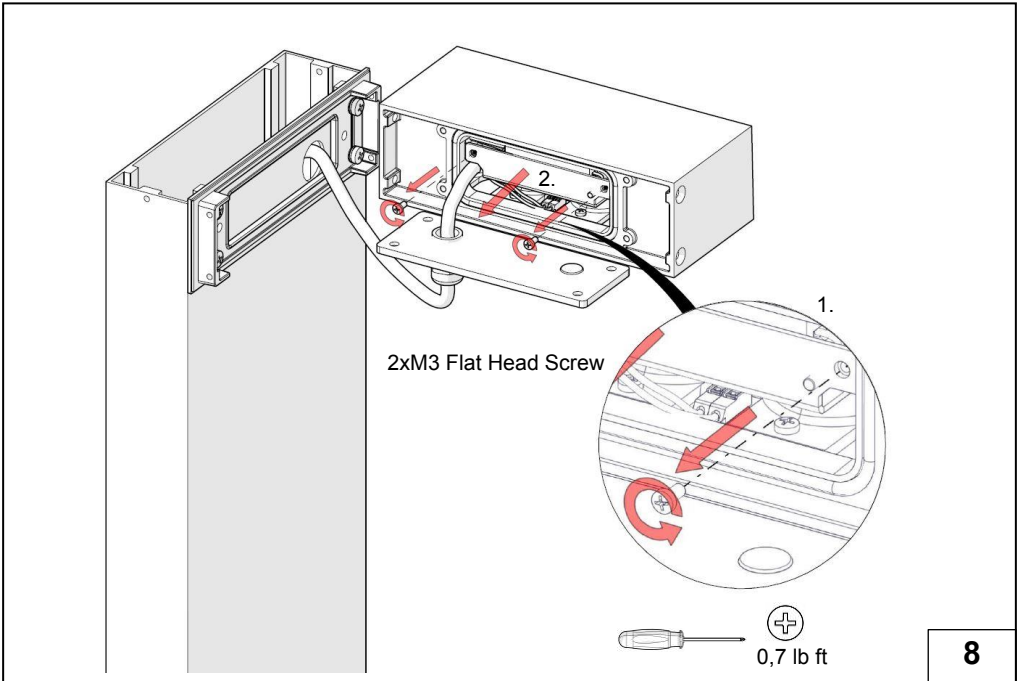

WARNINGS AND REMARKS FOR  
INSTALLATION AND MAINTENANCE

Safety Instructions ⚠

- The light source contained in this luminaire shall only be replaced by the manufacturer or his service agent or a similar qualified person. Always switch off the power prior to installation, maintenance or repair activities.
- The manufacturer is then discharged from liability when damage is caused by improper use or installation.
- If any luminaire is subsequently modified, the persons responsible for the modification shall be considered as manufacturer.
- To reduce the risk of death, personal injury or property damage from fire, electric shock, falling parts, cuts, abrasions and other hazards, please read all warnings and instructions included with the luminaire, on the luminaire's packaging and affixed to the luminaire itself..

Installation ⚡

- LEDs are high-quality electronic components! Please avoid contacting the light output opening of the LED directly during installation or relamping.

IMPORTANT ⚠

- To ensure secure connection, the luminaire housing must be positioned precisely in relation to the mounting plate.

Cleaning And Maintenance

- Clean luminaire regularly with solvent-free cleaners from dirt. Please do not do not clean the luminaire with using high-pressure liquids.

