



Heper Lighting

Uygurlar Cd. No:1, 06935 &
Organize Sanayi
Bölgesi/Sincan/Ankara
Turkey

Tel: +90 312 267 54 30
Fax : +90 312 267 54 31
info@hepergroup.com
www.heperlighting.com

TILA

Installation & Maintenance
Instructions

2020-0/04.11.2020

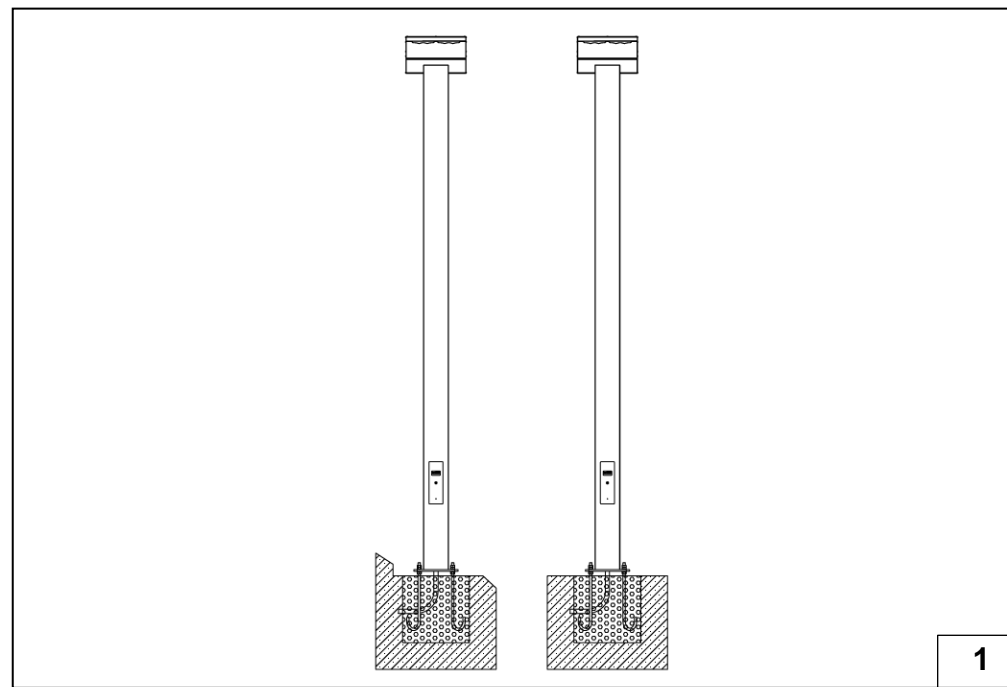

1

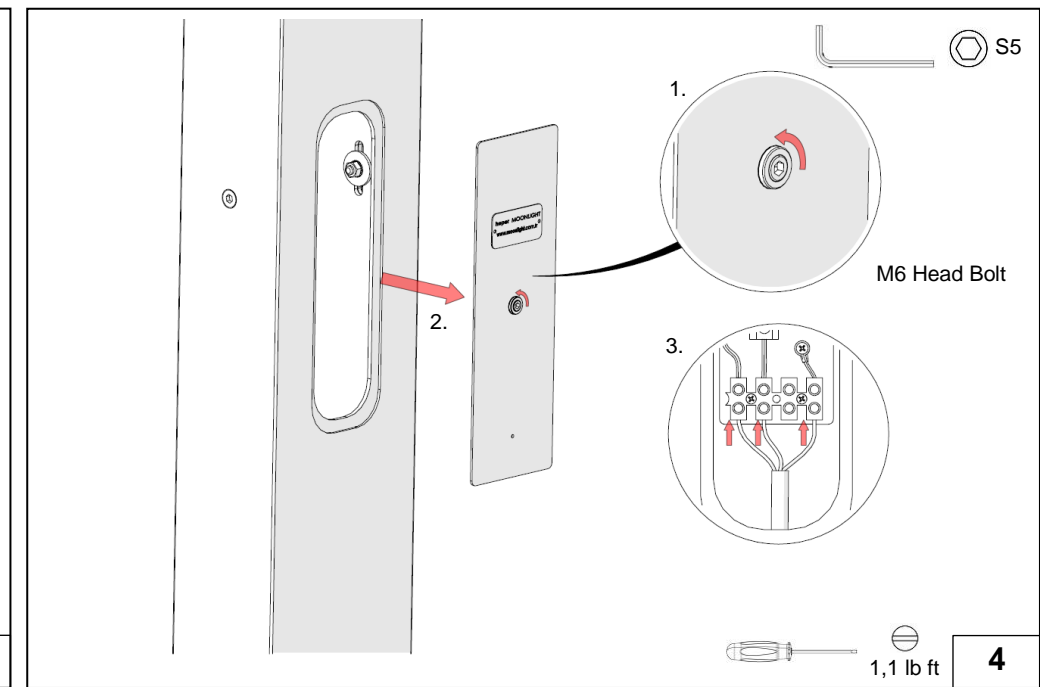

4

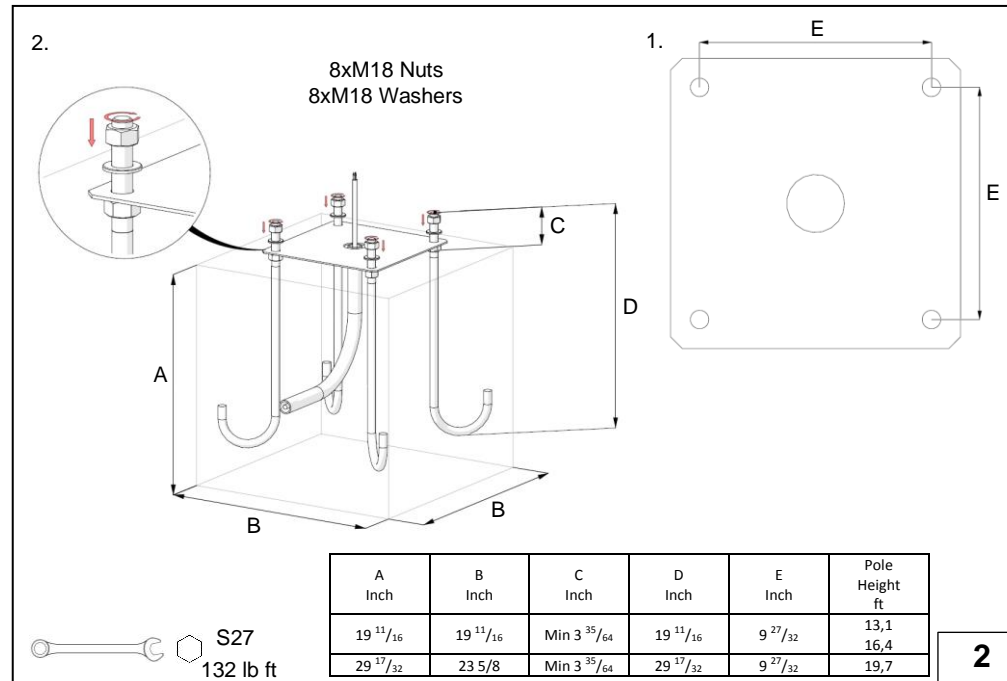

2

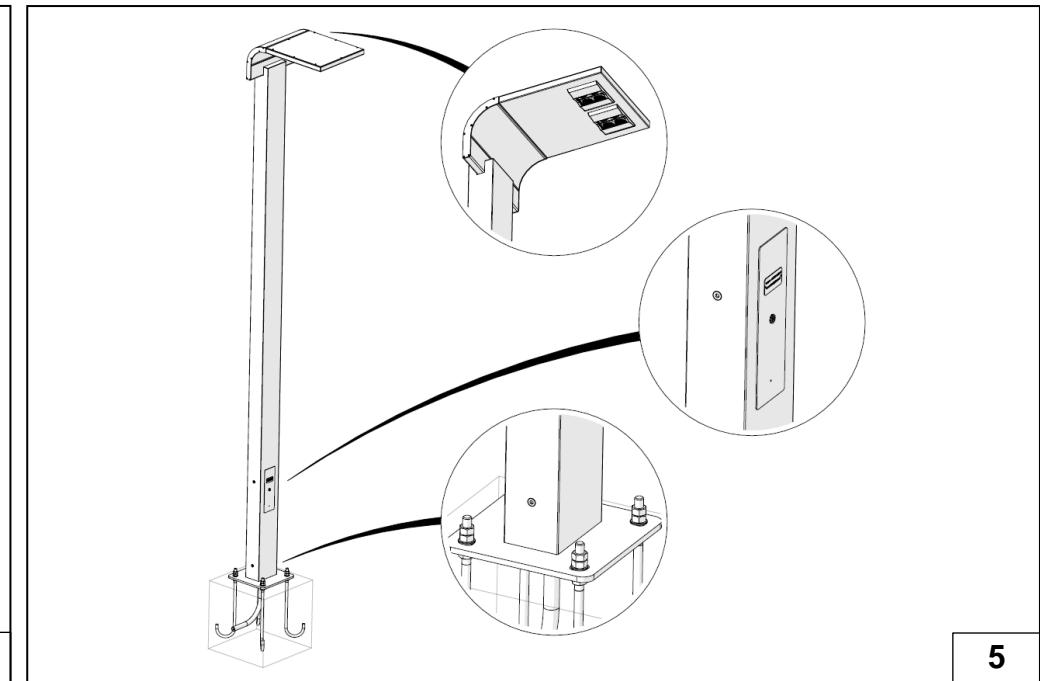

5

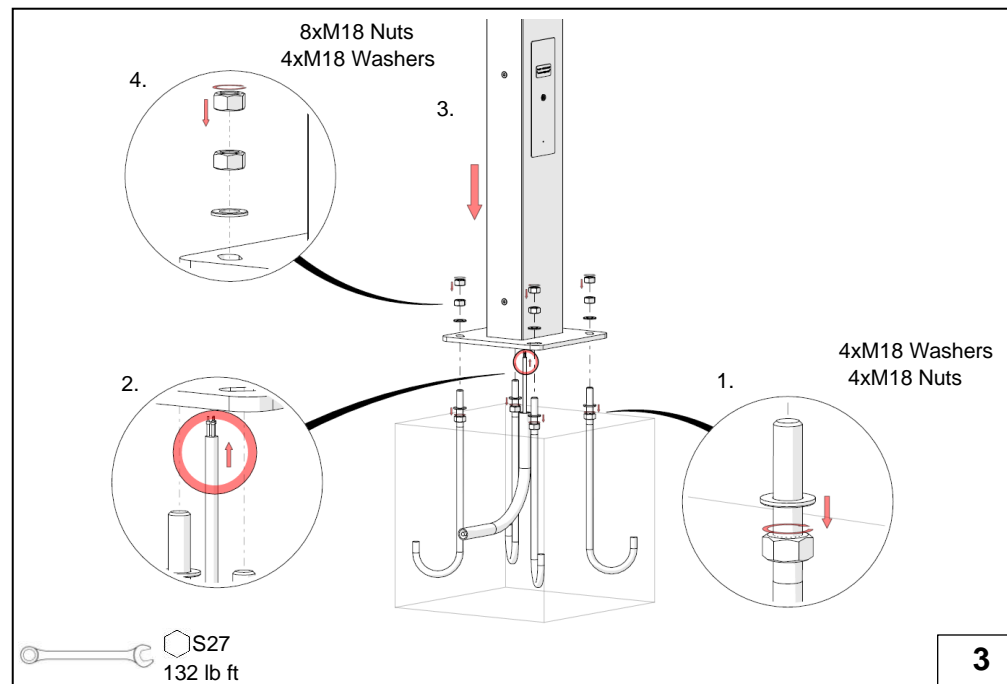

3

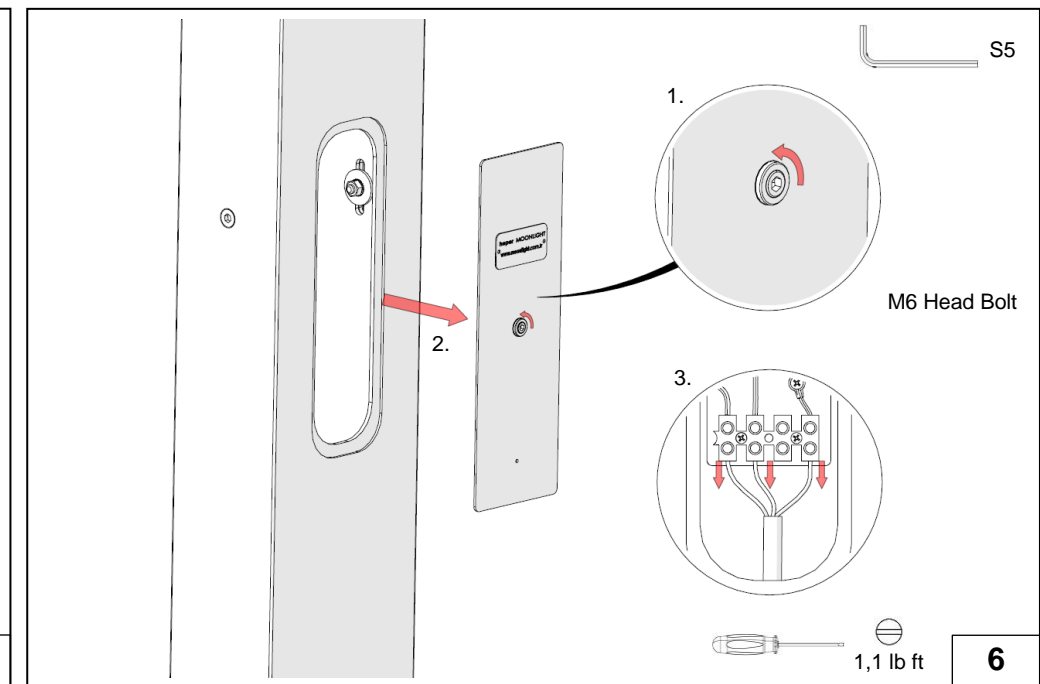

6

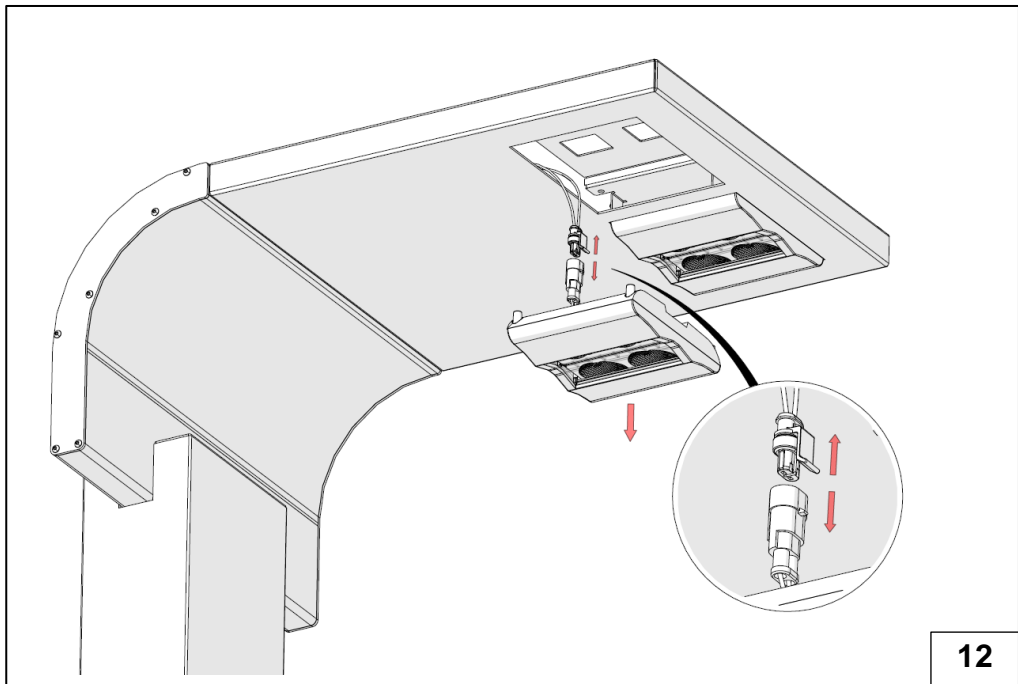
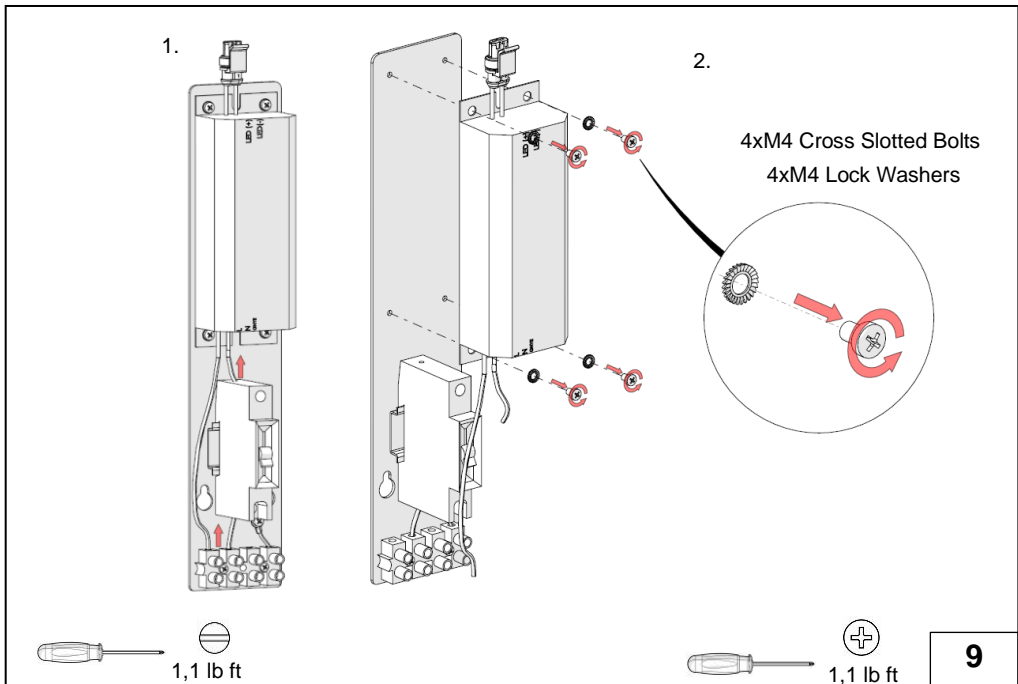
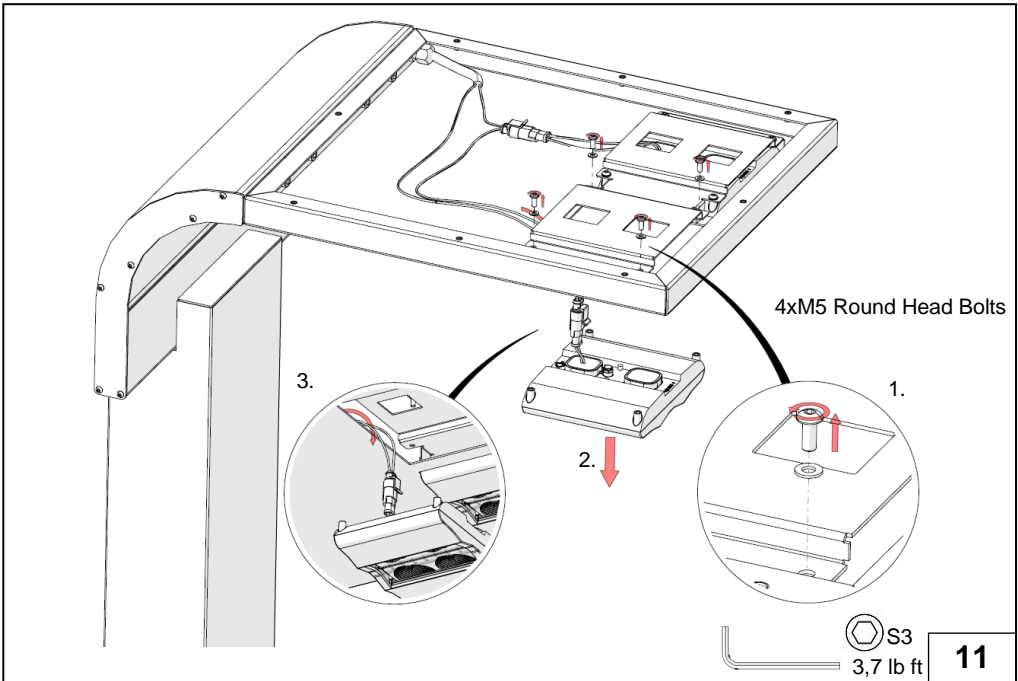
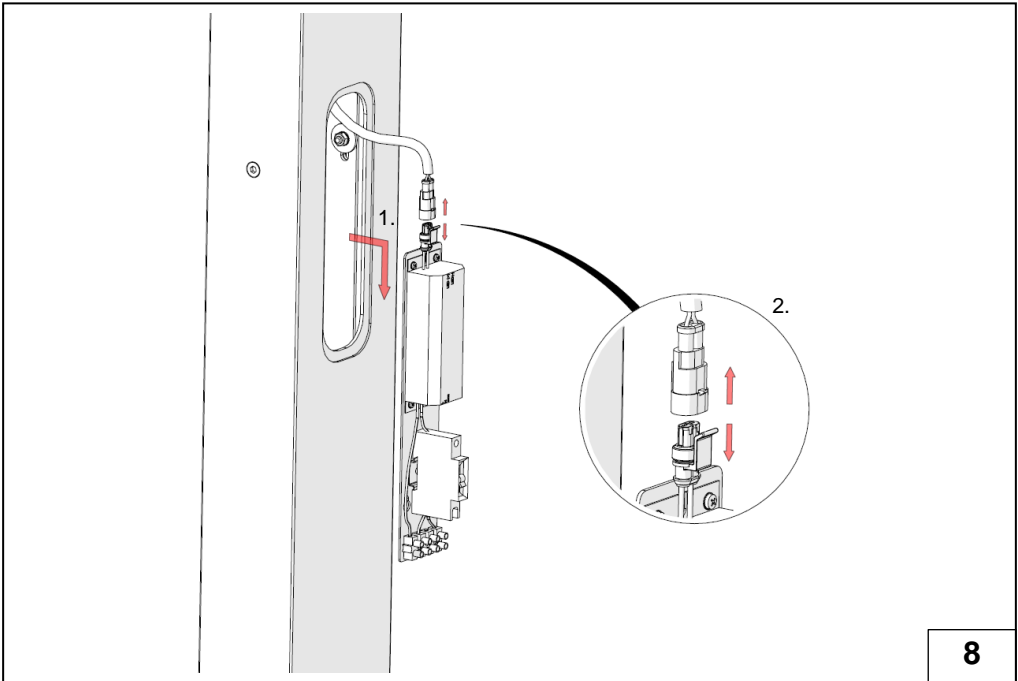
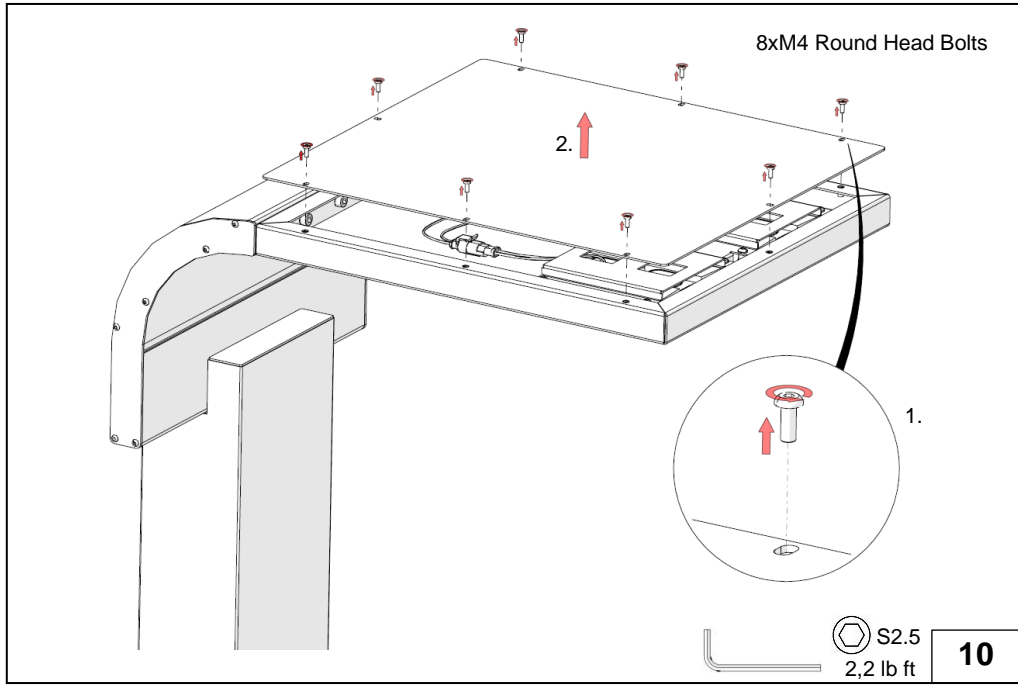
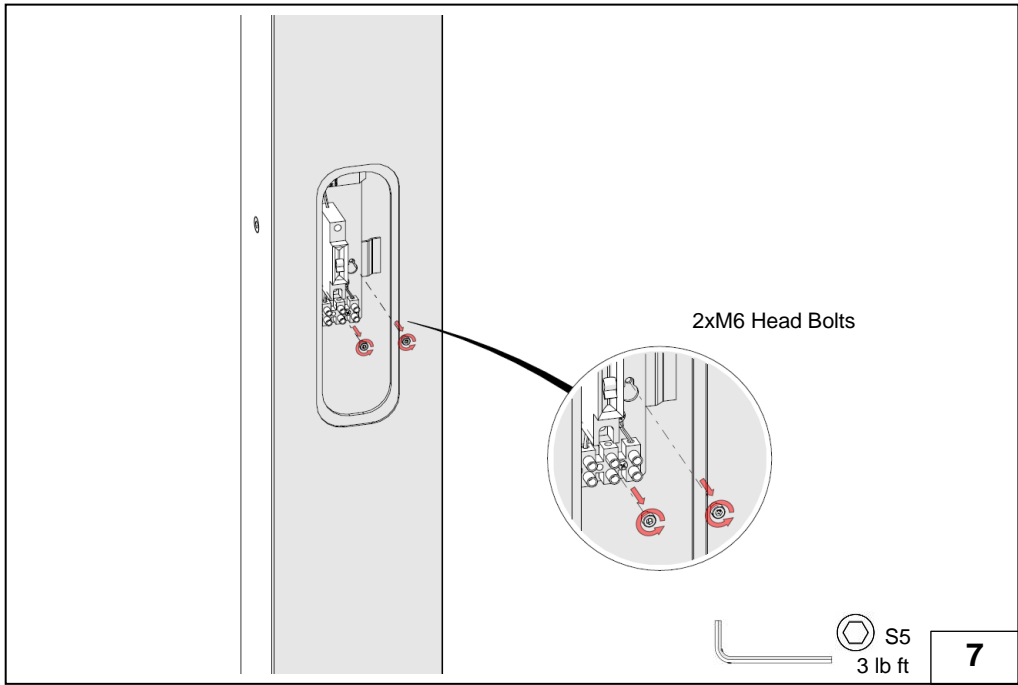

A (Inch)	H (ft)	B (Inch)	C (Inch)	D (Inch)	WEIGHT (lb)	DİREK KODU POLES KODE	BOLARD KODU BOLARD CODE
7 21/64	13,1	17 23/32	4 23/32	28 1/32	126,8 lb	PAFD.R01.T001	LL2013.682
7 21/64	16,4	17 23/32	4 23/32	28 1/32	138 lb		LL2013.682
7 21/64	19,7	17 23/32	4 23/32	28 1/32	173,7 lb		LL2013.682
7 21/64	13,1	17 23/32	4 23/32	28 1/32	132,3 lb		LL2013.684
7 21/64	16,4	17 23/32	4 23/32	28 1/32	142,2 lb		LL2013.684
7 21/64	19,7	17 23/32	4 23/32	28 1/32	59,5 lb		LL2013.684

English

ASSEMBLY INSTRUCTIONS

To mounting the product on the floor;

- The floor must be flat which the product will be mounted.
- The space on the floor is adjusted according to given concrete dimensions.
 - Anchor flange plate is used to align the connection holes of the product. (Hole center: 9 27/32")
 - The anchor studs are fixed into the concrete at a minimum of 90 mm from the floor to anchor flange. The anchor studs are embed to concrete.(8 Pieces, M18 Washers, 8 Pieces, M18 Nuts)

Note:After concrete, when the anchor stud fix the anchor flange that is used to align is removed.
- To mounting the pole to the floor;
 - The anchor studs are mounted with respectively M18 nuts and M18 washers for pole steep adjustment.
 - The main supply cable is placed into the pole in the direction of the arrow.
 - The pole is placed over M18 washers by aligning the studs.
 - The pole is mounted with torque of 51,6 lb ft by placing M18 washers under 4 pieces nuts to the studs coming out of the concrete. Contra is made with 4 pieces M18 nuts. (4 pieces, M18 Washer and 8 Pieces, M18 Nuts.)

4. To connection main supply;
Note: The electrical connection coming to the product must be disconnect before starting to this process.
4.1. The M6 bolt on the fuse cover is rotated approximately 90 degrees in the direction of the arrow, it is free.
Note:Care should be taken not to drop the fuse cover.
4.2. The fuse cover is removed its place from on the pole.
4.3. The main supply cable is connected to the connector on the cardridge group.
Note: After the connecting to the connector on the cardridge group, the fuse cover is placed to its place of on the pole and M6 bolt is rotated approximately 90 degrees and it is fixed.
5.Image of product.

To change the LED driver;
Note:The electrical connection coming to the product must be disconnect before starting to this process.
6. To removing the main supply connection;
6.1. The M6 bolt on the fuse cover is rotated approximately 90 degrees in the direction of the arrow, it is free.
Note:Care should be taken not to drop the fuse cover.
6.2. The fuse cover is removed to its place from on the pole.
6.3. The main supply cable is connected to the connector on the cartridge group.
Note: After connecting of the connector on the cartridge group, the fuse cover is placed to its place on the pole and the fuse cover is fixed by rotating the M6 bolt 90 degrees in the opposite direction of the arrow.
7. The bolts that is to fix of cartridge group are removed. (2 pieces, M6 Imbus Bolt)
Note1: The bolts are screwed with torque of 2,9 lb ft while they fix to its places. Note2: Care should be taken not to damage the cartridge group when it is free.

8. To separate of the cartridge group from pole;
8.1. The cartridge group is removed from the fuse cover.
Note:Care should be taken not to damage of the cartridge group.
8.2.The cable socket from the cartridge group to luminaire is removed. Note: Make sure that the socket is fully seated when installing the socket after the LED driver replacement.
9. To separate of the LED driver from cartridge group;
9.1. The cables from the LED driver to connector is removed.
Note1: The cables should be fix with torque of 1,1 lb ft when placing to its place.
Note2: Care should be taken not to damage the LED driver.
9.2. The bolts that is fixed the LED driver to cartridge is removed. (4 pieces, M4 cheese-head),(4 pieces, M4 lock washer)
Note1: While mounting of LED driver to its places, lock washers are placed under the bolts and bolts are fixed with 1,1 lb ft torque.
Note2: Care should be taken not to damage of the LED driver.

To change of the lighting module;
Note:T he electrical connection coming to the product must be disconnect before starting to this process.
10. To remove of the lumianire back plate;
10.1. The bolts that is fix to luminaire back plate are removed. (8 pieces, M4 round head bolt)
Note: It is screwed to its place with torque of 2,2 lb ft.
10.2: The luminaire back plate is separated in the direction of the arrow.
11. To remove of the lighting module;
11.1. The bolts that is fix to lighting module are removed. (M4 round head bolt)
Note1: The bolts are screwed with torque of 3,6 lb ft while they fix to its places. Note2: Care should be taken not to damage of the lighting module and sockets.
11.2. The lighting module is separated from its place on the luminaire in the direction of the arrow.
Note:Care should be taken not to damage of the lighting module and sockets.
11.3. The sockets are removed from inside the luminaire.
Note: Care should be taken not to damage of the lighting module and sockets.
12. The lighting module socket is removed.
Note: Care should be taken not to damage of the lighting module and sockets. Make sure that the socket is fully seated when installing the socket during the installation.

WARNINGS AND REMARKS FOR INSTALLATION AND MAINTENANCE

Safety Instructions ⚠

- The light source contained in this luminaire shall only be replaced by the manufacturer or his service agent or a similar qualified person. Always switch off the power prior to installation, maintenance or repair activities.
- The manufacturer is then discharged from liability when damage is caused by improper use or installation.
- If any luminaire is subsequently modified, the persons responsible for the modification shall be considered as manufacturer.
- To reduce the risk of death, personal injury or property damage from fire, electric shock, falling parts, cuts, abrasions and other hazards, please read all warnings and instructions included with the luminaire, on the luminaire's packaging and affixed to the luminaire itself..

Installation ⚙

- LEDs are high-quality electronic components! Please avoid contacting the light output opening of the LED directly during installation or relamping.

IMPORTANT ⚠

- To ensure secure connection, the luminaire housing must be positioned precisely in relation to the mounting plate.

Cleaning And Maintenance

- Clean luminaire regularly with solvent-free cleaners from dirt. Please do not do not clean the luminaire with using high-pressure liquids.

