

## 1) TUYA APP INSTALLATION



Install the “TUYA” application on your smartphone.

It can be downloaded from Google Play or Apple Store depending on the operating system of the smartphone.



Play Store QR (Android)



Apple Store QR (IOS)

**IMPORTANT:** The APP is supported by smartphones with iOS (7.0 or higher) or Android (4.3 or higher) version.

## 2) REGISTRATION AND LOGIN

- 1 - Press the “Create new account” option on the initial screen.
- 2 - Enter the e-mail address of the “super administrator” of the installation. Then press “Get verification code”.
- 3 - Enter the verification code that you will have received at the e-mail address provided.
- 4 - Set a password.

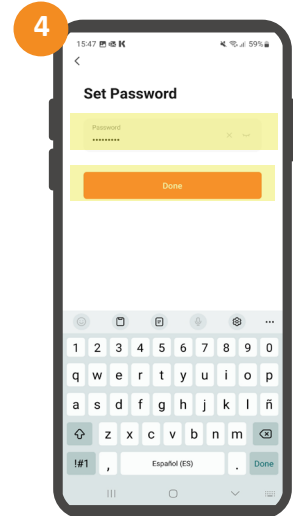
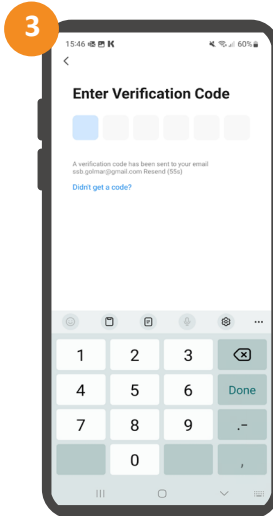
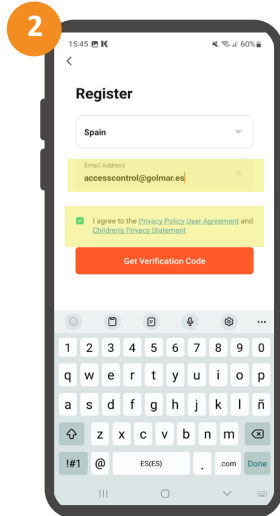

## 3) ADD CONTROLLER

The APP wizard will suggest you to add device. Please proceed as follows:

- 1 - Press the “got it” option and then the “+” or “add device” symbol.
  - 2 - Grant permission to the APP to make use of different smartphone features (camera, microphone, location, ...).
  - 3 - Then bring the smartphone close to the controller (Bluetooth must be enabled as it is required during pairing).
- Then select and set the password of the WiFi connection to which the controller will connect to have internet access.
- 4 - Controller will be added.

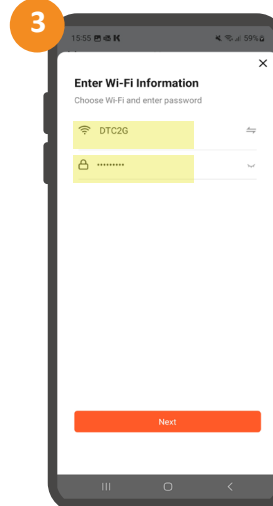
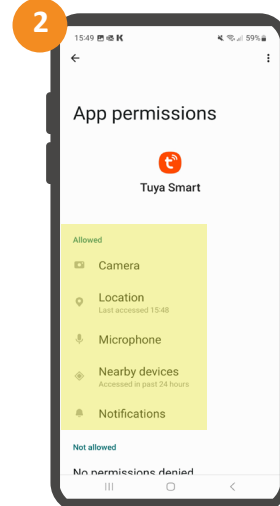
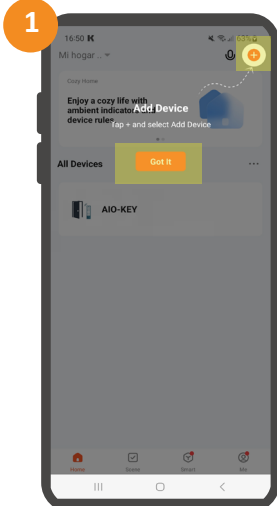

**IMPORTANT:** The WiFi network to which the controller is connected must be 2.4GHz frequency.

**IMPORTANT:** In case the controller is not detected automatically, perform the following sequence on the controller:

\* master code # 9 master code #

The connectivity will be reset, perform this sequence only in case the device is not detected.

#### 4) SHARE DEVICE

The user who initially adds the controller is by default “administrator”, who can share the device with other users:

- 1 - Press on the “Member manage” option located at the bottom of the main screen of the controller.
- 2 - Then press the “ordinary member” tab and then “+”.
- 3 - Enter an identifiable name in the “user name” field and enter the email address of the TUYA user in “user account”, uncheck the “administrator” box, then click “next”.
- 4 - The device will be shared. As soon as the user accepts the invitation the user will be able to start using the device.

#### IMPORTANT

The user to whom the installation is shared must have an account (registered in the APP, section “2.Registration and login”.

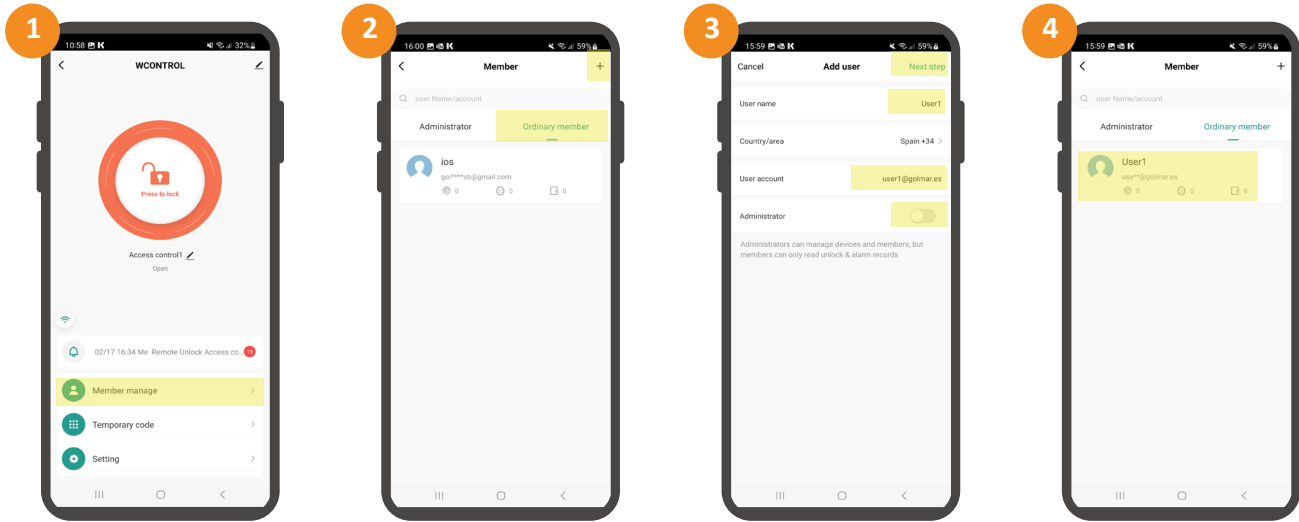

#### NOTES

- 1 - The user will now be able to open with the smartphone
- 2 - In case more users are to be added, repeat the process.
- 3 - In case it is desired to delete a user, access the list (screen step 2), select the user and then press the option “delete member”.
- 4 - In case it is desired to add the user with “administrator” rights, do not uncheck the “administrator” checkbox in step 3.

#### 5) USERS

- 1 - The user will receive a push notification that a new device has been shared:



#### Notification from new device

accesscontrol has shared WCONTROL with you

- 2 - This can be checked from the “message center” (“me” tab of the main screen).
- 3 - The device will appear on the main screen as “ devices shared with me ”.

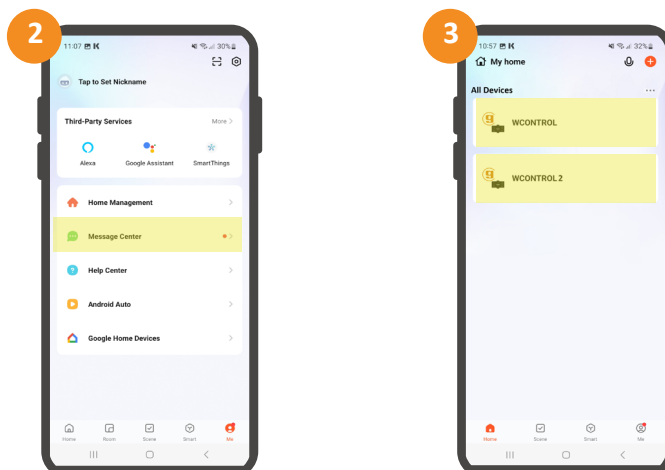

## 6) REGISTRATION OF IDENTIFICATIONS

- 1 - In the main screen of the controller, press on "Member manage".
- 2 - Select the user to register the credential.
- 3 - Press "Add" on the type of identification to register (code or card).

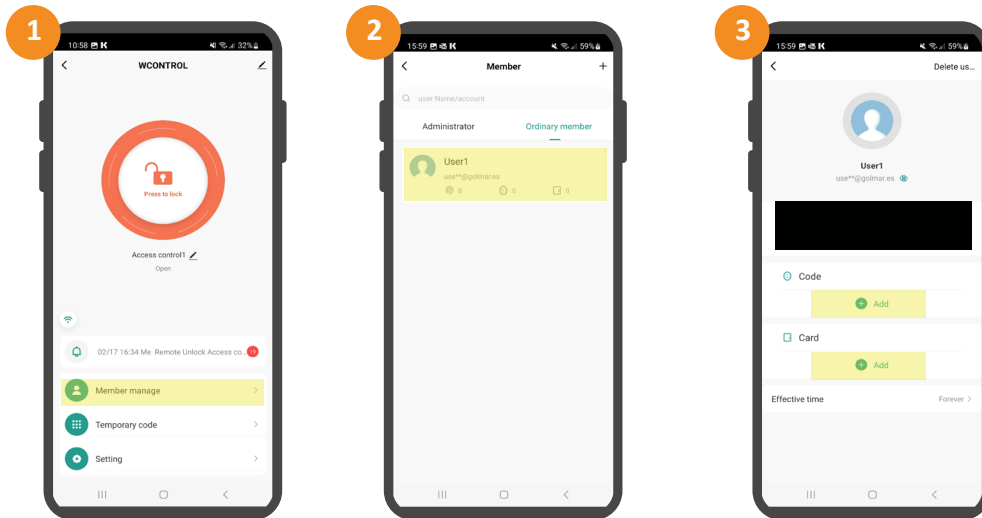

Below is a description of the registration process for the different types of identification:

### CARD REGISTRATION

- 1 - Press on the "Start add" option.
- 2 - Approach the card to be registered on the reader connected to the controller.
- 3 - Enter a name to identify the registered card.

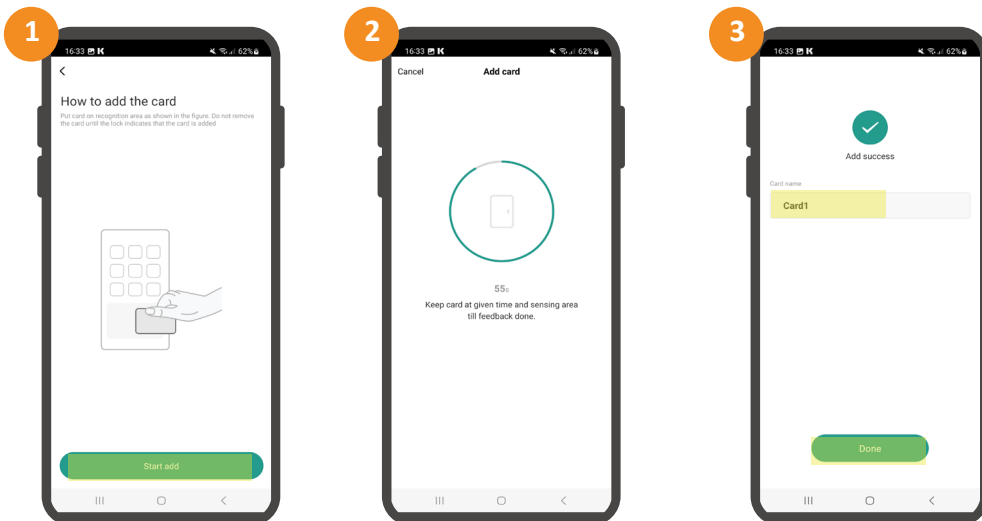

### PIN REGISTRATION

Set a 6-digit PIN and a name to identify the registered PIN, then press "save".

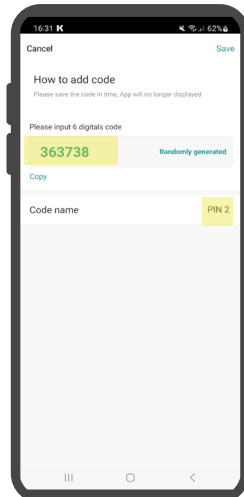

### DELETE IDENTIFICATION

- 1 - Select the access credential of the user to be deleted.
- 2 - Press the “delete” option highlighted in red.
- 3 - Press “confirm” to complete the deletion process.

