

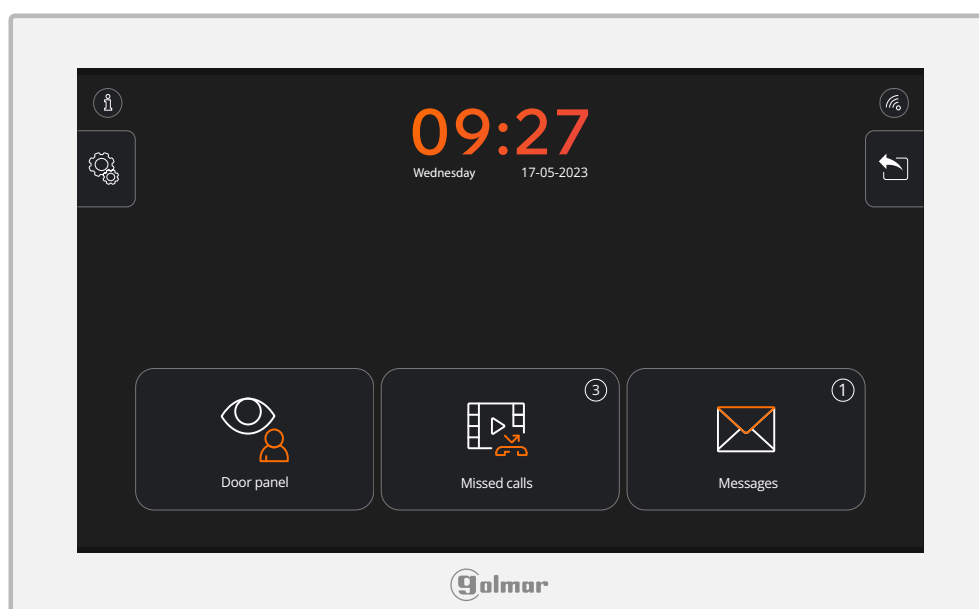

Monitor IP 7" EDGE

EDGE 7/G+ | EDGE 7W/G+



USER MANUAL

INDEX

1. Safety, cautions and warnings	3
2. Home screen & About.....	3
3. Monitor operation	4
4. Door panel preview	5
5. Missed calls	6
6. Messages	7
7. Intercom	9
8. CCTV	11
9. Concierge & SOS	12
10. Alarms.....	12
11. Settings & Shortcuts.....	13
11.1 User settings	13
11.2 Audio settings	15
11.3 Do not disturb.....	15
11.4 Screen settings	16
11.5 Shortcuts	16
12. Pairing the Wi-Fi monitor with the G2Call+ app	17
13. Link Alexa with Edge monitor.....	18
14. Link Google Home with Edge monitor	19

1. SAFETY, CAUTIONS AND WARNINGS

- The installation and setup of this equipment must be done by an authorized installer in a suitable surface and following the current regulations.
- Do not touch the device with wet hands, or using cleaning liquids or aerosols.
- Install the device in a dry and secure area, protected against water drops or sprays.
- Avoid placing the device close to heating/cooling sources, humid or dusty areas.
- Do not cover the device ventilation openings to assure air flow circulation.
- Do not open the device cover or manipulate the monitor's electric circuit.
- Danger of electric shock.

Declaration about compliance with Directive 2014/53/EU:

Hereby, GOLMAR S.A. declares that the radio equipment types EDGE 7W/G+ IP MONITOR is in compliance with the Directive 2014/53/EU. Wi-Fi Frequency Band: 2,4GHz. Output power (max): 19dBm.

The full text of the EU declaration of conformity is available at the following internet address: <https://www.golmar.es>

Wi-Fi monitors open ports 443 and 8443 for the following related services:

- 443: Used by the application G2Call+ to manage the indoor station configuration settings.
- 8443: Used for multimedia streaming between the Outdoor station and the Application G2Call+.

Wi-Fi network is used to provide a direct network connection between the monitor and cloud service for call forwarding and remote preview of the outdoor station from App. The monitor provides a switch button in the menu to disable Wi-Fi network at user's decision. Not having the monitor any external physical detection interface, security risks related to network are not present.

2. HOME SCREEN & ABOUT

Edge monitor is a touch screen monitor. In the below picture it is described the different sections which the monitor shows in its basic configuration setup home screen.

Home screen:

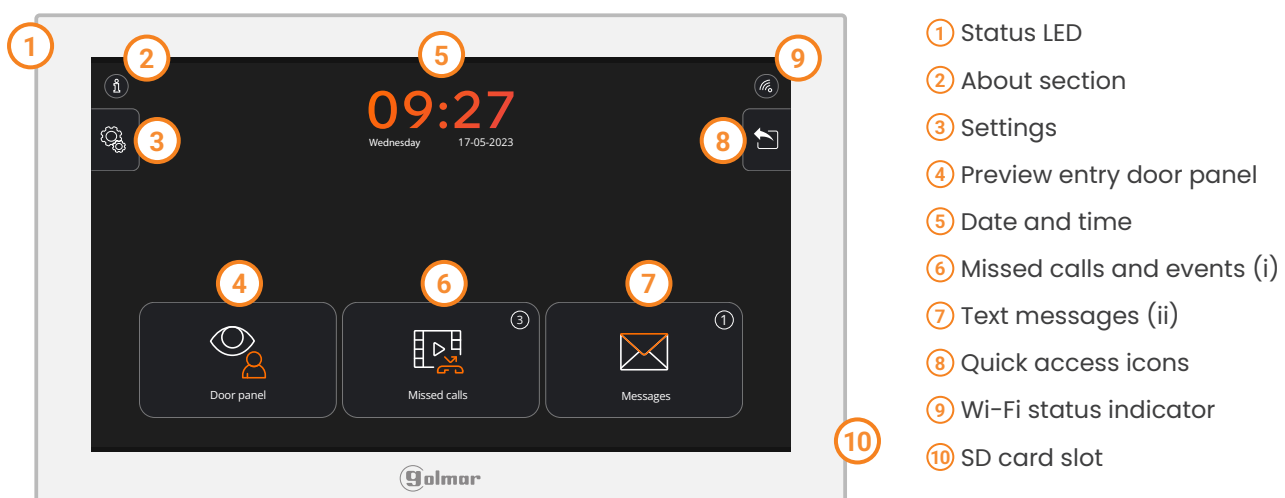

(i) Missed calls: If the missed calls log is empty, this section is shown in grey, not being accesible.

(ii) Message: When there is no incoming message, this section is shown in grey, not being accesible.

The LED indication has three states:

- Steady on: The monitor is in idle state.
- Blink: The monitor's "Do Not Disturb" (DND) function is enabled.
- 2 x fast blink: The monitor has an event in "Missed call" section to be checked.

About section:

In the "About" section you can find relevant information about your monitor, such as your calling address, required to be called from the digital coded panels.

It can also be found the monitor information, as well a QR code to download the user manual of the monitor.

3. MONITOR OPERATION

A. Call reception:

When receiving a call, the monitor starts to ring, displaying on the screen who is calling.

If the record function is enabled, the monitor will automatically (iii) take a snapshot or a video (iv), so that if the call is not answered, it is possible to check the visitor image recording in the Missed calls section.

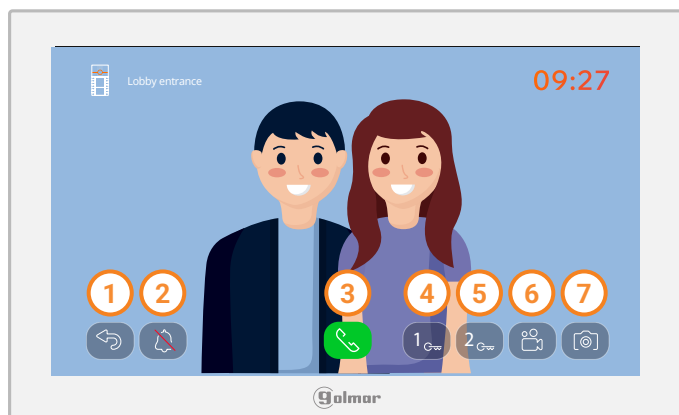

- ① End communication and go to home screen
- ② Mute ring tone
- ③ Start communication
- ④ Open door 1
- ⑤ Open door 2 (v)
- ⑥ Record a video (iv)
- ⑦ Take a snapshot

(iii) To switch between the modes (no-recording, snapshot, recording) touch the icon shown in the home screen, besides the Info icon in the top-left corner.

(iv) To enable this function a micro SD card needs to be inserted in the SD card slot.

2. In communication:

In a communication process with a door panel, the options are similar to "Call reception", but it will be also possible to adjust the communication volume or to mute the microphone for privacy.

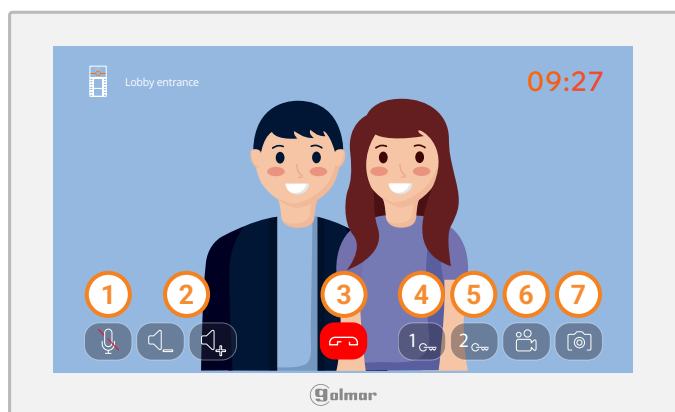

- ① Mute microphone
- ② Adjust communication volume
- ③ End communication
- ④ Open door 1
- ⑤ Open door 2 (v)
- ⑥ Record a video (iv)
- ⑦ Take a snapshot

(iii) To switch between the modes (no-recording, snapshot, recording) touch the icon shown in the home screen, besides the Info icon in the top-left corner.

(iv) To enable this function a micro SD card needs to be inserted in the SD card slot.

4. DOOR PANEL PREVIEW

It is possible to access to the door panel live image by pressing on the  icon from the home screen.

The monitor will show only those panels from which the monitor can be called, i.e. general panels if exist, and building panels.

For privacy purpose the monitor could be configured, so that some panels might be disabled from this section and therefore not visible although the monitor can be called.

A. Panel selection:

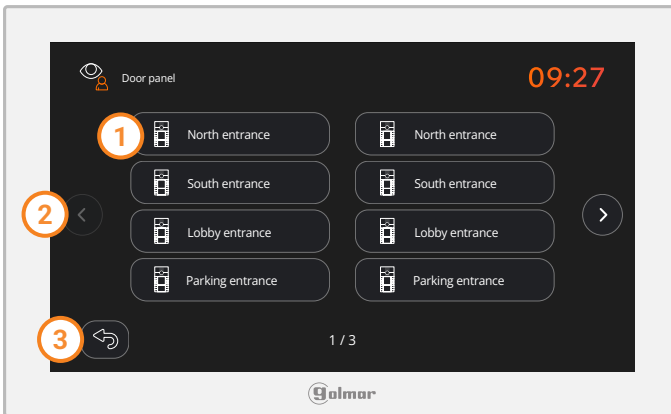

- ① Door panels allowed to be previewed
- ② Move between different screens
- ③ Go to the home screen

B. Preview live image:

During a door panel preview, the live image will be shown on the screen. It is possible to navigate through the different panels if more than one is available.



- ① End communication and back to home screen
- ② Navigate between door panels
- ③ Open audio communication
- ④ Open door 1
- ⑤ Open door 2 (v)
- ⑥ Record a video (vi)
- ⑦ Take a snapshot

(v) Doorlock 2 button, will appear only if the monitor has the right to open a second door lock.

(vi) To enable this function a micro SD card needs to be inserted in the SD card slot.

5. MISSED CALLS

It is possible to access to the list of missed calls and events by pressing on the  icon from the home screen.



- ① Call notifications
- ② Move between different screens
- ③ End communication and back to home screen
- ④ Delete the events.

A. Type of events:

The events received by the monitor will depend on the system setup. Those are the most relevant event type:

- Missed call from panel.
- Recordings: snapshot or video.

Other type of events may be shown depending on the system configuration, like door opened reminder, intercom from apartment

B. Delete events:

By pressing on the bin icon, it is possible to delete the call notifications.

Once the basket bin is pressed, it is possible to choose which images or events are to be deleted, by pressing on each one, or choose all, by pressing on the selection icon  that appears in the left side of the bin.

When the call notifications to be deleted are chosen, press again on the bin icon and confirm the erasing of the notifications.

C. Check recordings:

If the origin of the call is a door panel, and the recording function has been enabled, a recording event will be shown as a notification. The notification can be a video recording or a snapshot, which can be checked by pressing on the event.

Snapshot

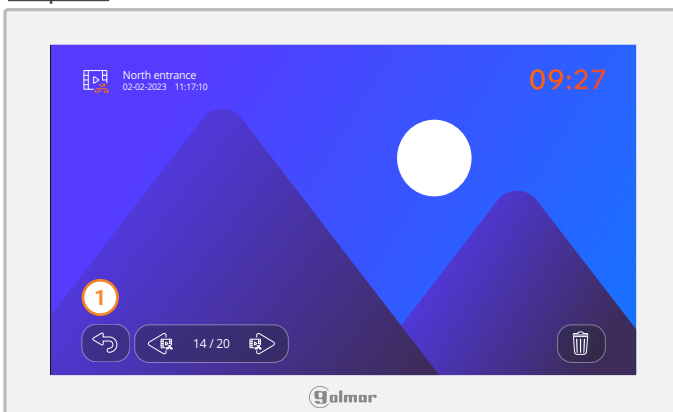

- ① Go to the "Missed calls" menu
- ② Move through the notifications

Video recording

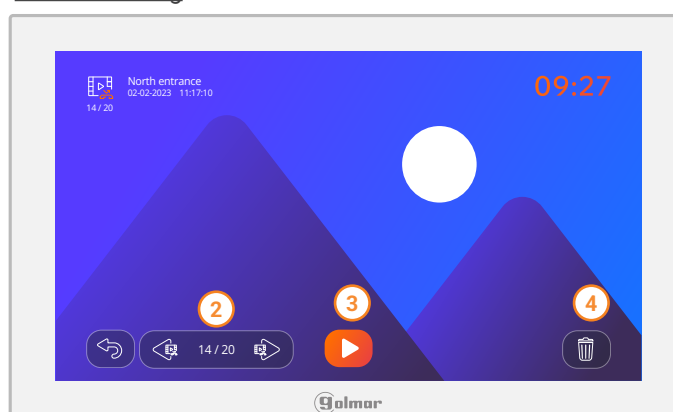

- ③ Play the recording
- ④ Delete

6. MESSAGES

A. Check messages:

If text messages have been received by the monitor, the message list can be accessed by pressing the messages icon on the home screen.

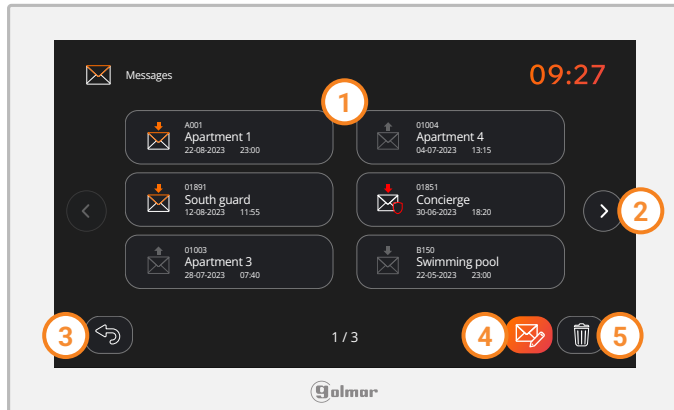

- ① Messages
- ② Move between different screens
- ③ Home screen
- ④ Create a new message (vii)
- ⑤ Delete messages

(vii) Create a new message, is a special function which requires to be enabled by the installer.

B. Delete messages:

By pressing on the bin icon, it is possible to delete the calls notifications.

Once the basket bin is pressed, it is possible to choose which messages to be deleted, by pressing on each one, or choose all by pressing on the selection icon that appears in the left side of the bin.

When the the text messages to be deleted are chosen, press again on the bin icon and confirm the erasing of the notifications.

C. Read messages:

By pressing on a message it is possible to read it. If the monitor has the right enabled to write messages, it will be possible to forward to another recipient or to reply to the sender.

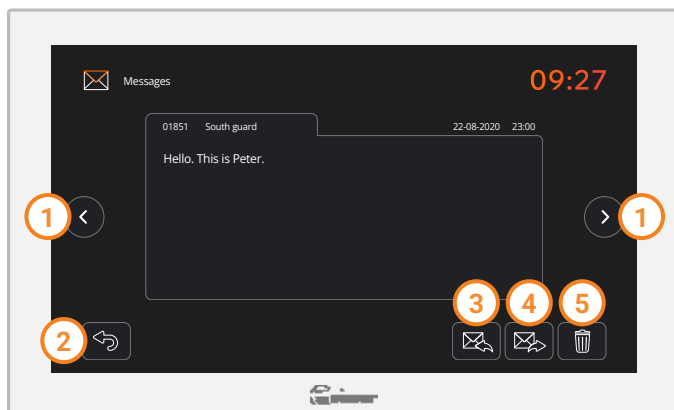

- ① Move between different messages
- ② Home screen
- ③ Answer to the message
- ④ Forward the message
- ⑤ Delete the messages

D. Write a new message (only if the option is enabled):



- ① Add recipients: It is possible to add recipients by dialing the address or by searching in the list of favourite contacts
- ② Go to the message list
- ③ Send message

E. Add recipients:

It is possible to directly write the monitor address to which you like to send the message or select it from the favourite contacts list.

If the favourite contacts list is empty it need to be created.

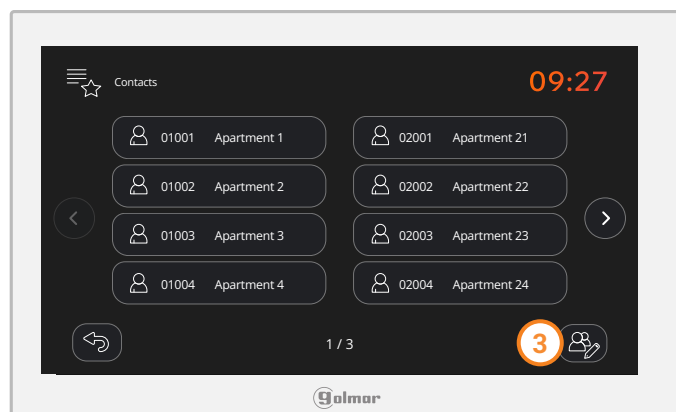
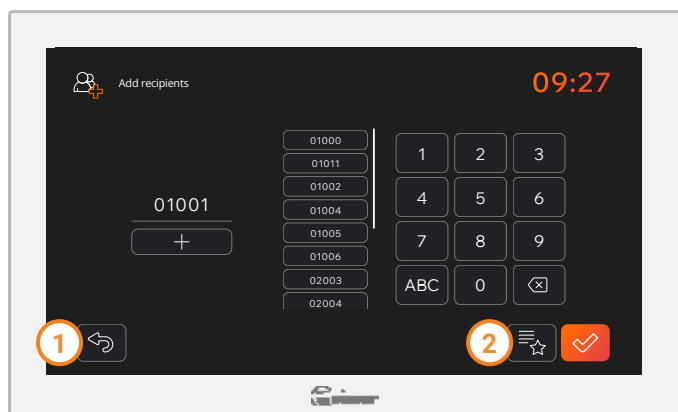

- ① Previous screen
- ② Choose recipients from the favourite contact list

- ③ Modify the favourite contact list

F. Create a favourite contacts list (only if the option is enabled):

It is possible to edit the favourite contacts list. It needs to be selected the block where the user belongs, and select the users from the block.

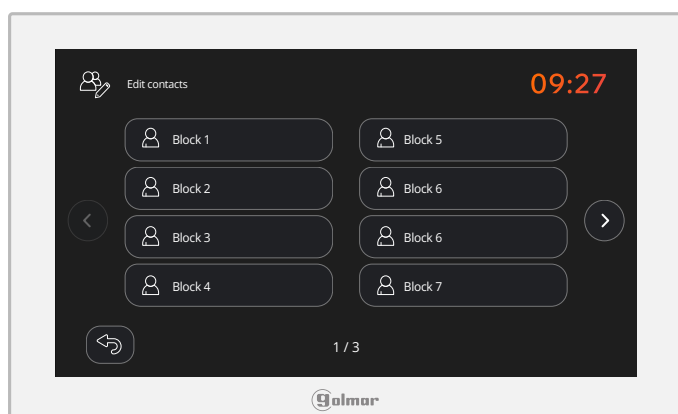

Choose the block where the contact to be added belongs.

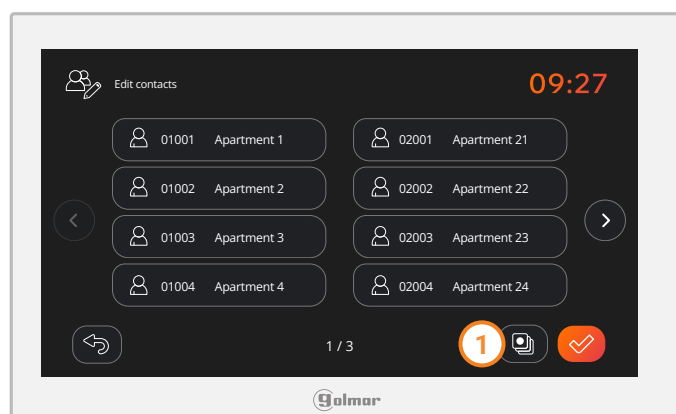

Select the contact to be added and confirm.

- ① Choose all contacts

7. INTERCOM

Edge monitor can initiate and receive intercom calls from other units inside the same apartment or even with units among other apartments in the system. The monitor will present the following home screen in case this function has been activated.

NOTE: This function is only accessible if it has been previously activated by the installer.

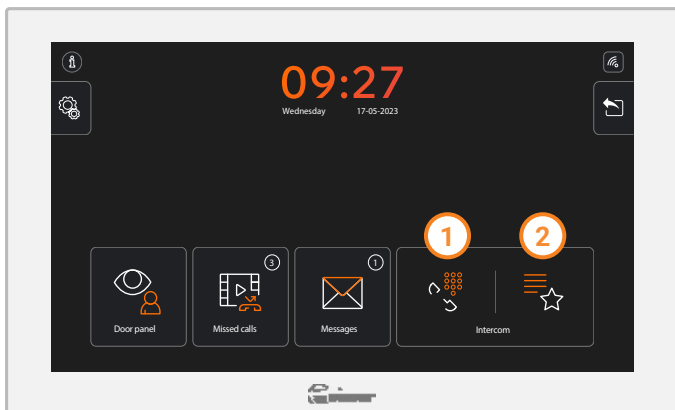

- ① Initiate an intercom call
- ② Direct access to favourites list

A. Dial a call number:

Press the intercom button to access to the dial pad screen. Chose the address of the neighbour you will intercom with.

You can get a fast access to your favourite contacts list to avoid having to dial the number.

NOTE: You can know your own dialling address in the about page. Access from the main screen as described in section 2 of this manual.

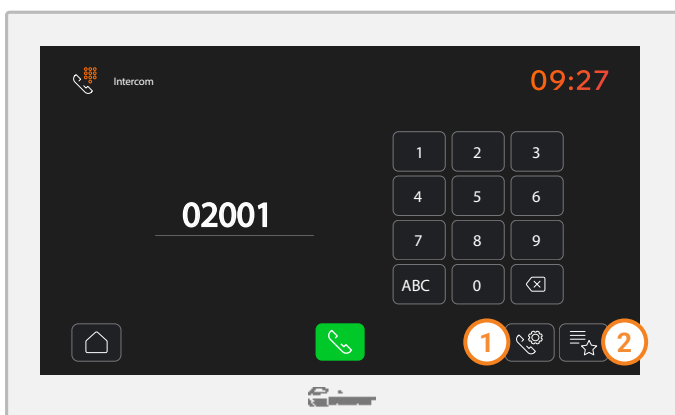

- ① Edit privacy settings
- ② Direct access to favourites list

B. Answer an intercom call:

When receiving an intercom call the following actions can be performed:

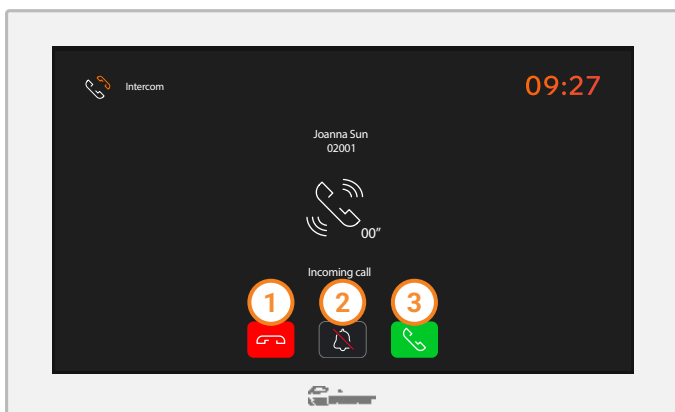

- ① Refuse the call
- ② Mute the ring tone
- ③ Answer the call

C. Answer an intercom call:

While in communication it is possible to mute the microphone for privacy or to adjust the communication volume setting.



- ① Communication adjustments
- ② Finish the communication

D. Privacy settings:

For privacy purposes it is possible to set the intercom setting, being possible between:

- Everyone: Any other apartment unit can call to my monitor.
- Favourite contacts: Only those which are in my favourite contacts list can call my monitor.
- Nobody: The intercom function is disabled, only can be called by guard units.

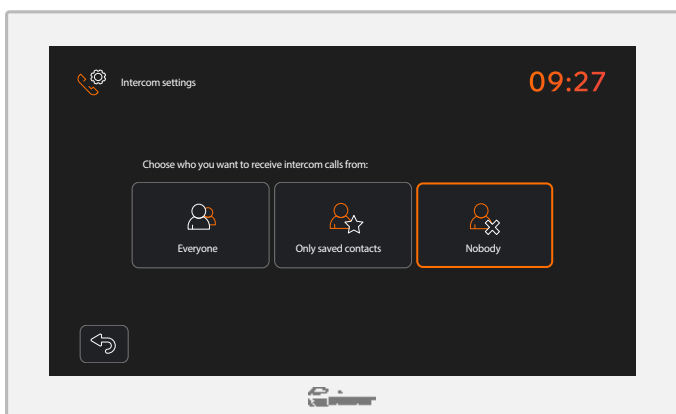

E. Create a favourite contacts list:

It is possible to edit the favourite contacts list. It needs to be selected the block where the user belongs, and select the users from the block.

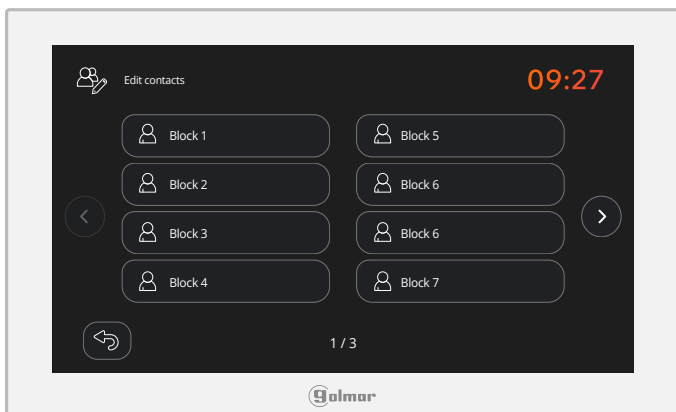

Choose the block where the contact to be added belongs.

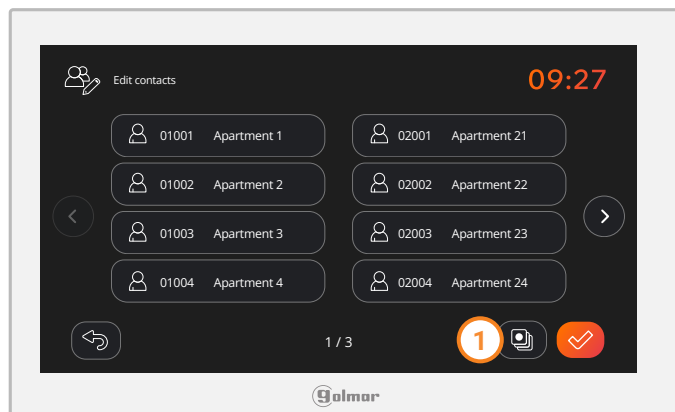

Select the contact to be added and confirm.

- ① Choose all contacts

8. CCTV

Edge monitor can stream live images from the CCTV cameras from an installation. If this feature has been enabled the monitor will show the following icon to get access to the cameras live stream.

NOTE: This function is only accessible if it has been previously activated by the installer.

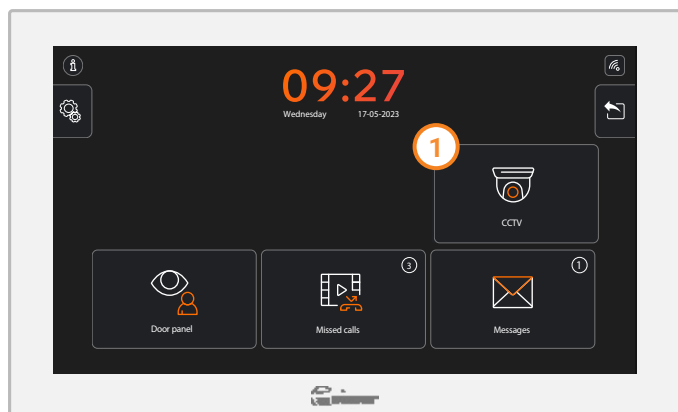

① Go to CCTV cameras list

Once in the list of cameras, navigate through the multiple pages, if there are more than 8 cameras visible by your monitor. Click over the desired camera to see it.

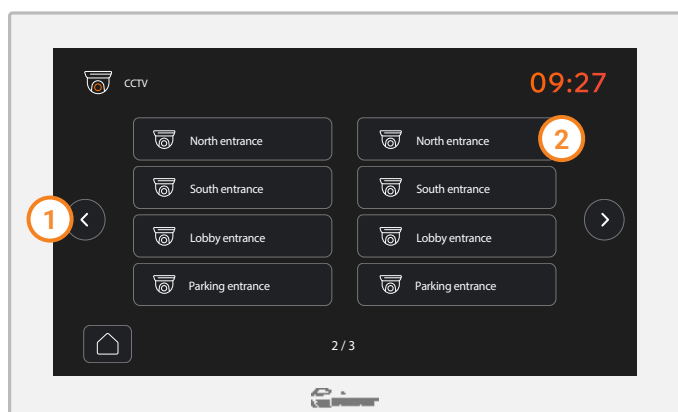

① Move between screens

② Select the camera to stream

While streaming the live video, it is possible to switch to next camera available or to record a video (viii) or take a snapshot.



① Back to previous page

② Move among available cameras

③ Take a snapshot / Record a video (viii)

(viii) To enable this function a micro SD card needs to be inserted in the SD card slot.

9. SOS & CONCIERGE

Edge monitor can place a call directly to the concierge service that has been set up. Can also configure an SOS button that will activate when held down for 3 seconds. This option also allows alarm events to be forwarded to the concierge service so that they are kept informed at all times.

NOTE: This function is only accessible if it has been previously activated by the installer.

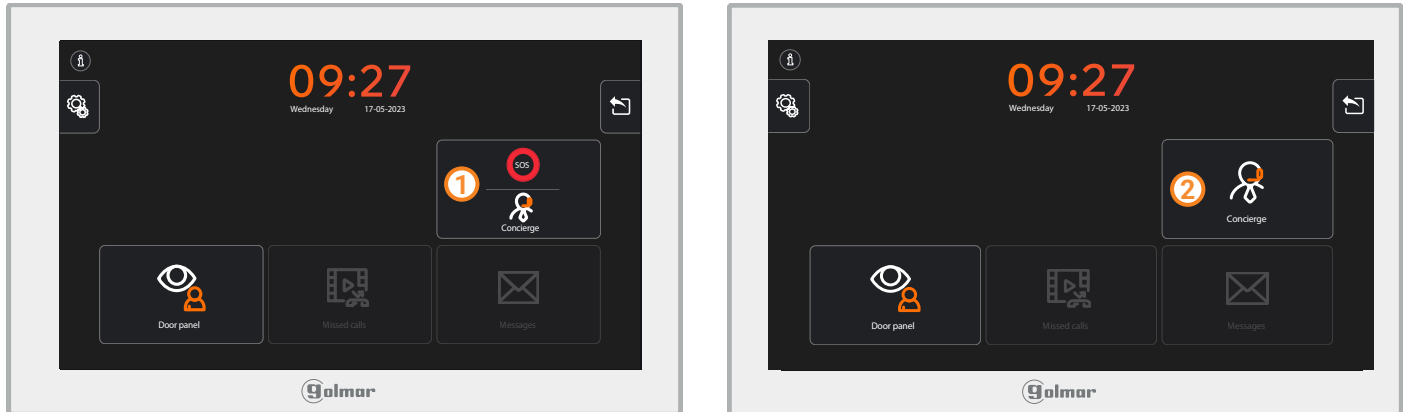

① Hold for 3 seconds to initiate an SOS call to concierge. ② Short press, initiate a call to concierge.

10. ALARMS

We have 2 modes for alarms: armed (color green) or disarmed (color red). To change the status, click on the colored icon. The default code to disarm a zone is "9999". You can change this code by selecting the "User" option and then "Change alarm password". It will be prompted to enter the current code and then the new code want to set.

NOTE: This function is only accessible if it has been previously activated by the installer.

NOTE: It is possible to activate this function in the G2Call+. Instructions are provided in the app manual.

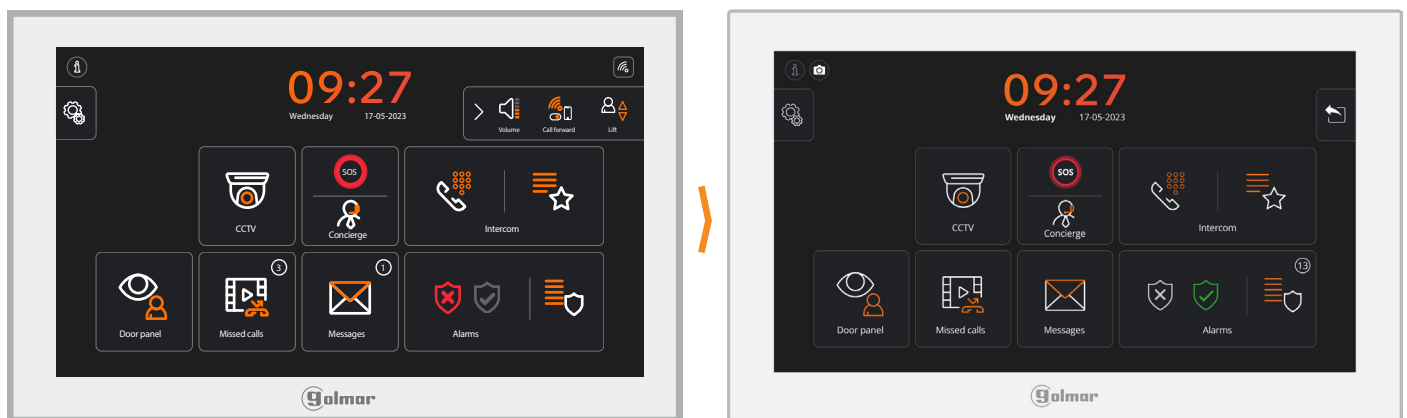

☰ Within the 5 lines, you'll find all alarm events, including the date, time, and zone. Can view the status of the other input zones by tapping the "i" icon, or clear all events using the other icon on the right.

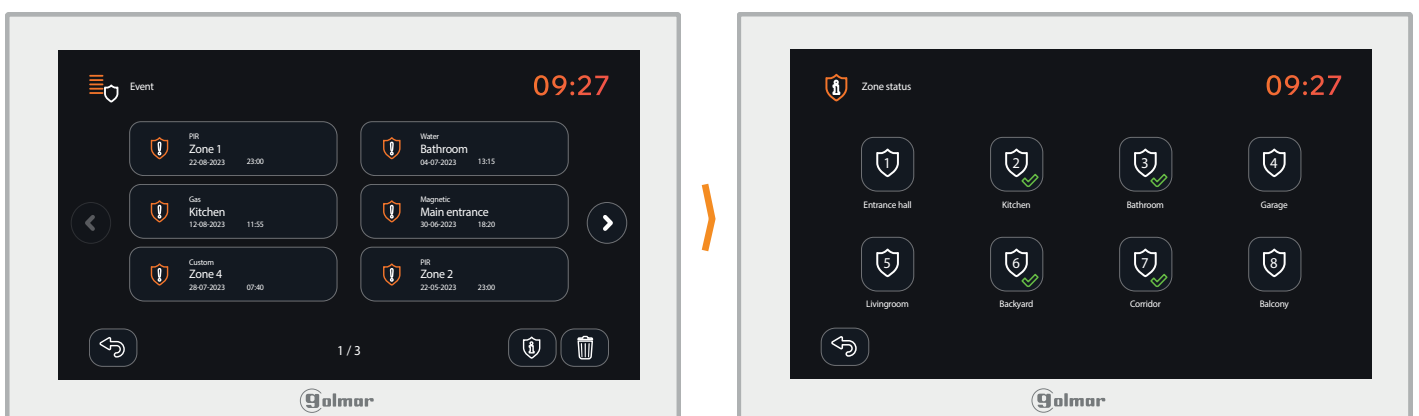

11. SETTINGS & SHORTCUTS

Deploy the tab with the different monitor settings options from the home screen of the monitor. Find it in the left side.

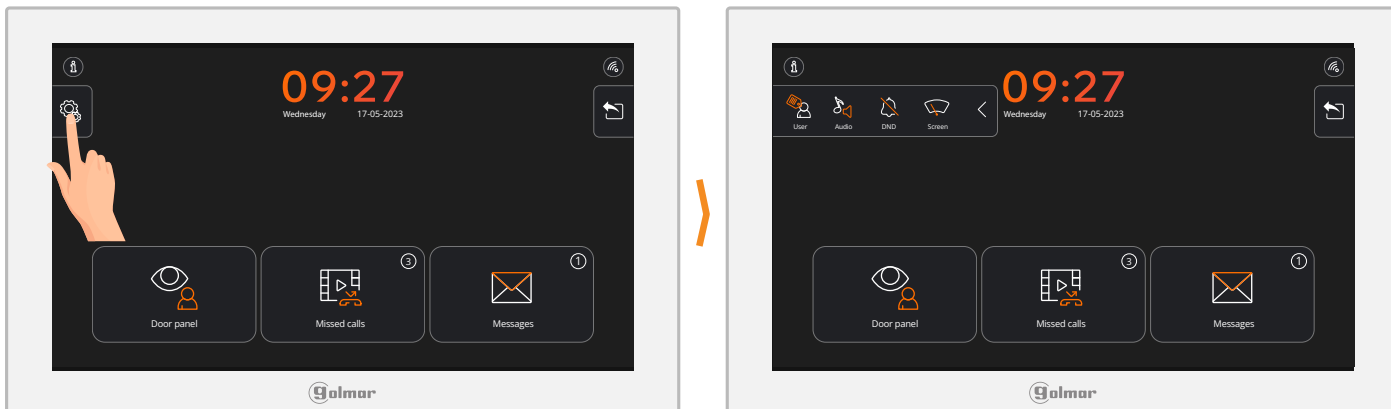

11.1 User settings

From the user settings section it is possible to change:

- The language of the monitor.
- The name which will be displayed on the panel (panels with display screen) or from other monitors contact's list (ix).
- Adjust the monitor time.
- Change the private access PIN code to be used at the entrance (ix).
- Change the private PIN code to disarm alarm zones.

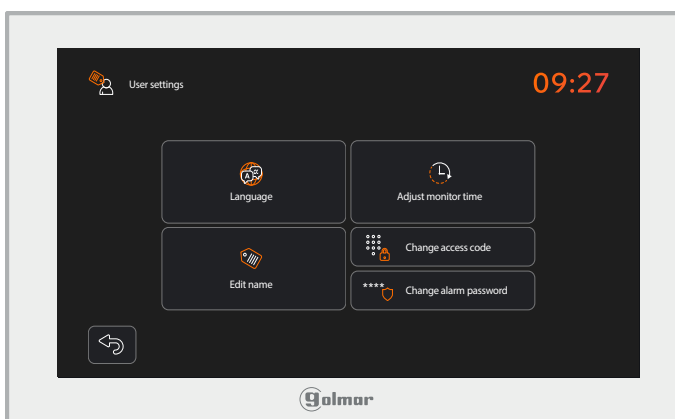

(ix) If those options are not available, they might be blocked by the installer.

A. Language:

Choose the desired language for the monitor user interface and confirm the selection. After that, a confirmation screen will appear notifying that the monitor will reboot to apply the language setting modifications. If the language is shown in grey, it means that the language is not available in this monitor version.

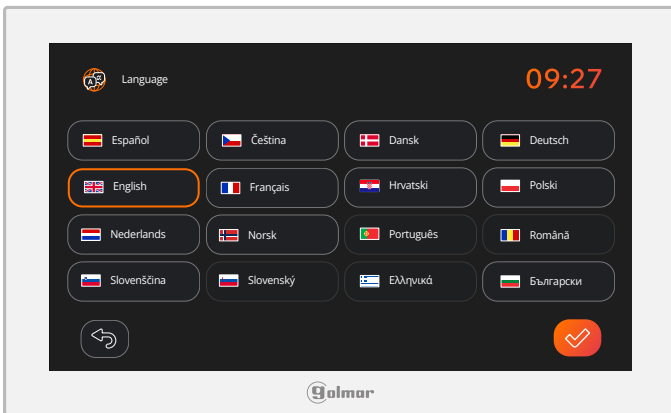
**B. Edit name:**

Enter the name with the keypad and validate the new name for the monitor. After that, a notification screen will appear notifying that the name change will be effective at midnight. It might take effect before, but the name change in the panel display is not immediate, as the system needs to propagate this change among all existing devices.

**C. Adjust monitor time:**

Adjust the time and date by swipe up and down the numbers. It is possible to modify the format of the date, choosing between "dd/mm/yyyy" or "yyyy/mm/dd". The time format can also be modified by choosing between 24h or 12h format (AM/PM).

When "Use system time" option is enabled, the monitor takes the default time set by the system. Disable this option to set your own preferred time. It is possible to hide the time in the home screen, by turning off the "Show monitor time" option.

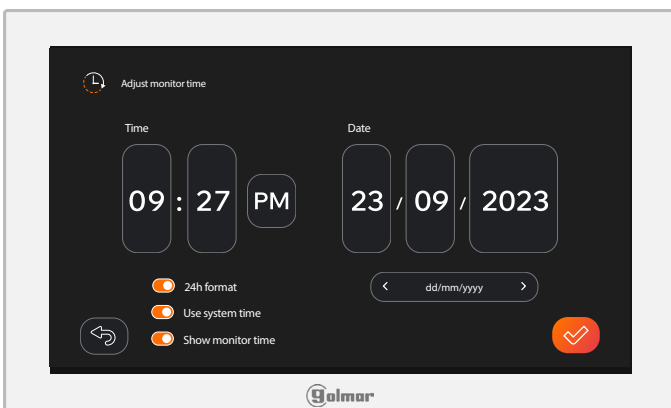

D. Change access code:

This option will only appear if the right has been enabled by the installer.

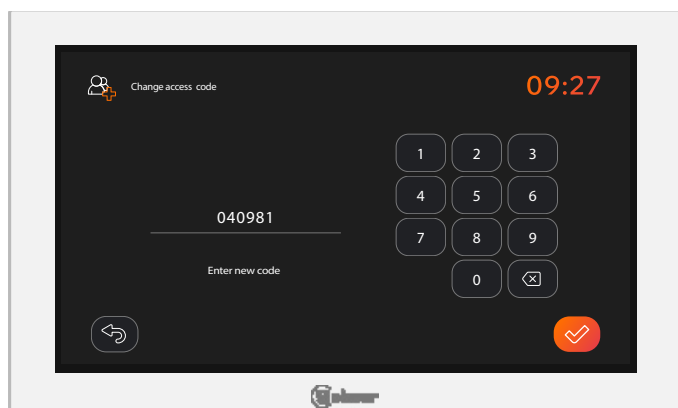

11.2 Audio settings

Adjust the volume level of the ring tone, and set the different melodies to differentiate the origin of the call. It is also possible to disable the beep push confirmation tone.

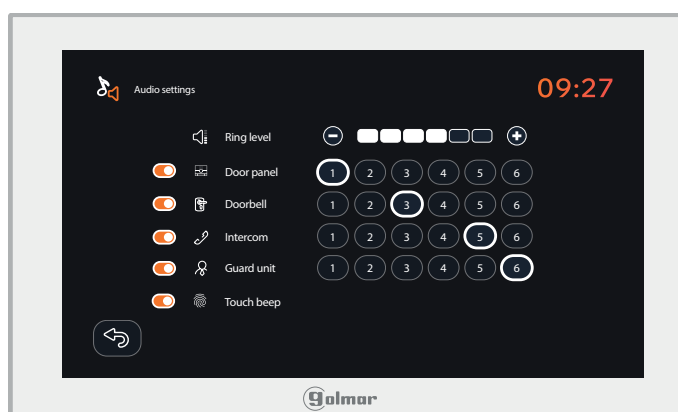

11.3 Do not disturb (DND)

Enable the "Do not disturb" mode, which can be programmed during a period of time. When this mode is enabled the monitor won't reproduce the ring tone call in a call process, furthermore it is possible to keep the monitor screen "off" by enabling the option "Screen off while do not disturb", very useful if the monitor is placed in a bedroom. It is also possible to make the panel to request for a voice message to the visitor, by activating the "Leave message" option. This prompt can be instantaneous or if the call is not answered. It is possible to activate and program during a period of time the automatic door opening. In this mode, the door will be automatically opened when the call is made from the door panel to this particular monitor address. This feature need to be enabled by the installer as it requires a PIN code.

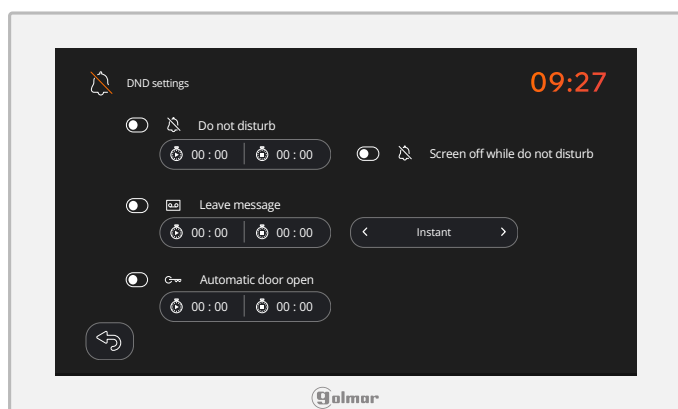

11.4 Screen settings

From the screen settings it is possible to enable the cleaning mode. In this mode the screen won't be reactive to touch for 30s.

It is also possible to change the background image (x). To do so, it is necessary to enter a SD card with the image file to be uploaded in the SD card slot.

The format of the image file must be PNG or JPG, and the size must be 1024 x 600px.

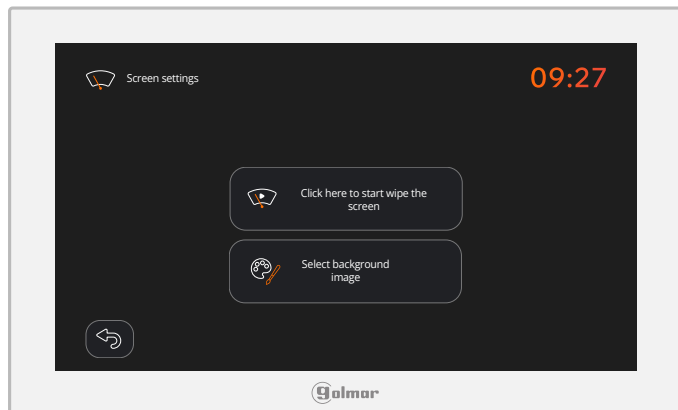

(x) Background image edition might have been disabled by the installer. If so, it won't be possible to access this function.

11.5 Shortcuts

It is also possible to deploy the shortcuts tab, which contains a direct access to the volume level and Wi-Fi setting. Find it on the right side of the monitor.

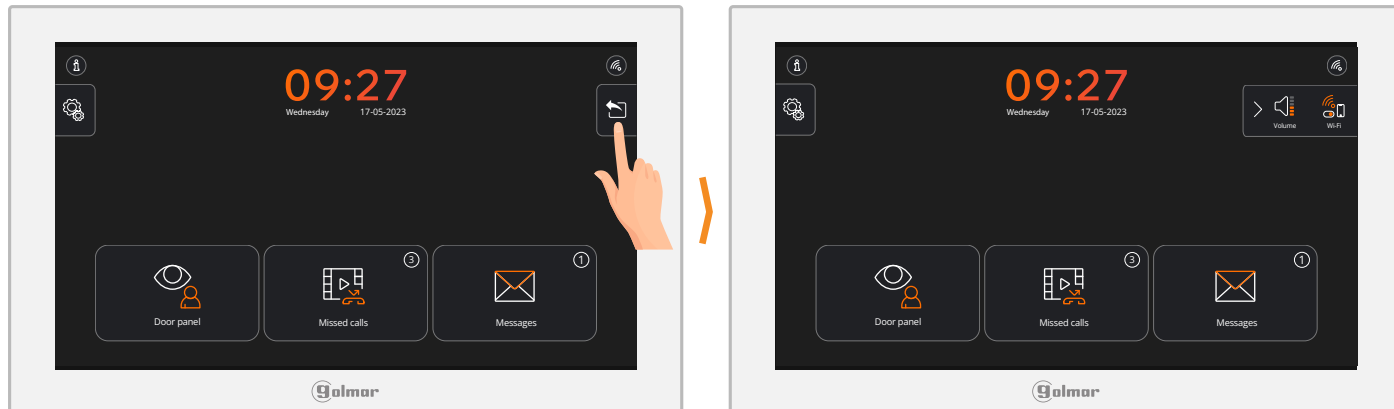

Volume adjustment:

By pressing on this icon, it is possible to adjust the volume level of the monitor. Every time that the icon is pressed, the volume level will be modified in a cyclic way. To mute the ring tone, go to the DND function in the monitor settings as described in 11.3.



Wi-Fi activation and settings:

It is possible to turn off and on the Wi-Fi connectivity of the monitor by pressing the icon. If the icon is pressed and hold for 5s, then the monitor will open the Wi-Fi setting section. This option only is available in Wi-Fi monitors version EDGE 7W/G+ or EDGE 7BW/G+ or EDGE 7AW/G+.



Staircase light control:

If your system has been equipped with a staircase light control, it will be possible to activate from your monitor the lights from your corridor for a better comfort.

12. PAIRING THE WI-FI MONITOR WITH THE G2CALL+ APP

This section, only applies to Wi-Fi monitors models EDGE 7W/G+ or EDGE 7AW/G+. Once in the Wi-Fi setting section, the monitor will display the next screen:

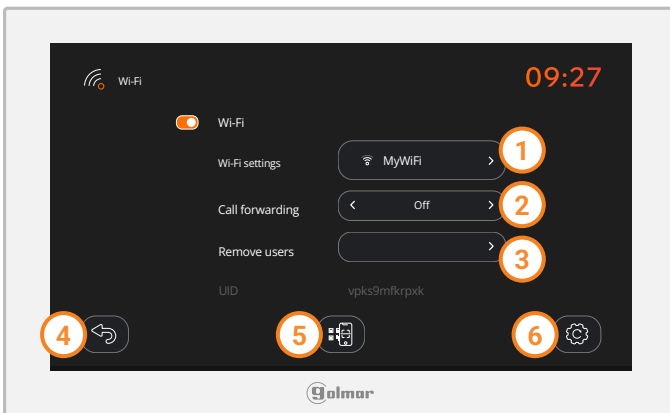

- ① Choose the Wi-Fi network
- ② Set the call forwarding mode:
On / Off / If no answer / After 15s
- ③ Unbind current account from G2Call+ access (Xi)
- ④ Go to main screen
- ⑤ Display QR for pairing and App's
- ⑥ Reset Wi-Fi settings

(xi) If the monitor is paired with an account from a previous resident, it needs to be unbound with this function.

A. Choose the Wi-Fi network:

First of all, the user must choose the Wi-Fi network, to which the monitor must connect. Choose the Wi-Fi network between all the found ones and enter the password in the screen that the monitor will display after choosing it.

NOTE: Edge 7W monitor is compatible only with 2,4 Ghz Wi-Fi networks.

If you find problems on pairing the monitor, try to change the channel of the Wi-Fi network in the router settings, since the channel might be saturated. Make sur that the 5 Ghz network SSID name is different than the 2,4 Ghz network.

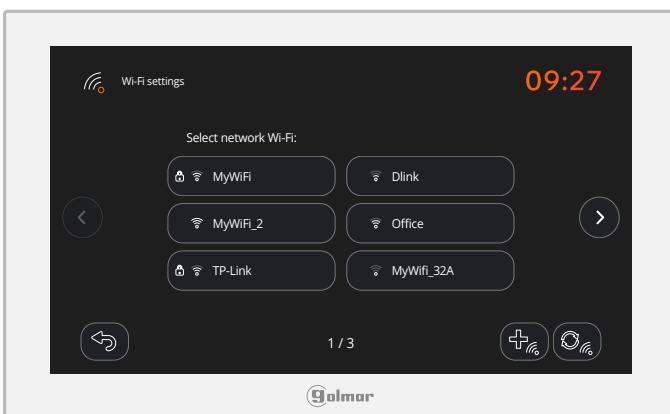

B. Pair the monitor:

Once the monitor is connected to the Wi-Fi network, press over the  icon to display the QR codes to pair the monitor. You will find three QR codes in that screen. Two are for the App direct download link to the G2Call+ App (Android and iOS versions). The third QR code is the one which needs to be scanned by the G2Call+ App.

After creating the user account in the G2Call+ App, scan the pairing QR code and follow the steps that the app requests.

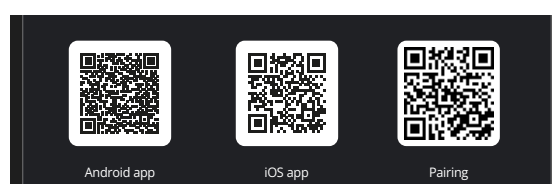

For more information about the G2Call+ App, see the [USM_ENG_REV0221_APP_G2CALL+_IP_G+](#) that you can find in our website in the EDGE monitor section's downloads area.

13. LINK ALEXA WITH EDGE MONITOR

This section, only applies to Wi-Fi monitors models EDGE 7W/G+ or EDGE 7WB/G+ or EDGE 7AW/G+. To link Alexa with Edge monitor it is necessary to have an Alexa account previously registered and to have paired the EDGE monitor with G2Call+ App. Once it is completed follow this steps:

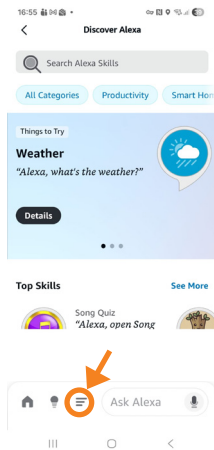

Select the options icon in Alexa App

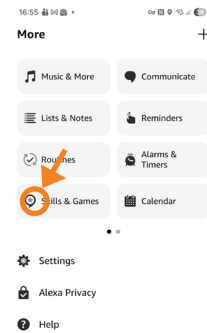

Select Skills in Alexa App

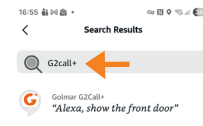

Search for Golmar G2Call+

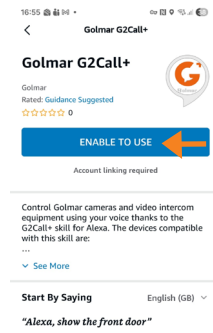

Enable its use

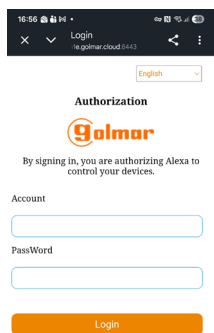

Log-in with your G2Call+ credentials

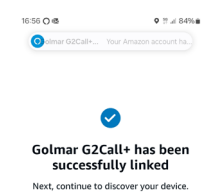

Go Next for accepting searching for devices

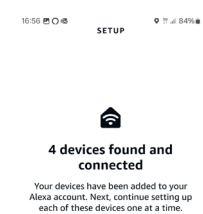

Go Next to define which devices to configure

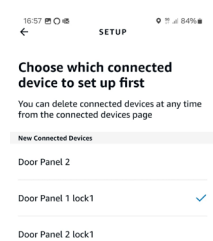

Select the device to set up

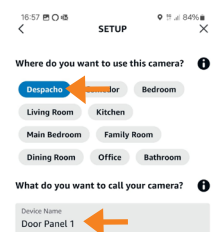

Select in which room is located the device and set up a name to identify it

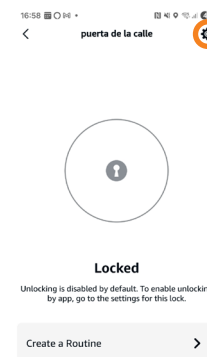

Go to the device and select the configuration option.

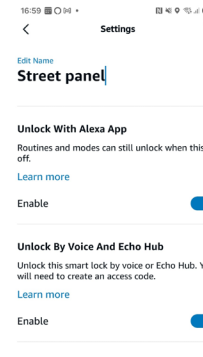

Enable the "Unlock with Alexa App" and "Unlock by voice". A PIN will be requested

14. LINK GOOGLE HOME WITH EDGE MONITOR

This section, only applies to Wi-Fi monitors models EDGE 7W/G+ or EDGE 7WB/G+ or EDGE 7AW/G+. To link Alexa with Edge monitor it is necessary to have an Alexa account previously registered and to have paired the EDGE monitor with G2Call+ App. Once it is completed follow this steps:

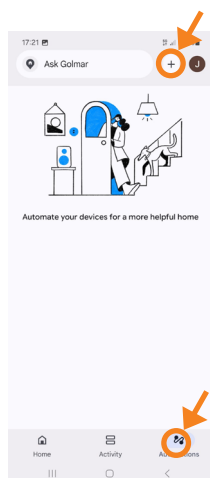

Select the "Automations" option and add an automation.

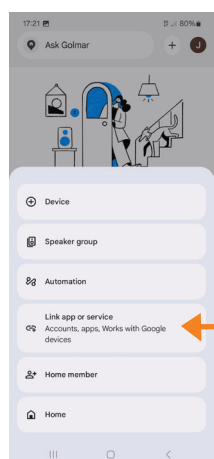

Select "Link App or Service"

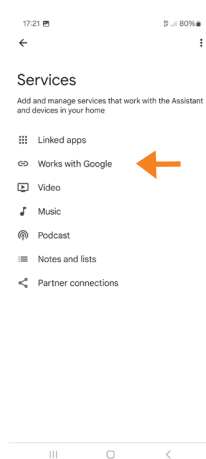

Select "Works with Google"

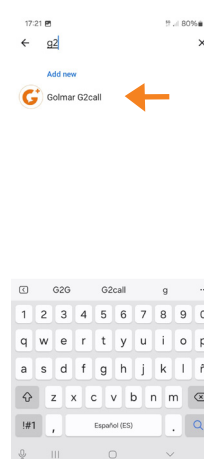

Search for G2Call+ App

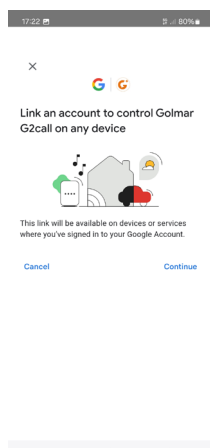

Accept the link requests.



Log-in with your G2Call+ credentials

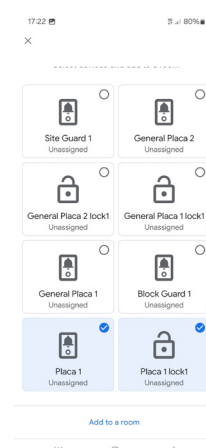

Define which devices to add

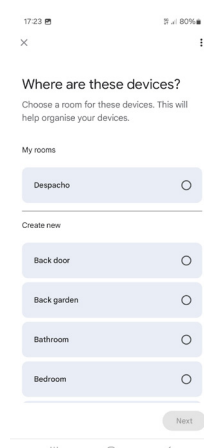

Select the device location

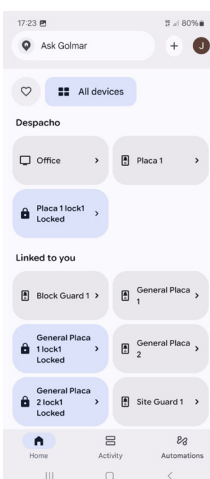

Configure the device

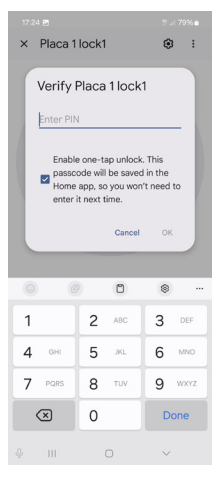

Set a PIN code to allow unlock the door.

Note: Google home only allows the preview and door unlock function. It is not possible to receive the calls from the panel.



we take care of your home

Golmar Sistemas de Comunicación S.A.
C/ Silici 13. Polígono Industrial Famadas
08940 - Cornellà de Llobregat - Spain
golmar@golmar.es - (+34) 93 480 06 96

www.golmar.es



Golmar se reserva el derecho a cualquier modificación sin previo aviso.
Golmar reserves the right to make any modifications without prior notice.
Golmar se réserve le droit de toute modification sans préavis.