

16	208176	1128C INOX. CHROME G1/2"--G1/2" FLEXIBLE HOSE 1.55m ANTITWIST SYSTEM
15	251331	2876 BT CHROME SHOWER 3F ANTI-LIMESCALE IN BOX
14	251322	RP240 CHROME SHOWER HEAD ABS OF 240mm
13	261737	SDT SOPORTE DESLIZANTE BOTON T100N
12	242223	T100N CHROME SPOUT NO AJUSTABLE W/O DIVERTER Ø19
11	300096	IDH1/2 DIVERTER SHOWER H1/2 M3/4
10	160257	E 1/2.-3/4. ST ECCENTRIC STANDARD
9	167127	1325 CHROME ESCUTCHEON CONIC
8	182094	1324 CHROMED ESCUTCHEON + ECCENTRIC STANDARD
7	160220	T 3/4. SIMPLE NUT CHROMED
6	252816	AGM-2I SIT OF LEFT THREAD NUT
5	252978	35000-3 CARTRIDGE UPPER O-RING Ø35 S2
4	253014	TSC350 CARTRIDGE NUT FOR 35000, 35000-2 & 35000-3
3	252834	4980 COVER FOR CARTRIDGE 35000. 35000-2 & 35000-3
2	252825	DT1-CN INDEX CHROMED NEUTRAL
1	252987	1800-35 CHROME TITANIUM HANDLE LEVER IN BAG
Nº Reference		Denomination

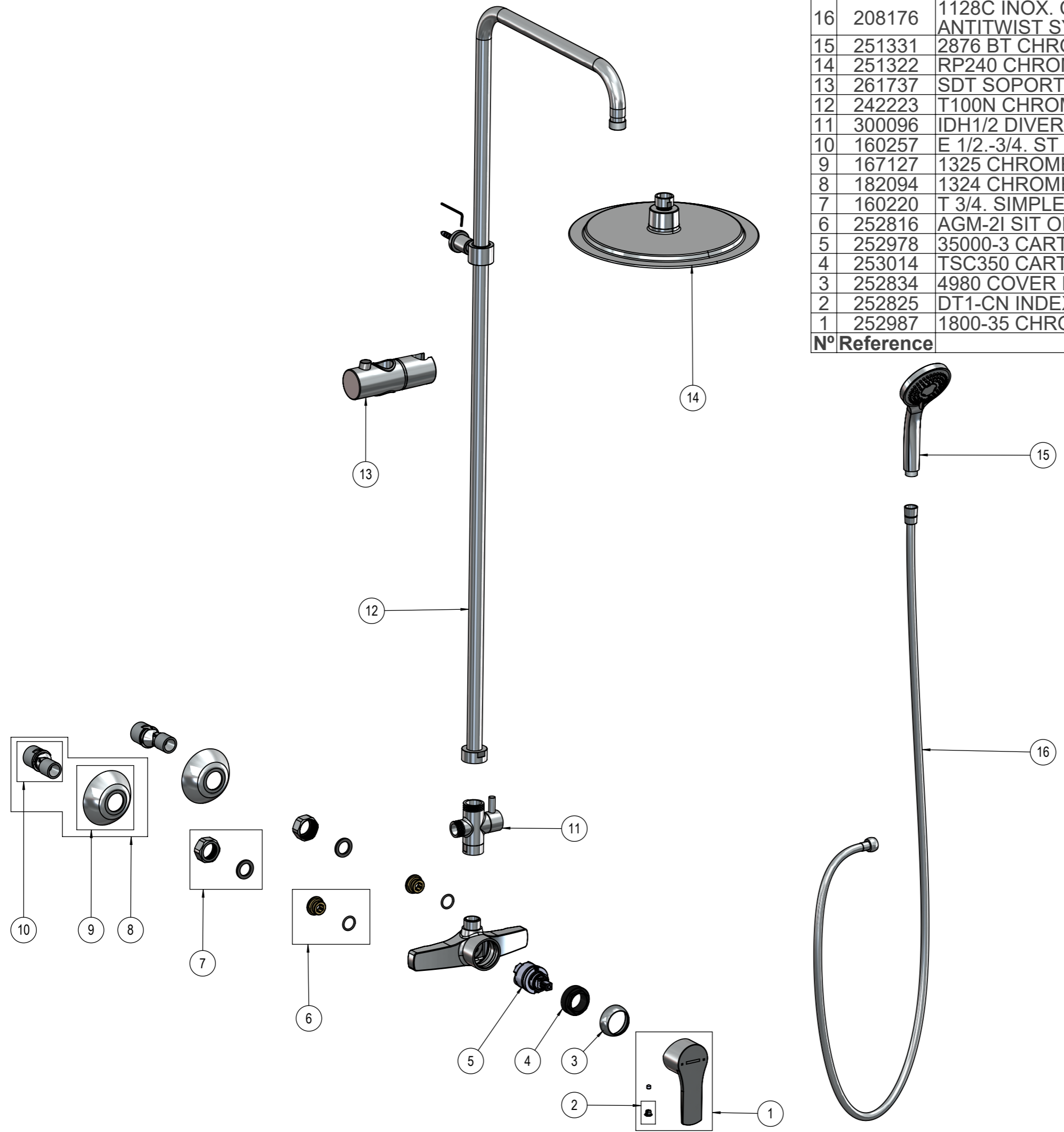

Ramon Soler®

**1878 RP240 (1838
S+T100N+IDH1/2+RP240+2876
BT+1128C)**

Drawn: C. Rosas	Approved: J. Romero	18-261504
--------------------	------------------------	-----------