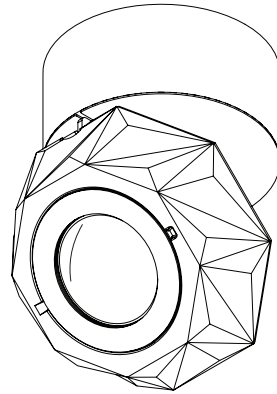
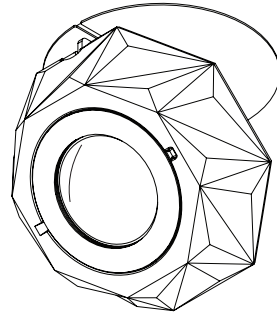

## 6th ELEMENT /C

**EN** INSTALLATION INSTRUCTIONS**FR** NOTICE DE MONTAGE**DE** MONTAGEANLEITUNG**PT** INSTRUÇÕES DE MONTAGEM**ES** INSTRUCCIONES DE MONTAJE

**EN** READ THE SUPPLEMENTARY MANUALS.  
**FR** LIRE LES NOTICES DE MONTAGE SUPPLÉMENTAIRES.  
**DE** LESEN SIE DIE ZUSÄTZLICHEN MONTAGEANLEITUNGEN  
**PT** CONSULTE OS MANUAIS COMPLEMENTARES.  
**ES** LEA LOS MANUALES COMPLEMENTARIOS.

**IIV815**

Order code / Code com. / Bestell-Nr. / Código / Código: 90278L...

**EN** Carefully read the installation instructions provided before installing the device. Safety and Maintenance: Scan here.**FR** Lire attentivement les notices de montage avant l'installation de l'appareil. Sécurité et Entretien: Scannez ici.**DE** Bitte lesen die mitgelieferte Montageanleitung vor der Montage des Geräts. Sicherheit und Wartung: Hier scannen.**PT** Leia atentamente as instruções de montagem fornecidas antes de instalar o aparelho. Segurança e Manutenção: Scan aqui.**ES** Lea atentamente las instrucciones de montaje proporcionadas antes de instalar el aparato. Seguridad y Mantenimiento: Escanea aquí.

# 6th ELEMENT /C

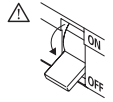

W	mA	V	(mm)	(mm)	(mm)	(mm)
9	250	34,4	Ø140x80	200x200	135x135	10-25
12	350	35,4	Ø140x80	200x200	135x135	10-25

## TOOLS | OUTILS | WERKZEUG | FERRAMENTAS | HERRAMIENTAS

Umbrako 2,5mm  
Phillips screwdriver



**EN** USE GLOVES.  
**FR** UTILISEZ DES GANTS.  
**DE** HANDSCHUHE BENUTZEN.  
**PT** UTILIZE LUVAS.  
**ES** USE GUANTES.



## 6th ELEMENT /C

90278L...

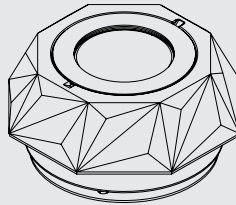

(x1)



(x3)

**CEILING ROSE**  
**PATÈRE DE SUSPENSION**  
**DECKENDOSE**  
**CAIXA DE ALIMENTAÇÃO**  
**BASE DE TECTO**

97201... | 97202...

RECESSED T52 Q200  
ENCASTRÉE T52 Q200  
EINBAU T52 Q200  
ENCASTRART52 Q200  
EMPOTRART52 Q200

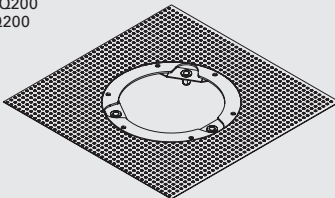

(x1)

97203... | 97204...

SURFACE MOUNTED T51 D120  
SAILLIE T51 D120  
ANBAU T51 D120  
SALIENTE T51 D120  
SUPERFICIE T51 D120



(x3/x5/x7)

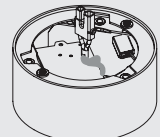

(x1)

+   
**IIV815**

# 6th ELEMENT /C +T52

EN RECESSED

FR ENCASTRE

DE EINBAU

PT ENCASTRAR

ES EMPOTRAR

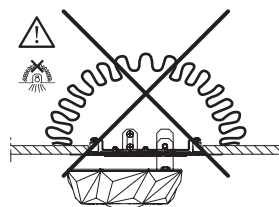
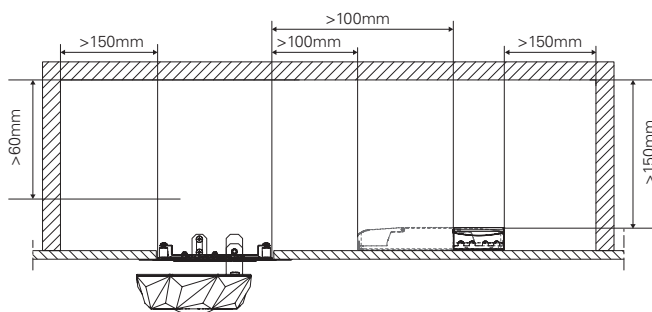
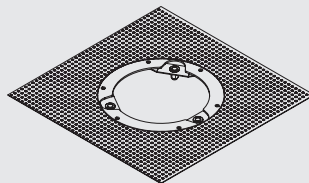
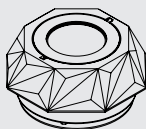

1

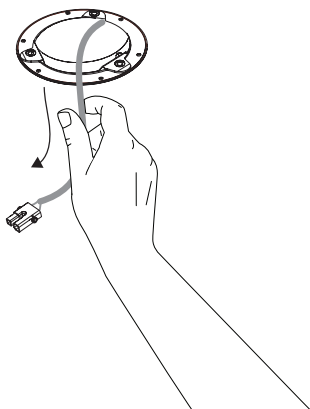

TO ASSEMBLE THE CEILING ROSE, READ:  
POUR LE MONTAGE DE LA PATÈRES DE  
SUSPENSION LIRE :  
ZUR MONTAGE DER DECKENDOSE LESEN:  
PARA A MONTAGEM DA CAIXA DE  
ALIMENTAÇÃO LER:  
PARA LA MONTAJE DE LA BASE DE TECHO,  
LEER:



IIV815

### 1.1

1.

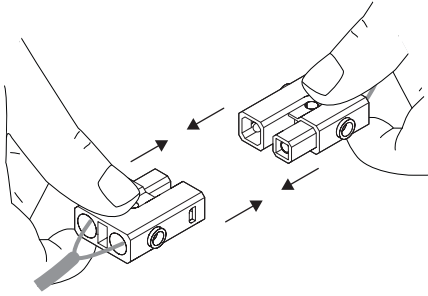

2.

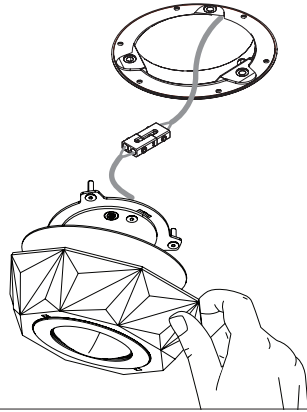

### 1.2

1.

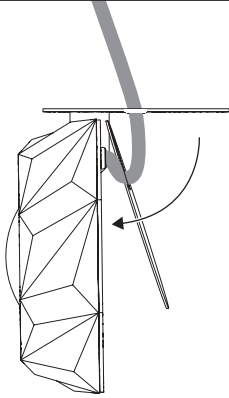

2.

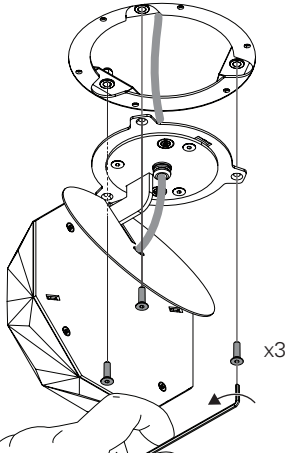

3.

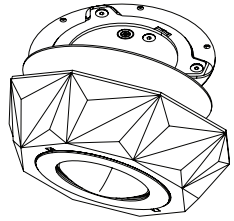

### 1.3

1.

-click-

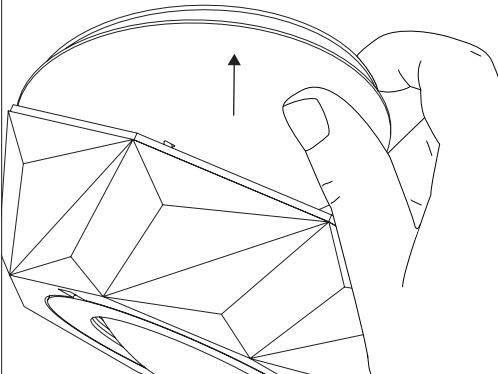

2.

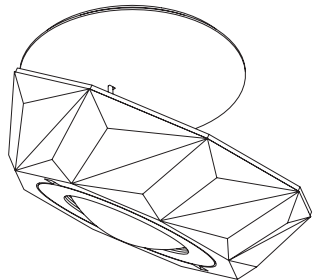

1.4

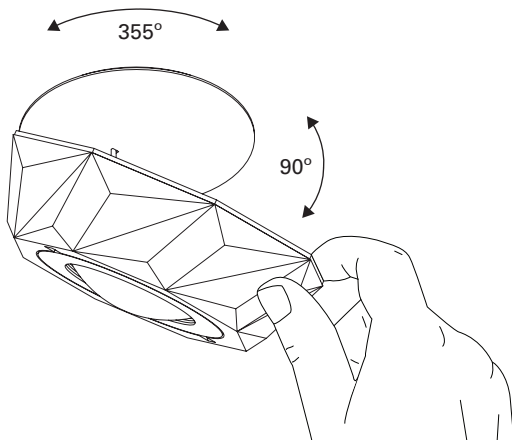

## 6th ELEMENT /C + T51

**EN** SURFACE MOUNTED

**FR** SAILLIE

**DE** ANBAU

**PT** SALIENTE

**ES** SUPERFICIE

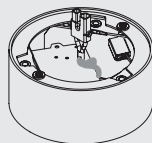
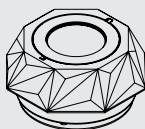

2

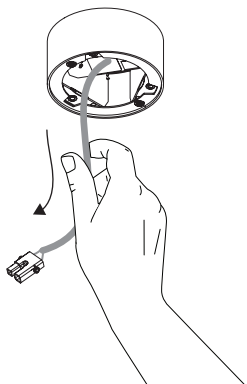

TO ASSEMBLE THE CEILING ROSE, READ:  
POUR LE MONTAGE DE LA PATÈRES DE  
SUSPENSION LIRE :  
ZUR MONTAGE DER DECKENDOSE LESEN:  
PARA A MONTAGEM DA CAIXA DE ALIMEN-  
TAÇÃO LER:  
PARA LA MONTAJE DE LA BASE DE TECHO,  
LEER:



**IIV815**

## 2.1

1.

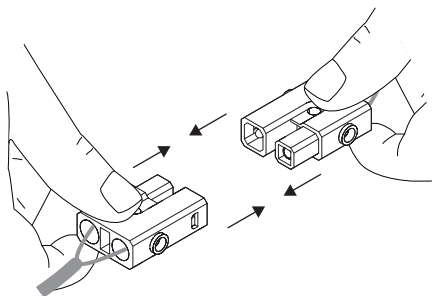

2.

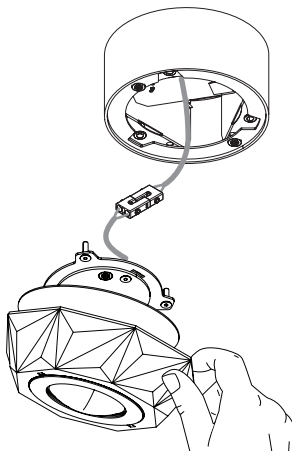

## 2.2

1.

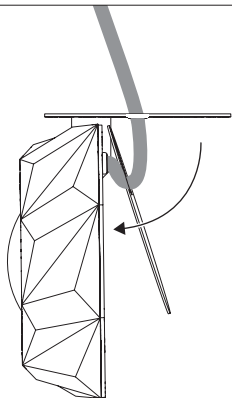

2.

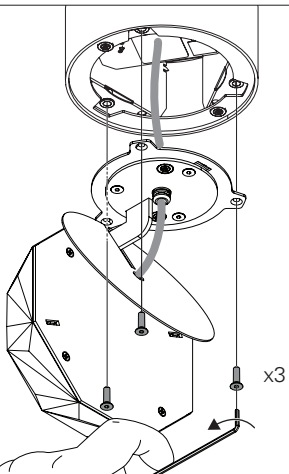

3.

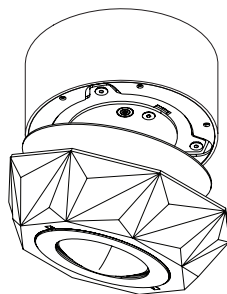

## 2.3

1.

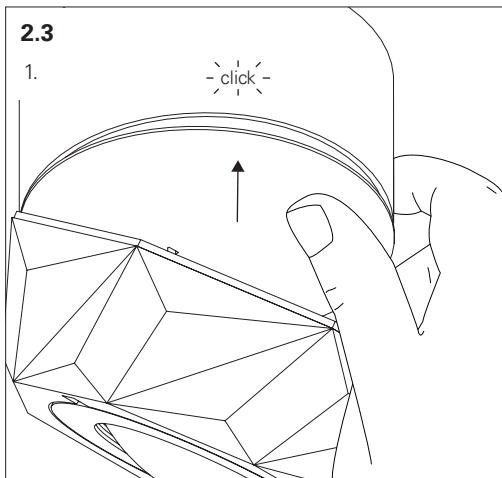

2.

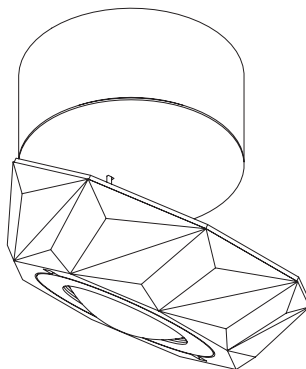

2.4

