

ELI 50 / E 1 | ELI 50 / E 2 | ELI 50 Sq / E 1 | ELI 50 Sq / E 2 | ELI 50 Spot / E 1 | ELI 50 Spot / E 2

EN INSTALLATION INSTRUCTIONS
FR NOTICE DE MONTAGE
DE MONTAGEANLEITUNG
PT INSTRUÇÕES DE MONTAGEM
ES INSTRUCCIONES DE MONTAJE



IIV794



ELI 50 / E 1

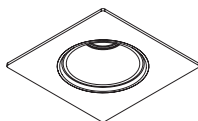

ELI 50 Sq / E 1

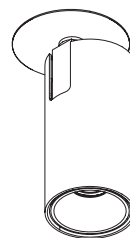

ELI 50 Spot / E 1

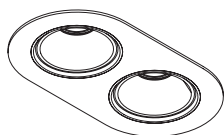

ELI 50 / E 2

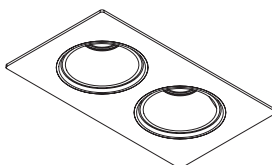

ELI 50 Sq / E 2

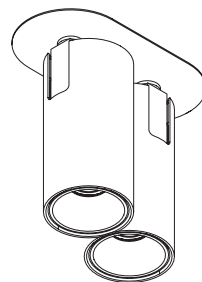

ELI 50 Spot / E 2

Order code / Code com. / Bestell-Nr. / Código / Código: 90694L... | 90695L... | 90696L... | 90697L... | 90702L... | 90703L...



EN Carefully read the installation instructions provided before installing the device. Safety and Maintenance: Scan here.
FR Lire attentivement les notices de montage avant l'installation de l'appareil. Sécurité et Entretien: Scannez ici.
DE Bitte lesen die mitgelieferte Montageanleitung vor der Montage des Geräts. Sicherheit und Wartung: Hier scannen.
PT Leia atentamente as instruções de montagem fornecidas antes de instalar o aparelho. Segurança e Manutenção: Scan aqui.
ES Lea atentamente las instrucciones de montaje proporcionadas antes de instalar el aparato. Seguridad y Mantenimiento: Escanea aquí.



ELI 50 /E 1 | ELI 50 /E 2 | ELI 50 Sq /E 2 | ELI 50 Sq /E 2 | ELI 50 Spot /E 1 | ELI 50 Spot /E 2



EN WARNING: THE LUMINAIRE MUST BE ASSEMBLED WITH A DRIVER SUITABLE FOR ITS TECHNICAL SPECIFICATIONS.
FR AVERTISSEMENT: L'APPAREIL DOIT ÊTRE INSTALLÉ AVEC LE DRIVER INSTALLÉ AVEC UN DRIVER QUI CORRESPOND À SES CARACTÉRISTIQUES TECHNIQUES.
DE WARNUNG: DIE LEUCHE MUSS MIT EINEM FÜR IHRE TECHNISCHEN SPEZIFIKATIONEN GEEIGNETEN TREIBER BESTÜCKT WERDEN.
PT ATENÇÃO: A LUMINÁRIA DEVE SER MONTADA COM O DRIVER ADEQUADO AS SUAS CARACTERÍSTICAS TÉCNICAS.
ES ATENCIÓN: LA LUMINARIA DEBERÁ MONTARSE CON EL DRIVER ADECUADO A SUS CARACTERÍSTICAS TÉCNICAS.

| |  (mm) | A | B | C | $\frac{W}{A}$ (mm) | W | mA | V |
|--------------|--|-----------|----|----------|--------------------|----|-----|------|
| .../E 1 | Ø75x76 | -- | -- | Ø(65-68) | 1-25 | 9 | 250 | 34,9 |
| .../E 2 | 75x135x76 | [120-125] | 60 | Ø(60-65) | 1-25 | 17 | 500 | 34,9 |
| ...Sq /E 1 | 75x75x73 | -- | -- | Ø(65-68) | 1-25 | 9 | 250 | 34,9 |
| ...Sq /E 2 | 135x75x73 | [120-125] | 60 | Ø(60-65) | 1-25 | 17 | 500 | 34,9 |
| ...Spot /E 1 | Ø65x159 | -- | -- | Ø(50-52) | 1-25 | 5 | 150 | 33,4 |
| ...Spot /E 2 | 65x125x159 | [105-110] | 60 | Ø(45-50) | 1-25 | 10 | 300 | 33,4 |

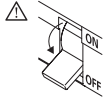

TOOLS | OUTILS | WERKZEUG | FERRAMENTAS | HERRAMIENTAS

Phillips screwdriver



EN USE GLOVES.
FR UTILISEZ DES GANTS.
DE HANDSCHUHE BENUTZEN.
PT UTILIZE LUVAS.
ES USE GUANTES.

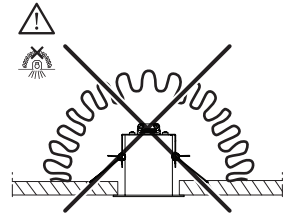
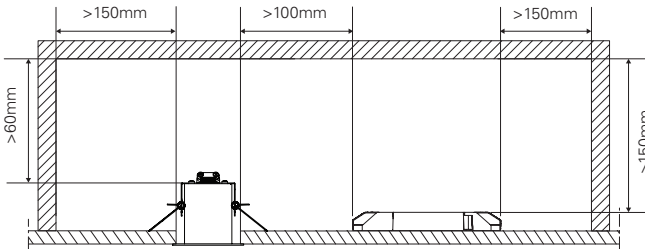

ELI 50 /E 1 | ELI 50 /E 2 | ELI 50 Sq /E 1 | ELI 50 Sq /E 2 | ELI 50 Spot /E 1 | ELI 50 Spot /E 2

90694L... | 90695L... | 90696L... | 90697L... | 90702L... |
90703L...

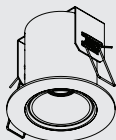

(x1)

CONTROL GEAR ALIMENTATION ÉLECTRIQUE GETRIEBSGERÄT FONTE DE ALIMENTAÇÃO FUENTE DE ALIMENTACIÓN

+ 
IIV864

90000... | 90010... | 90011... | 90030...

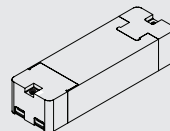



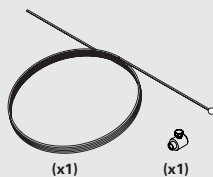
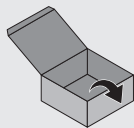

(x1)

SAFETY CABLE
FILIN D'ACIER
SICHERHEITSKABEL OPTION
CABO DE SEGURANÇA
CABLE DE SEGURIDAD

955000



| |  (mm) |  A |  B |  C |  (mm) |
|---------------|--|---|---|---|--|
| .../E 1 | Ø75x76 | -- | -- | Ø[65-68] | 1-25 |
| .../E 2 | 75x135x76 | [120-125] | 60 | Ø[60-65] | |
| ...Sq / E 1 | 75x75x73 | -- | -- | Ø[65-68] | |
| ...Sq / E 2 | 135x75x73 | [120-125] | 60 | Ø[60-65] | |
| ...Spot / E 1 | Ø65x159 | -- | -- | Ø[50-52] | |
| ...Spot / E 2 | 65x125x159 | [105-110] | 60 | Ø[45-50] | |

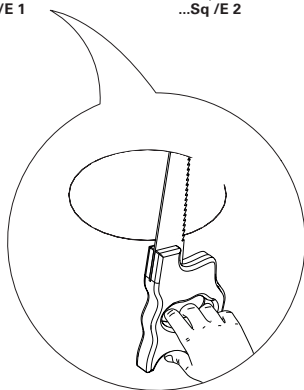
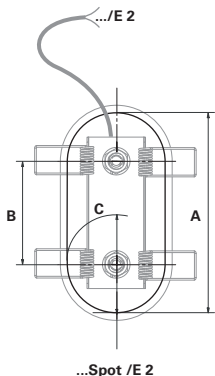
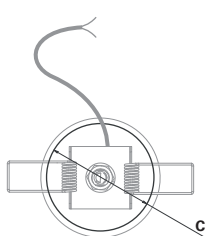
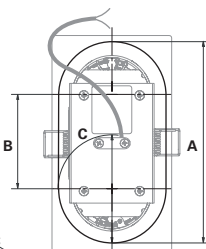
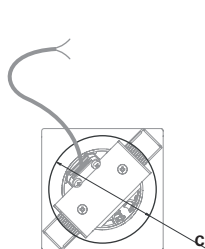
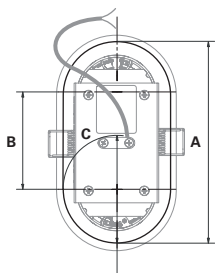
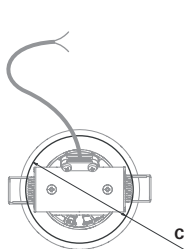

1

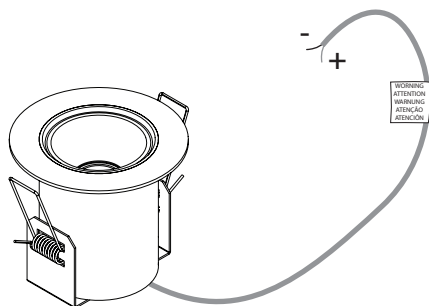

FOR ELECTRICAL CONNECTION, REQUIRES EXTERNAL CONTROL GEAR, READ: POUR LE RACCORDEMENT ELECTRIQUE, NÉCESSITE UN EQUIPEMENT DE COMMANDE EXTERNE, LIRE : FÜR DEN ELEKTRISCHEN ANSCHLUSS IST EIN EXTERNES STEUERGERÄT ERFORDERLICH, LESEN SIE: PARA LIGAÇÃO ELÉTRICA, REQUER FONTE DE ALIMENTAÇÃO EXTERNA, LER: PARA LA CONEXIÓN ELÉCTRICA, REQUIERE FUENTE DE ALIMENTACIÓN EXTERNA, LEA:



IIV864

2 - SAFETY CABLE OPTION
OPTION FILIN D'ACIER
SICHERHEITSKABEL OPTION
OPÇÃO CABO DE SEGURANÇA
OPCIÓN CABLE DE SEGURIDAD

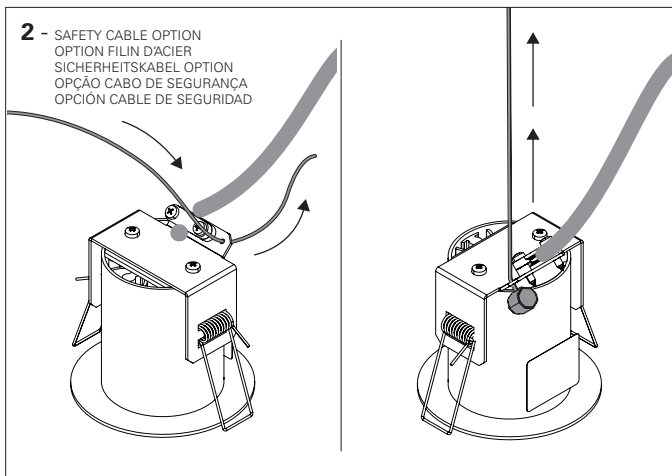

3

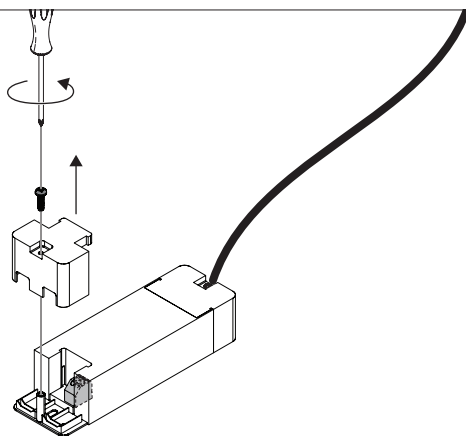

4

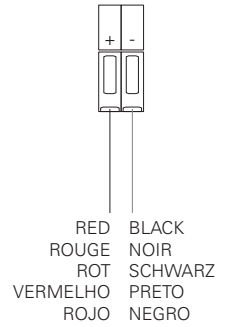
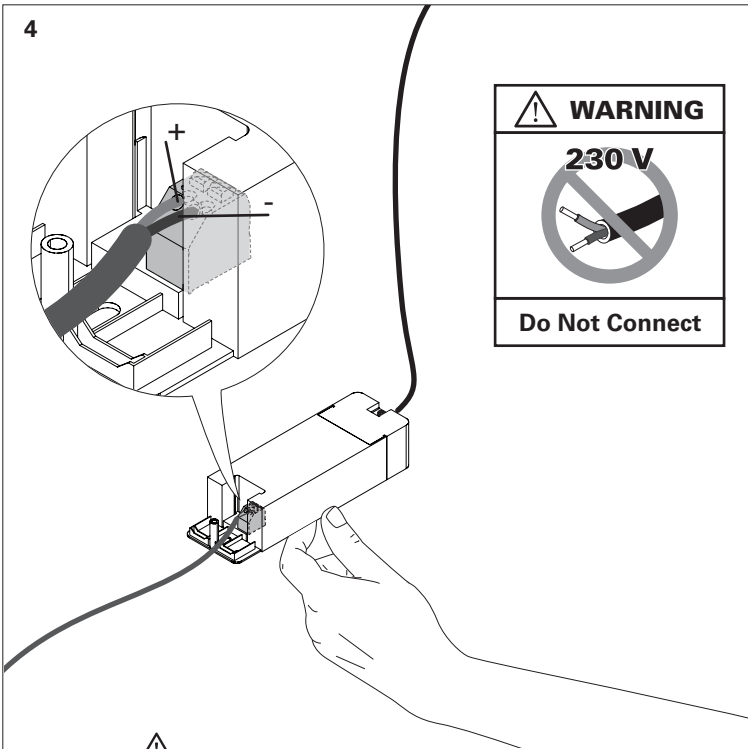

EN WARNING: NEVER CONNECT DIRECTLY ~230V. DRIVER REQUIRED FOR OPERATION.
FR ATTENTION : NE JAMAIS BRANCHER DIRECTEMENT SUR ~230V. NECESSITE L'APPLICATION D'UN DRIVER.
DE ACHTUNG: NIEMALS DIREKT AN ~230V ANSCHLIESSEN. FÜR DEN BETRIEB IST EIN TREIBER ERFORDERLICH.
PT ATENÇÃO: NUNCA LIGAR ~230V DIRETO. REQUER APLICAÇÃO DO DRIVER.
ES ATENCIÓN: NO CONECTAR DIRECTAMENTE A ~230V. REQUIERE LA APLICACIÓN DE UN DRIVER.

5

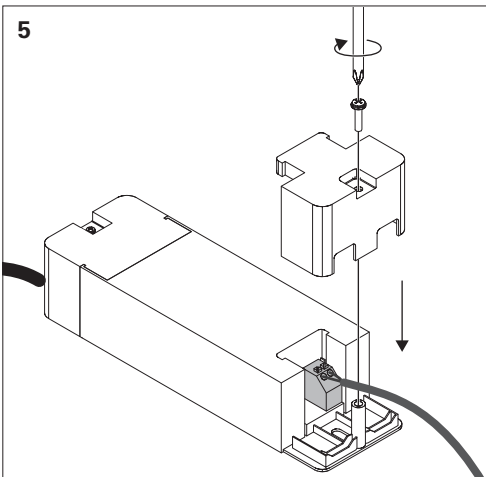

6

2.

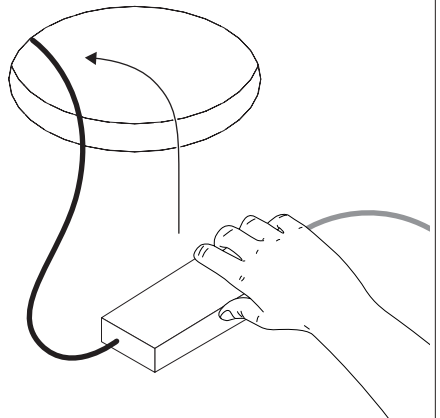

7

1.

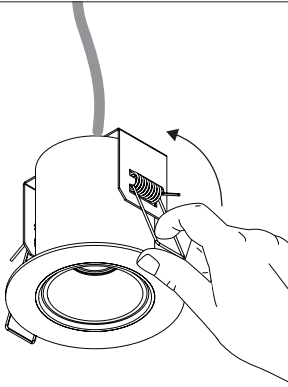

2.

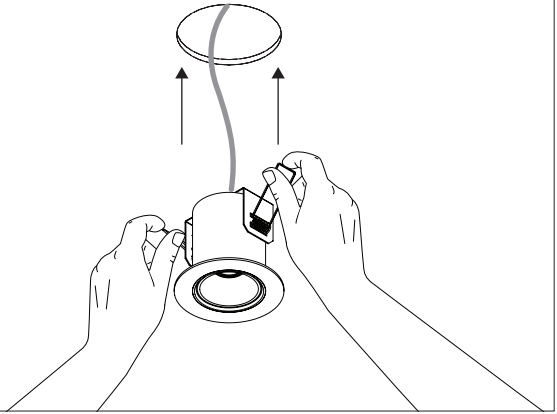

ELI 50 Spot /E 1 | ELI 50 Spot /E 2

