



DIMENSIONS



ACCESSORIES



HIGH CHROMATIC LED



BEAM MIXER DIFFUSER

ANTI-GLARE HONEYCOMB
LOUVER

TRACK 48V OPTIONS

AWARDS



| | |
|-----------|------------------------------------|
| Name | TOP MINI 48V DIM DALI 30° 3000K NT |
| Reference | A3400221NT |
| Color | Textured black |
| RAL | 9005 |
| Category | TRACKLIGHTS |

PRODUCT

TOP MINI 48V DIM DALI 30° 3000K NT

A3400221NT

Textured black

9005

TRACKLIGHTS

LIGHTING INFORMATION

| | |
|-----------------------------|---------------------------|
| Light source | LED |
| Gross luminous flux | 640 Lm |
| Power | 6,5 W |
| Power values of the system | 6,84 W |
| Colour temperature | 3000 K |
| Colour Rendering Index | CRI>90 |
| Chromatic stability | Mac Adam Step 2 |
| Light beam angle | 30° |
| Unified Glare Rating | UGR<19 |
| Lighting efficiency | 89% |
| Efficacy | 98 Lm/W |
| Current intensity | 700 mA |
| Dimming | DALI |
| Control through bluetooth | Please Consult |
| Driver | Included |
| Electrical insulation class | III |
| Voltage | 48 Vdc |
| Energy efficiency | A+ |
| LED lifespan | L80B10 (Tj=85°C) >60.000h |

OTHER DATA

| | |
|----------------------|---------------------------|
| Ingress Protection | IP20 |
| Track type | Track 48V |
| Weight | 95 g. |
| Packaged weight | 165 g. |
| Packaging dimensions | 188 × 163 × 53 mm. |
| Units per package | 1 |
| Materials | Aluminium / Polycarbonate |



Top 48V is miniaturized luminary that serves as a downlight low voltage tracklight systems. Its reduced dimensions make Top the perfect candidate for projects where a discrete presence and a perfect integration are needed. It is a pure line and an architectural aesthetic design. Moreover, in terms of lighting performance, Top offers a conical distribution with three possible beam angles (flood, medium and spot).

POLAR DIAGRAM

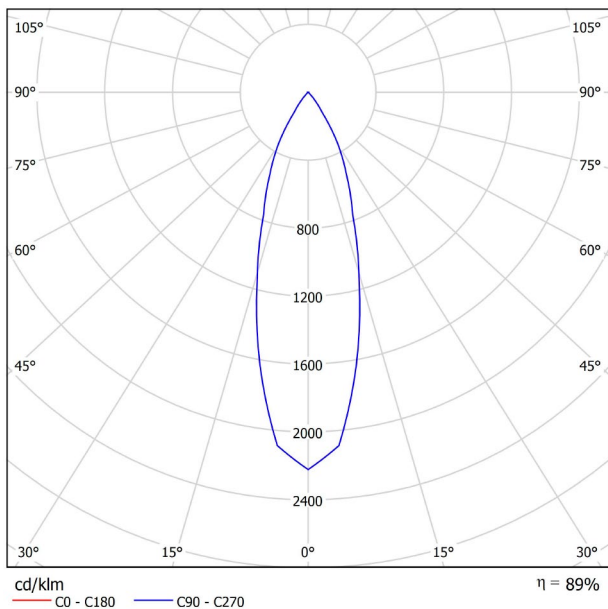

CONICAL DIAGRAM

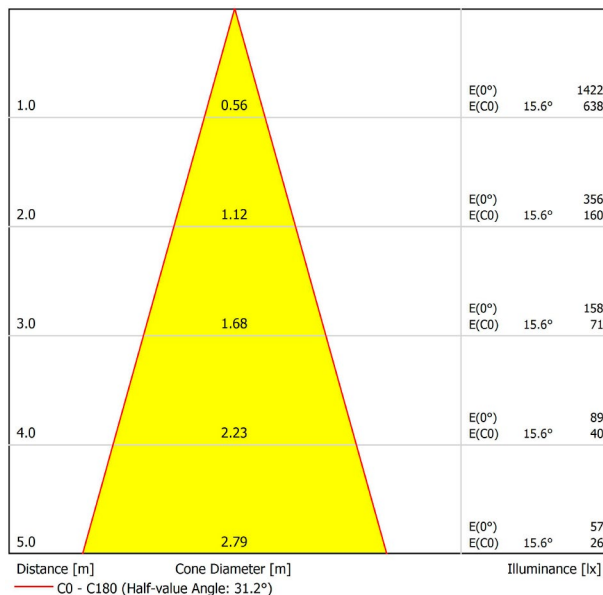

| Vivid Model Colour Temperature | 2700K | 3000K | 3500K | 4000K | Light Pink |
|-----------------------------------|-------|-------|-------|-------|------------|
| 📖 Reading | | | • | • | |
| 🥗 Fruits & Vegetables | | • | • | | |
| 🍞 Bakery | • | | | | |
| 👤 Retail | | • | • | | |
| 💄 Cosmetics | | | • | • | |
| 🥩 Meat | | | | | • |
| 🐟 Fish | | | | • | |
| 🐠 Seafood | | | | • | • |



For some of its products, Arkoslight offers the possibility to provide them with a special LED, designed to create an illumination focused on visually promoting goods or products for commercial purposes. It is a high chromaticity LED, capable of identifying the colour shades that produce a positive psychological perception of the illuminated object.

This special LED lighting source offers a much more attractive and intense colour range than a conventional LED, besides being much wider. Technically, this is possible thanks to a special LED setting that includes a «special saturation parameter», capable of highlighting the objects colours and materials in such a way that they seem more attractive within the visible light spectrum. To achieve this performance, in each case, the appropriate diode and specific phosphor coating are carefully selected.



| | PRODUCT |
|-----------|---------------------|
| Model | Beam Mixer Diffuser |
| Reference | 08050100 |
| Category | Accessories |

NOT SOLD SEPARATELY.

The Beam Mixer Diffuser is used to smooth beam artifacts caused by parabolic, Fresnel, or TIR lens collimators without significant broadening.

The unique mixing design provides superior far-field smoothing and color mixing with high on-axis brightness. Compared with traditional diffusers, it maintains higher central beam candlepower (CBCP), and produce less undesirable "field light" at higher angles.



| | PRODUCT |
|-----------|-----------------------------|
| Model | Anti-glare Honeycomb Louver |
| Reference | 08070000NT |
| Colour | NT ■ Textured black |
| Category | Accessories |

NOT SOLD SEPARATELY.



Accessory made up of louver in the shape of a honeycomb panel to reduce glare and the effects of direct rays of vision.

TRACK 48V TRIMLESS

ARKOSLIGHT®

TRACK 48V SURFACE

Available on request. Please consult.

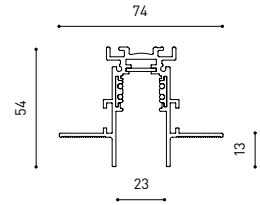

| | |
|---------------------------------|-----------------|
| TRACK 48V 1M | A338-01-00- N |
| TRACK 48V 2M | A338-02-00- N |
| TRACK 48V 3M | A338-03-00- N |
| TRACK 48V Corner 90° One Plane | A338-06-00- N |
| TRACK 48V Corner 90° Two Planes | A338-07-00- N |



| | | P | I | D |
|--------------------------------------|------------|------|-----|------------------|
| CONSTANT VOLTAGE LED POWER SUPPLY | 0434-01-21 | 75W | 48V | 180 x 52 x 30mm |
| | 0434-01-22 | 150W | 48V | 240 x 60 x 49mm |
| | 0434-01-19 | 75W | 48V | 235 x 100 x 31mm |
| | 0434-01-20 | 150W | 48V | 235 x 100 x 31mm |

CABLE SECTION AND LENGTH BETWEEN TRACK 48V AND POWER SUPPLY

| TRACK LENGTH (m) | | 10 | | | 20 | | 29 |
|------------------|---------------------|----|----|----|----|----|----|
| CABLE LENGTH (m) | | 1 | 10 | 20 | 1 | 10 | 1 |
| POWER (W) | CABLE SECTION (mm²) | | | | | | |
| 75W | 0,75mm² | ✓ | ✓ | ✓ | ✓ | ✓ | ✓ |
| | 1,5mm² | ✓ | ✓ | ✓ | ✓ | ✓ | ✓ |
| 150W | 0,75mm² | ✓ | X | X | ✓ | X | ✓ |
| | 1,5mm² | ✓ | ✓ | X | ✓ | ✓ | ✓ |

COLOUR | N ■ RAL 9005 |

Recommended for installations where the profile can be installed before the false plasteboard ceiling (thickness 12,5mm.)



TRACK 48V TRIMLESS

ARKOSLIGHT®

TRACK 48V SURFACE

Available on request. Please consult.

TRACK 48V 90° CORNER One Plane



*Electrical connection not included

TRACK 48V 90° CORNER Two Planes



*Electrical connection not included



TRACK 48V Live-End Connector

A338-00-01- | N |



TRACK 48V End

A338-00-06- | N |



TRACK 48V Central Connector

A338-00-02- | N |



TRACK 48V End Feed

A338-00-07- | N |



TRACK 48V Corner 90° Connector

A338-00-12



TRACK 48V Suspension Kit

A338-00-08

See accessories quantities*



TRACK 48V Short T-Bracket

A338-00-03



TRACK 48V Clamp for M6 ROD

A338-00-09

See accessories quantities*

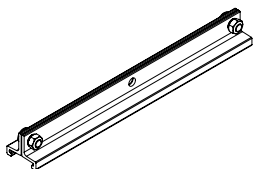

TRACK 48V Long T-Bracket

A338-00-04



TRACK 48V Track Clamp

A338-00-10

See accessories quantities*



TRACK 48V Straight Joiners (2 Units)

A338-00-05

* SUGGESTED MOUNTING ACCESSORIES QUANTITIES

1000 mm - 2 Pcs.
2000 mm - 3 Pcs.
3000 mm - 4 Pcs.

COLOUR | N ■ RAL 9005 |

Recommended for installations where the profile can be installed before the false plasteboard ceiling (thickness 12,5mm.)