

Standard Installation

SQUARE VERSA STAR/SQUARE STEP STAR

CEILING RECESSED & WALL RECESSED - LED



Flammable



Warning



Low Voltage



Hot Surface

**TOOLS
NEEDED:**

- 1/8" Allen wrench
- Waterproof Wire Connectors
- Phillips Screwdriver

INSTRUCTIONS PERTAINING TO A RISK OF FIRE, OR INJURY TO PERSONS IMPORTANT SAFETY INSTRUCTIONS

Lighted fixture is HOT!

**WARNING - To reduce the risk of
FIRE OR INJURY TO PERSONS:**

Turn off/unplug and allow to cool before replacing lamp/LED. Fixture gets HOT quickly! Contact only switch/plug when turning on. Do not touch hot lens, guard, or enclosure. Keep fixture away from materials that may burn. Do not operate the luminaire fitting with a missing or damaged shield. Do not touch the source at any time. Use a soft cloth or gloves. Oil from skin may cause damage.

SAVE THESE INSTRUCTIONS

IMPORTANT SAFETY INFORMATION - READ, FOLLOW, AND SAVE ALL SAFETY AND INSTALLATION INSTRUCTIONS

- Product must be installed by a qualified person in a manner consistent with its intended use and in compliance with the National Electrical Code, Canadian Electrical Code, and all Local and Provincial Codes.
- Follow product label information and instructions.
- Qualified Personnel with appropriate personal protective equipment must perform all servicing of this product.
- Before wiring to power supply and during servicing, turn off and lock out power at fuse or circuit breaker before service.
- The use of accessory equipment not recommended by the manufacturer or installed contrary to instructions may cause an unsafe condition. The use of damaged components may cause an unsafe condition and void product warranty.
- Do not block light emanating from product in whole or part, as this may cause an unsafe condition.
- Never operate the fixture with missing or damaged lens. Lens must be cleaned on regular basis.
- Entire fixture may become extremely hot. Do not touch hot lens or fixture body.
- Replace LED assembly only with correct wattage and type of power supply appropriate for LED assembly.
- All gaskets, o-rings and sealing surfaces must be kept clean during installation and service; failure to do this may cause an unsafe condition and void product warranty.

IMPORTANT LISTINGS AND CERTIFICATIONS

- Suitable for wet location
- Additionally suitable for mounting within 4 ft. of the ground
- Type Non-IC

Please refer to the low voltage design guide at "<https://www.bklighting.com/resources/>" before installation for proper wire selection.

This set of instructions works for:
VS-CR - Versa Star Ceiling Recessed
SS-WR - Step Star Wall Recessed

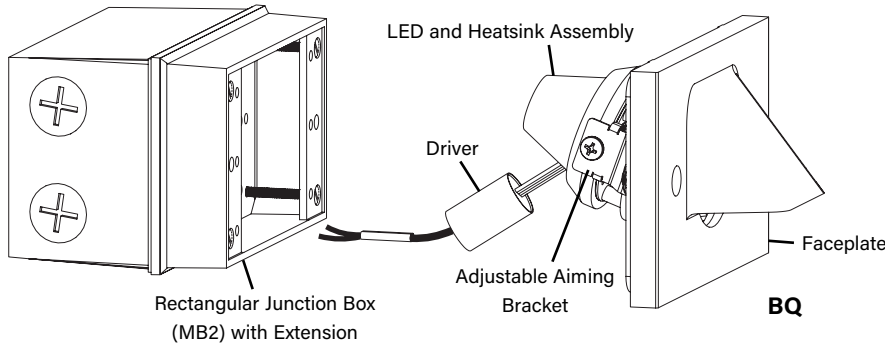

IMPORTANT NOTE
Step Star mount in ceiling. Orientation of installed back box determines faceplate screw orientation.

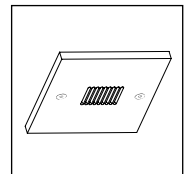
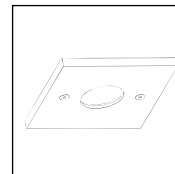
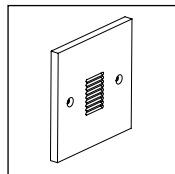
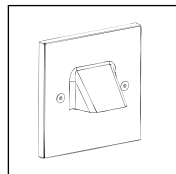
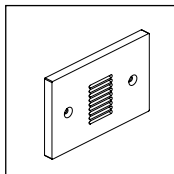
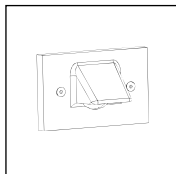

IMPORTANT SAFETY INFORMATION - READ, FOLLOW, AND SAVE THESE INSTALLATION INSTRUCTIONS

B-K LIGHTING

40429 Brickyard Drive • Madera, CA 93636 • USA
 559.438.5800 • FAX 559.438.5900
www.bklighting.com • info@bklighting.com

RELEASE DATE
 09/08/2025

REFERENCE NUMBER
 INS001003

THIS DOCUMENT CONTAINS PROPRIETARY INFORMATION OF B-K LIGHTING, INC. AND ITS RECEIPT OR POSSESSION DOES NOT CONVEY ANY RIGHTS TO REPRODUCE, DISCLOSE ITS CONTENTS, OR TO MANUFACTURE, USE OR SELL ANYTHING IT MAY DESCRIBE. REPRODUCTION, DISCLOSURE OR USE WITHOUT SPECIFIC WRITTEN AUTHORIZATION OF B-K LIGHTING, INC. IS STRICTLY FORBIDDEN.

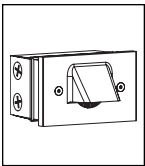

SQUARE VERSA STAR/SQUARE STEP STAR

CEILING RECESSED & WALL RECESSED - LED

Standard Installation

Phase 1 - Rough In

Installation of Back box

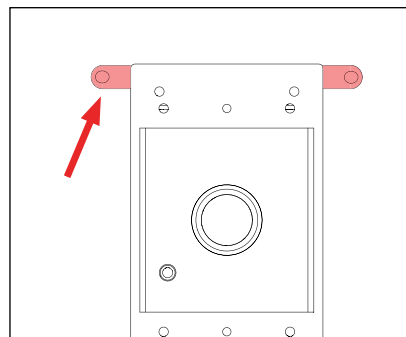
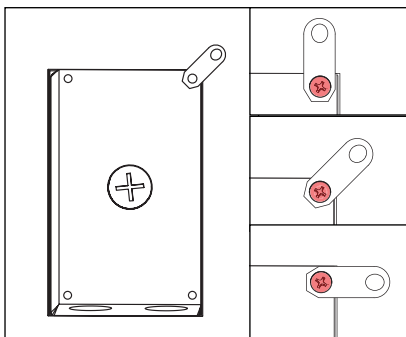
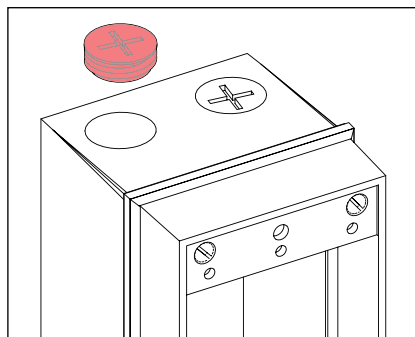
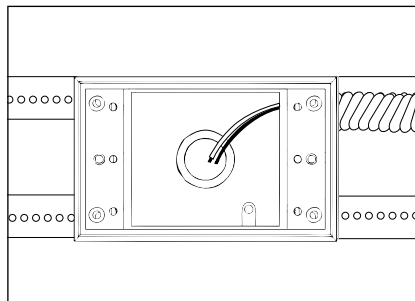

1. Remove canopy and/or fixture from MB2 housing. Ensure unused tapped holes are plugged to maintain seal. Plugs are provided.
2. Install conduit (not included) to be used with this product.

NOTE: Surface conduit is a common entrance for water if not properly sealed. Seal connector threads and conduit with a suitable sealant (teflon tape, adhesive, etc.). Sealing the conduit after knockouts are removed is required to maintain warranty.

3. To prepare MB2 for mounting, align mounting brackets on back of box. Brackets can be aligned to vertical, horizontal or 45° orientation. Secure with mounting screw using screwdriver.

Install back box so that front face is flush with finished wall or ceiling. Make sure rectangular back box is plumb before proceeding.

4. Mount MB2 box to surface using mounting hardware (included) using the mounting brackets attached to back of MB2 box.

Alternative mounting methods may compromise integrity of MB2 against water intrusion and will void warranty.

5. Connect box to conduit and pull wires for connections (See Wiring diagram).

Phase 2 - Finish Installation of Fixture with Remote Transformer

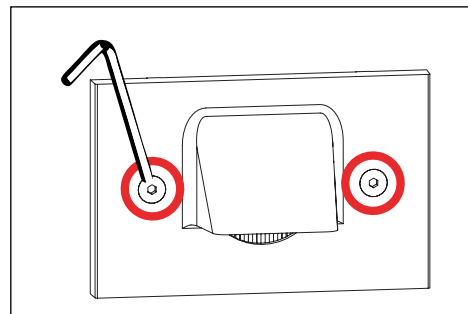
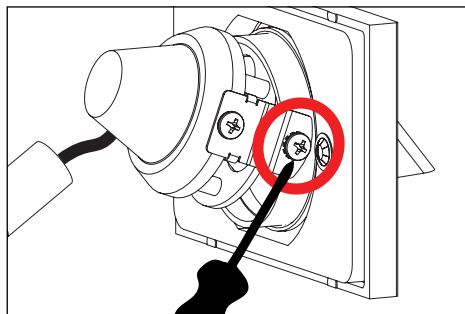
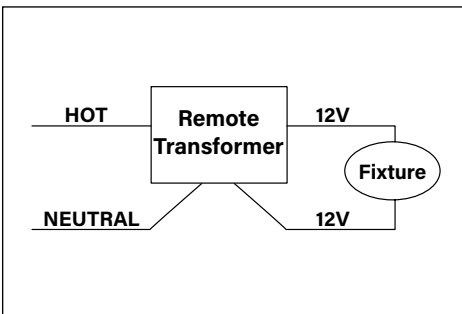

WIRING DIAGRAM

LED - For use with 12VAC LED remote transformer or magnetic transformers only. B-K Lighting cannot guarantee performance with third party manufacturers' transformers.

1. Make watertight connections from remote 12V transformer to LED source leads using waterproof wire connectors. See wiring diagram.

2. To aim, loosen the two (2) phillips screws attaching the adjustable bracket to the faceplate. Aim to desired position. Tighten two (2) phillips screws to lock in place when desired angle is set.

3. Mount faceplate using two (2) #10-24 screws with 1/8" allen wrench. Tighten evenly to compress gasket. **Do not over tighten.**

**IMPORTANT SAFETY INFORMATION LISTED ON REVERSE
READ, FOLLOW, AND SAVE ALL SAFETY AND INSTALLATION INSTRUCTIONS**



B-K LIGHTING

40429 Brickyard Drive • Madera, CA 93636 • USA
559.438.5800 • FAX 559.438.5900
www.bklighting.com • info@bklighting.com

RELEASE DATE
09/08/2025

REFERENCE NUMBER
INS001003

LED BOARD/DRIVER/OPTICS

ARCHITECTURAL RECESSED - BACK BOX

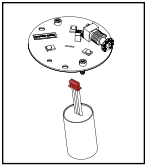

Standard Installation/Replacement



Flammable



Warning





Low Voltage



Hot Surface

TOOLS NEEDED:

-  5/64" & 9/64" Allen Wrench
-  Small Flat Head Screw Driver
-  Phillips Screwdriver

Replacing LED Board/Driver and Optics

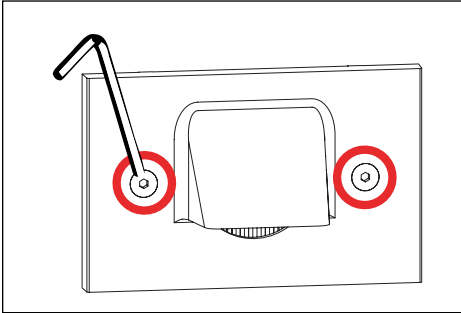

- Remove fixture by loosening two (2) #10-24 fasteners. Gently pull away from installed back box enough to expose back of faceplate.

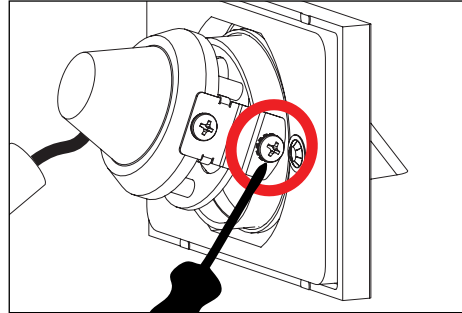

- Loosen two (2) phillips head screws holding bracket to faceplate. Remove bracket from faceplate to expose optics and LED.

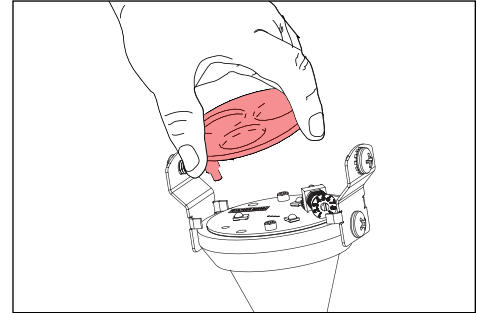

- Space three fingers evenly around the optic and gently rock optic to remove.

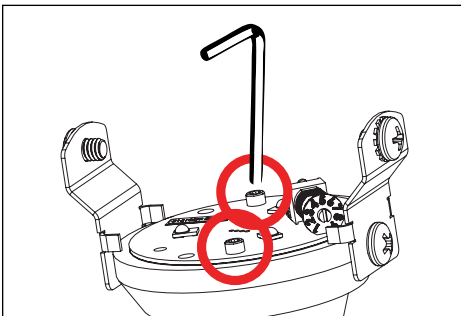

- Use a 5/64" allen wrench to remove two (2) #2-56 socket head cap screws on LED board, grasp LED board and gently pull up to expose quick disconnect.

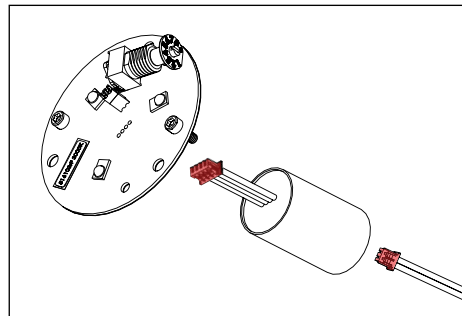

- Disengage LED board and driver assembly. Replace with new board and driver assembly.

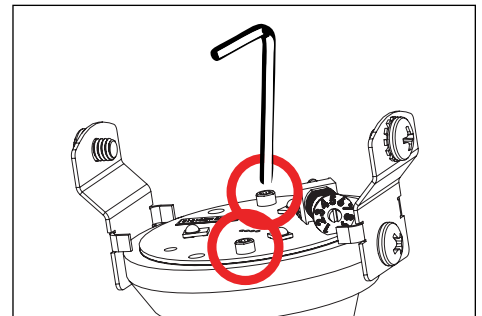

- Reverse install LED board and driver by carefully re-engaging quick disconnects. Secure LED board in place with stainless steel screws. Snap optics in place.

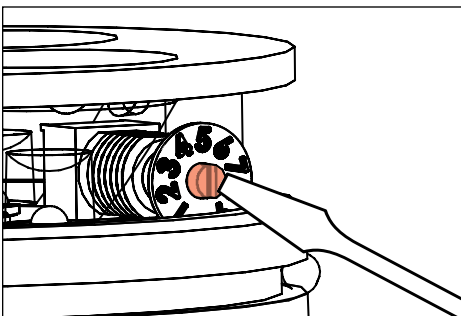

- With flat head screw driver rotate dial to desired lumen output.

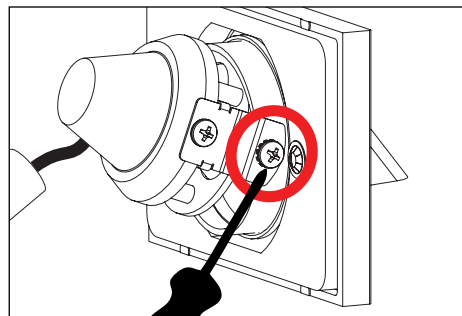

- Attach bracket to faceplate by securing two (2) phillips screws. Aim to desired position. Tighten two (2) phillips screws to lock in place when desired angle is set.

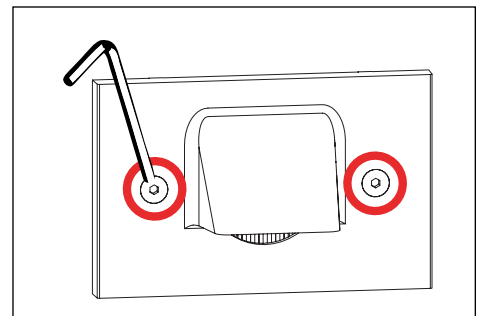

- Mount faceplate using two (2) #10-24 screws with a 1/8" allen wrench. Tighten evenly to compress gasket. **Do not over tighten.**

IMPORTANT SAFETY INFORMATION - READ, FOLLOW, AND SAVE THESE INSTALLATION INSTRUCTIONS

B-K LIGHTING

40429 Brickyard Drive • Madera, CA 93636 • USA
559.438.5800 • FAX 559.438.5900
www.bklighting.com • info@bklighting.com

RELEASE DATE
09/08/2025

REFERENCE NUMBER
INS001003

THIS DOCUMENT CONTAINS PROPRIETARY INFORMATION OF B-K LIGHTING, INC. AND ITS RECEIPT OR POSSESSION DOES NOT CONVEY ANY RIGHTS TO REPRODUCE, DISCLOSE ITS CONTENTS, OR TO MANUFACTURE, USE OR SELL ANYTHING IT MAY DESCRIBE. REPRODUCTION, DISCLOSURE OR USE WITHOUT SPECIFIC WRITTEN AUTHORIZATION OF B-K LIGHTING, INC. IS STRICTLY FORBIDDEN.